

TYPICAL THREE LANE ASPHALT RECONSTRUCTION CROSS SECTION

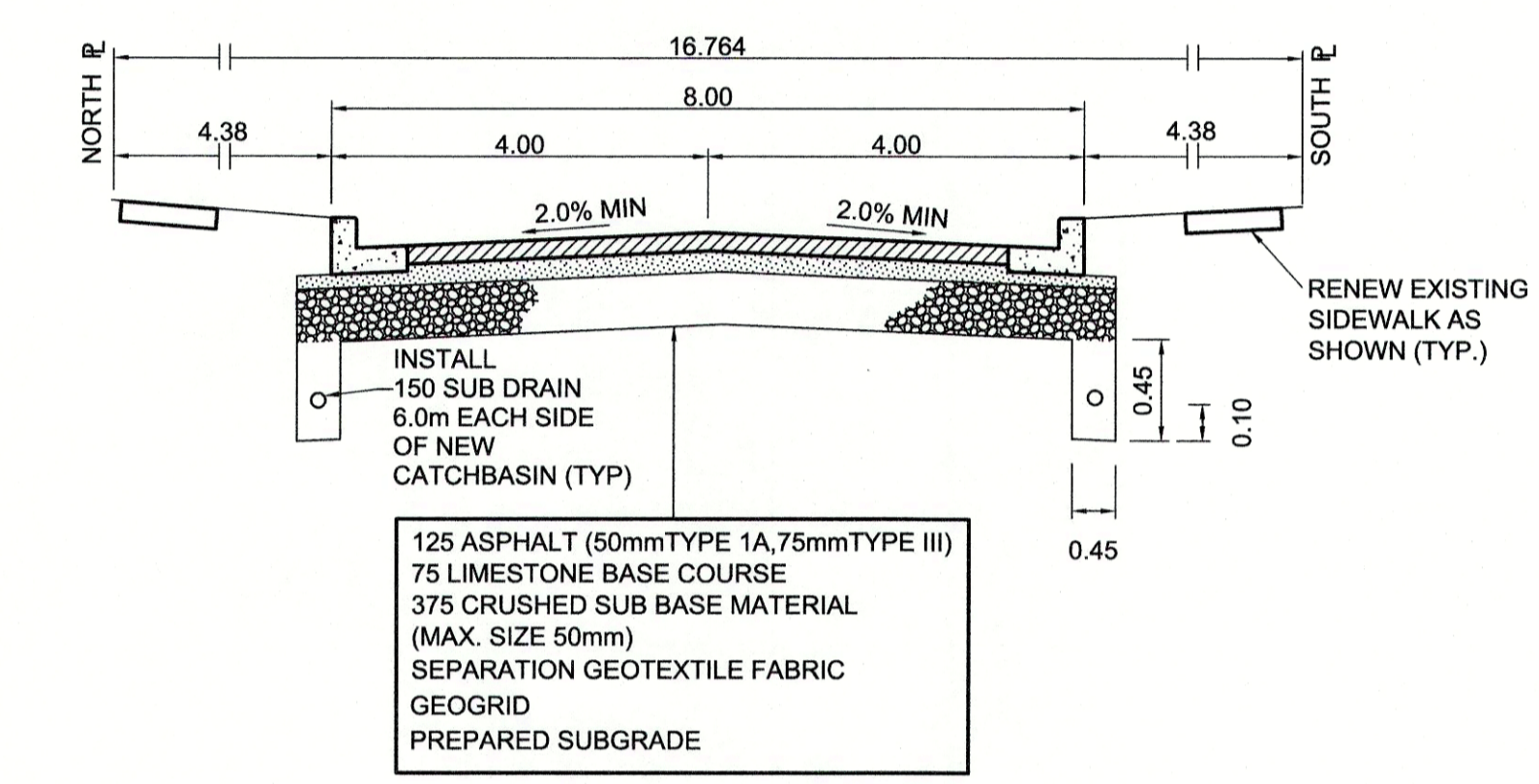

TYPICAL ASPHALT RECONSTRUCTION CROSS SECTION

- REFERENCE NOTES**
- PAVEMENT DIMENSIONS ARE TO BACK OF CURB
  - BASELINE IS CENTRE LINE RIGHT-OF-WAY
  - PROPERTY LINES OBTAINED FROM CITY OF WINNIPEG L.B.I.S., AND NO SCALE FACTOR WAS APPLIED
  - REFER TO AECOM FIELD BOOK NO. 4918
- CONSTRUCTION NOTES**
- RE-GRADE EXISTING GRAVEL
  - REMOVE EXISTING CONCRETE PAVEMENT AND CONSTRUCT NEW ASPHALTIC PAVEMENT (125mm SEE ABOVE PAVEMENT SECTION FOR ASPHALT TYPES)
  - REMOVE EXISTING CONCRETE PAVEMENT AND CONSTRUCT NEW 150mm REINFORCED CONCRETE PAVEMENT
  - CONSTRUCT NEW BARRIER CURB (180mm HT. SEPARATE)
  - CONSTRUCT NEW MODIFIED BARRIER CURB (180mm HT. SEPARATE)
  - CONSTRUCT NEW MODIFIED BARRIER CURB (180mm HT. INTEGRAL)
  - CONSTRUCT NEW CURB RAMP (10mm HT. INTEGRAL)
  - CONSTRUCT NEW BARRIER CURB AND GUTTER (180mm HT.)
  - RENEW EXISTING 100mm CONCRETE SIDEWALK
  - CONSTRUCT NEW LIP CURB AND GUTTER (40mm HT.)
  - REMOVE EXISTING CATCHBASIN AND PLUG EXISTING LEAD
  - INSTALL NEW CURB AND GUTTER INLET c/w CATCH BASIN (SD-024) AND CONNECT NEW 250mm LEAD TO EXISTING 450CS
  - REMOVE EXISTING FRAME AND COVER AND PLACE NEW FRAME AND SOLID COVER (AP-004/AP-005)
  - ADJUST EXISTING MANHOLE TO GRADE
  - ADJUST EXISTING TRAFFIC SIGNAL SPLICE PIT TO GRADE
  - INSTALL NEW CAST IRON RING
  - INSTALL 150mm SUBDRAIN 6.0m ON EACH SIDE OF CATCHBASIN
  - REMOVE EXISTING ASPHALTIC PAVEMENT AND CONSTRUCT NEW ASPHALTIC PAVEMENT TYPE 1A
  - ADJUST EXISTING WATER VALVE TO GRADE
  - ADJUST EXISTING CURB STOP TO GRADE
  - INSTALL DETECTABLE WARNING SURFACE TILE
  - ADJUST EXISTING PATIO BLOCKS
  - REMOVE AND REINSTALL LIGHT STANDARD

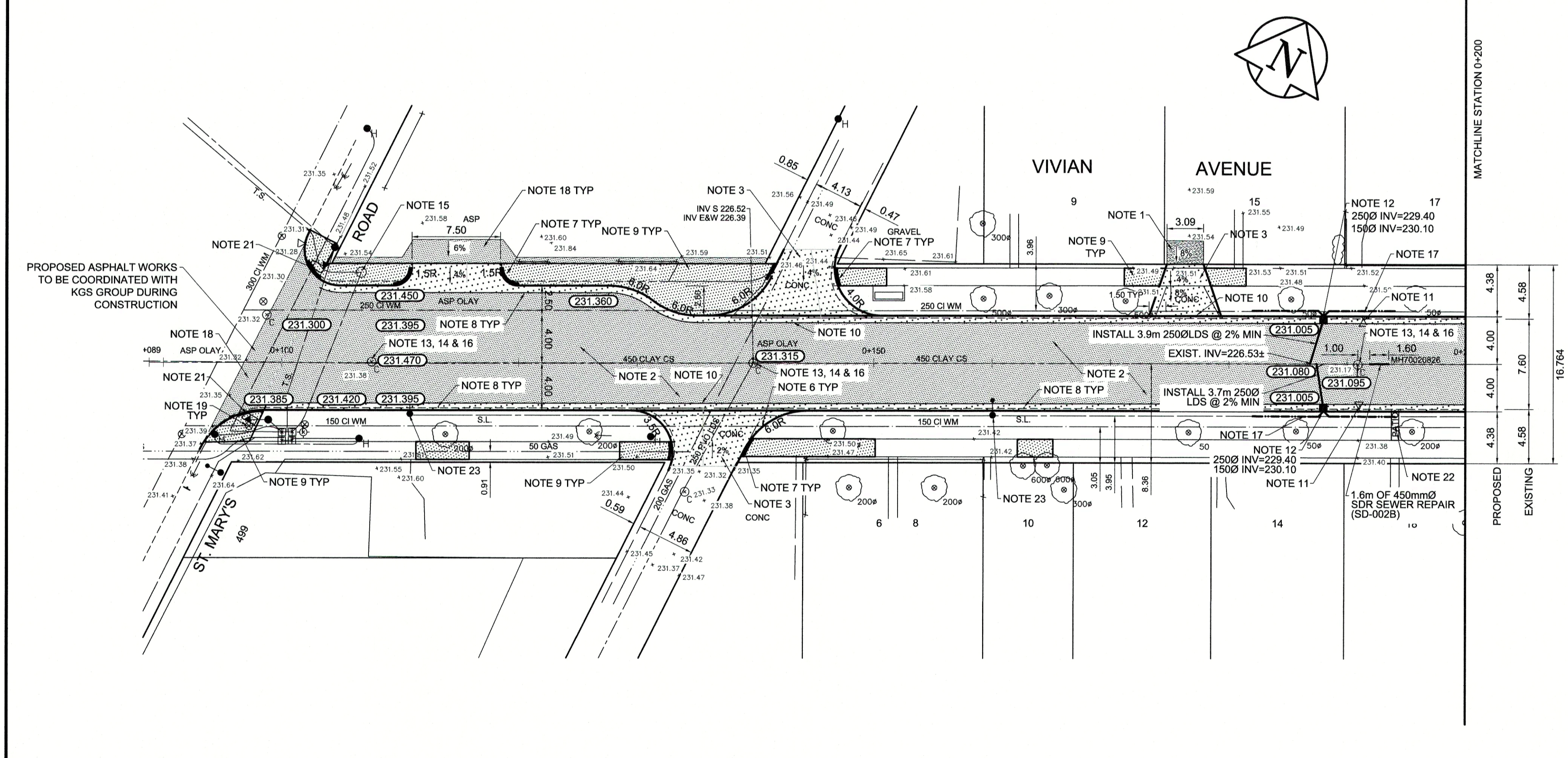

EXISTING	LEGEND - PLAN	PROPOSED	EXISTING	LEGEND - PLAN	PROPOSED	EXISTING	LEGEND - PROFILE	PROPOSED
150 mm W.M.	WATERMAIN	150 mm W.M.	---	HYDRO	---	X	C PROFILE	---
Hydrant	HYDRANT	Hydrant	---	M.T.S.	---	---	NORTH/WEST GUTTER	---
Valve	VALVE	Valve	---	CONCRETE	---	---	SOUTH/EAST GUTTER	---
300mm L.D.S.	LAND DRAINAGE SEWER	300mm L.D.S.	---	ASPHALT	---	---	N/W PROPERTY LINE	---
250mm W.W.S.	WASTEWATER SEWER	250mm W.W.S.	---	PROPERTY LINE	---	---	S/E PROPERTY LINE	---
Manhole	MANHOLE	Manhole	---	SURVEY BAR	---	---		---
Catch Basin	CATCH BASIN	Catch Basin	---	ELEVATION	(35.750)	---		---
Catch Pit	CATCH PIT	Catch Pit	---	TREE	---	---		---
Junctions	JUNCTIONS	Junctions	---	SIDEWALK RAMP	---	---		---
Culvert	CULVERT	Culvert	---	CONCRETE SIDEWALK	---	---		---
Gas	GAS	Gas	---	FENCE	---	---		---

**LOCATION APPROVED UNDERGROUND STRUCTURES**

SUPV. UG STRUCTURES COMMITTEE DATE

**NOTE:**  
LOCATION OF UNDERGROUND STRUCTURES AS SHOWN ARE BASED ON THE BEST INFORMATION AVAILABLE, BUT NO GUARANTEE IS GIVEN THAT ALL EXISTING UTILITIES ARE SHOWN OR THAT THE GIVEN LOCATIONS ARE EXACT. CONFIRMATION OF EXISTENCE AND EXACT LOCATION OF ALL SERVICES MUST BE OBTAINED FROM THE INDIVIDUAL UTILITIES BEFORE PROCEEDING WITH CONSTRUCTION.

B.M. 54 - 018 654374 SW corner Vivian Ave & St Mary's Rd. Tbl  
ELEV. 231.528  
In valve box, 6.6m N of C.L. Vivian Ave & 2.9m W of West curb of S bound traffic lane St Mary's Rd.

DESIGNED BY	BC	CHECKED BY	KWR/BC
DRAWN BY	PB/RT	APPROVED BY	
HOR. SCALE:	1:250	RELEASED FOR CONSTRUCTION BY:	
VERTICAL:	1:10	DATE	Apr 12/16
ISSUED FOR TENDER	04/13/2016	BC	
ISSUED FOR REVIEW	03/31/2016	BC	
NO. REVISIONS		DATE	

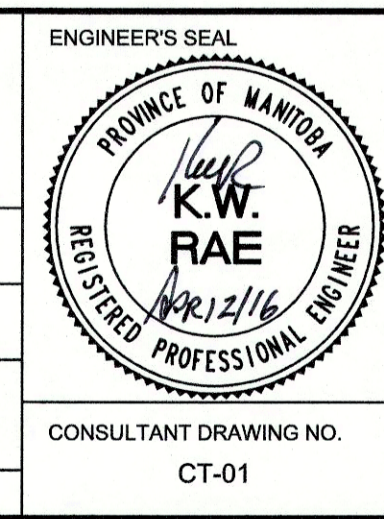

**AECOM**

Certificate of Authorization  
AECOM Canada Ltd.  
No. 4671 Date: Apr 12/16

**METRIC**  
WHOLE NUMBERS INDICATE MILLIMETRES  
DECIMALIZED NUMBERS INDICATE METRES

**THE CITY OF WINNIPEG**  
PUBLIC WORKS DEPARTMENT  
ENGINEERING DIVISION

2016 LOCAL STREET RENEWAL PROGRAM

VIVIAN AVENUE: ST MARY'S ROAD TO RUE DES MEURONS  
CONCRETE/ASPHALT RECONSTRUCTION  
ST MARY'S ROAD TO STATION 0+200

CITY DRAWING NUMBER  
SHEET 01 OF 11