

UNDERGROUND SERVICE NOTES:

- CONFIRM LOCATIONS OF UNDERGROUND SERVICES PRIOR TO COMMENCEMENT OF SITE WORKS.
- REPORT ANY ENCUMBRANCES TO THE CONTRACT ADMINISTRATOR & OWNER IMMEDIATELY.

GENERAL LEGEND

- | | | | |
|---------|-------------------------|------------|---|
| MH ○ | MANHOLE | ----- | CHAIN LINK FENCE |
| CB ○ | CATCH BASIN | —200 GAS— | GAS LINES |
| CI □ | CURB INLET | —250 WM— | WATERMAIN |
| ⊙ | WATER VALVE | —750 CS— | SEWER |
| ⊕ | FIRE HYDRANT | —OH HYDRO— | OVERHEAD HYDRO |
| ● LS | LIGHT STANDARDS | —UG HYDRO— | UNDERGROUND HYDRO |
| ● PED-X | PEDESTRIAN X-WALK LIGHT | —TS— | TRAFFIC SIGNALS |
| ● HP | HYDRO POLE | ----- | LIMIT OF CONSTRUCTION |
| ○ S | SIGN | ○ | EXISTING TREES TO BE RETAINED & PROTECTED DURING CONSTRUCTION |
| ● B | BOLLARDS | | |
| □ | BOLLARD TO REMAIN | | |

MATERIALS LEGEND

- | | | | |
|-----------|---|-----------|--|
| [Pattern] | CIP CONC. SIDEWALK | [Pattern] | REPAIR ASPHALT TO MATCH EXISTING & PER CW 3410 |
| [Pattern] | POURED IN PLACE RUBBER SURFACE COLOUR BLUE | [Turtle] | EXTRUDED FOAM TURTLE - BY OTHERS |
| [Pattern] | POURED IN PLACE RUBBER SURFACE COLOUR: BROWN | [Bench] | LOG BENCH - BY OTHERS |
| [Pattern] | ACRYLOTEX PAINT OVER CONC. COLOUR CAPE GREY | ○ | 18" HT. LOG STEPPER |
| [Pattern] | ACRYLOTEX PAINT OVER CONC. COLOUR ORANGE | ● | 28" HT. LOG STEPPER |
| [Pattern] | ACRYLOTEX PAINT OVER CONC. COLOUR SAHARA SAND | ⊙ | LIGHT STANDARD - BY OTHERS |
| [Pattern] | ACRYLOTEX PAINT OVER CONC. COLOUR YELLOW | ⊕ | ISOLATE EXISTING C.B. |
| [Pattern] | ACRYLOTEX PAINT OVER CONC. COLOUR WHITE | | |

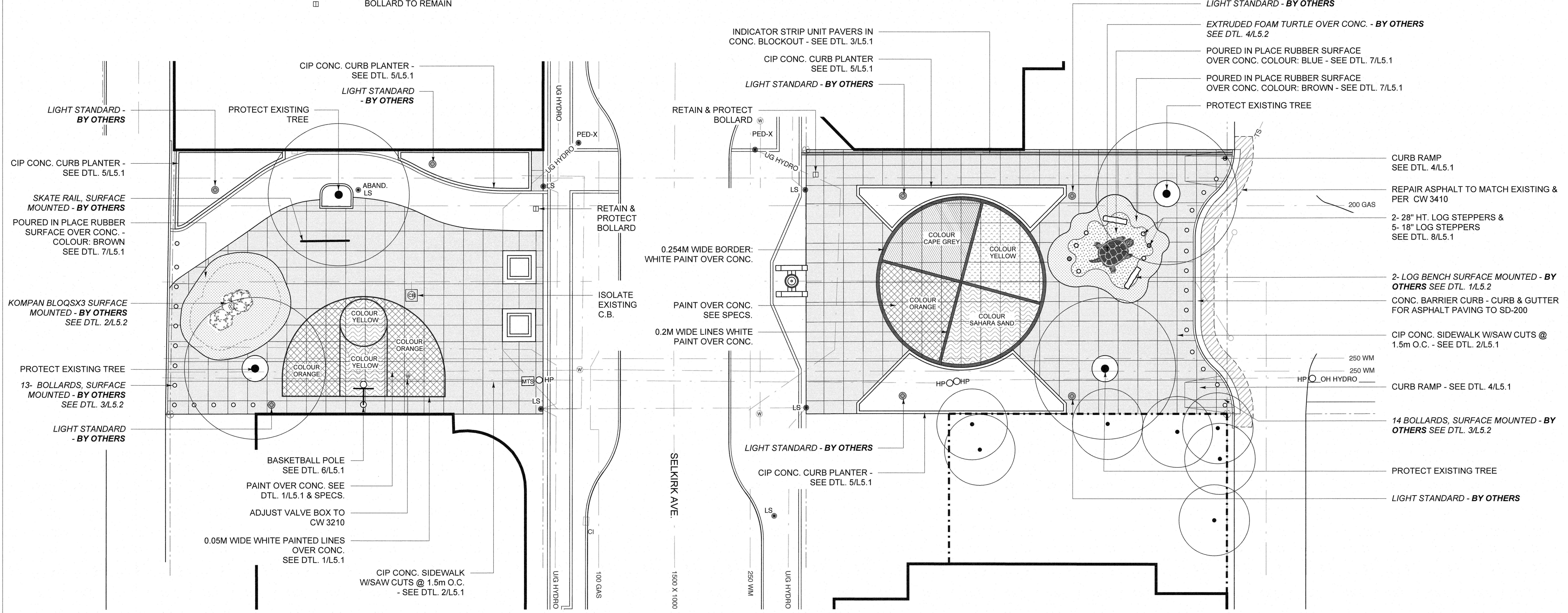

1 MATERIALS PLAN
L4.0 SCALE: 1:150

METRIC
WHOLE NUMBERS INDICATE MILLIMETRES
DECIMALIZED NUMBERS INDICATE METRES

LOCATION APPROVED UNDERGROUND STRUCTURES <i>Approved Record 211/02/17</i> SUPV. U/G STRUCTURES COMMITTEE DATE		B.M. ELEV.		ENGINEER'S SEAL Monica Giesbrecht Member No. 101 Feb 22/16		THE CITY OF WINNIPEG PUBLIC WORKS DEPARTMENT ENGINEERING DIVISION	
NOTE: LOCATION OF UNDERGROUND STRUCTURES AS SHOWN ARE BASED ON THE BEST INFORMATION AVAILABLE BUT NO GUARANTEE IS GIVEN THAT ALL EXISTING UTILITIES ARE SHOWN OR THAT THE GIVEN LOCATIONS ARE EXACT. CONFIRMATION OF EXISTENCE AND EXACT LOCATION OF ALL SERVICES MUST BE OBTAINED FROM THE INDIVIDUAL UTILITIES BEFORE PROCEEDING WITH CONSTRUCTION.		DESIGNED BY HC CHECKED BY HC		DRAWN BY JH APPROVED BY		SELKIRK AVENUE PAVEMENT RECONSTRUCTION ARLINGTON STREET TO SALTER STREET	
EXISTING LEGEND - PLAN PROPOSED EXISTING LEGEND - PLAN PROPOSED EXISTING LEGEND - PROFILE PROPOSED		0 Issued for Tender 02/26/16 JH		HOR. SCALE: as shown VERTICAL: as shown		POWERS PLAZA UPGRADE MATERIALS PLAN	
		NO REVISIONS DATE BY		RELEASED FOR CONSTRUCTION BY:		CITY DRAWING NUMBER P-3471-18 SHEET 18 OF 20 BID NO. 24-2016	