

ADDRESS	SIZE & MATERIAL	CURB STOP MEASUREMENTS		CORP LOCATION
		SHORT	LONG	
823 BARRY AVE	20 CU	5.18 EWHL		4.57 EWHL
824 BARRY AVE	20 CU	7.32 EWHL		7.62 EWHL
827 BARRY AVE		3.72 EWHL		
828 BARRY AVE	20 CU	5.36 WEHL		3.35 WEHL
831 BARRY AVE		5.27 WEHL		
832 BARRY AVE		5.27 WEHL		
835 BARRY AVE		4.82 WEHL		
836 BARRY AVE		2.59 WEHL		
839 BARRY AVE		4.57 EWHL		
840 BARRY AVE		3.96 EWHL		
843 BARRY AVE		6.25 EWHL		
844 BARRY AVE		4.05 EWHL		
847 BARRY AVE		3.72 WEHL		
850 BARRY AVE	20 CU	2.29 EWHL		

CONSTRUCTION NOTES:

1. INSTALL WATER MAIN BY TRENCHLESS METHODS.
2. ALL MATERIALS TO CONFORM TO THE CITY OF WINNIPEG STANDARD CONSTRUCTION SPECIFICATIONS.
3. MINIMUM COVER TO TOP OF PROPOSED WATER MAIN IS 2.5m FROM STREET CENTERLINE.
4. INSTALL ALL HYDRANTS WITH FLANGE ELEVATION 50mm TO 150mm ABOVE FINISHED GRADE.
5. REPLACE ALL EXISTING LEAD SERVICES FROM THE PROPOSED WATER MAIN TO PROPERTY LINE.
6. BACKFILL UNDER OR WITHIN 1.0m OF PAVEMENTS, (INCLUDING SIDEWALKS) IS CLASS 3 BACKFILL EXCEPT AS NOTED. BACKFILL IN BOULEVARDS IS CLASS 5 BACKFILL.
7. WATER VALVES ARE CLOCKWISE TO CLOSE (BLACK OPERATING NUT).

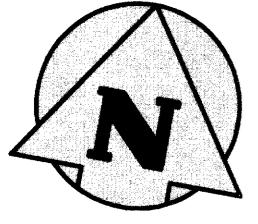
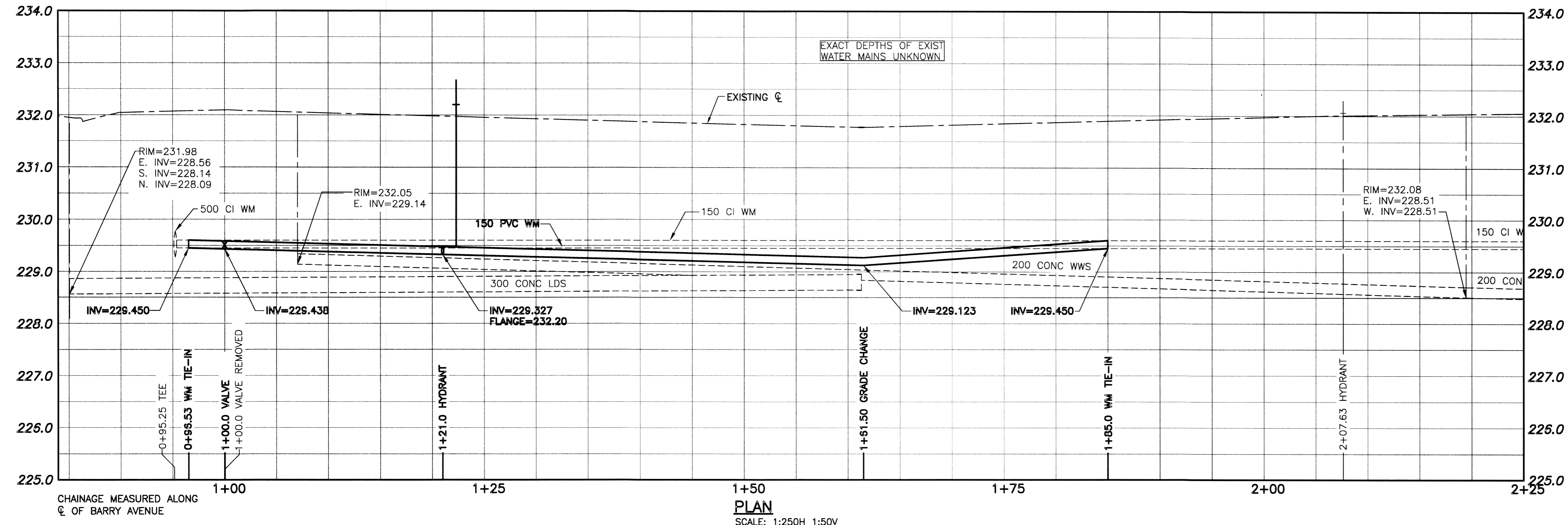

BARRY AVENUE

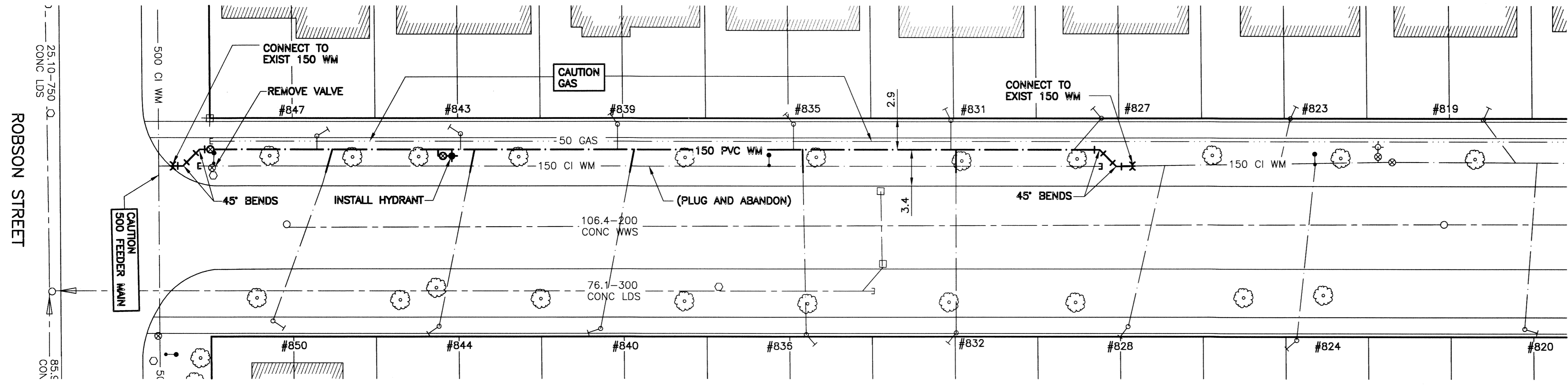

PLAN
SCALE: 1:250

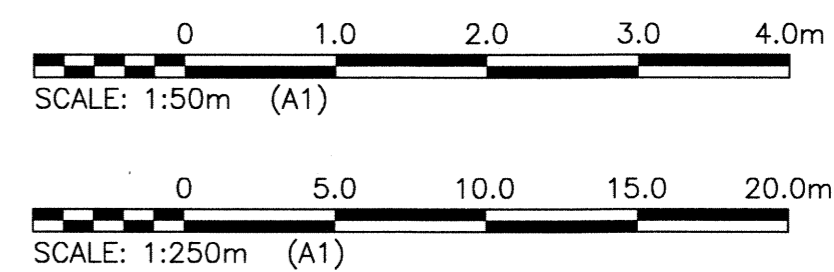

WARNING

1. NOTIFY THE GAS COMPANY OF THE PROPOSED LOCATION OF EXCAVATION.
2. TAKE PRECAUTION TO AVOID DAMAGE TO GAS COMPANY INSTALLATIONS.
3. SEE PROVINCIAL REGULATION 210/72 FOR DETAILS.

PROPERTY LIMITS DELINEATION

DELINEATION OF PROPERTY LIMITS AS SHOWN ON THIS DWG DOES NOT REPRESENT A "LEGAL SURVEY". KGS GROUP MAKES NO REPRESENTATION OR WARRANTY AS TO THE ACCURACY OF PROPERTY LIMITS DELINEATED ON THIS DWG, NOR ON THE DIMENSIONAL ACCURACY OF DWG FEATURES RELATIVE TO THOSE PROPERTY LIMITS.

METRIC

WHOLE NUMBERS INDICATE MILLIMETRES
DECIMALIZED NUMBERS INDICATE METRES



Certificates of Authorization
KGS Group
No. 245

EXISTING	LEGEND-PLAN	PROPOSED	EXISTING	LEGEND-PLAN	PROPOSED	EXISTING	LEGEND-PROFILE	PROPOSED
150 WM	WATER MAIN	150 WM	HYDRO	M.T.S.	150 WM	WATER MAIN	150 WM	WATER MAIN
Hydrant	HYDRANT	Hydrant	CONCRETE	CONCRETE	Hydrant	HYDRANT, VALVE	Hydrant	HYDRANT, VALVE
Valve	VALVE	Valve	ASPHALT	ASPHALT	Valve	LAND DRAINAGE SEWER	300 LDS	LAND DRAINAGE SEWER
300 LDS	LAND DRAINAGE SEWER	300 LDS	SIDEWALK	SIDEWALK	300 LDS	WASTE WATER SEWER	250 WWS	WASTE WATER SEWER
250 WWS	WASTE WATER SEWER	250 WWS	PLANNING	PLANNING	250 WWS	C PROFILE	250 WWS	C PROFILE
Manhole	MANHOLE	Manhole	PROPERTY LINE	PROPERTY LINE	Manhole	NORTH/WEST GUTTER	Manhole	NORTH/WEST GUTTER
Catch Basin	CATCH BASIN	Catch Basin	SURVEY BAR	SURVEY BAR	Catch Basin	SOUTH/EAST GUTTER	Catch Basin	SOUTH/EAST GUTTER
Curb Inlet	CURB INLET	Curb Inlet	GAS	GAS	Curb Inlet	N/W, S/E R'S	Curb Inlet	N/W, S/E R'S
Bend	BEND	Bend	CURB STOP	CURB STOP	Bend	N/W, S/E TOP/CURB	Bend	N/W, S/E TOP/CURB
Reducer	REDUCER	Reducer	TEE	TEE	Reducer		Reducer	

LOCATION APPROVED UNDERGROUND STRUCTURES		B.M. KGS BASE ELEV.	DWGS BASE ON C.S.R.S. NAD 83 SYSTEM UTM GRID.
SUPV. U/G STRUCTURES COMMITTEE	DATE		
NOTE: LOCATION OF UNDERGROUND STRUCTURES AS SHOWN ARE BASED ON THE BEST INFORMATION AVAILABLE BUT NO GUARANTEE IS GIVEN THAT ALL EXISTING UTILITIES ARE SHOWN OR THAT THE GIVEN LOCATIONS ARE EXACT. CONFIRMATION OF EXISTENCE AND EXACT LOCATION OF ALL SERVICES MUST BE OBTAINED FROM THE INDIVIDUAL UTILITIES BEFORE PROCEEDING WITH CONSTRUCTION.			
NO.	REVISIONS	DATE	BY
0	ISSUED FOR CONSTRUCTION	16/03/23	K2

DESIGNED BY		CHECKED BY	
MAT		BM	
DRAWN BY		APPROVED BY	
DMW		R20	
HOR. SCALE:	1:250	RELEASED FOR CONSTRUCTION:	
VERTICAL:	1:50		
DATE	16/03/15	DATE	16/03/23

ENGINEER'S SEAL	
PROVINCE OF MANITOBA	R.B. OFFMAN
REGISTERED PROFESSIONAL ENGINEER	24701
CONSULTANT DRAWING NO. 15-0107-022_C05	

THE CITY OF WINNIPEG
WATER AND WASTE DEPARTMENT

PROJECT TITLE: **2016 WATER MAIN RENEWALS CONTRACT 3**

SHEET **06** OF **11**

COMPUTER FILE NAME: **15-0107-022_C05**

CITY DRAWING NUMBER: **D-14265**

LOCATION: **BARRY AVENUE ROBSON STREET TO MIDDLEBLOCK EAST**

File Name: U:\PMS\15-0107-022\15-0107-022_CALL.dwg - Tab: C06 Plotted By: glcwen 16/03/22 [Tue 11:51am]