

File Name: U:\FMS\15-0107-022\15-0107-022_CALL.dwg - Tab: C09 Plotted By: glewew 16/03/22 [Tue 11:52am]

WATER SERVICE INFORMATION				
ADDRESS	SIZE & MATERIAL	CURB STOP MEASUREMENTS		CORP LOCATION
		SHORT	LONG	
326 MELROSE AVE E		5.94 EWHL		
327 MELROSE AVE E		1.22 WEHL		
329 MELROSE AVE E		2.13 WEHL		
332 MELROSE AVE E		2.19 NSHL		
333 MELROSE AVE E		10.36 NSHL		

CONSTRUCTION NOTES:

1. INSTALL WATER MAIN BY TRENCHLESS METHODS.
2. ALL MATERIALS TO CONFORM TO THE CITY OF WINNIPEG STANDARD CONSTRUCTION SPECIFICATIONS.
3. MINIMUM COVER TO TOP OF PROPOSED WATER MAIN IS 2.5m FROM STREET CENTERLINE.
4. INSTALL ALL HYDRANTS WITH FLANGE ELEVATION 50mm TO 150mm ABOVE FINISHED GRADE.
5. REPLACE ALL EXISTING LEAD SERVICES FROM THE PROPOSED WATER MAIN TO PROPERTY LINE.
6. BACKFILL UNDER OR WITHIN 1.0m OF PAVEMENTS, (INCLUDING SIDEWALKS) IS CLASS 3 BACKFILL EXCEPT AS NOTED. BACKFILL IN BOULEVARDS IS CLASS 5 BACKFILL.
7. WATER VALVES ARE CLOCKWISE TO CLOSE (BLACK OPERATING NUT).

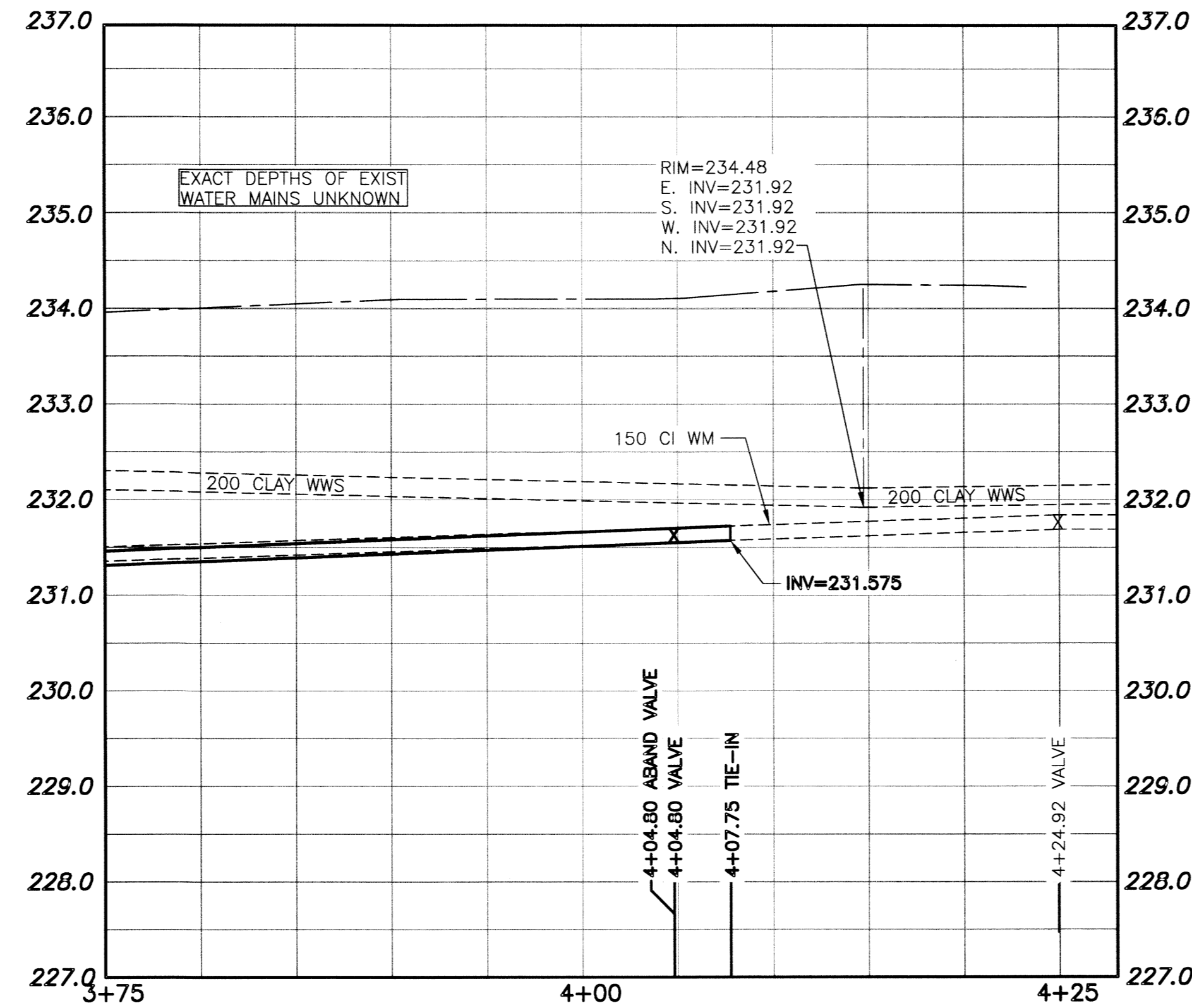

CHAINAGE MEASURED ALONG
C OF MELROSE AVENUE
PLAN
SCALE: 1:250H 1:50V

MATCH LINE
STA 3+75

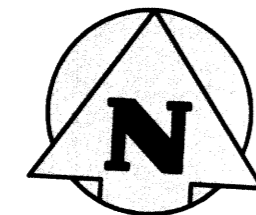

MELROSE AVENUE

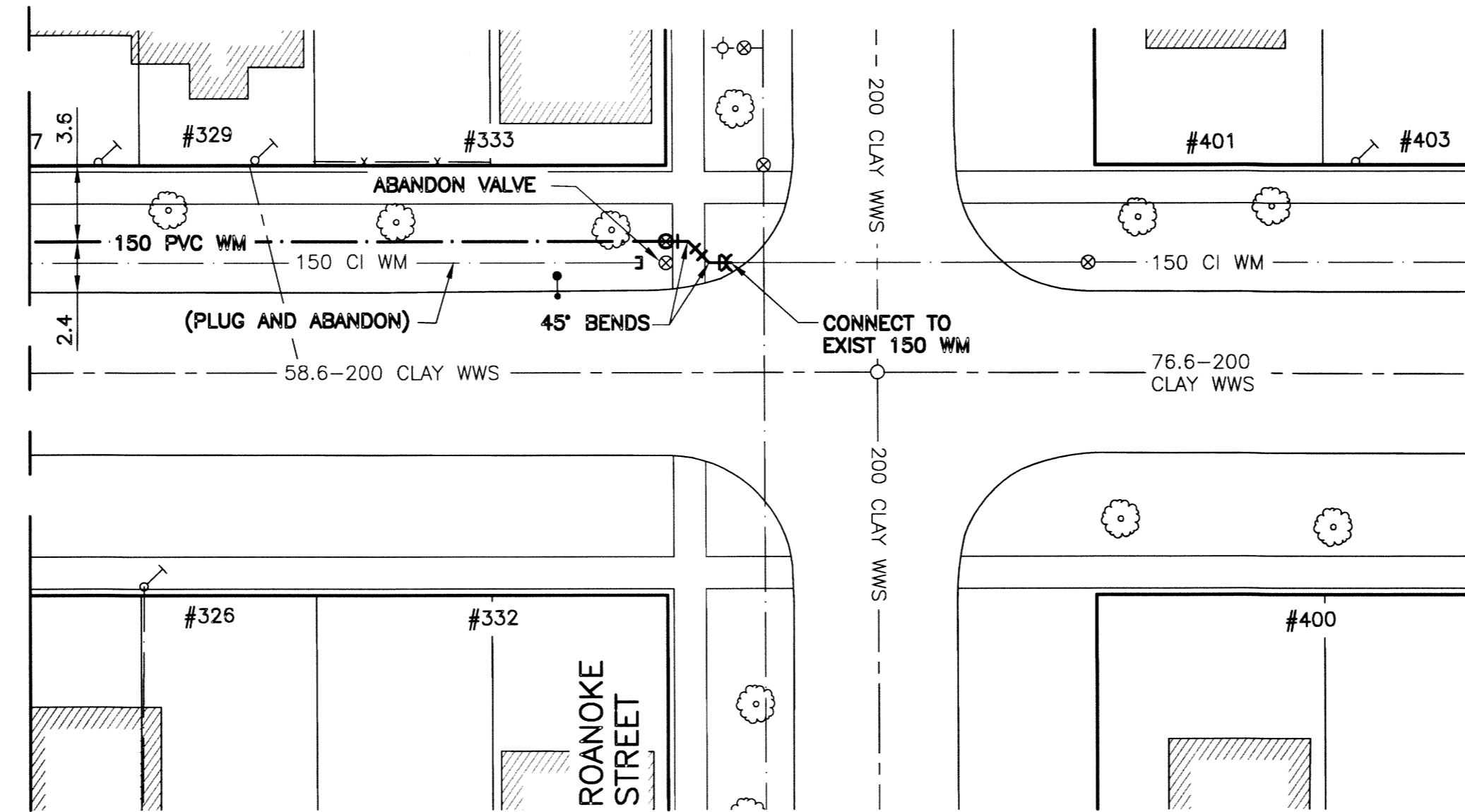

PLAN
SCALE: 1:250

WARNING

1. NOTIFY THE GAS COMPANY OF THE PROPOSED LOCATION OF EXCAVATION.
2. TAKE PRECAUTION TO AVOID DAMAGE TO GAS COMPANY INSTALLATIONS.
3. SEE PROVINCIAL REGULATION 210/72 FOR DETAILS.

PROPERTY LIMITS DELINEATION

DELINEATION OF PROPERTY LIMITS AS SHOWN ON THIS DWG DOES NOT REPRESENT A "LEGAL SURVEY". KGS GROUP MAKES NO REPRESENTATION OR WARRANTY AS TO THE ACCURACY OF PROPERTY LIMITS DELINEATED ON THIS DWG, NOR ON THE DIMENSIONAL ACCURACY OF DWG FEATURES RELATIVE TO THOSE PROPERTY LIMITS.

METRIC

WHOLE NUMBERS INDICATE MILLIMETRES
DECIMALIZED NUMBERS INDICATE METRES

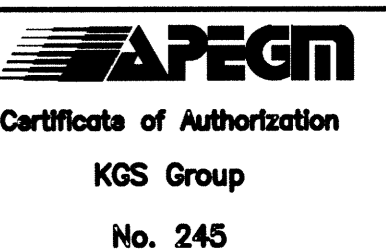
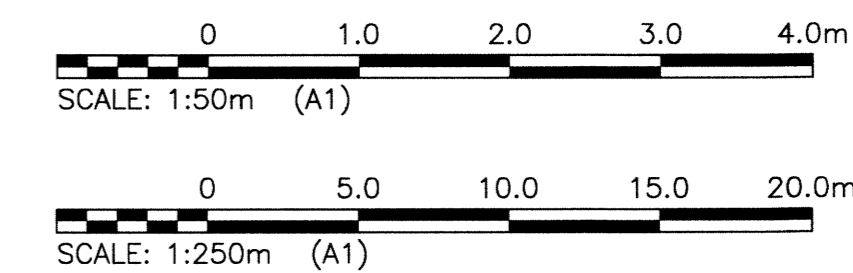

150 WM	WATER MAIN	150 WM	HYDRO	150 WM	WATER MAIN	150 WM
⊕	HYDRANT	⊕	M.T.S.	⊕	HYDRANT, VALVE	⊕
⊙	VALVE	⊙	CONCRETE	⊙	LAND DRAINAGE SEWER	⊙
⊖	LAND DRAINAGE SEWER	⊖	ASPHALT	⊖	WASTE WATER SEWER	⊖
⊗	WASTE WATER SEWER	⊗	SIDEWALK	⊗	C PROFILE	⊗
○	MANHOLE	○	PLANING	○	NORTH/WEST GUTTER	○
□	CATCH BASIN	□	PROPERTY LINE	□	SOUTH/EAST GUTTER	□
▽	CURB INLET	▽	SURVEY BAR	▽	N/W, S/E P'S	▽
∩	BEND	∩	GAS	∩	N/W, S/E TOP/CURB	∩
∪	REDUCER	∪	CURB STOP	∪		∪
⌋	TEE	⌋	TEE	⌋		⌋
EXISTING	LEGEND-PLAN	PROPOSED	EXISTING	LEGEND-PLAN	PROPOSED	EXISTING
				LEGEND-PROFILE	PROPOSED	

LOCATION APPROVED UNDERGROUND STRUCTURES

SUPV. U/G STRUCTURES COMMITTEE DATE
NOTE:
LOCATION OF UNDERGROUND STRUCTURES AS SHOWN ARE BASED ON THE BEST INFORMATION AVAILABLE BUT NO GUARANTEE IS GIVEN THAT ALL EXISTING UTILITIES ARE SHOWN OR THAT THE GIVEN LOCATIONS ARE EXACT. CONFIRMATION OF EXISTENCE AND EXACT LOCATION OF ALL SERVICES MUST BE OBTAINED FROM THE INDIVIDUAL UTILITIES BEFORE PROCEEDING WITH CONSTRUCTION.

B.M. KGS BASE ELEV.	DWGS BASE ON C.S.R.S. NAD 83 SYSTEM UTM GRID.
0	ISSUED FOR CONSTRUCTION 16/03/23
NO.	REVISIONS

KGS GROUP CONSULTING ENGINEERS	
DESIGNED BY: MAT	CHECKED BY: [Signature]
DRAWN BY: DMW	APPROVED BY: [Signature]
HOR. SCALE: 1:250	RELEASED FOR CONSTRUCTION: [Signature]
VERTICAL: 1:50	DATE: 16/03/15

ENGINEER'S SEAL
PROVINCE OF MANITOBA REGISTERED PROFESSIONAL ENGINEER R.E. OFFMAN Member 2471
CONSULTANT DRAWING NO. 15-0107-022_C09

THE CITY OF WINNIPEG WATER AND WASTE DEPARTMENT

PROJECT TITLE: **2016 WATER MAIN RENEWALS CONTRACT 3**

LOCATION: **MELROSE AVENUE KANATA STREET TO ROANOKE STREET STA 3+75 TO ROANOKE STREET**

SHEET 09 OF 11
COMPUTER FILE NAME: 15-0107-022_C09
CITY DRAWING NUMBER: **D-14268**