

Filename: U:\FMS\15-0107-022\15-0107-002\_CALL.dwg - Tab: C11 Plotted By: glewem 16/03/22 [Tue 11:53am]

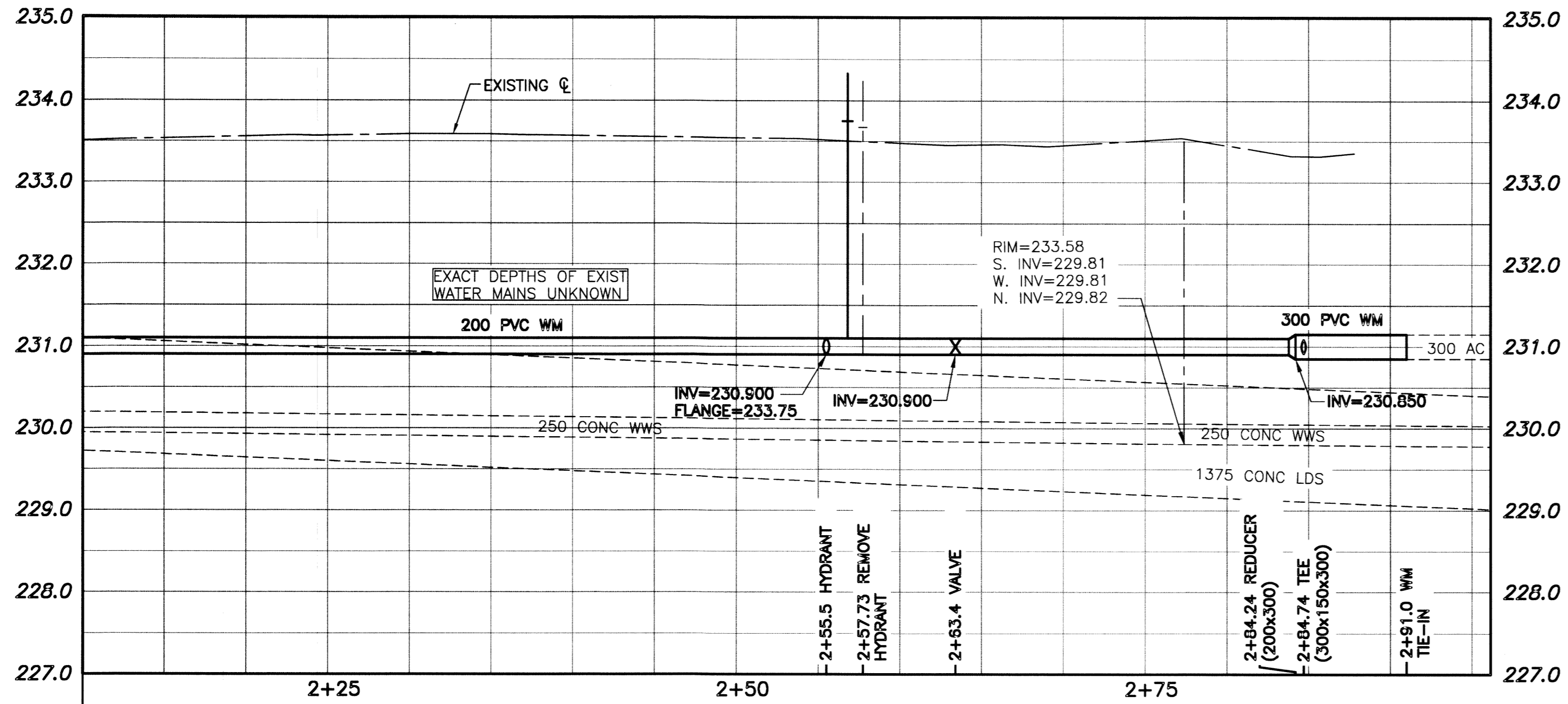

PLAN  
SCALE: 1:250H 1:50V  
CHAINAGE MEASURED ALONG  
CL OF WAYOTA STREET  
MATCH LINE  
STA 2+10

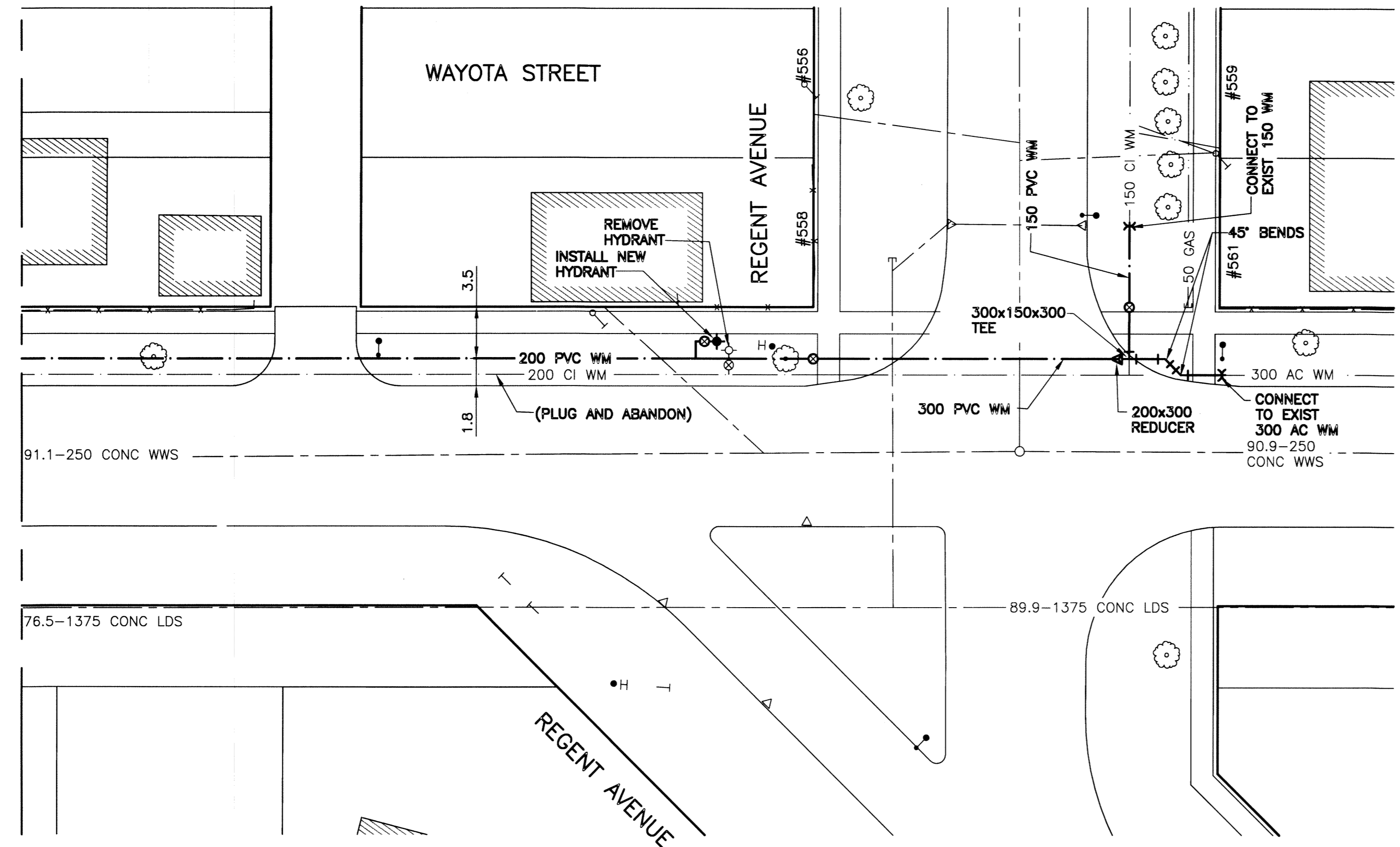

PLAN  
SCALE: 1:250

WATER SERVICE INFORMATION				
ADDRESS	SIZE & MATERIAL	CURB STOP MEASUREMENTS		CORP LOCATION
		SHORT	LONG	
558 REGENT AVE E		4.88 NSHL		

CONSTRUCTION NOTES:

1. INSTALL WATER MAIN BY TRENCHLESS METHODS.
2. ALL MATERIALS TO CONFORM TO THE CITY OF WINNIPEG STANDARD CONSTRUCTION SPECIFICATIONS.
3. MINIMUM COVER TO TOP OF PROPOSED WATER MAIN IS 2.5m FROM STREET CENTERLINE.
4. INSTALL ALL HYDRANTS WITH FLANGE ELEVATION 50mm TO 150mm ABOVE FINISHED GRADE.
5. REPLACE ALL EXISTING LEAD SERVICES FROM THE PROPOSED WATER MAIN TO PROPERTY LINE.
6. BACKFILL UNDER OR WITHIN 1.0m OF PAVEMENTS, (INCLUDING SIDEWALKS) IS CLASS 3 BACKFILL EXCEPT AS NOTED. BACKFILL IN BOULEVARDS IS CLASS 5 BACKFILL.
7. WATER VALVES ARE CLOCKWISE TO CLOSE (BLACK OPERATING NUT).

**WARNING**

1. NOTIFY THE GAS COMPANY OF THE PROPOSED LOCATION OF EXCAVATION.
2. TAKE PRECAUTION TO AVOID DAMAGE TO GAS COMPANY INSTALLATIONS.
3. SEE PROVINCIAL REGULATION 210/72 FOR DETAILS.

**PROPERTY LIMITS DELINEATION**

DELINEATION OF PROPERTY LIMITS AS SHOWN ON THIS DWG DOES NOT REPRESENT A "LEGAL SURVEY". KGS GROUP MAKES NO REPRESENTATION OR WARRANTY AS TO THE ACCURACY OF PROPERTY LIMITS DELINEATED ON THIS DWG, NOR ON THE DIMENSIONAL ACCURACY OF DWG FEATURES RELATIVE TO THOSE PROPERTY LIMITS.

**METRIC**

WHOLE NUMBERS INDICATE MILLIMETRES  
DECIMALIZED NUMBERS INDICATE METRES

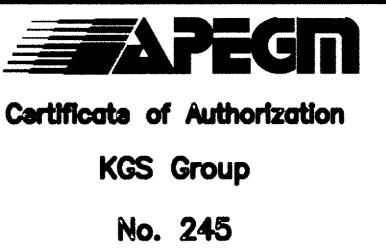
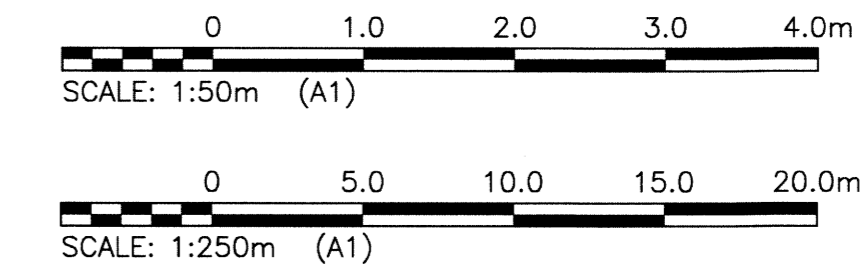

150 WM	WATER MAIN	150 WM	HYDRO	150 WM	WATER MAIN	150 WM
⊕	HYDRANT	⊕	M.T.S.	⊕	HYDRANT, VALVE	⊕
⊙	VALVE	⊙	CONCRETE	⊙	CONCRETE	⊙
⊖	MANHOLE	⊖	ASPHALT	⊖	ASPHALT	⊖
⊗	CATCH BASIN	⊗	SIDEWALK	⊗	SIDEWALK	⊗
∇	CURB INLET	∇	PLANING	∇	PLANING	∇
∩	BEND	∩	PROPERTY LINE	∩	PROPERTY LINE	∩
∪	REDUCER	∪	SURVEY BAR	∪	SURVEY BAR	∪
⊥	LEGEND-PLAN	⊥	GAS	⊥	GAS	⊥
⊥	LEGEND-PLAN	⊥	CURB STOP	⊥	CURB STOP	⊥
⊥	LEGEND-PLAN	⊥	TEE	⊥	TEE	⊥
⊥	LEGEND-PLAN	⊥	EXISTING	⊥	EXISTING	⊥
⊥	LEGEND-PLAN	⊥	PROPOSED	⊥	PROPOSED	⊥
⊥	LEGEND-PROFILE	⊥	EXISTING	⊥	EXISTING	⊥
⊥	LEGEND-PROFILE	⊥	PROPOSED	⊥	PROPOSED	⊥

**LOCATION APPROVED UNDERGROUND STRUCTURES**

SUPV. U/G STRUCTURES COMMITTEE DATE

NOTE:  
LOCATION OF UNDERGROUND STRUCTURES AS SHOWN ARE BASED ON THE BEST INFORMATION AVAILABLE BUT NO GUARANTEE IS GIVEN THAT ALL EXISTING UTILITIES ARE SHOWN OR THAT THE GIVEN LOCATIONS ARE EXACT. CONFIRMATION OF EXISTENCE AND EXACT LOCATION OF ALL SERVICES MUST BE OBTAINED FROM THE INDIVIDUAL UTILITIES BEFORE PROCEEDING WITH CONSTRUCTION.

B.M. KGS BASE ELEV. DWGS BASE ON C.S.R.S. NAD 83 SYSTEM UTM GRID.

NO.	REVISIONS	DATE	BY
0	ISSUED FOR CONSTRUCTION	16/03/23	RBD

**KGS GROUP CONSULTING ENGINEERS**

DESIGNED BY	MAT	CHECKED BY	RBD
DRAWN BY	DMW	APPROVED BY	RBD
HOR. SCALE:	1:250	RELEASED FOR CONSTRUCTION:	
VERTICAL:	1:50	DATE:	16/03/15

CONSULTANT DRAWING NO. 15-0107-022\_C11

**THE CITY OF WINNIPEG WATER AND WASTE DEPARTMENT**

PROJECT TITLE: 2016 WATER MAIN RENEWALS CONTRACT 3

WAYOTA STREET  
PANDORA AVENUE TO REGENT AVENUE  
STA 2+10 TO REGENT AVENUE

SHEET 11 OF 11  
COMPUTER FILE NAME: 15-0107-022\_C11  
CITY DRAWING NUMBER: D-14270