

NOTE: CHAINAGES SHOWN ARE ALONG N. P. OF SELKIRK AVENUE

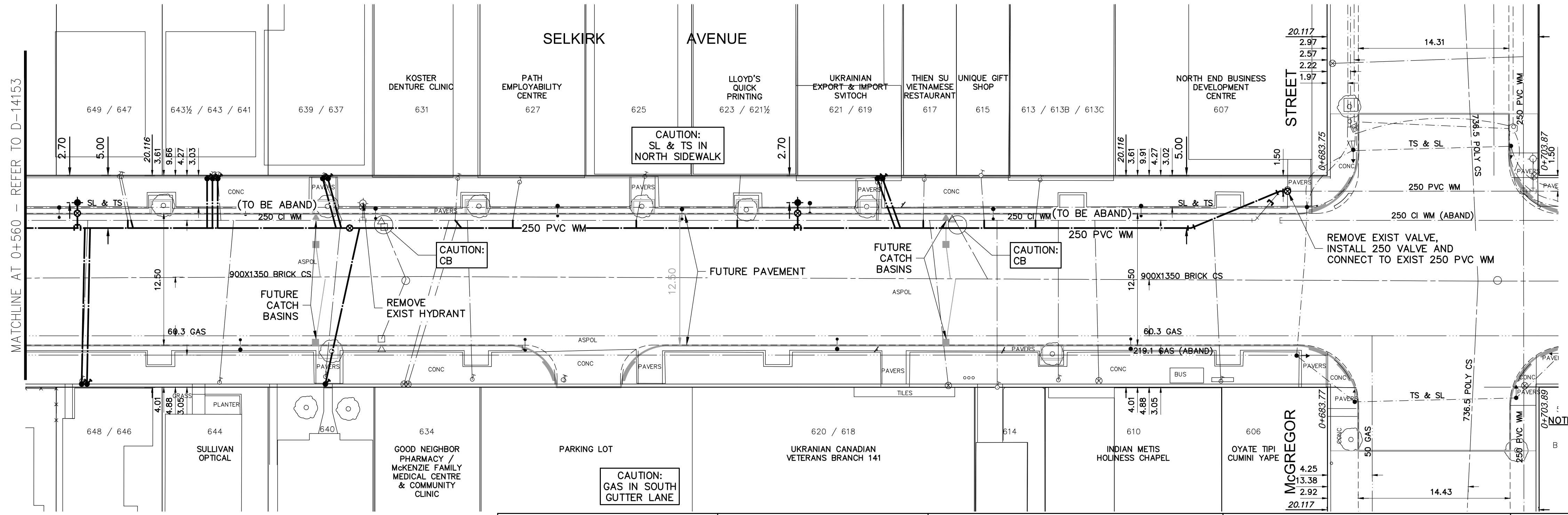
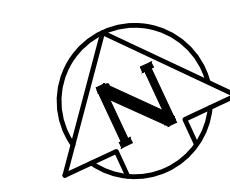

ADDRESS	SIZE (mm) MATERIAL (STREET)	SIZE (mm) MATERIAL (PROP.)	SHORT & LONG MEASUREMENT	CORPORATION LOCATION	REMARKS
649 SELKIRK AV	20 CU	20	66.4 EEL MCKENZIE 3.8 WEL 647	0.8 E OF S/C	#649
648 SELKIRK AV	12 LEAD	12	62.8 EEL OF MCKENZIE	0.6 E OF S/C	DBL WITH 646 RENEW TO PROPERTY
647 SELKIRK AV	20 CU	20	66.8 EEL MCKENZIE 3.5 WEL #647	0.8 E OF S/C	
646 SELKIRK AV	12 LEAD	12	62.8 EEL OF MCKENZIE	0.6 E OF S/C	DBL WITH 648 RENEW TO PROPERTY
644 SELKIRK AV	20 CU	20	76.8 EEL OF MCKENZIE	0.5 E OF S/C	REVERSE TAP
643 1/2 SELKIRK AV	- LEAD	12	75.7 EEL MCKENZIE	OPP S/C 641	TRIP WITH 643 & 641 RENEW TO PROPERTY
643 SELKIRK AV	- LEAD	12	4.9 WEL LL	OPP S/C 641	TRIP WITH 643 1/2 & 641 RENEW TO PROPERTY
641 SELKIRK AV	- LEAD	12	4.7 WEL LL	OPP S/C	TRIP WITH 643 1/2 & 643 RENEW TO PROPERTY
640 SELKIRK AV	12 LEAD	12	86.3 EEL OF MCKENZIE	1.2 E OF S/C	RENEW TO PROPERTY
639 SELKIRK AV	16 LEAD	12	87.8 EEL OF MCKENZIE	0.3 W OF S/C	BRANCH WITH 637 RENEW TO PROPERTY
637 SELKIRK AV	16 LEAD	12	87.8 EEL OF MCKENZIE	0.3 W OF S/C	BRANCH WITH 639 RENEW TO PROPERTY
634 SELKIRK AV	38 CU	38	93.6 EEL OF MCKENZIE	5.0 E OF S/C	
631 SELKIRK AV	20 CU	20	82.9 WWL MCGREGOR	OPP S/C	
627 SELKIRK AV	20 CU	20	77.4 WWL OF MCGREGOR	OPP S/C	REVERSE TAP
625 SELKIRK AV	20 CU	12	65.4 WWL MCGREGOR	0.3 W OF S/C	REVERSE TAP
623 SELKIRK AV	38 CU	38	55.8 WWL OF MCGREGOR	0.3 W OF S/C	
621 SELKIRK AV	20 CU	20	7.6 EWL BLDG	0.3 W OF S/C	DBL WITH 619 RENEW TO PROPERTY
619 SELKIRK AV	20 CU	12	7.2 EWL BLDG	OPP S/C	DBL WITH 621 RENEW TO PROPERTY
618 SELKIRK AV	50 CU	50	36.3 WWL MCGREGOR	1.5 W OF S/C	
617 SELKIRK AV	20 CU	20	36.4 WWL MCGREGOR	OPP S/C	REVERSE TAP
615 SELKIRK AV	20 CU	20	32.9 WWL MCGREGOR	0.3 E OF S/C	REVERSE TAP
614 SELKIRK AV	20 CU	20	31.4 WWL OF MCGREGOR	OPP S/C	
613 SELKIRK AV	25 CU	25	27.7 WWL OF MCGREGOR	OPP S/C	
610 SELKIRK AV	38 CU	38	21.9 WWL MCGREGOR	0.2 W OF S/C	
607 SELKIRK AV	38 CU	38	10.5 NWL OF SELKIRK	0.8 N OF S/C	SERVICED OFF MCGREGOR
606 SELKIRK AV	20 CU	12	11.2 WWL MCGREGOR	0.3 E OF S/C	

NOTE: REPLACE ALL EXISTING LEAD SERVICES FROM THE PROPOSED WATER MAIN TO PROPERTY LINE.
RECONNECT ALL OTHER SERVICES UNLESS NOTED.
LOCATION OF WATER SERVICES SHOWN ON DRAWINGS ARE APPROXIMATE.
THE CONTRACTOR SHALL FIELD LOCATE ALL WATER SERVICES PRIOR TO CONSTRUCTION.

ALL VALVES TO BE COUNTER-CLOCKWISE TO CLOSE (RED OPERATING NUT)

METRIC
WHOLE NUMBERS INDICATE MILLIMETRES
DECIMALIZED NUMBERS INDICATE METRES

AECOM
Certificate of Authorization
AECOM Canada Ltd.
No. 4671 Date: 16/01/27

WARNING
IF POWER EQUIPMENT OR EXPLOSIVES ARE TO BE USED FOR EXCAVATION ON THIS PROJECT THE CONTRACTOR MUST:
1) NOTIFY THE GAS COMPANY OF THE PROPOSED LOCATION OF EXCAVATION.
2) TAKE PRECAUTION TO AVOID DAMAGE TO GAS COMPANY INSTALLATIONS.
SEE PROVINCIAL REGULATION 21072 FOR DETAILS

LOCATION APPROVED UNDERGROUND STRUCTURES
SUPV. U/G STRUCTURES COMMITTEE DATE
NOTE: LOCATION OF UNDERGROUND STRUCTURES AS SHOWN ARE BASED ON THE BEST INFORMATION AVAILABLE BUT NO GUARANTEE IS GIVEN THAT ALL EXISTING UTILITIES ARE SHOWN OR THAT THE GIVEN LOCATIONS ARE EXACT. CONFIRMATION OF EXISTENCE AND EXACT LOCATION OF ALL SERVICES MUST BE OBTAINED FROM THE INDIVIDUAL UTILITIES BEFORE PROCEEDING WITH CONSTRUCTION.

B.M. 26-020
ELEV. 232.072m
CONSTRUCTION COMPLETION DATE:
N.W. Cor. Selkirk Ave. and Powers St. Brass Plug in Conc. Pile, 2.4m E. of W. Selkirk Ave. and 0.3m N. of N.E. of Selkirk Ave.

NO.	ISSUED FOR	DATE	BY
0	ISSUED FOR TENDER	16/01/27	GSK
A	ISSUED FOR REVIEW	16/01/14	GSK

AECOM

DESIGNED BY: HC
CHECKED BY: GSK
DRAWN BY: JP
APPROVED BY: AN
SCALE: HORIZONTAL 1:250
VERTICAL 1:50
PLOT DATE: 2016 01 27

ENGINEER'S SEAL
PROVINCE OF MANITOBA
K.W. FITCHETT
REGISTERED PROFESSIONAL ENGINEER

THE CITY OF WINNIPEG
WATER AND WASTE DEPARTMENT
ENGINEERING DIVISION

SELKIRK AVENUE
ARLINGTON STREET TO SALTER STREET
PAVEMENT RECONSTRUCTION
2015 WATER MAIN RENEWAL CONTRACT A-1 MCGREGOR ST TO SALTER ST
57.5m EAST OF MCKENZIE ST. TO MCGREGOR ST.

SHEET 6 OF 6
CITY DRAWING NUMBER
D-14154

CONSULTANT DRAWING NUMBER
C-0005