

CHAINAGE ALONG C OF PUBLIC RIGHT-OF-WAY  
**NEWMAN STREET / BASSWOOD PLACE**

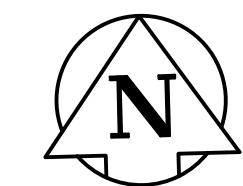

**NOTES:**

- ISOLATE EXISTING HYDRO POLES AS DIRECTED BY CONTRACT ADMINISTRATOR
- RENEW EXISTING APPROACHES AS DIRECTED BY CONTRACT ADMINISTRATOR
- ADDITIONAL EXCAVATION AND INSTALLATION OF SUBGRADE GEOGRID TO BE DETERMINED BY CONTRACT ADMINISTRATOR
- ADJUSTMENTS TO PROPOSED CROSSFALL, WHERE REQUIRED, ARE TO BE DETERMINED BY CONTRACT ADMINISTRATOR TO SUIT EXISTING DRIVEWAYS, APPROACHES, ETC.
- MODIFIED BARRIER CURB TO BE USED FOR CURB RENEWAL AT RADII AS DIRECTED BY CONTRACT ADMINISTRATOR
- EX. MANHOLES, CATCHBASINS, GATE VALVES AND OTHER APPURTENANCES TO BE ADJUSTED AS DIRECTED BY CONTRACT ADMINISTRATOR

FOR CONTINUATION SEE  
 DWG 151-13889-00-25

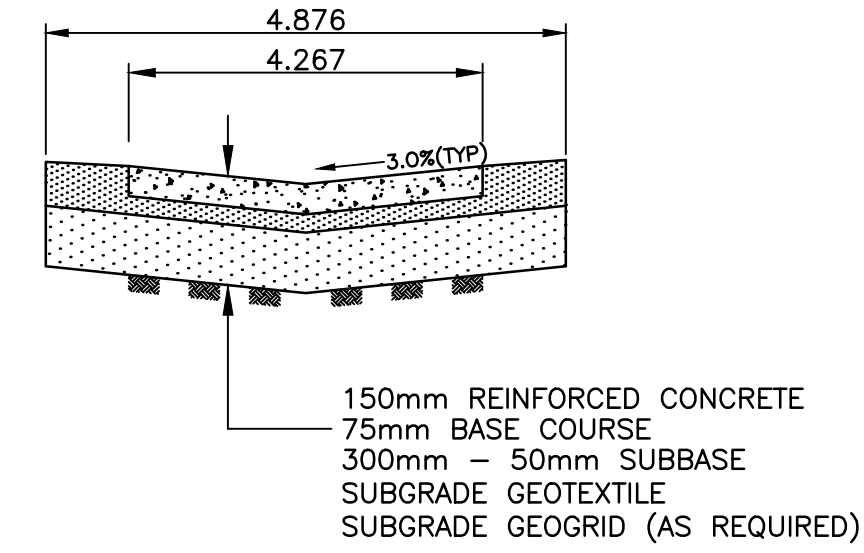
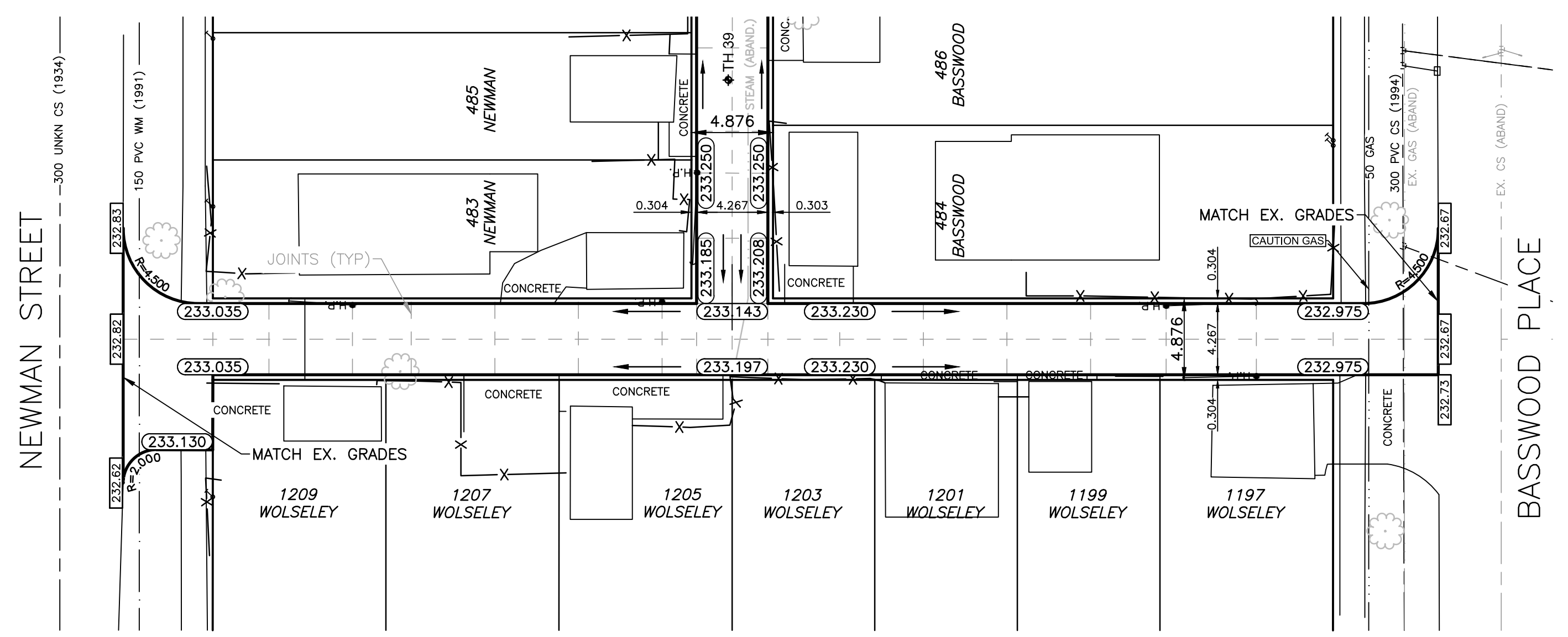

**TYPICAL ALLEY CROSS SECTION**  
 N.T.S.

"Description of property limits, and existing and/or proposed features relative to these limits as shown on this drawing do not represent a Legal Survey. WSP makes no representation or guarantee that the property limit information is accurate. WSP accepts no responsibility for damages, if any, suffered by any third party as a result of decisions made or actions based on this drawing."

---	WATERMAIN	---	M.T.S.	---	WATERMAIN
⊕	HYDRANT	⊕	TRAFFIC SIGNAL	⊕	VALVE
⊗	VALVE	⊗	CONCRETE/ASPHALT	⊗	LAND DRAINAGE SEWER
⊙	CURB STOP	⊙	SIDEWALK	⊙	WASTE WATER SEWER
---	WASTE WATER SEWER	---	CURB RAMP	---	CENTERLINE
---	LAND DRAINAGE SEWER	---	PROPERTY LINE	---	SOUTH & EAST GUTTER
---	C.B. LEAD	---	ELEVATIONS	---	NORTH & WEST GUTTER
○	MANHOLE	○	TEST HOLE LOCATION	⬢	S. & E. PAD/GARG.
□	CATCH BASIN	□		△	N. & W. PAD/GARG.
---	GAS	---			
---	HYDRO	---			
---	EXISTING	---	LEGEND - PLAN	---	EXISTING
---	LEGEND - PLAN	---	PROPOSED	---	LEGEND - PROFILE
---	PROPOSED	---	EXISTING	---	PROPOSED

**LOCATION APPROVED UNDERGROUND STRUCTURES**

SUPV. U/G STRUCTURES DATE COMMITTEE

NOTE:  
 LOCATION OF UNDERGROUND STRUCTURES AS SHOWN ARE BASED ON THE BEST INFORMATION AVAILABLE BUT NO GUARANTEE IS GIVEN THAT ALL EXISTING UTILITIES ARE SHOWN OR THAT THE GIVEN LOCATIONS ARE EXACT. CONFIRMATION OF EXISTENCE AND EXACT LOCATION OF ALL SERVICES MUST BE OBTAINED FROM THE INDIVIDUAL UTILITIES BEFORE PROCEEDING WITH CONSTRUCTION.

B.M. - CWMB ZONE 37 - NO. 44  
 ELEV. - 233.296

NO.	REVISIONS	DATE	BY
2	ISSUED FOR TENDER	04/11/16	AB
1	CON REVIEW & APPROVAL	03/07/16	RH

**WSP** 1600 BUFFALO PLACE  
 WINNIPEG, MB, R3T 6B8  
 PHONE: 204-477-6650  
 FAX: 204-474-2864  
 WWW.WSPGROUP.COM

DESIGNED BY: R.H. CHECKED BY: S.M.  
 DRAWN BY: R.H. APPROVED BY: I.McK.  
 HOR. SCALE: 1:250  
 VERT. SCALE: 1:25  
 RELEASED FOR CONSTRUCTION

DATE: JANUARY 2016

ENGINEERS SEAL

CONSULTANT DRAWING NO.  
 151-13889-00-24

**THE CITY OF WINNIPEG**  
 PUBLIC WORKS DEPARTMENT

**2016 ALLEY RECONSTRUCTION - CONTRACT 2**  
 NEWMAN STREET/BASSWOOD PLACE ALLEY

SOUTH TEE FROM NEWMAN STREET TO BASSWOOD PLACE  
 CONCRETE PAVEMENT

CITY DRAWING NO.  
 SHEET 1 OF 4  
 317-2016

