

NOTES:

1. REFER TO DRAWING 1-0127A-B0001 FOR GENERAL NOTES.

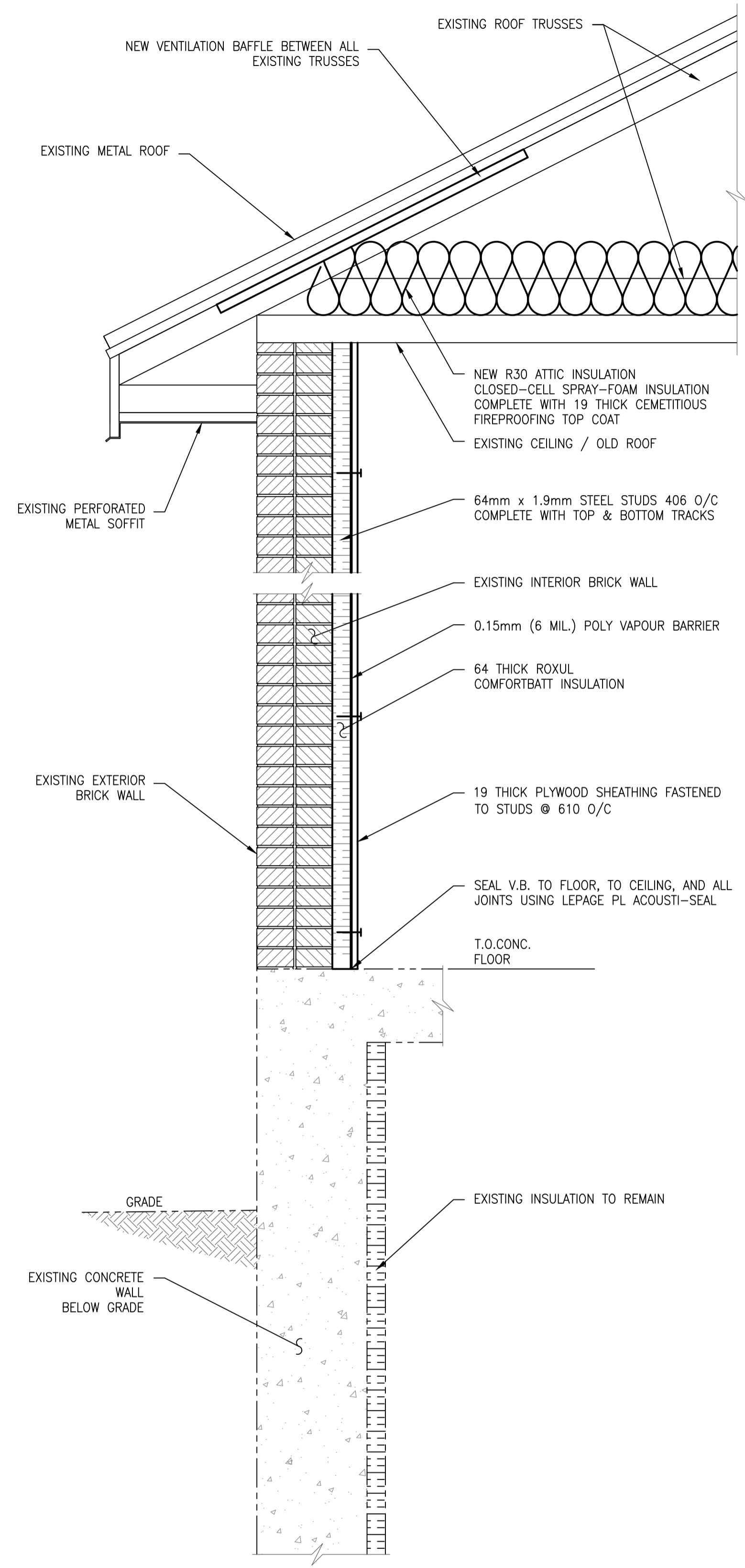

A WALL DETAIL
SCALE: N.T.S.

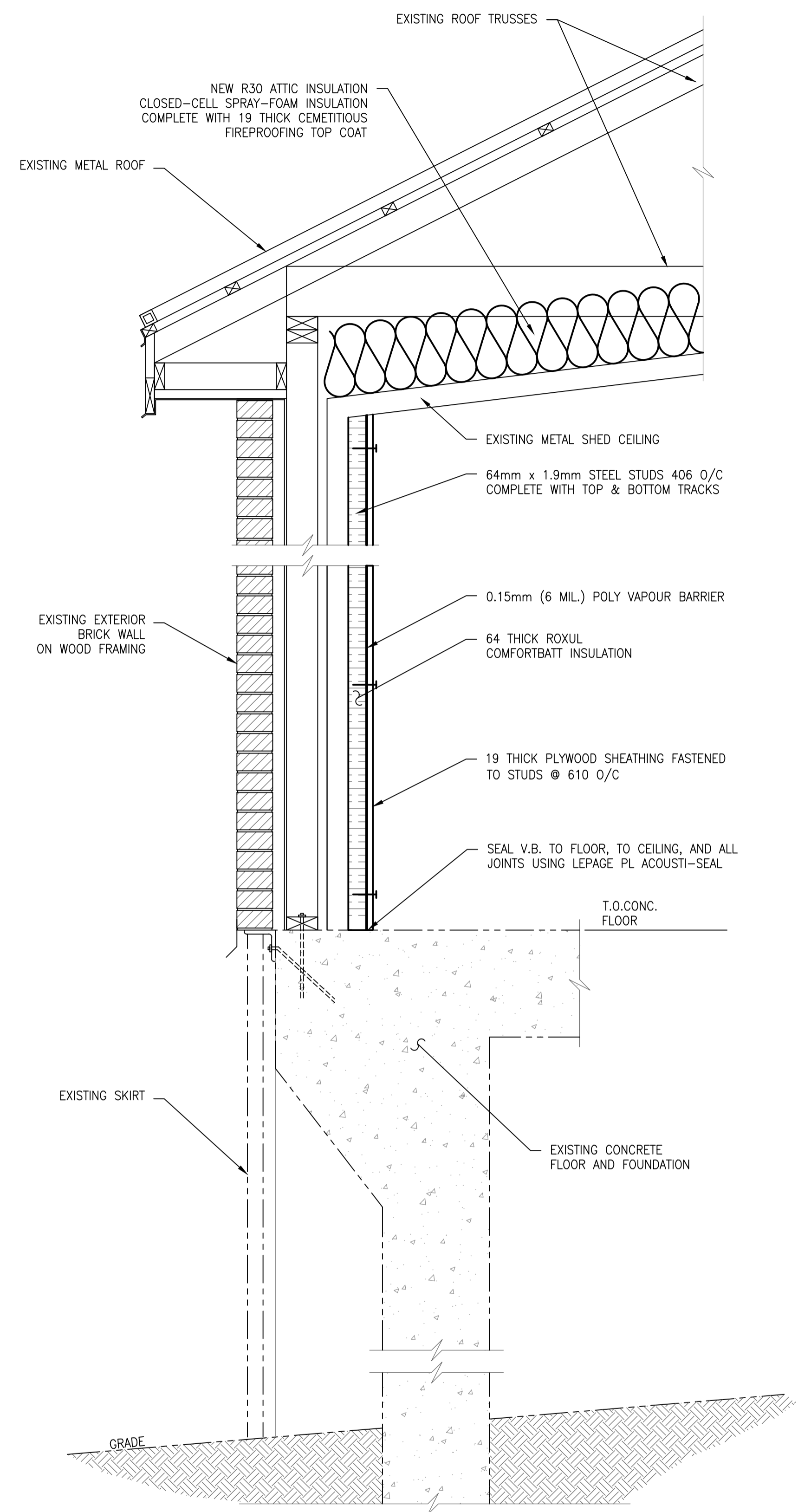

B WALL DETAIL
SCALE: N.T.S.

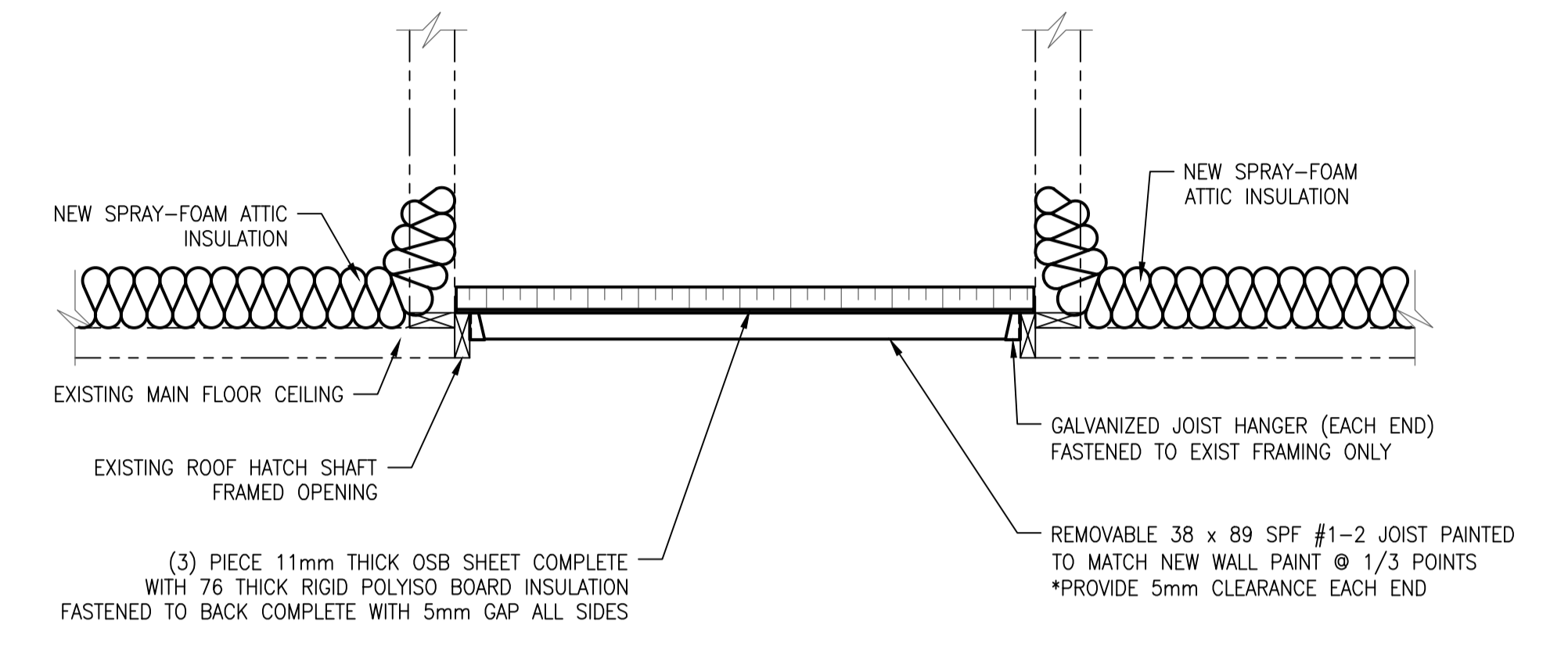

C HATCH CEILING COVER
SCALE: N.T.S.

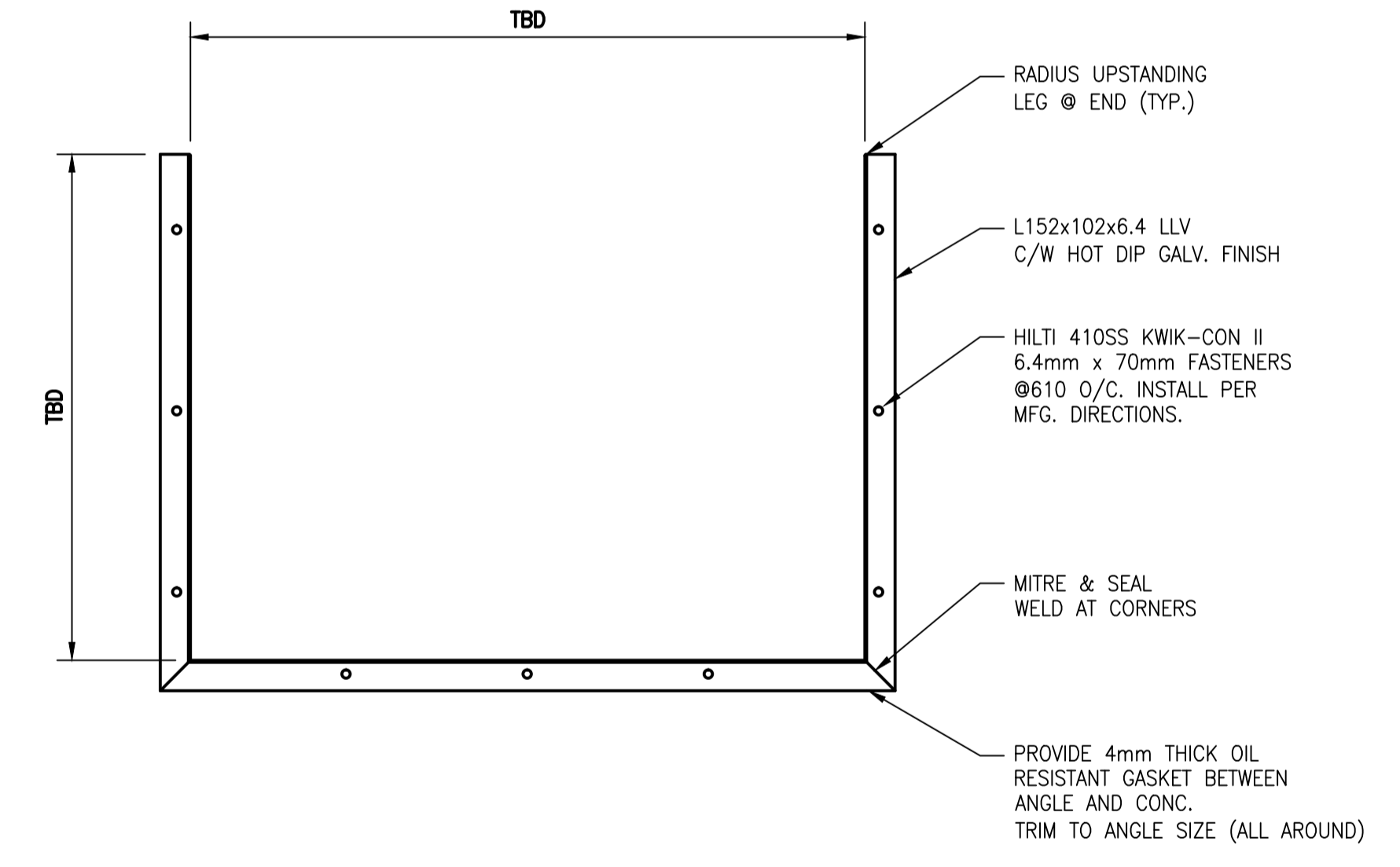

D PLAN - OIL CONTAINMENT BARRIER ANGLE
SCALE: N.T.S.

LAST SAVE: 2016/05/05 - 2:32pm
PATH: M:\632354\ENGR\425TR\DD - General DWG\1-0127A-B0002.dwg

1-0127A-B0001	ARCHITECTURAL PLAN, NEW WORK
DRAWING NUMBER	REFERENCE DRAWINGS



00	ISSUED FOR TENDER, BID OP. 331-2016	2016/05/04	KK	DC
NO.	REVISIONS	DATE	DESIGN	CHECK

 SNC-LAVALIN INC. 148 Nature Park Way Winnipeg, MB, Canada R3P 0X7 204-786-8080		ENGINEER'S SEAL ORIGINAL DRAWING SEALED BY: K. KOTYK SNC-LAVALIN INC. MEMBER # 21950 2016/05/04 REV. 00
DESIGNED BY: K. KOTYK DRAWN BY: M.J. PERSSON SCALE: NTS DATE: 2016/02/12 CONSULTANT NO.:	CHECKED BY: D. COATES APPROVED BY: I. PARKINSON ISSUED FOR CONSTRUCTION BY: K. ZUREK DATE: 2016/05/06	

 THE CITY OF WINNIPEG WATER AND WASTE DEPARTMENT	
COCKBURN FLOOD AND WASTEWATER PUMPING STATION 2016 UPGRADES ARCHITECTURAL SECTIONS NEW WORK	
CITY DRAWING NUMBER 1-0127A-B0002	SHEET 001
REV. 00	SIZE A1