

NOTE: CHAINAGES SHOWN ARE ALONG E. P/L OF WOODLAWN ST.

WATER SERVICE INFORMATION

ADDRESS	SIZE (mm) MATERIAL (STREET)	SIZE (mm) MATERIAL (PROP.)	SHORT & LONG MEASUREMENT	CORP. LOCATION	REMARKS
331 ALBANY ST. RESIDENTIAL	-	-	0.4 SNBL	-	RECONNECT SERVICE
335 ALBANY ST. RESIDENTIAL	-	-	1.6 SNBL	-	RECONNECT SERVICE
337 ALBANY ST. RESIDENTIAL	-	-	2.4 NNBL	-	RECONNECT SERVICE
338 ALBANY ST. RESIDENTIAL	-	-	24.4 FROM HYD	-	RECONNECT SERVICE
339 ALBANY ST. RESIDENTIAL	-	-	0.8 SNBL	-	RECONNECT SERVICE
341 ALBANY ST. RESIDENTIAL	-	-	35.1 FROM HYD	-	RECONNECT SERVICE
343 ALBANY ST. RESIDENTIAL	-	-	3.4 NSBL	-	RECONNECT SERVICE
344 ALBANY ST. RESIDENTIAL	-	-	50.3 N 1ST HYD S NESS	OPP OF S/C	RECONNECT SERVICE
345 ALBANY ST. RESIDENTIAL	-	-	1.0 SNBL	-	RECONNECT SERVICE
346 ALBANY ST. RESIDENTIAL	-	-	53.3 FROM HYD	-	RECONNECT SERVICE
347 ALBANY ST. RESIDENTIAL	-	-	1.2 NNBL	-	RECONNECT SERVICE
348 ALBANY ST. RESIDENTIAL	-	-	15.2 SSL NESS	OPP OF S/C	RECONNECT SERVICE
349 ALBANY ST. RESIDENTIAL	-	-	14.9 SSL NESS	OPP OF S/C	RECONNECT SERVICE
1970 NESS AVE. INSTITUTIONAL	-	-	2.2 SNBL	OPP OF S/C	-
	-	-	2.5 SNLL	OPP OF S/C	-
	-	-	48.4 SSL OF NESS	-	RECONNECT SERVICE INSTALL 150 VALVE

* SERVICES TO BE RENEWED TO P/L ALL OTHERS TO BE RECONNECTED

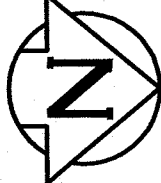

ALBANY STREET

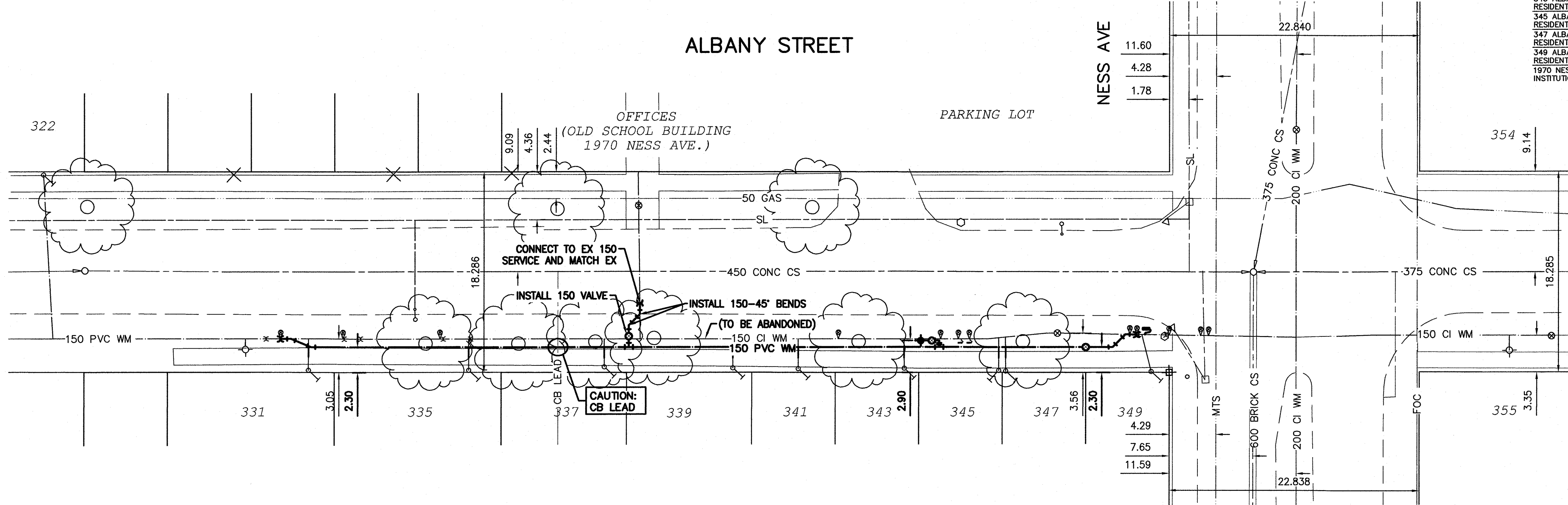

NOTE: ALL GATE VALVES TO BE COUNTER-CLOCKWISE TO CLOSE (RED OPERATING NUT)

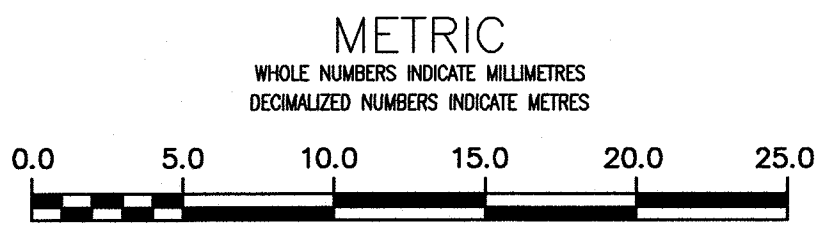

WARNING
IF POWER EQUIPMENT OR EXPLOSIVES ARE TO BE USED FOR EXCAVATION ON THIS PROJECT THE CONTRACTOR MUST:
1) NOTIFY THE GAS COMPANY OF THE PROPOSED LOCATION OF EXCAVATION.
2) TAKE PRECAUTION TO AVOID DAMAGE TO GAS COMPANY INSTALLATIONS.
SEE PROVINCIAL REGULATION 210/72 FOR DETAILS

LOCATION APPROVED
UNDERGROUND STRUCTURES
SUPV. U/G STRUCTURES COMMITTEE DATE
NOTE:
LOCATION OF UNDERGROUND STRUCTURES AS SHOWN ARE BASED ON THE BEST INFORMATION AVAILABLE BUT NO GUARANTEE IS GIVEN THAT ALL EXISTING UTILITIES ARE SHOWN OR THAT THE GIVEN LOCATIONS ARE EXACT. CONFIRMATION OF EXISTENCE AND EXACT LOCATION OF ALL UTILITIES MUST BE OBTAINED FROM THE INDIVIDUAL UTILITIES BEFORE PROCEEDING WITH CONSTRUCTION.

B.M. 38-62 ELEV. 234.664m	829680 - N.E. Cor. Ness Ave. & Schofield St. Tht. on top of 0.05 m dia. x 2.4 m iron pipe, in Valve Box, 2.1 m S. of N.E. Ness Ave. & 1.9 m W. of E.L. Schofield St.		
0	ISSUED FOR TENDER	16/04/21	R.S.
NO.	REVISIONS	DATE	BY

Stantec

DESIGNED BY: J.H. CHECKED BY: R.S.
DRAWN BY: J.H. APPROVED BY: R.S.

SCALE:
HORIZONTAL 1:250
VERTICAL 1:50

DATE: 2016 04 21
PLOT DATE: 2016 04 21

ENGINEER'S SEAL
PROVINCE OF MANITOBA
APR 21/16
R.M. SHERLOCK
REGISTERED PROFESSIONAL ENGINEER
MEMBER 24045
CONSULTANT DRAWING NUMBER
C-210

THE CITY OF WINNIPEG
WATER AND WASTE DEPARTMENT
ENGINEERING DIVISION

2016 WATERMAIN RENEWALS
CONTRACT 6
ALBANY STREET
90 SSL OF NESS AVENUE TO
NESS AVENUE

SHEET 11 OF 14
CITY DRAWING NUMBER
D-14357