

File Name: U:\FMS\16-0107-002\16-0107-002_CALL.dwg - Tab: C02 Plotted By: glcwen 16/04/26 [Tue 10:25am]

WATER SERVICE INFORMATION			
ADDRESS	SIZE & MATERIAL	CURB STOP MEASUREMENTS	CORP LOCATION
		SHORT	LONG
342 HAWTHORNE AVE	3.66 EWHL		
343 HAWTHORNE AVE	4.88 EWHL		
346 HAWTHORNE AVE	2.00 EWHL	3.00 EWLL	
347 HAWTHORNE AVE	1.37 WEHL		
350 HAWTHORNE AVE	3.51 EWHL		
350 HAWTHORNE AVE	2.13 WEHL		
354 HAWTHORNE AVE	2.00 EWHL	3.10 EWLL	
358 HAWTHORNE AVE	3.66 EWHL		
362 HAWTHORNE AVE	1.83 EWHL		
366 HAWTHORNE AVE	3.66 EWHL		
367 HAWTHORNE AVE	30.33 EWHL	33.22 EWPL	27.74 E OF HYD
367 HAWTHORNE AVE	2.13 EWHL	5.33 EWPL	
367 HAWTHORNE AVE	50 CU	5.79 WEHL	99.97 EWPL
370 HAWTHORNE AVE	4.42 WEHL		
374 HAWTHORNE AVE	3.96 WEHL		

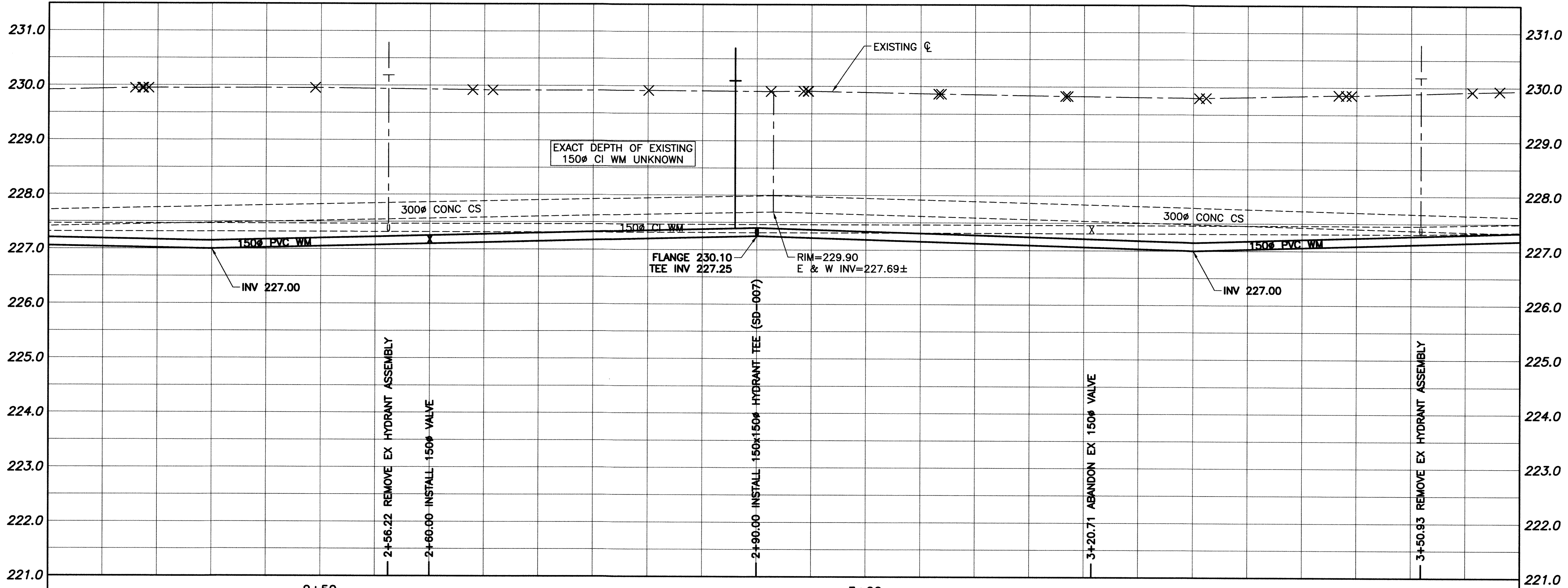

PROFILE
SCALE: 1:250H 1:50V

HAWTHORNE AVENUE

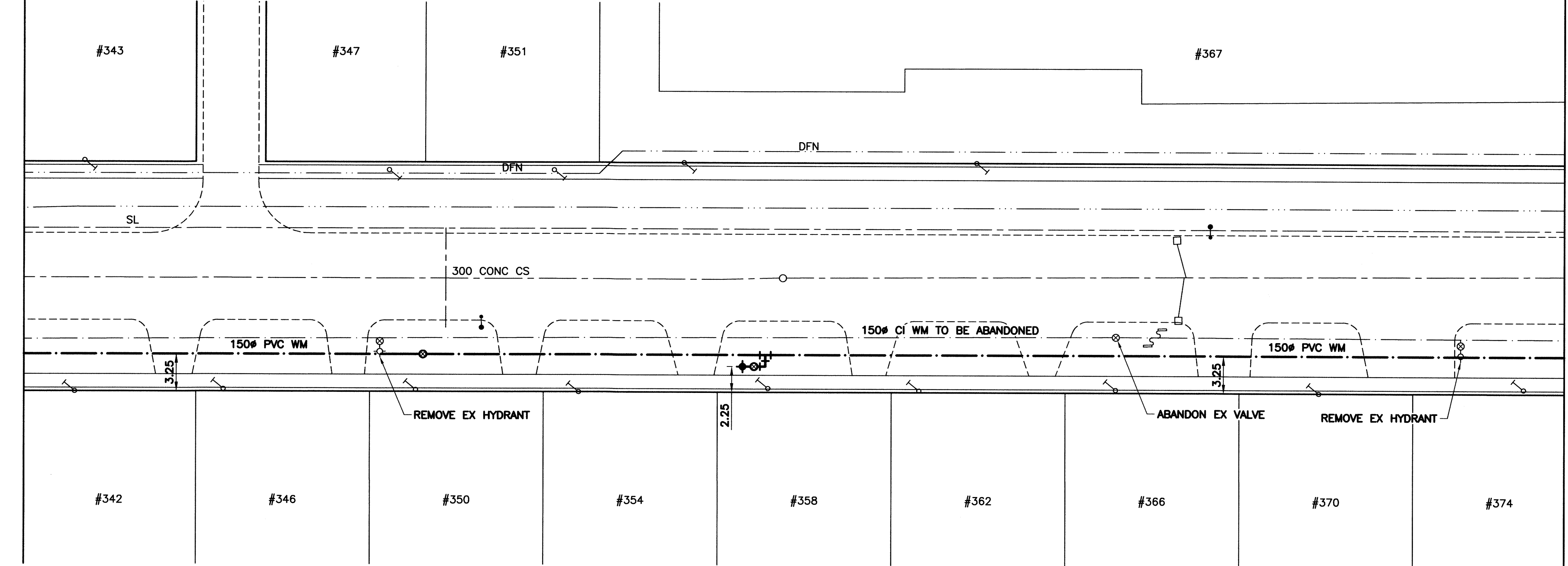

PLAN
SCALE: 1:250

- CONSTRUCTION NOTES:**
1. INSTALL WATER MAIN BY TRENCHLESS METHODS.
 2. ALL MATERIALS TO CONFORM TO THE CITY OF WINNIPEG STANDARD CONSTRUCTION SPECIFICATIONS.
 3. MINIMUM COVER TO TOP OF PROPOSED WATER MAIN IS 2.5m FROM STREET CENTERLINE.
 4. INSTALL ALL HYDRANTS WITH FLANGE ELEVATION 50mm TO 150mm ABOVE FINISHED GRADE.
 5. REPLACE ALL EXISTING LEAD SERVICES FROM THE PROPOSED WATER MAIN TO PROPERTY LINE.
 6. BACKFILL UNDER OR WITHIN 1.0m OF PAVEMENTS, (INCLUDING SIDEWALKS) IS CLASS 3 BACKFILL EXCEPT AS NOTED. BACKFILL IN BOULEVARDS IS CLASS 5 BACKFILL.
 7. WATER VALVES ARE CLOCKWISE TO CLOSE (BLACK OPERATING NUT).

WARNING

1. NOTIFY THE GAS COMPANY OF THE PROPOSED LOCATION OF EXCAVATION.
2. TAKE PRECAUTION TO AVOID DAMAGE TO GAS COMPANY INSTALLATIONS.
3. SEE PROVINCIAL REGULATION 210/72 FOR DETAILS.

PROPERTY LIMITS DELINEATION

DELINEATION OF PROPERTY LIMITS AS SHOWN ON THIS DWG DOES NOT REPRESENT A "LEGAL SURVEY". KGS GROUP MAKES NO REPRESENTATION OR WARRANTY AS TO THE ACCURACY OF PROPERTY LIMITS DELINEATED ON THIS DWG, NOR ON THE DIMENSIONAL ACCURACY OF DWG FEATURES RELATIVE TO THOSE PROPERTY LIMITS.

METRIC

WHOLE NUMBERS INDICATE MILLIMETRES
DECIMAL NUMBERS INDICATE METRES

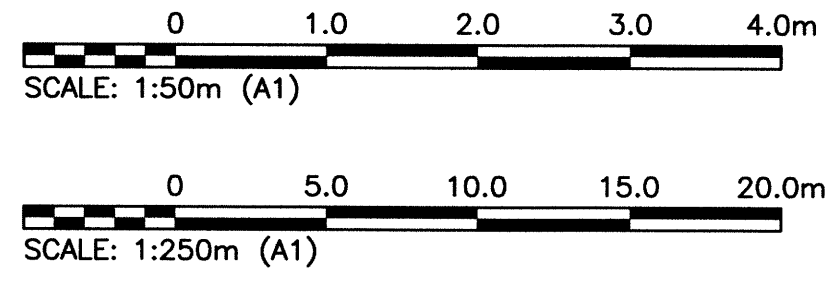

APEGN
Certificate of Authorization
KGS Group
No. 245

SYMBOL	DESCRIPTION	SYMBOL	DESCRIPTION	SYMBOL	DESCRIPTION	SYMBOL	DESCRIPTION
○	150 WM HYDRANT	○	HYDRO M.T.S.	○	150 WM HYDRANT VALVE	○	WATER MAIN
⊕	VALVE	□	CONCRETE	⊕	300 LBS LAND DRAINAGE SEWER	⊕	LAND DRAINAGE SEWER
⊖	300 LBS LAND DRAINAGE SEWER	⊖	ASPHALT	⊖	250 WWS WASTE WATER SEWER	⊖	WASTE WATER SEWER
○	250 WWS WASTE WATER SEWER	○	SIDWALK	○	MANHOLE	○	MANHOLE
□	CATCH BASIN	□	PLANNING	□	CATCH BASIN	□	CATCH BASIN
▽	CURB INLET	▽	PROPERTY LINE	▽	CURB INLET	▽	CURB INLET
∩	BEND	∩	SURVEY BAR	∩	BEND	∩	BEND
∩	REDUCER	∩	GAS	∩	REDUCER	∩	REDUCER
∩	LEGEND-PLAN	∩	CURB STOP	∩	LEGEND-PLAN	∩	LEGEND-PLAN
∩	PROPOSED	∩	TEE	∩	PROPOSED	∩	PROPOSED
∩	EXISTING	∩	LEGEND-PROFILE	∩	EXISTING	∩	LEGEND-PROFILE
∩	PROPOSED	∩	PROPOSED	∩	EXISTING	∩	PROPOSED

LOCATION APPROVED UNDERGROUND STRUCTURES

SUPV. U/G STRUCTURES COMMITTEE DATE

NOTE: LOCATION OF UNDERGROUND STRUCTURES AS SHOWN ARE BASED ON THE BEST INFORMATION AVAILABLE BUT NO GUARANTEE IS GIVEN THAT ALL EXISTING UTILITIES ARE SHOWN OR THAT THE GIVEN LOCATIONS ARE EXACT. CONFIRMATION OF EXISTENCE AND EXACT LOCATION OF ALL SERVICES MUST BE OBTAINED FROM THE INDIVIDUAL UTILITIES BEFORE PROCEEDING WITH CONSTRUCTION.

B.M. KGS BASE ELEV. DWGS BASE ON C.S.R.S. NAD 83 SYSTEM UTM GRID.

KGS GROUP CONSULTING ENGINEERS

DESIGNED BY: MAT
DRAWN BY: GEL
CHECKED BY: B.M.
APPROVED BY: R.S.O.
HOR. SCALE: 1:250
VERTICAL: 1:50
ISSUED FOR CONSTRUCTION: 16/04/27
DATE: 16/01/26

ENGINEER'S SEAL

THE CITY OF WINNIPEG WATER AND WASTE DEPARTMENT

Winnipeg

PROJECT TITLE: 2016 WATER MAIN RENEWALS CONTRACT 4
HAWTHORNE AVENUE
ROCH STREET TO ROTHESAY STREET
STA 2+25 TO STA 3+60

SHEET OF: 02 OF 14
COMPUTER FILE NAME: 16-0107-002_CALL
CITY DRAWING NUMBER: D-14331

CONSULTANT DRAWING NO. 16-0107-002_C02