

File Name: U:\FMS\16-0107-002\16-0107-002_CALL.dwg - Tab: C13 Plotted By: gloewen 16/04/26 [Tue 10:29am]

ADDRESS	SIZE & MATERIAL	CURB STOP MEASUREMENTS		CORP. LOCATION
		SHORT	LONG	
343 MUNROE AVE		5.90 EWHL	129.40 WWL ROCH ST	1.30 W OF CS
402 MUNROE AVE	20 CU			0.40 W OF CS
405 MUNROE AVE	50 CU	22.25 EWHL		28.80 E OF HYD
406 MUNROE AVE	CU	2.59 EWHL		15.24 E OF HYD
410 MUNROE AVE	20 CU	0.61 EWHL		25.30 E OF HYD
414 MUNROE AVE	CU	2.13 EWHL		39.50 E OF HYD
418 MUNROE AVE	CU	4.27 WEHL		53.95 E OF HYD
422 MUNROE AVE	CU	3.35 WEHL		34.44 W OF HYD
426 MUNROE AVE	CU	2.90 EWHL		25.60 W OF HYD

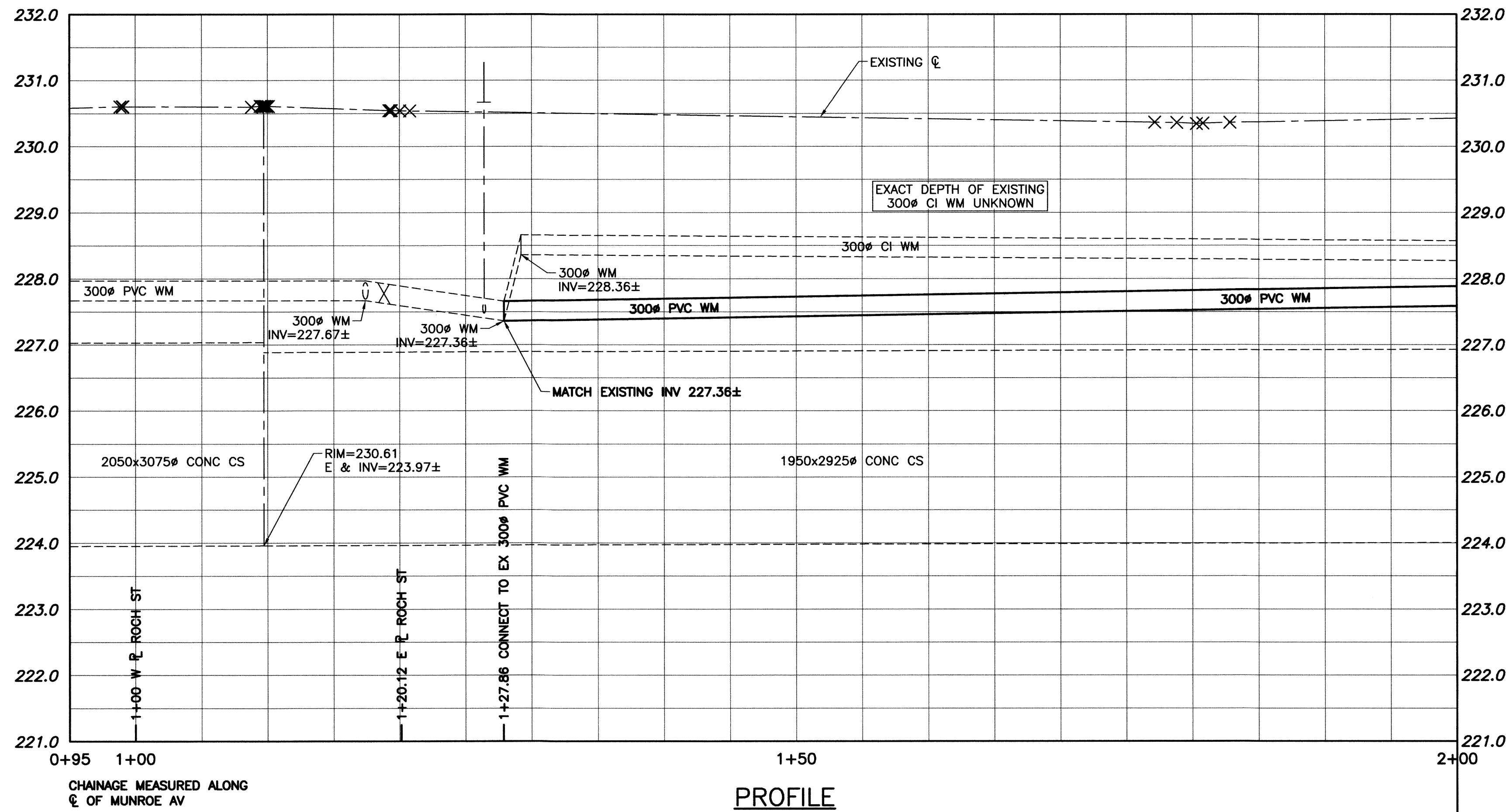

CHAINAGE MEASURED ALONG C.E. OF MUNROE AV
PROFILE
 SCALE: 1:250H 1:50V

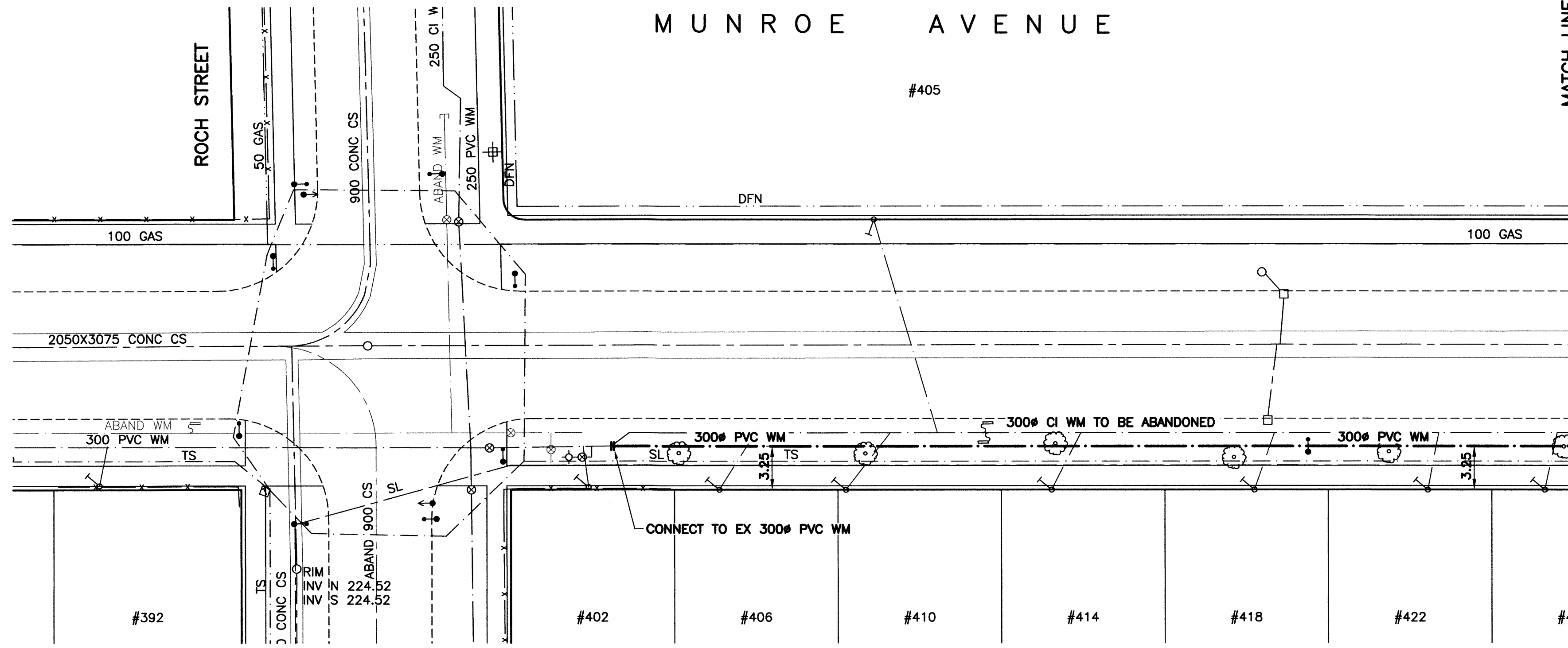

PLAN
 SCALE: 1:250

CONSTRUCTION NOTES:

1. INSTALL WATER MAIN BY TRENCHLESS METHODS.
2. ALL MATERIALS TO CONFORM TO THE CITY OF WINNIPEG STANDARD CONSTRUCTION SPECIFICATIONS.
3. MINIMUM COVER TO TOP OF PROPOSED WATER MAIN IS 2.5m FROM STREET CENTERLINE.
4. INSTALL ALL HYDRANTS WITH FLANGE ELEVATION 50mm TO 150mm ABOVE FINISHED GRADE.
5. REPLACE ALL EXISTING LEAD SERVICES FROM THE PROPOSED WATER MAIN TO PROPERTY LINE.
6. BACKFILL UNDER OR WITHIN 1.0m OF PAVEMENTS, (INCLUDING SIDEWALKS) IS CLASS 3 BACKFILL EXCEPT AS NOTED. BACKFILL IN BOULEVARDS IS CLASS 5 BACKFILL.
7. WATER VALVES ARE CLOCKWISE TO CLOSE (BLACK OPERATING NUT).

WARNING

1. NOTIFY THE GAS COMPANY OF THE PROPOSED LOCATION OF EXCAVATION.
2. TAKE PRECAUTION TO AVOID DAMAGE TO GAS COMPANY INSTALLATIONS.
3. SEE PROVINCIAL REGULATION 210/72 FOR DETAILS.

PROPERTY LIMITS DELINEATION

DELINEATION OF PROPERTY LIMITS AS SHOWN ON THIS DWG DOES NOT REPRESENT A "LEGAL SURVEY". KGS GROUP MAKES NO REPRESENTATION OR WARRANTY AS TO THE ACCURACY OF PROPERTY LIMITS DELINEATED ON THIS DWG, NOR ON THE DIMENSIONAL ACCURACY OF DWG FEATURES RELATIVE TO THOSE PROPERTY LIMITS.

METRIC

WHOLE NUMBERS INDICATE MILLIMETRES
 DECIMALIZED NUMBERS INDICATE METRES

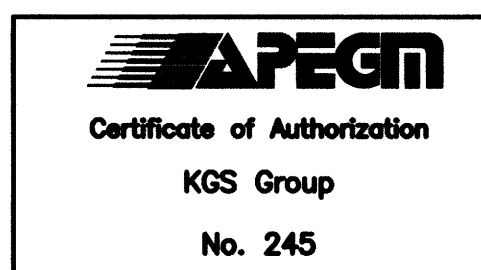
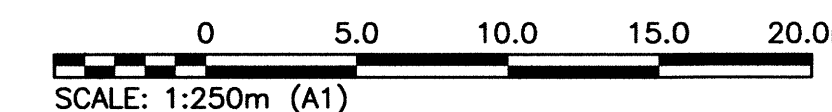
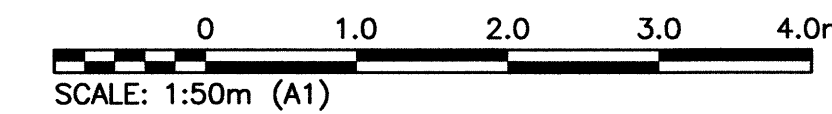

150 WM	WATER MAIN	150 WM	HYDRO	150 WM	WATER MAIN	150 WM
+	HYDRANT	+	M.T.S.	+	HYDRANT, VALVE	+
o	VALVE	o	CONCRETE	o	LAND DRAINAGE SEWER	o
300 LDS	LAND DRAINAGE SEWER	300 LDS	ASPHALT	300 LDS	WASTE WATER SEWER	300 LDS
250 WWS	WASTE WATER SEWER	250 WWS	SIDEWALK	250 WWS	CENTRELINE	250 WWS
o	MANHOLE	o	PLANNING	o	NORTH/WEST GUTTER	o
□	CATCH BASIN	□	PROPERTY LINE	o	SOUTH/EAST GUTTER	o
∇	CURB INLET	∇	SURVEY BAR	◇, o	N/W, S/E P'S	◇, o
∩	BEND	∩	GAS			
∩	REDUCER	∩	CURB STOP			
J	LEGEND-PLAN	J	TEE			
	EXISTING		LEGEND-PLAN		LEGEND-PROFILE	

LOCATION APPROVED UNDERGROUND STRUCTURES
 SUPV. U/G STRUCTURES COMMITTEE DATE _____
 NOTE:
 LOCATION OF UNDERGROUND STRUCTURES AS SHOWN ARE BASED ON THE BEST INFORMATION AVAILABLE BUT NO GUARANTEE IS GIVEN THAT ALL EXISTING UTILITIES ARE SHOWN OR THAT THE GIVEN LOCATIONS ARE EXACT. CONFIRMATION OF EXISTENCE AND EXACT LOCATION OF ALL SERVICES MUST BE OBTAINED FROM THE INDIVIDUAL UTILITIES BEFORE PROCEEDING WITH CONSTRUCTION.

B.M. KGS BASE ELEV.	DWGS BASE ON C.S.R.S. NAD 83 SYSTEM UTM GRID.

DESIGNED BY	MAT	CHECKED BY	BGM
DRAWN BY	GEL	APPROVED BY	RBO
HOR. SCALE:	1:250	RELEASED FOR CONSTRUCTION:	
VERTICAL:	1:50	DATE	16/01/26
ISSUED FOR CONSTRUCTION	16/04/27	DATE	
NO. REVISIONS		DATE	

ENGINEER'S SEAL

 CONSULTANT DRAWING NO.
 16-0107-002_C13

THE CITY OF WINNIPEG
 WATER AND WASTE DEPARTMENT

Winnipeg

PROJECT TITLE
2016 WATER MAIN RENEWALS CONTRACT 4

MUNROE AVENUE
 ROCH STREET TO MID BLOCK TIE-IN
 ROCH STREET TO STA 2+00

SHEET OF
13 OF 14

COMPUTER FILE NAME
 16-0107-002_CALL

CITY DRAWING NUMBER
D-14342