

PLAN - STA 8+25 TO STA 9+75  
SCALE: 1:250

- NOTES:**
- STATION IN CENTRE OF INKSTER BOULEVARD UNLESS OTHERWISE NOTED
  - NORTH EAST PROPERTY LINE OF KEEWATIN STREET IS STA 1+00.0
  - ALL MEASUREMENTS TO BACK OF CURB
  - ALL EXISTING TREES TO BE PROTECTED AND MAINTAINED THROUGHOUT CONSTRUCTION
  - ALL BUS STOPS WITHIN LIMITS OF CONSTRUCTION TO BE TEMPORARILY DECOMMISSIONED DURING WORKS.
  - HAND OF SOFT DIG METHODS REQUIRED OVER ALL UTILITIES AT INTERVALS DETERMINED BY THE ENGINEER TO DETERMINE DEPTH OF COVER.
  - NO WORKS, INCLUDING CONCRETE CUTTING OR BREAKING, TO BE UNDERTAKEN NEAR GAS LINES UNTIL DEPTH OF COVER IS DETERMINED AND A MB HYDRO SAFETY WATCH IS ON SITE.
  - ANY GAS MAINS OR SERVICES EXPOSED IN THE EXCAVATION AREA TO BE ROCK WRAPPED IN ACCORDANCE WITH MB HYDRO STANDARDS PRIOR TO WORK PROCEEDING ON SITE.
  - NO VIBRATORY COMPACTION PERMITTED WITHIN 1M OF GAS MAINS.
  - INSTALL DETECTABLE WARNING TILES AT INTERSECTIONS.
  - NO VIBRATORY COMPACTION PERMITTED WITHIN 3M OF 600 FEEDERMAIN.
  - APPROXIMATE LIMITS OF WORK SHOWN. FINAL LIMITS TO BE SET BY THE CONTRACT ADMINISTRATOR PRIOR TO MILLING OPERATIONS.

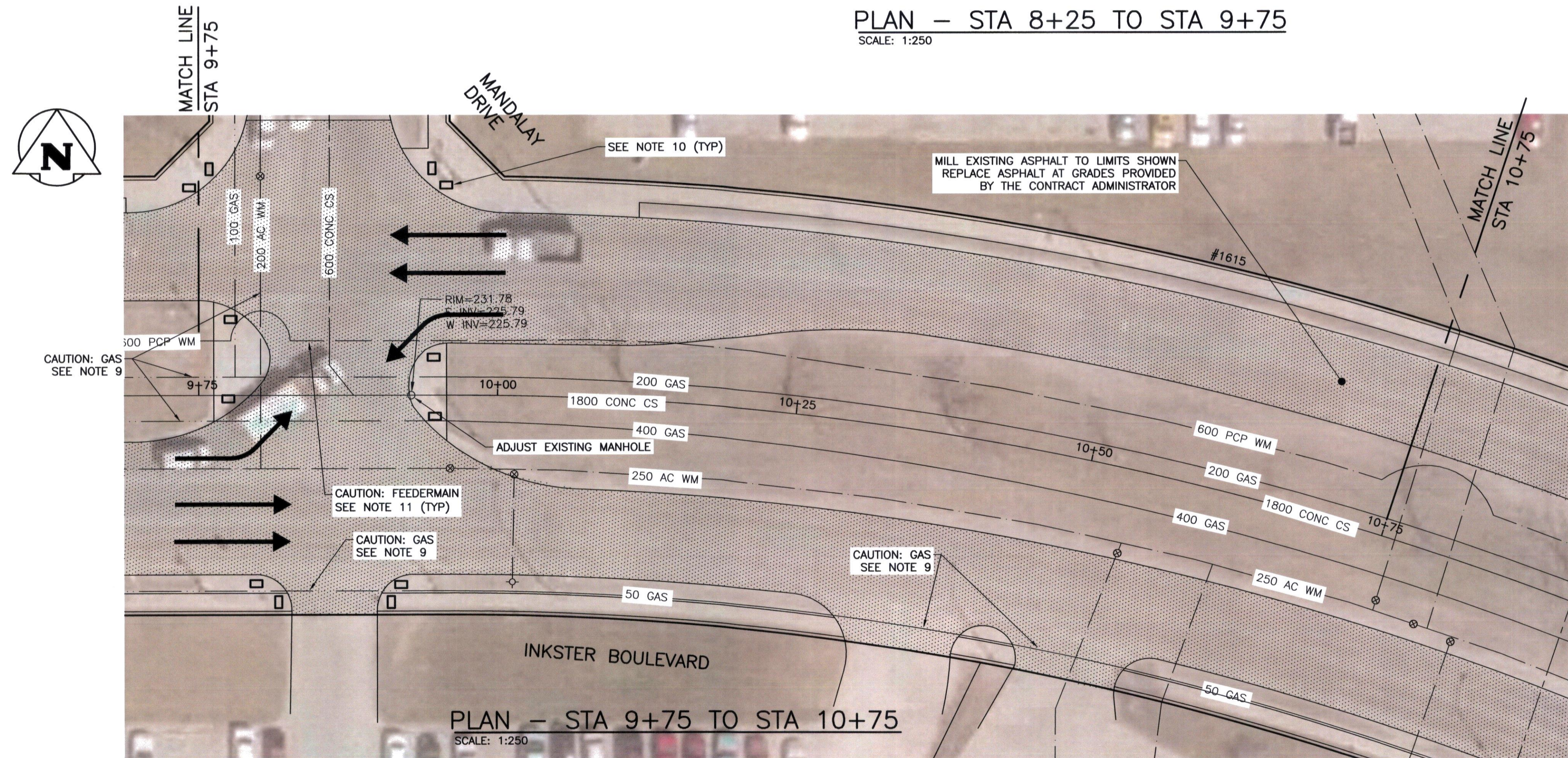

PLAN - STA 9+75 TO STA 10+75  
SCALE: 1:250

**PROPERTY LIMITS DELINEATION**

DELINEATION OF PROPERTY LIMITS AS SHOWN ON THIS DWG DOES NOT REPRESENT A "LEGAL SURVEY". KGS GROUP MAKES NO REPRESENTATION OR WARRANTY AS TO THE ACCURACY OF PROPERTY LIMITS DELINEATED ON THIS DWG, NOR ON THE DIMENSIONAL ACCURACY OF DWG FEATURES RELATIVE TO THOSE PROPERTY LIMITS.

**NOTES:**

**WARNING**

NOTIFY THE GAS COMPANY OF THE PROPOSED LOCATION OF EXCAVATION.

TAKE PRECAUTION TO AVOID DAMAGE TO GAS COMPANY INSTALLATIONS.

SEE PROVINCIAL REGULATION 210/72 FOR DETAILS.

**METRIC**

WHOLE NUMBERS INDICATE MILLIMETRES  
DECIMALIZED NUMBERS INDICATE METRES

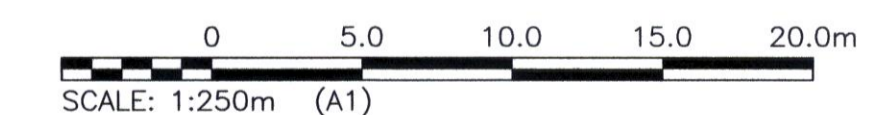

300 LBS	LAND DRAINAGE SEWER	300 LBS	+	TEST HOLE					
250 WWS	WASTE WATER SEWER	250 WWS	+	GUY WIRE					
	GAS		+	LIGHT STANDARD					
	HYDRO		+	BACK OF CURB					
	M.T.S.		+	CONCRETE					
150 WM	WATERMAIN	150 WM	+	ASPHALT					
+	HYDRANT		+	SIDEWALK					
+	VALVE		+	PROPERTY LINE					
○	MANHOLE		+	SURVEY BAR					
□	CATCH BASIN		+	GEODETIC BENCHMARK					
▽	CURB INLET		+	ELEVATION					
•	POLES		+						
•	POLES		+						
EXISTING	LEGEND-PLAN	PROPOSED	EXISTING	LEGEND-PLAN	PROPOSED	EXISTING	LEGEND-PROFILE	PROPOSED	

<b>LOCATION APPROVED UNDERGROUND STRUCTURES</b>		B.M. XX-XXX ELEV. XXX.XX	XXXXXXXXXX XXXXXXXXXX XXXXXXXXXX
SUPV. U/G STRUCTURES COMMITTEE	DATE		
NOTE: LOCATION OF UNDERGROUND STRUCTURES AS SHOWN ARE BASED ON THE BEST INFORMATION AVAILABLE BUT NO GUARANTEE IS GIVEN THAT ALL EXISTING UTILITIES ARE SHOWN OR THAT THE GIVEN LOCATIONS ARE EXACT. CONFIRMATION OF EXISTENCE AND EXACT LOCATION OF ALL SERVICES MUST BE OBTAINED FROM THE INDIVIDUAL UTILITIES BEFORE PROCEEDING WITH CONSTRUCTION.			

<b>KGS GROUP CONSULTING ENGINEERS</b>		DESIGNED BY: JB	CHECKED BY: CR
		DRAWN BY: DMW	APPROVED BY: MA
		HOR. SCALE: 1:250	RELEASED FOR CONSTRUCTION:
		VERTICAL: 1:50	DATE: 12/02/16
0	ISSUED FOR TENDER	16/04/12	CR
NO.	REVISIONS	DATE	BY

<b>THE CITY OF WINNIPEG PUBLIC WORKS DEPARTMENT ENGINEERING DIVISION</b>		PROJECT TITLE	SHEET OF
		INKSTER BOULEVARD MILL AND FILL	04 OF 06
		KEEWATIN STREET TO SHEPPARD STREET STA 8+25 TO STA 10+75	COMPUTER FILE NAME: INKSTER_CALL DWG.
CONSULTANT DRAWING NO. <b>C204</b>		CITY DRAWING NUMBER	