

INKSTER BOULEVARD
PLAN – STA 10+75 TO STA 12+25
 SCALE: 1:250

- NOTES:**
1. STATION IN CENTRE OF INKSTER BOULEVARD UNLESS OTHERWISE NOTED
 2. NORTH EAST PROPERTY LINE OF KEEWATIN STREET IS STA 1+00.0
 3. ALL MEASUREMENTS TO BACK OF CURB
 4. ALL EXISTING TREES TO BE PROTECTED AND MAINTAINED THROUGHOUT CONSTRUCTION
 5. ALL BUS STOPS WITHIN LIMITS OF CONSTRUCTION TO BE TEMPORARILY DECOMMISSIONED DURING WORKS.
 6. HAND OF SOFT DIG METHODS REQUIRED OVER ALL UTILITIES AT INTERVALS DETERMINED BY THE ENGINEER TO DETERMINE DEPTH OF COVER.
 7. NO WORKS, INCLUDING CONCRETE CUTTING OR BREAKING, TO BE UNDERTAKEN NEAR GAS LINES UNTIL DEPTH OF COVER IS DETERMINED AND A MB HYDRO SAFETY WATCH IS ON SITE.
 8. ANY GAS MAINS OR SERVICES EXPOSED IN THE EXCAVATION AREA TO BE ROCK WRAPPED IN ACCORDANCE WITH MB HYDRO STANDARDS PRIOR TO WORK PROCEEDING ON SITE.
 9. NO VIBRATORY COMPACTION PERMITTED WITHIN 1M OF GAS MAINS.
 10. INSTALL DETECTABLE WARNING TILES AT INTERSECTIONS.
 11. NO VIBRATORY COMPACTION PERMITTED WITHIN 3M OF 600 FEEDERMAIN.
 12. APPROXIMATE LIMITS OF WORK SHOWN. FINAL LIMITS TO BE SET BY THE CONTRACT ADMINISTRATOR PRIOR TO MILLING OPERATIONS.

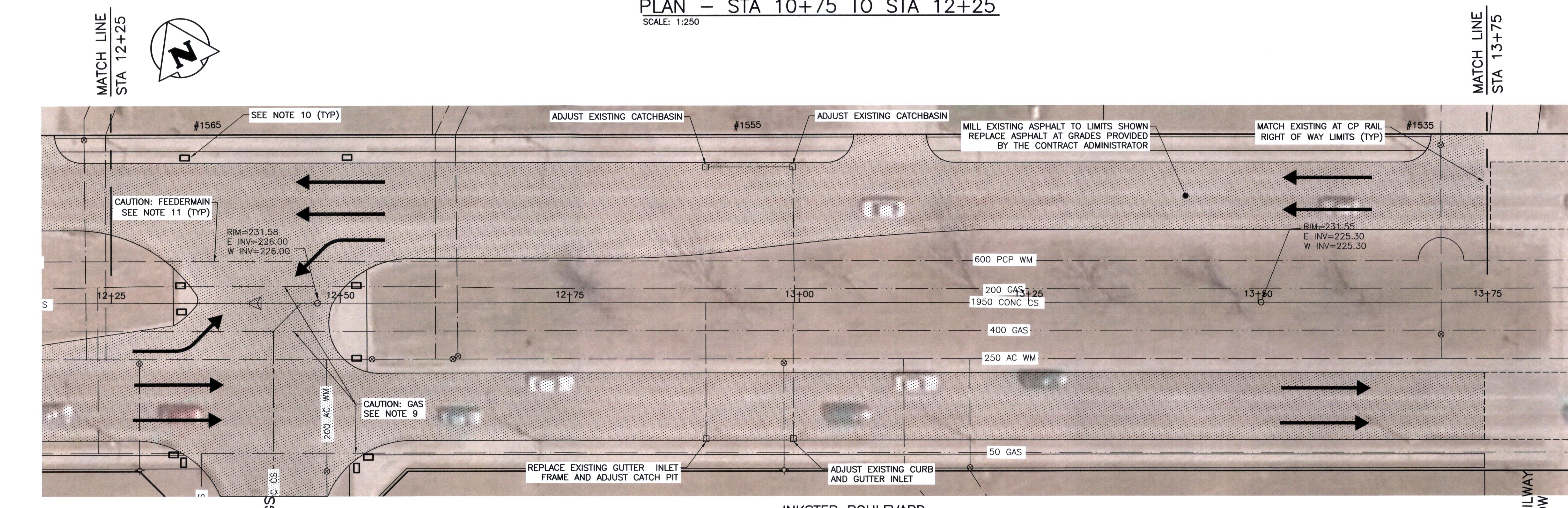

INKSTER BOULEVARD
PLAN – STA 12+25 TO STA 13+75
 SCALE: 1:250

PROPERTY LIMITS DELINEATION

DELINEATION OF PROPERTY LIMITS AS SHOWN ON THIS DWG DOES NOT REPRESENT A "LEGAL SURVEY". KGS GROUP MAKES NO REPRESENTATION OR WARRANTY AS TO THE ACCURACY OF PROPERTY LIMITS DELINEATED ON THIS DWG, NOR ON THE DIMENSIONAL ACCURACY OF DWG FEATURES RELATIVE TO THOSE PROPERTY LIMITS.

NOTES:

WARNING

NOTIFY THE GAS COMPANY OF THE PROPOSED LOCATION OF EXCAVATION.

TAKE PRECAUTION TO AVOID DAMAGE TO GAS COMPANY INSTALLATIONS.

SEE PROVINCIAL REGULATION 210/72 FOR DETAILS.

METRIC

WHOLE NUMBERS INDICATE MILLIMETRES
 DECIMALIZED NUMBERS INDICATE METRES

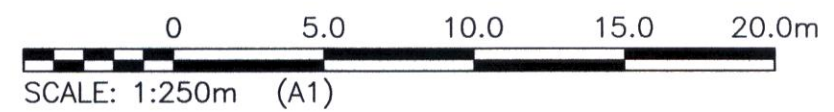

300 LGS	LAND DRAINAGE SEWER	300 LGS	TEST HOLE				
250 WWS	WASTE WATER SEWER	250 WWS	GUY WIRE				
	GAS		LIGHT STANDARD				
	HYDRO		BACK OF CURB				
	M.T.S.		CONCRETE				
150 WM	WATERMAIN	150 WM	ASPHALT				
	HYDRANT		SIDEWALK				
	VALVE		PROPERTY LINE				
	MANHOLE		SURVEY BAR				
	CATCH BASIN		GEODETIC BENCHMARK				
	CURB INLET		ELEVATION				
	POLES						
EXISTING	LEGEND-PLAN	PROPOSED	EXISTING	LEGEND-PLAN	PROPOSED	EXISTING	LEGEND-PROFILE

LOCATION APPROVED UNDERGROUND STRUCTURES

SUPV. U/G STRUCTURES COMMITTEE DATE

NOTE:
 LOCATION OF UNDERGROUND STRUCTURES AS SHOWN ARE BASED ON THE BEST INFORMATION AVAILABLE BUT NO GUARANTEE IS GIVEN THAT ALL EXISTING UTILITIES ARE SHOWN OR THAT THE GIVEN LOCATIONS ARE EXACT. CONFIRMATION OF EXISTENCE AND EXACT LOCATION OF ALL SERVICES MUST BE OBTAINED FROM THE INDIVIDUAL UTILITIES BEFORE PROCEEDING WITH CONSTRUCTION.

B.M. XX-XXX	XXXXXXX		
ELEV. XXX.XX	XXXXXXXX		
	XXXXXXXX		

NO.	REVISIONS	DATE	BY
0	ISSUED FOR TENDER	16/04/12	CR

KGS GROUP
 CONSULTING ENGINEERS

DESIGNED BY: JB
 CHECKED BY: CR
 DRAWN BY: DMW
 APPROVED BY: PPH
 HOR. SCALE: 1:250
 VERTICAL: 1:50
 RELEASED FOR CONSTRUCTION: DATE
 DATE: 12/02/16

THE CITY OF WINNIPEG
 PUBLIC WORKS DEPARTMENT
 ENGINEERING DIVISION

PROJECT TITLE: **INKSTER BOULEVARD MILL AND FILL**

CONSULTANT DRAWING NO. **C205**

KEEWATIN STREET TO SHEPPARD STREET
 STA 10+75 TO STA 13+75

SHEET **05** OF **06**
 COMPUTER FILE NAME: **INKSTER_CALL.DWG.**
 CITY DRAWING NUMBER: **---**