

PEMBINA HIGHWAY SOUTHBOUND PROFILE

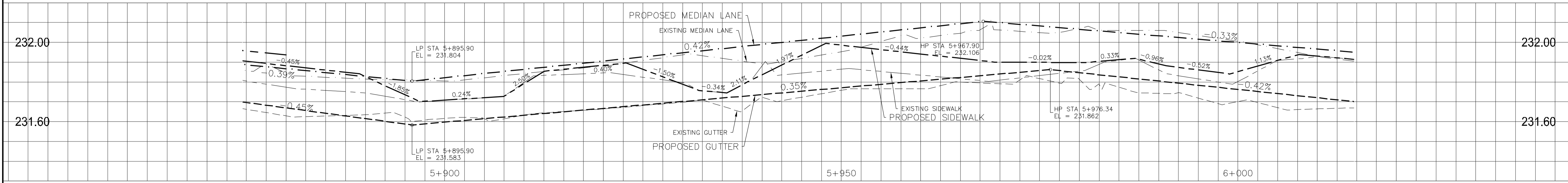

PEMBINA HIGHWAY NORTHBOUND PROFILE

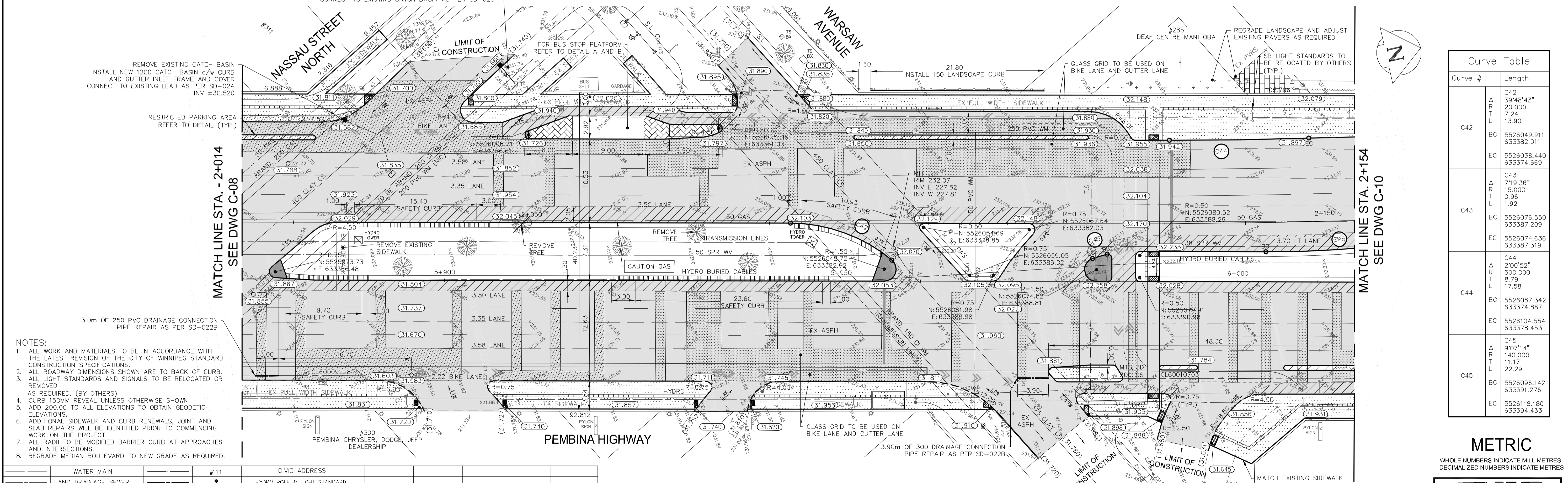

- NOTES:**
- ALL WORK AND MATERIALS TO BE IN ACCORDANCE WITH THE LATEST REVISION OF THE CITY OF WINNIPEG STANDARD CONSTRUCTION SPECIFICATIONS.
 - ALL ROADWAY DIMENSIONS SHOWN ARE TO BACK OF CURB. ALL LIGHT STANDARDS AND SIGNALS TO BE RELOCATED OR REMOVED AS REQUIRED (BY OTHERS).
 - CURB 150MM REVEAL UNLESS OTHERWISE SHOWN.
 - ADD 200.00 TO ALL ELEVATIONS TO OBTAIN GEODETIC ELEVATIONS.
 - ADDITIONAL SIDEWALK AND CURB RENEWALS, JOINT AND SLAB REPAIRS WILL BE IDENTIFIED PRIOR TO COMMENCING WORK ON THE PROJECT.
 - ALL RADI TO BE MODIFIED BARRIER CURB AT APPROACHES AND INTERSECTIONS.
 - REGRADE MEDIAN BOULEVARD TO NEW GRADE AS REQUIRED.

Curve #	Length
C42	Δ R T L 39°48'43"
	20.000
	7.24 13.90
BC	5526049.911 633382.011
	EC
C43	Δ R T L C43 7°19'36"
	15.000
	0.96 1.92
BC	5526076.550 633387.209
	EC
C44	Δ R T L C44 2°00'52"
	500.000
	8.79 17.58
BC	5526087.342 633374.887
	EC
C45	Δ R T L C45 9°07'14"
	140.000
	11.17 22.29
BC	5526096.142 633391.276
	EC

EXISTING	LEGEND-PLAN	PROPOSED	EXISTING	LEGEND-PLAN	PROPOSED	EXISTING	LEGEND-PROFILE	PROPOSED
---	WATER MAIN	---	#111	CIVIC ADDRESS	---	---	---	---
---	LAND DRAINAGE SEWER	---	●	HYDRO POLE & LIGHT STANDARD	---	---	---	---
---	WASTE WATER SEWER	---	○	LIGHT STANDARD	---	---	---	---
---	HYDRO	---	HP	HYDRO POLE	---	---	---	---
---	M.T.S.	---	□	CURB RAMP	---	---	---	---
---	GAS	---	■	DETECTABLE WARNING SURFACE TILE c/w RAMP	---	---	---	---
---	SIGNALS	---	---	EDGE OF SIDEWALK	---	---	---	---
○	MANHOLE	●	---	PROPERTY LINE	---	---	---	---
□	CATCH BASIN	■	---	EDGE OF ASPHALT	---	---	---	---
△	CURB INLET	▽	---	MODIFIED BARRIER CURB	---	---	---	---
△	UTILITIES ADJUSTED	△	---	BARRIER CURB	---	---	---	---
J	PLUG	J	---	BARRIER CURB WITH SPLASH STRIP	---	---	---	---
◇	HYDRANT	◆	---	TRAFFIC SIGNAL	---	---	---	---
⊗	VALVE	⊗	---	SIDEWALK	---	---	---	---
⊙	CURB STOP	⊙	---	CONCRETE SLAB REPAIR	---	---	---	---
230.99	GROUND GRADE	---	---	ASPHALT	---	---	---	---
---	PAVEMENT GRADE	(31.000)	---	CONCRETE	---	---	---	---
---	LOT GRADE	[31.000]	---	INTERLOCKING PAVING STONES	---	---	---	---
---	ANCHOR	---	---	BULLNOSE	---	---	---	---
---	EXISTING	---	---	LEGEND-PLAN	---	---	---	---

FOR SECTIONS AND DETAILS REFER TO C-20

FOR TENDER PURPOSES ONLY

LOCATIONS APPROVED UNDERGROUND STRUCTURES

NOTES:
These design documents are prepared solely for the use by the party with whom the design professional has entered into a contract and there are no representations of any kind made by the design professional to any party with whom the design professional has not entered into a contract.

NO.	REVISIONS	DATE	BY
3	ISSUED FOR TENDER	16.MAY.16	VM
2	ISSUED TO UNDERGROUND STRUCTURES	16.MAY.16	VM
1	ISSUED FOR CLIENT REVIEW	28.APR.16	VM

MMM GROUP

DESIGNED BY: SQ/JP
CHECKED BY: VM/TP

DRAWN BY: HK/LT
APPROVED BY: VM

HOR SCALE: 1:250
VERTICAL: 1:10

ISSUED FOR CONSTRUCTION: MARCH 2016

RELEASING FOR CONSTRUCTION: MARCH 2016

THE CITY OF WINNIPEG
PUBLIC WORKS DEPARTMENT
ENGINEERING DIVISION

PEMBINA HIGHWAY
FROM CARTER AVENUE TO OSBORNE STREET

PAVEMENT REHABILITATION
SOUTHBOUND STA. 2+014 - STA. 2+154

CITY DRAWING NUMBER: SHEET 09 OF 27
BID NO. 386-2016

CONSULTANT ACAD DWG. NO. 5516006-C-09

METRIC
WHOLE NUMBERS INDICATE MILLIMETRES
DECIMALIZED NUMBERS INDICATE METRES

APEGM
Certificate of Authorization
MMM Group Limited
No. 4531

May 16, 2016 - 12:08pm
 P:\5516006-15-09099-5516006 - Pembina Hwy Pavement Rehab. & Bike Lane\MMW Drawings\Construction Drawings\5516006 CD1-C12 Rehabilitation Issued for Tender_20160516.dwg - tab: STA. 2+040.00 - STA. 2+180.23