

PEMBINA HIGHWAY NORTHBOUND LEFT TURN LANE PROFILE

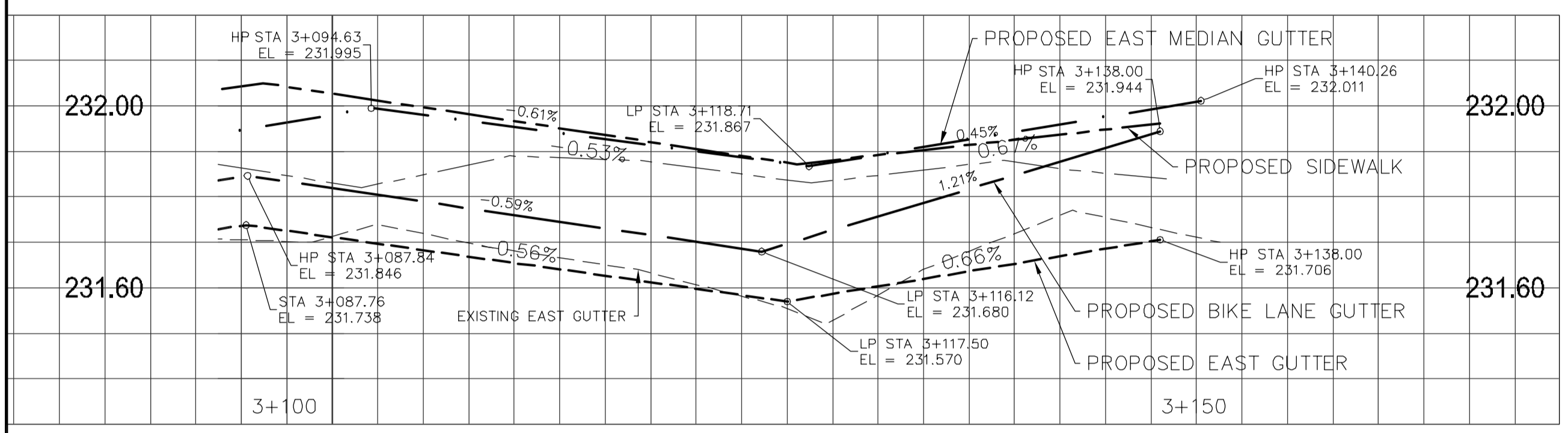

PEMBINA HIGHWAY NORTHBOUND PROFILE

Curve Table	
Curve #	Length
C52	Δ R T L 2'08"30", 250.000, 4.67, 9.34
	BC 5526320.748, 633448.705
	EC 5526326.885, 633455.751
C53	Δ R T L C53 11'27"30", 150.000, 15.05, 30.00
	BC 5526344.656, 633479.856
	EC 5526326.885, 633455.751
C54	Δ R T L C54 52'54"30", 96.500, 48.02, 89.11
	BC 5526338.172, 633484.059
	EC 5526267.679, 633434.837
C56	Δ R T L C56 17'55"18", 35.000, 5.52, 10.95
	BC 5526325.372, 633489.818
	EC 5526316.768, 633481.143
C57	Δ R T L C57 20'39"02", 45.000, 8.20, 16.22
	BC 5526349.432, 633524.796
	EC 5526334.566, 633518.535
C65	Δ R T L C65 22'46"15", 36.000, 7.25, 14.31
	BC 5526309.954, 633476.416
	EC 5526300.275, 633466.008

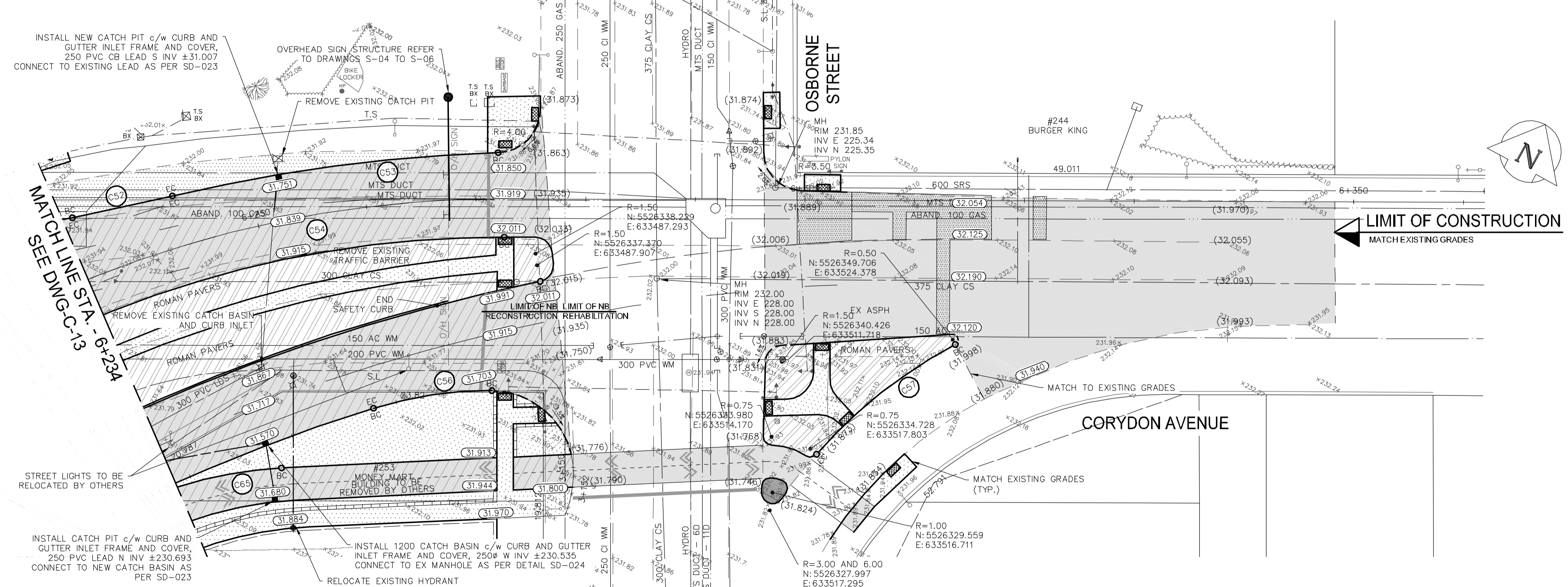

EXISTING	LEGEND-PLAN	PROPOSED	EXISTING	LEGEND-PLAN	PROPOSED	EXISTING	LEGEND-PROFILE	PROPOSED
---	WATER MAIN	---	#111	CIVIC ADDRESS	---	---	LEFT TURN LANE	---
---	LAND DRAINAGE SEWER	---	●	HYDRO POLE & LIGHT STANDARD	---	---	WEST MEDIAN GUTTER	---
---	WASTE WATER SEWER	---	○	LIGHT STANDARD	---	---	EAST MEDIAN GUTTER	---
---	HYDRO	---	HP	HYDRO POLE	---	---	SIDEWALK	---
---	M.T.S.	---	□	CURB RAMP	---	---	WEST SIDEWALK	---
---	GAS	---	■	DETECTABLE WARNING SURFACE TILE c/w RAMP	---	---	EAST SIDEWALK	---
---	SIGNALS	---	○	EDGE OF SIDEWALK	---	---	ROADWAY CENTRE LINE	---
---	MANHOLE	---	●	PROPERTY LINE	---	---	WEST GUTTER	---
---	CATCH BASIN	---	■	EDGE OF ASPHALT	---	---	EAST GUTTER	---
---	CURB INLET	---	▲	MODIFIED BARRIER CURB	---	---	---	---
---	UTILITIES ADJUSTED	---	△	BARRIER CURB	---	---	---	---
---	PLUG	---	⌋	BARRIER CURB WITH SPLASH STRIP	---	---	---	---
---	HYDRANT	---	⊕	TRAFFIC SIGNAL	---	---	---	---
---	VALVE	---	⊗	ASPHALT	---	---	---	---
---	CURB STOP	---	⊖	CONCRETE SLAB REPAIR	---	---	---	---
---	GROUND GRADE	---	---	CONCRETE	---	---	---	---
---	PAVEMENT GRADE	---	---	INTERLOCKING PAVING STONES	---	---	---	---
---	LOT GRADE	---	---	BULLNOSE	---	---	---	---
---	ANCHOR	---	---	---	---	---	---	---

FOR TENDER PURPOSES ONLY

FOR SECTIONS AND DETAILS REFER TO C-20

RECONSTRUCTION DESIGN TO BE FINALIZED IN 2017

NOTE: These design documents are prepared solely for the use by the party with whom the design professional has entered into a contract and there are no representations of any kind made by the design professional to any party with whom the design professional has not entered into a contract.

LOCATIONS APPROVED UNDERGROUND STRUCTURES	
SIGNED BY:	DATE:
SUPV UG STRUCTURES	
LOCATION OF UNDERGROUND STRUCTURES AS SHOWN ARE BASED ON THE BEST INFORMATION AVAILABLE BUT NO GUARANTEE IS GIVEN THAT ALL EXISTING UTILITIES ARE SHOWN OR THAT THE GIVEN LOCATIONS ARE EXACT CONFIRMATION OF EXISTENCE AND EXACT LOCATION OF ALL SERVICES MUST BE OBTAINED FROM THE INDIVIDUAL UTILITIES BEFORE PROCEEDING	

G.R.A.I. BENCHMARK LOCATION	
ELEV. 232.929	LOCATED ON "O" OF OPEN ON HYDRANT, SOUTHEAST CORNER OF PEMBINA HIGHWAY AND DALY STREET NORTH
DESIGNED BY: SQ/JP	CHECKED BY: VM/TP
DRAWN BY: HK/LT	APPROVED BY: VM
3 ISSUED FOR TENDER 16.MAY.16 VM 2 ISSUED TO UNDERGROUND STRUCTURES 16.MAY.16 VM 1 ISSUED FOR CLIENT REVIEW 28.APR.16 VM NO. REVISIONS DATE BY	
HORIZ SCALE 1:250 VERTICAL SCALE 1:10 DATE MARCH 2016	

NOTES:
 1. ALL WORK AND MATERIALS TO BE IN ACCORDANCE WITH THE LATEST REVISION OF THE CITY OF WINNIPEG STANDARD CONSTRUCTION SPECIFICATIONS.
 2. ALL ROADWAY DIMENSIONS SHOWN ARE TO BACK OF CURB.
 3. ALL LIGHT STANDARDS AND SIGNALS TO BE RELOCATED OR REMOVED AS REQUIRED. (BY OTHERS)
 4. CURB 150MM REVEAL UNLESS OTHERWISE SHOWN.
 5. ADD 200.00 TO ALL ELEVATIONS TO OBTAIN GEODETIC ELEVATIONS.
 6. ADDITIONAL SIDEWALK AND CURB RENEWALS, JOINT AND SLAB REPAIRS WILL BE IDENTIFIED PRIOR TO COMMENCING WORK ON THE PROJECT.
 7. ALL RADII TO BE MODIFIED BARRIER CURB AT APPROACHES AND INTERSECTIONS.
 8. REGRADE MEDIAN BOULEVARD TO NEW GRADE AS REQUIRED.

METRIC
 WHOLE NUMBERS INDICATE MILLIMETRES
 DECIMAL NUMBERS INDICATE METRES

Certificate of Authorization
 MMM Group Limited
 No. 4531

THE CITY OF WINNIPEG
 PUBLIC WORKS DEPARTMENT
 ENGINEERING DIVISION

PEMBINA HIGHWAY
 FROM CARTER AVENUE TO OSBORNE STREET

PAVEMENT REHABILITATION
 NORTHBOUND STA. 2+234 TO LIMIT OF CONSTRUCTION

CITY DRAWINGS NUMBER: SHEET 14 OF 27
 BID NO. 386-2016

CONSULTANT CAD DWS NO. 5516006-C-14

May 16, 2016 - 10:44am
 P:\3516006-5516006-5516006 - Pembina Hwy Pavement Rehab. & Bike Lane\MMW Drawings\Construction Drawings\5516006 C13-14 Pembina Reconstruction issued for Tender 20160516.dwg - tab:STA 2+230.00 - STA2+350.00