

RENOVATION LEGEND:

- X EXISTING ELECTRICAL EQUIPMENT TO BE REMOVED AND DISPOSED OF BY THE GENERAL CONTRACTOR. REMOVE, BLANK OFF, EXTEND OR RELOCATE ALL ASSOCIATED WIRING AND MAKE SAFE. THE CONTRACTOR SHALL REMOVE THE EXISTING CONDUIT AND WIRING TO THE SATISFACTION OF THE CONTRACT ADMINISTRATOR.
- * EXISTING ELECTRICAL EQUIPMENT TO BE REMOVED AND REINSTALLED OR RELOCATED AS SHOWN. RE-WIRE OR EXTEND WIRING AS REQUIRED.
- ✓ EXISTING ELECTRICAL EQUIPMENT TO REMAIN IN ITS PRESENT LOCATION.

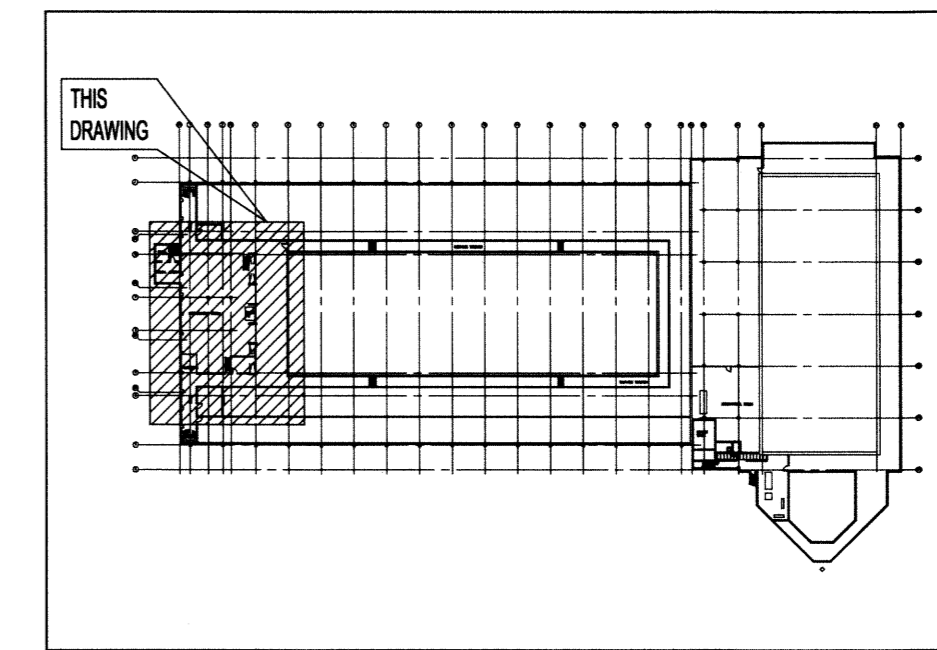

KEY PLAN SCALE: N.T.S.

NOTES:

THESE DRAWINGS SHALL NOT BE SCALED.

THE CONTRACTOR SHALL VISIT THE SITE AND SATISFY ONESELF ALL DIMENSIONS, DATUM, AND DETAILED INFORMATION SHOWN ARE CORRECT.

THE CONTRACTOR IS TO REVIEW AND COORDINATE ALL ARCHITECTURAL, MECHANICAL, ELECTRICAL AND STRUCTURAL DRAWINGS FOR ADDITIONAL OPENINGS THROUGH FLOORS, WALLS, AND CEILINGS FOR DUCT, PIPE & ELECTRICAL RISERS AND ALL OPENINGS NOT SHOWN ON DRAWINGS.

ALL OPENINGS THROUGH THE FIRE SEPARATIONS AS A RESULT OF THE WORK OF THIS CONTRACT ARE TO BE FIRE STOPPED AND SEALED WITH ULC APPROVED FIRE STOPPING TO MAINTAIN THE INTEGRITY OF THE FIRE SEPARATION, AND PROVIDE AND SMOKE-TIGHT BARRIER. EXISTING OPENINGS THROUGH FIRE SEPARATIONS THAT ARE NOT CURRENTLY FIRE STOPPED TO BE DEALT WITH UNDER SEPARATE CONTRACT.

ALL PRODUCTS AND MATERIALS TO BE USED AND INSTALLED SHALL CONFORM WITH MANUFACTURERS SPECIFICATIONS & APPLICABLE CODES.

THE CONTRACTOR SHALL BE RESPONSIBLE TO PATCH AND MAKE GOOD ALL EXISTING CONSTRUCTION AFFECTED BY THE REMOVAL OF ALL ITEMS FORMING THE PART OF THE RENOVATION WORK.

WHERE NEW FLOORING AND BASE IS TO BE INSTALLED IN EXISTING AREAS (REFER TO FLOOR PLAN AND ROOM SCHEDULE) THE EXISTING FLOORING SURFACE AND BASE MUST BE REMOVED, UNLESS OTHERWISE NOTED. ALL FLOOR SURFACES SHALL BE PREPARED IN ACCORDANCE TO MANUFACTURERS RECOMMENDATIONS FOR INSTALLATION OF NEW FLOOR.

WHERE PAINTING OF EXISTING WALLS IS INDICATED ON THE ROOM SCHEDULE, THESE WALLS MUST BE CLEANED OF ANY EXISTING WALL COVERING, PATCHED & PREPARED TO ACCEPT NEW MATERIAL, UNLESS OTHERWISE NOTED.

GENERAL NOTES:

1. GREY SHADED LINE WEIGHT DENOTES EXISTING EQUIPMENT.

KEYNOTES:

1. DISCONNECT AND REMOVE THE EXISTING WIRING AND CONDUIT FOR THE KIDDE POOL HEAT EXCHANGER CIRCULATION PUMP BACK TO THE LOCAL STARTER ON THE WALL.
2. RECONNECT THE EXISTING KIDDE POOL HEAT EXCHANGER CIRCULATION PUMP BY EXTENDING NEW SURFACE MOUNTED WIRING AND CONDUIT FROM THE EXISTING WALL MOUNTED STARTER TO THE PUMP. PROVIDE JUNCTION BOX EXTENSIONS AS REQUIRED.

GENERAL DEMOLITION NOTES

1. CONTRACTOR SHALL COMPLY WITH ALL APPLICABLE CODES AND STANDARDS.
2. PRIOR TO COMMENCEMENT OF ANY WORK, THE CONTRACTOR SHALL BE RESPONSIBLE FOR OBTAINING ALL REQUIRED PERMITS TO COMPLETE THE DEMOLITION SCOPE OF WORK.
3. CONTRACTOR SHALL BE RESPONSIBLE FOR MAKING SAFE THE AREA OF DEMOLITION AND FOR ENSURING THAT SAFETY PROCEDURES, PRACTICES AND OPERATIONS ARE FOLLOWED. ALL DEMOLITION AND MATERIAL SHALL BE SAFELY REMOVED TO ALLOW FUTURE CONSTRUCTION AND ALL DEBRIS DISPOSED OF ON A DAILY BASIS.
4. CONTRACTOR SHALL PROVIDE SAFETY AND DUST PROOF BARRIERS TO PROTECT ALL PUBLICLY OCCUPIED AREAS DURING THE DEMOLITION AND CONSTRUCTION PERIOD. ALL AREAS, FURNITURE, EQUIPMENT ETC. THAT ARE ADJACENT OR NOT A PART OF THE DEMOLITION AREA SHALL BE PROTECTED FROM DAMAGE.
5. ALL MATERIALS REMOVED DUE TO THE DEMOLITION OF EXISTING AREAS ARE OF THE OWNER'S PROPERTY IN WHICH THE OWNER HAS THE FIRST RIGHT TO CLAIM. ALL ITEMS THAT ARE NOT CLAIMED BY THE OWNER SHALL BE THE RESPONSIBILITY OF THE CONTRACTOR TO REMOVE AND DISCARD FROM SITE.
6. NON-DEMOLITION ITEMS MAY BE SHOWN ON THE DRAWINGS TO DESCRIBE THE INTENT OF THE OVERALL SCOPE OF WORK AND TO AID THE CONTRACTOR WITH THEIR COORDINATION. CONTRACTOR SHALL FIELD VERIFY ALL DEVICE LOCATIONS.
7. WHERE CONDUITS ARE TO BE REMOVED WITHIN THE SCOPE OF WORK, ALL CONDUITS AND ASSOCIATED WIRING (I.E. FEEDER CIRCUIT WIRING) SHALL BE REMOVED BACK TO THEIR SOURCE AND NOT JUST TO THE NEAREST JUNCTION BOX.
8. ALL OBSOLETE/ABANDONED CABLING AND CONDUIT WITHIN CEILING SPACES THAT ARE AFFECTED BY THE AREA OF DEMOLITION SHALL BE COMPLETELY REMOVED.
9. WHERE ELECTRICAL EQUIPMENT HAS BEEN REMOVED, ALL WALLS/CEILINGS SHALL BE REPAIRED TO EXISTING CONDITIONS. SURFACES SHALL BE PATCHED AND PAINTED TO MATCH EXISTING.

0	ISSUED FOR TENDER	16.05.20
No.	REVISION/DESCRIPTION	BY DATE

SEAL



DRAWN	GMB	CHECKED	DESIGNED	CLS	APPROVED
DATE	2016.04.14	USER	APPROVAL		

Winnipeg THE CITY OF WINNIPEG
PLANNING, PROPERTY AND
DEVELOPMENT DEPARTMENT
MUNICIPAL ACCOMMODATIONS DIVISION
3-65 GARRY STREET, R3C 4K4

PROJECT
REPLACEMENT OF BOILERS AND
POOL WATER HEAT EXCHANGERS AT
PAN AM POOL
25 POSEIDON BAY

SHEET TITLE
ELECTRICAL
MECHANICAL ROOM PLAN
DEMOLITION & NEW

SCALE	PROJECT No:	SHEET No:
AS SHOWN	16-0107-008	P1_E08

DRAWING SHEET SIZE: A1 (841mm x 594mm) PLOT 1:1

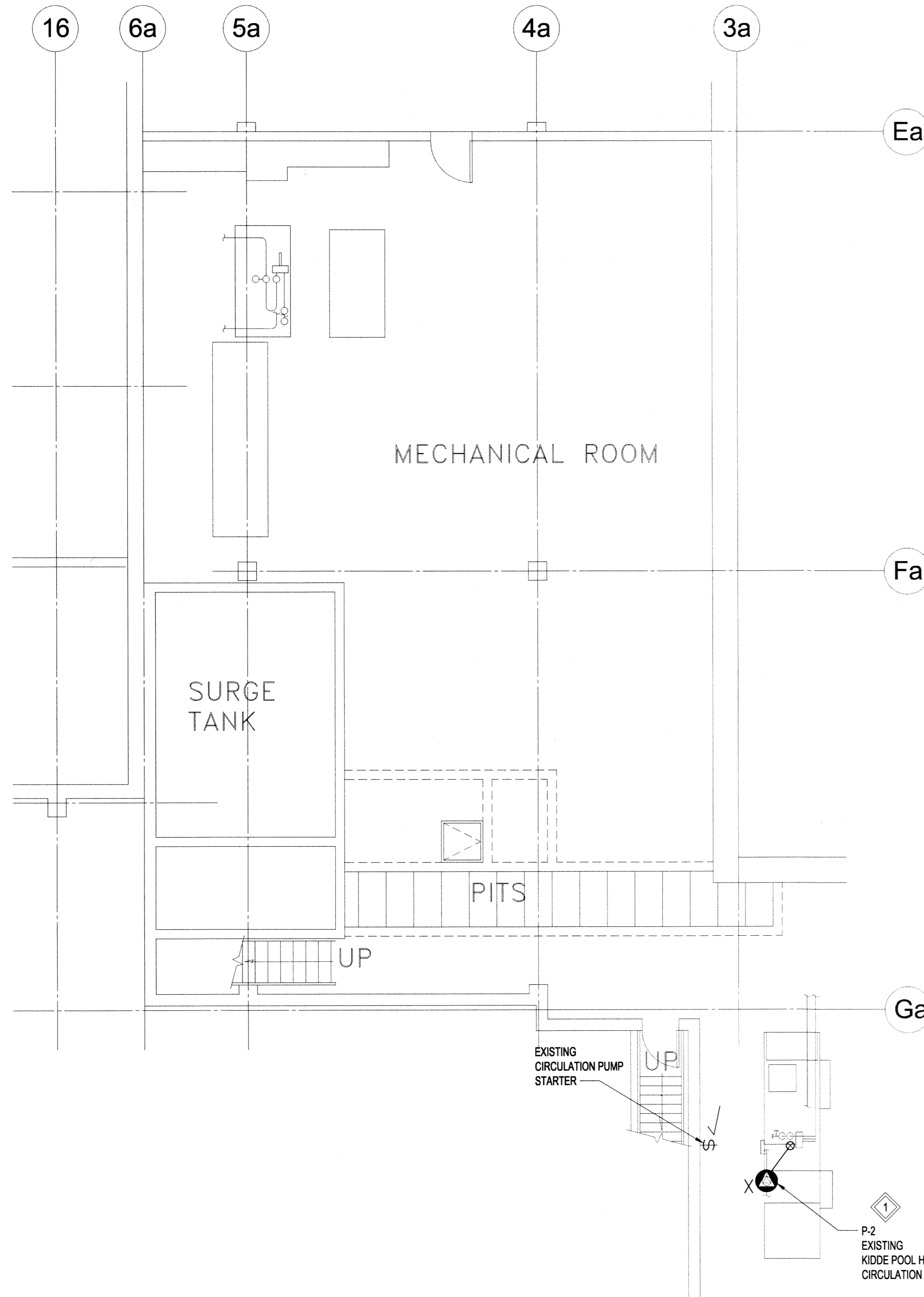

ELECTRICAL ROOM PLAN - DEMOLITION SCALE: 1:75

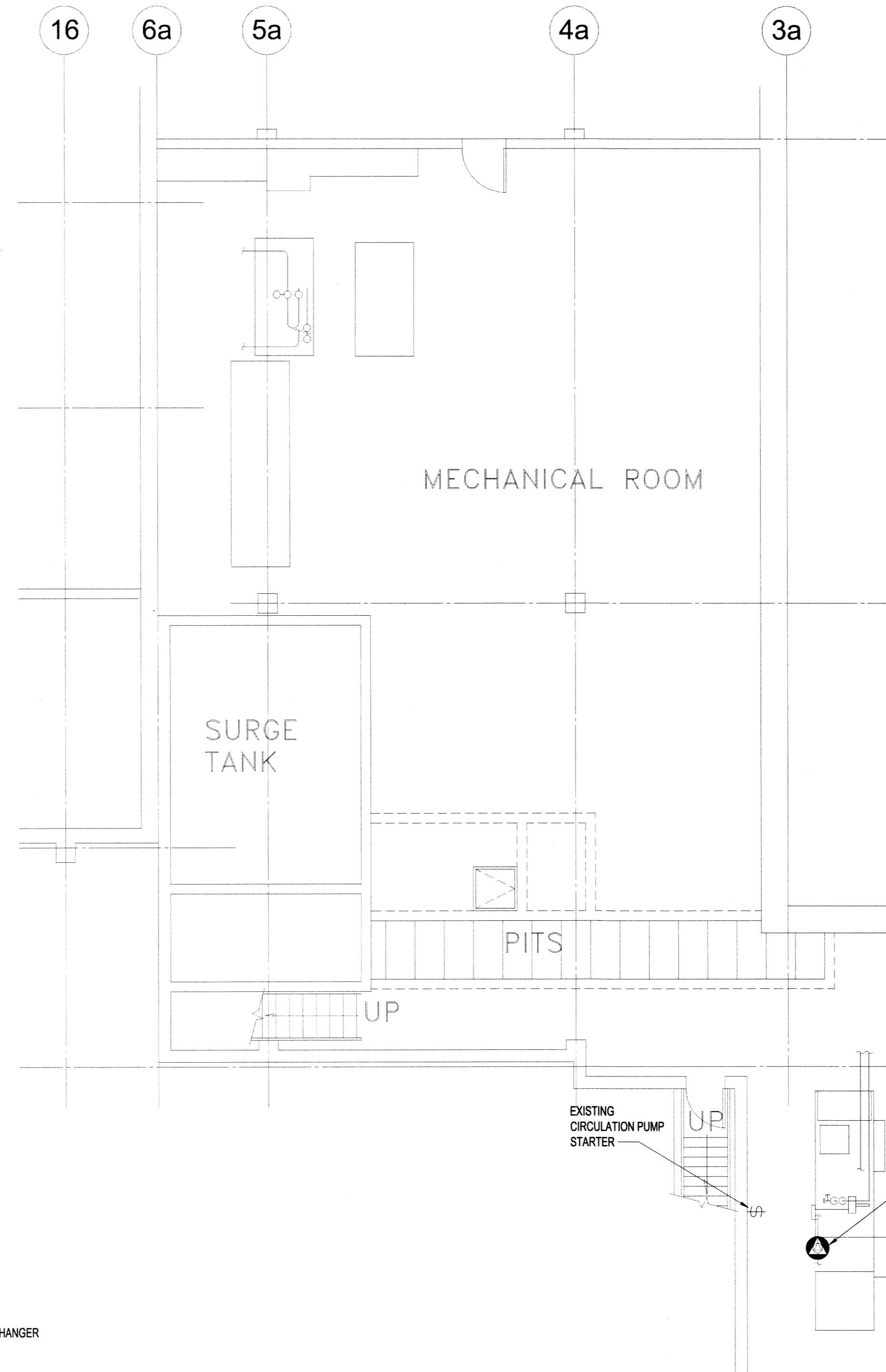

ELECTRICAL ROOM PLAN - NEW SCALE: 1:75

