

WEST ACCESS ROAD CONTROL LINE						
SEGMENT	STATION (START)	STATION (END)	NORTHING (START)	EASTING (START)	NORTHING (END)	EASTING (END)
L40	1+000.000	1+020.309	5523352.771	630898.988	5523353.830	630878.706
C23	1+020.309	1+038.667	5523353.830	630878.706	5523365.431	630866.458
L41	1+038.667	1+172.675	5523365.431	630866.458	5523498.680	630852.217
C24	1+172.675	1+186.624	5523498.680	630852.217	5523512.608	630851.705
L42	1+186.624	1+230.168	5523512.608	630851.705	5523556.128	630853.142

CURVE DATA						
#	R.	Δc	Tc	L.	L.C.	
C23	13.000	80°54'38"	11.086	18.358	16.870	
C24	100.000	7°59'31"	6.986	13.949	13.937	

LEGEND		
b.o.c.	-	BACK OF CURB
f.o.g.	-	FACE OF 600mm WIDE CURB AND GUTTER PAN

COMMERCIAL APPROACH ENTRANCE						
SEGMENT	STATION (START)	STATION (END)	NORTHING (START)	EASTING (START)	NORTHING (END)	EASTING (END)
L45	0+000.000	0+026.064	5523373.852	630976.927	5523374.804	630950.880
C26	0+026.064	0+073.188	5523374.804	630950.880	5523345.919	630919.804

CURVE DATA						
#	R.	Δc	Tc	L.	L.C.	
C26	30.000	90°00'00"	30.000	47.124	42.426	

EAST ACCESS ROAD CONTROL LINE						
SEGMENT	STATION (START)	STATION (END)	NORTHING (START)	EASTING (START)	NORTHING (END)	EASTING (END)
L43	1+000.000	1+130.507	5523379.770	630945.002	5523508.115	630968.653
C25	1+130.507	1+144.576	5523508.115	630968.653	5523522.083	630970.251
L44	1+144.576	1+203.649	5523522.083	630970.251	5523581.094	630972.946

CURVE DATA						
#	R.	Δc	Tc	L.	L.C.	
C25	103.000	7°49'36"	7.046	14.070	14.059	

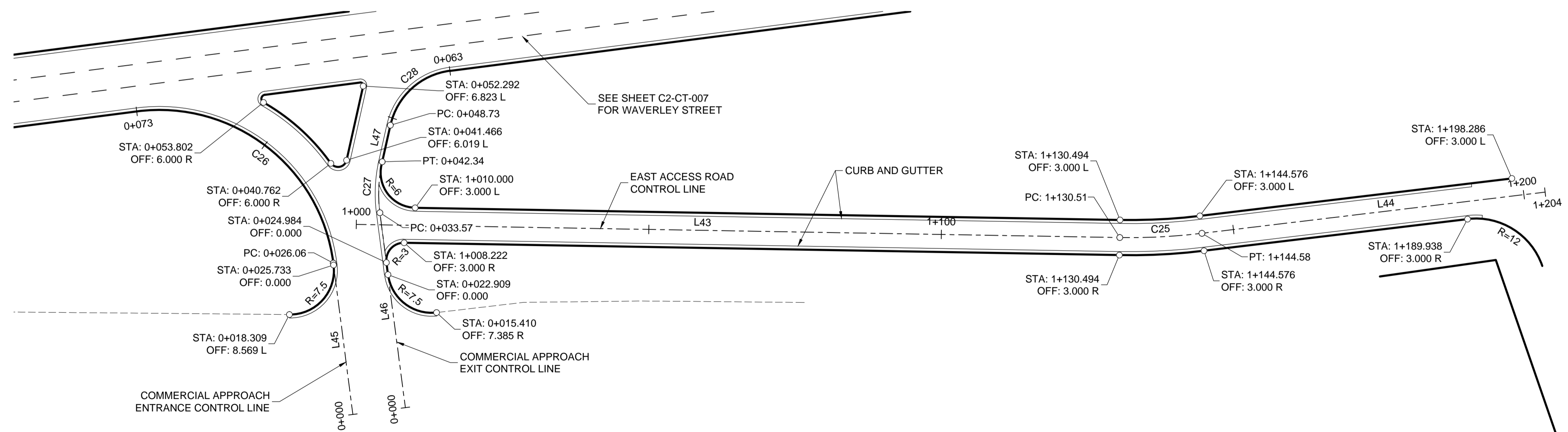

COMMERCIAL APPROACH EXIT						
SEGMENT	STATION (START)	STATION (END)	NORTHING (START)	EASTING (START)	NORTHING (END)	EASTING (END)
L46	0+000.000	0+033.572	5523382.897	630977.257	5523384.071	630943.705
C27	0+033.572	0+042.338	5523384.071	630943.705	5523385.891	630935.176
L47	0+042.338	0+048.730	5523385.891	630935.176	5523388.295	630929.254
C28	0+048.730	0+063.391	5523388.295	630929.254	5523399.852	630921.775

CURVE DATA						
#	R.	Δc	Tc	L.	L.C.	
C27	25.000	20°05'24"	4.428	8.766	8.721	
C28	12.000	70°00'00"	8.402	14.661	13.766	

UNDERGROUND STRUCTURES			
SUPPLY	U/G STRUCTURES	DATE	
<small>LOCATION OF UNDERGROUND STRUCTURES AS SHOWN ARE BASED ON THE BEST INFORMATION AVAILABLE, BUT NO GUARANTEE IS GIVEN THAT ALL EXISTING UTILITIES ARE SHOWN OR THAT THE GIVEN LOCATIONS ARE EXACT. CONFIRMATION OF EXISTENCE AND EXACT LOCATION OF ALL SERVICES MUST BE OBTAINED FROM THE INDIVIDUAL UTILITIES BEFORE PROCEEDING WITH CONSTRUCTION.</small>			

B.M. ELEV.			
NO.	REVISIONS	DATE	BY
0	ISSUED FOR TENDER	17/01/09	DBW

DILLON CONSULTING

DESIGNED BY: RTP	CHECKED BY: DBW
DRAWN BY: TJH	APPROVED BY: DBW
HOR. SCALE: 1:500	RELEASED FOR CONSTRUCTION
VERTICAL	

ENGINEER'S SEAL

CONSULTANT PROJECT NUMBER: 16-3353

THE CITY OF WINNIPEG PUBLIC WORKS DEPARTMENT

Winnipeg

WAVERLEY STREET UNDERPASS AT CN MILE 3.89 RIVERS SUB
CONTRACT 2: UNDERPASS STRUCTURES, RAILWORKS, ROADWORKS, LAND DRAINAGE SEWER, PUMPING STATION AND LANDSCAPING WORKS

CITY DRAWING NUMBER: U-239-2016-C2-CT-013
SHEET: 013 OF 081
CONSULTANT DRAWING NUMBER: C2-CT-013

CONTROL LINE GEOMETRY ACCESS ROADS

APEGM
Certificate of Authorization
Dillon Consulting Limited (MB)
No. 1789 Date: 17/01/09

G:\CAD\163353\Technical Workspace\Engineering\Drawings and Figures\Roadworks\Contract\163353-C2-CON-CT-CONTROL-LINE-GEOMETRY.dwg