

WAVERLEY STREET SOUTHBOUND

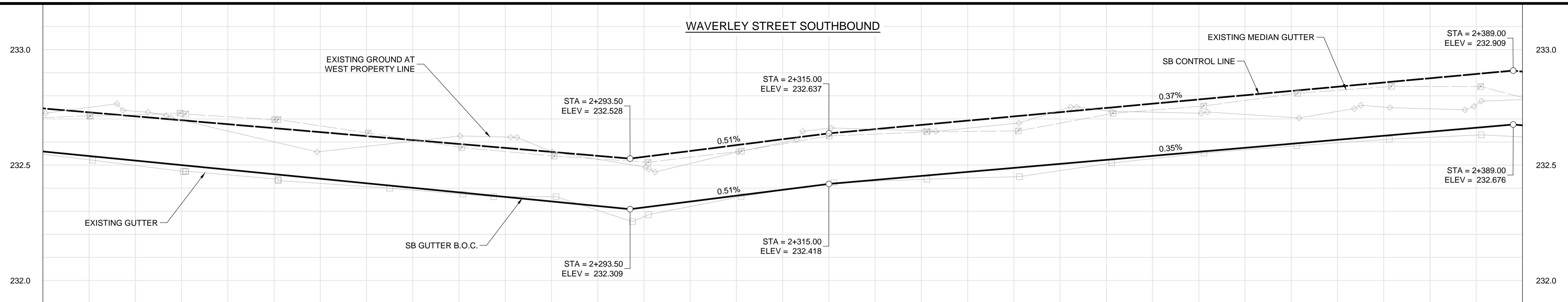

WAVERLEY STREET NORTHBOUND

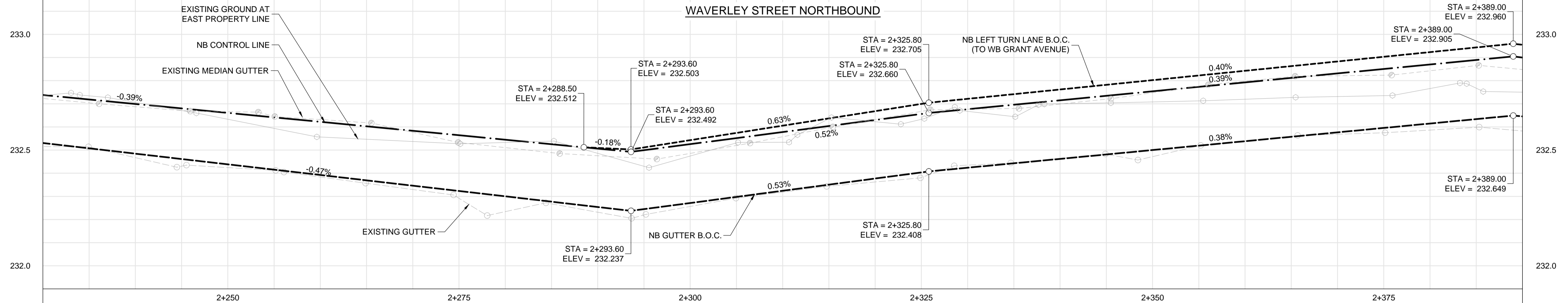

CONSTRUCTION NOTES:

- ISOLATE MISCELLANEOUS ITEMS IN NEW CONCRETE WORKS AS PER SD-228C.
- LEGAL PLAN AND UNDERGROUND INFORMATION FROM CITY OF WINNIPEG LBS. CONTRACTOR VERIFY ALL UNDERGROUNDS IN THE FIELD.
- CONTRACTOR TO TAKE PRECAUTIONARY STEPS TO AVOID DAMAGE FROM CONSTRUCTION ACTIVITIES TO TREES WITHIN THE LIMITS OF CONSTRUCTION.
- LOCATION OF EXISTING SERVICES TO BE CONFIRMED IN THE FIELD BY THE CONTRACTOR.
- INSTALL CB LEADS AT MIN. 1.0% SLOPE OR AS DIRECTED BY CONTRACT ADMINISTRATOR.
- FOR CB LEADS, RIP RAP AND LDS INFORMATION SEE "CU" DRAWINGS.
- CONTRACTOR SHALL CONFIRM EXISTING LEAD INVERT ELEVATIONS PRIOR TO INSTALLATION.

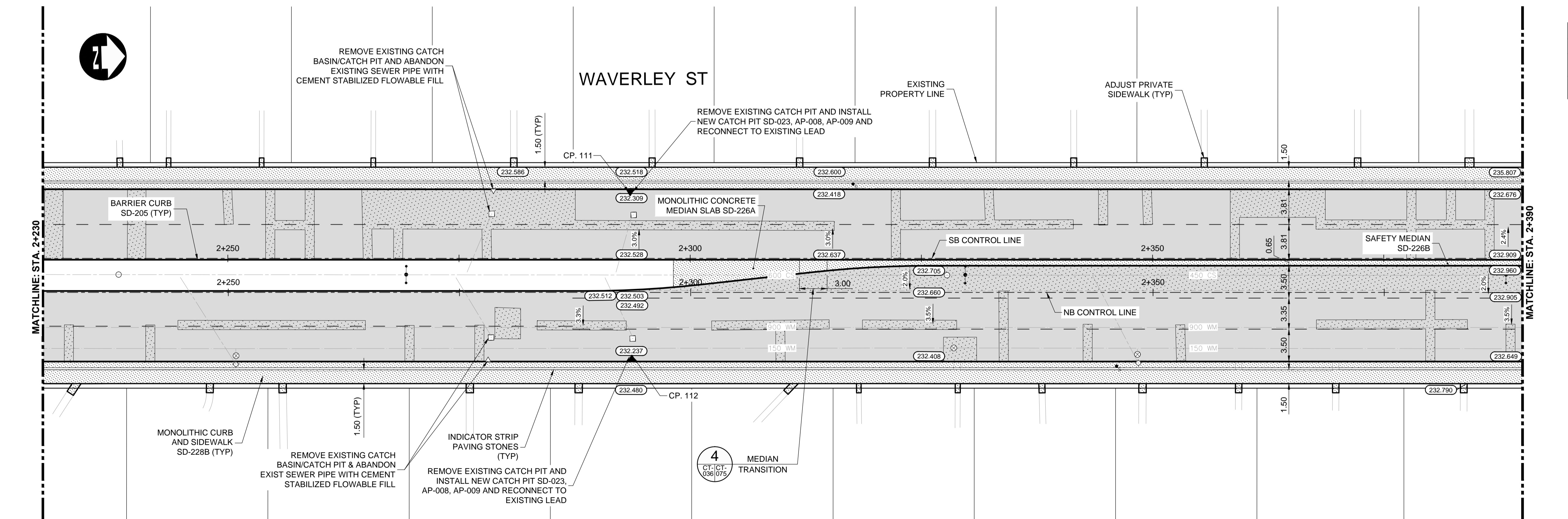

CATCH BASINS					
CB	STA	AP	RIM	BTM	INV
CP. 111	2+293	AP-008 AP-009	232.309		231.459
CP. 112	2+293	AP-008 AP-009	232.237		231.387

**APEGM**  
Certificate of Authorization  
Dillon Consulting Limited (MB)  
No. 1789 Date: 17/01/09

EXISTING	LEGEND-PLAN	PROPOSED	EXISTING	LEGEND-PLAN	PROPOSED	EXISTING	LEGEND-PROFILE	PROPOSED
150 WM	WATERMAIN	150 WM	CONCRETE	ASPHALT	150 WM	WATERMAIN	150 WM	WATERMAIN
300 LDS	HYDRANT	300 LDS	CONCRETE	PLANING	300 LDS	LAND DRAINAGE SEWER	300 LDS	LAND DRAINAGE SEWER
250 WWS	VALVE	250 WWS	CONCRETE	SIDEWALK	250 WWS	WASTE WATER SEWER	250 WWS	WASTE WATER SEWER
100 GAS	MANHOLE	100 GAS	CONCRETE	PAVING STONES	100 GAS	HYDRANT	100 GAS	HYDRANT
	CATCH BASIN		CONCRETE	PARTIAL DEPTH REPAIR		VALVE		VALVE
	CURB INLET		CONCRETE	PROPERTY LINE		C PROFILE		C PROFILE
	LAND DRAINAGE SEWER		CONCRETE	DRAINAGE ARROW		NORTH/WEST GUTTER		NORTH/WEST GUTTER
	WASTE WATER SEWER		CONCRETE	CURB RAMP (SD-229C)		SOUTH/EAST GUTTER		SOUTH/EAST GUTTER
	HYDRO		CONCRETE	DETECTABLE WARNING SURFACE TILE (SD-229AA)		NORTH/WEST DITCH		NORTH/WEST DITCH
	M.T.S.					SOUTH/EAST DITCH		SOUTH/EAST DITCH
	GAS							

UNDERGROUND STRUCTURES	
SUPPLY	DATE

B.M. ELEV.	SEE SHEET C2-CT-007 FOR CONTROL POINT INFORMATION

DESIGNED BY	CHECKED BY
PMW	RTP
DRAWN BY	APPROVED BY
RD	DBW
HOR. SCALE	RELEASED FOR CONSTRUCTION
1:250	
VERTICAL	DATE
1:10	

ENGINEER'S SEAL  
PROVINCE OF MANITOBA  
D.B. WIEBE  
Member 22480  
REGISTERED PROFESSIONAL ENGINEER  
CONSULTANT PROJECT NUMBER  
16-3353

**THE CITY OF WINNIPEG**  
PUBLIC WORKS DEPARTMENT  
Winnipeg  
WAVERLEY STREET UNDERPASS AT CN MILE 3.89 RIVERS SUB  
CONTRACT 2: UNDERPASS STRUCTURES, RAILWORKS,  
ROADWORKS, LAND DRAINAGE SEWER, PUMPING STATION  
AND LANDSCAPING WORKS  
WAVRLEY STREET - STA. 2+225 TO 2+385  
(PLAN-PROFILE)

CITY DRAWING NUMBER  
U-239-2016-C2-CT-036  
SHEET 036 OF 081  
CONSULTANT DRAWING NUMBER  
C2-CT-036

G:\CAD\163353\Technical\Workspaces\Drawings and Figures\Roadworks\Contract\163353-C2-CON-CT-PLAN-PROFILE-WAVERLEY-NORTH.dwg