

TAYLOR AVENUE WESTBOUND

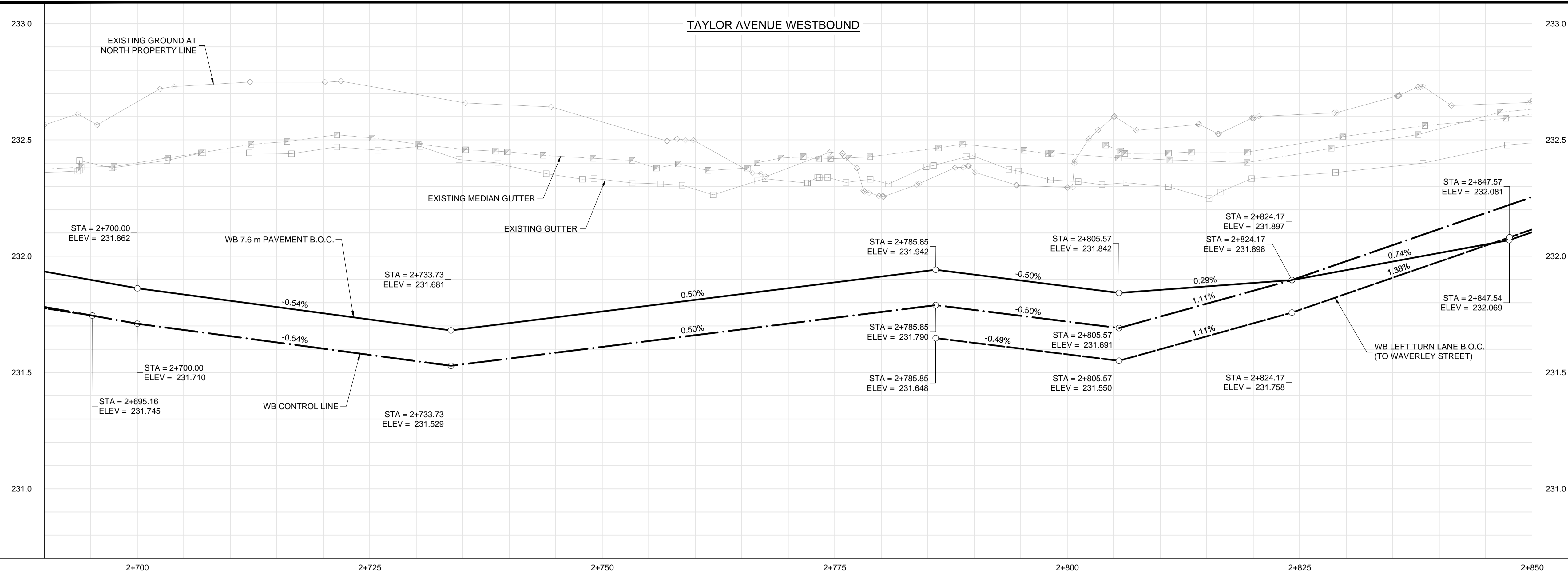

TAYLOR AVENUE EASTBOUND

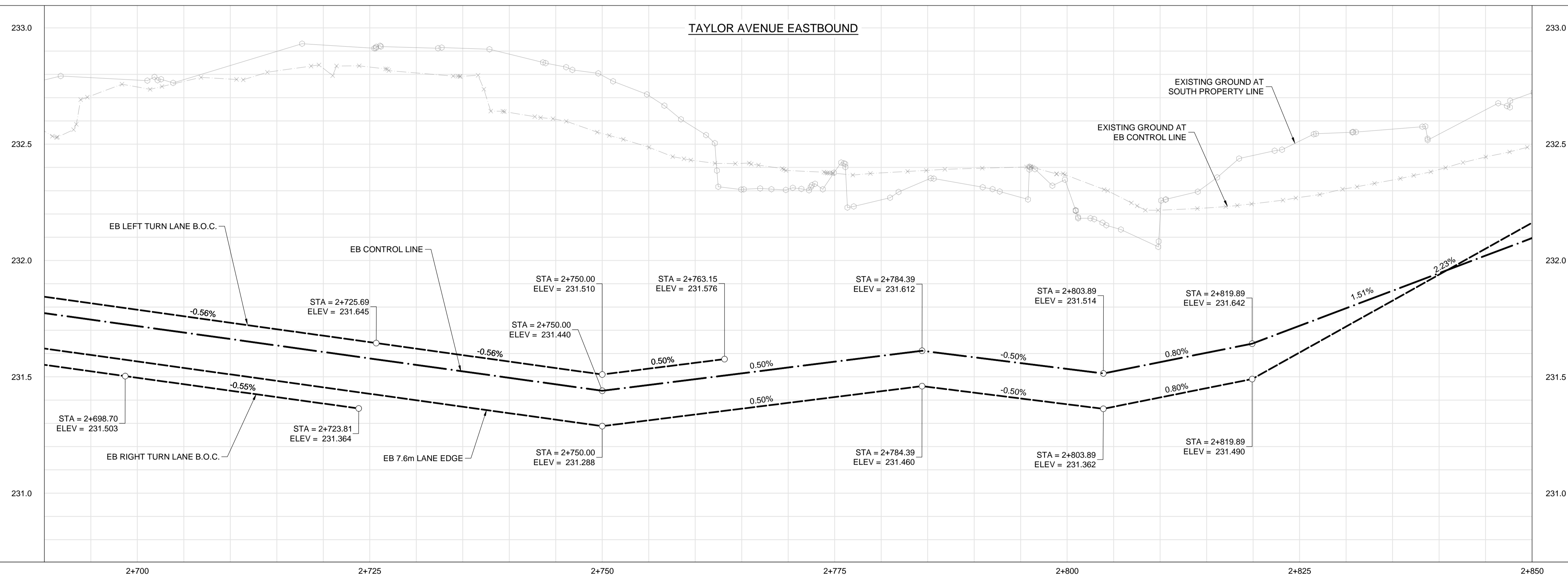

CONSTRUCTION NOTES:

- ISOLATE MISCELLANEOUS ITEMS IN NEW CONCRETE WORKS AS PER SD-228C.
- LEGAL PLAN AND UNDERGROUND INFORMATION FROM CITY OF WINNIPEG LBIS. CONTRACTOR VERIFY ALL UNDERGROUNDS IN THE FIELD.
- CONTRACTOR TO TAKE PRECAUTIONARY STEPS TO AVOID DAMAGE FROM CONSTRUCTION ACTIVITIES TO TREES WITHIN THE LIMITS OF CONSTRUCTION.
- LOCATION OF EXISTING SERVICES TO BE CONFIRMED IN THE FIELD BY THE CONTRACTOR.
- INSTALL CB LEADS AT MIN. 1.0% SLOPE OR AS DIRECTED BY CONTRACT ADMINISTRATOR.
- FOR CB LEADS, RIP RAP AND LDS INFORMATION SEE "CU" DRAWINGS.
- CONTRACTOR SHALL CONFIRM EXISTING LEAD INVERT ELEVATIONS PRIOR TO INSTALLATION.

METRIC

WHOLE NUMBERS INDICATE MILLIMETRES
DECIMALIZED NUMBERS INDICATE METRES

WARNING

IF POWER EQUIPMENT OR EXPLOSIVES ARE TO BE USED FOR EXCAVATION ON THIS PROJECT THE CONTRACTOR MUST:

- NOTIFY THE GAS COMPANY OF THE PROPOSED LOCATION OF EXCAVATION.
- TAKE PRECAUTION TO AVOID DAMAGE TO GAS COMPANY INSTALLATIONS SEE PROVINCIAL REGULATION 210/72 FOR DETAILS.
- OBTAIN EXCAVATION PERMITS PRIOR TO CONSTRUCTION.



G:\CAD\163353\Technical\Workspace\Engineering\Drawings and Figures\Roadworks\Contract\163353-C2-CON-CT-PLAN-PROFILE-TAYLOR.dwg

		CONCRETE ASPHALT PLANING SIDEWALK PAVING STONES PARTIAL DEPTH REPAIR PROPERTY LINE DRAINAGE ARROW CURB RAMP (SD-229C) DETECTABLE WARNING SURFACE TILE (SD-229AA)		WATERMAIN LAND DRAINAGE SEWER WASTE WATER SEWER HYDRANT VALVE M.T.S. GAS		UNDERGROUND STRUCTURES SUPPLY, U/G STRUCTURES DATE LOCATION OF UNDERGROUND STRUCTURES AS SHOWN ARE BASED ON THE BEST INFORMATION AVAILABLE BUT NO GUARANTEE IS GIVEN THAT ALL EXISTING UTILITIES ARE SHOWN OR THAT THE GIVEN LOCATIONS ARE EXACT. CONFIRMATION OF EXISTENCE AND EXACT LOCATION OF ALL SERVICES MUST BE OBTAINED FROM THE INDIVIDUAL UTILITIES BEFORE PROCEEDING WITH CONSTRUCTION.		B.M. ELEV. SEE SHEET C2-CT-007 FOR CONTROL POINT INFORMATION				ENGINEER'S SEAL 				WAYERLEY STREET UNDERPASS AT CN MILE 3.89 RIVERS SUB CONTRACT 2: UNDERPASS STRUCTURES, RAILWORKS, ROADWORKS, LAND DRAINAGE SEWER, PUMPING STATION AND LANDSCAPING WORKS		CITY DRAWING NUMBER U-239-2016-C2-CT-046 SHEET 046 OF 081	
						DESIGNED BY RTP CHECKED BY DBW DRAWN BY RD APPROVED BY DBW HOR. SCALE 1:250 VERTICAL 1:10 RELEASED FOR CONSTRUCTION		CONSULTANT PROJECT NUMBER 16-3353		TAYLOR AVENUE - STA. 2+690 TO 2+850 (WB & EB PROFILES)				CONSULTANT DRAWING NUMBER C2-CT-046					
EXISTING LEGEND-PLAN PROPOSED EXISTING		LEGEND-PLAN PROPOSED EXISTING		LEGEND-PROFILE PROPOSED EXISTING		NO. REVISIONS DATE BY		0 ISSUED FOR TENDER 17/01/09 DBW											