

- CONSTRUCTION NOTES:**
- ISOLATE MISCELLANEOUS ITEMS IN NEW CONCRETE WORKS AS PER SD-228C.
 - LEGAL PLAN AND UNDERGROUND INFORMATION FROM CITY OF WINNIPEG LBIS. CONTRACTOR VERIFY ALL UNDERGROUNDS IN THE FIELD.
 - CONTRACTOR TO TAKE PRECAUTIONARY STEPS TO AVOID DAMAGE FROM CONSTRUCTION ACTIVITIES TO TREES WITHIN THE LIMITS OF CONSTRUCTION.
 - LOCATION OF EXISTING SERVICES TO BE CONFIRMED IN THE FIELD BY THE CONTRACTOR.
 - INSTALL CB LEADS AT MIN. 1.0% SLOPE OR AS DIRECTED BY CONTRACT ADMINISTRATOR.
 - FOR CB LEADS, RIP RAP AND LDS INFORMATION SEE "CU" DRAWINGS.
 - CONTRACTOR SHALL CONFIRM EXISTING LEAD INVERT ELEVATIONS PRIOR TO INSTALLATION.

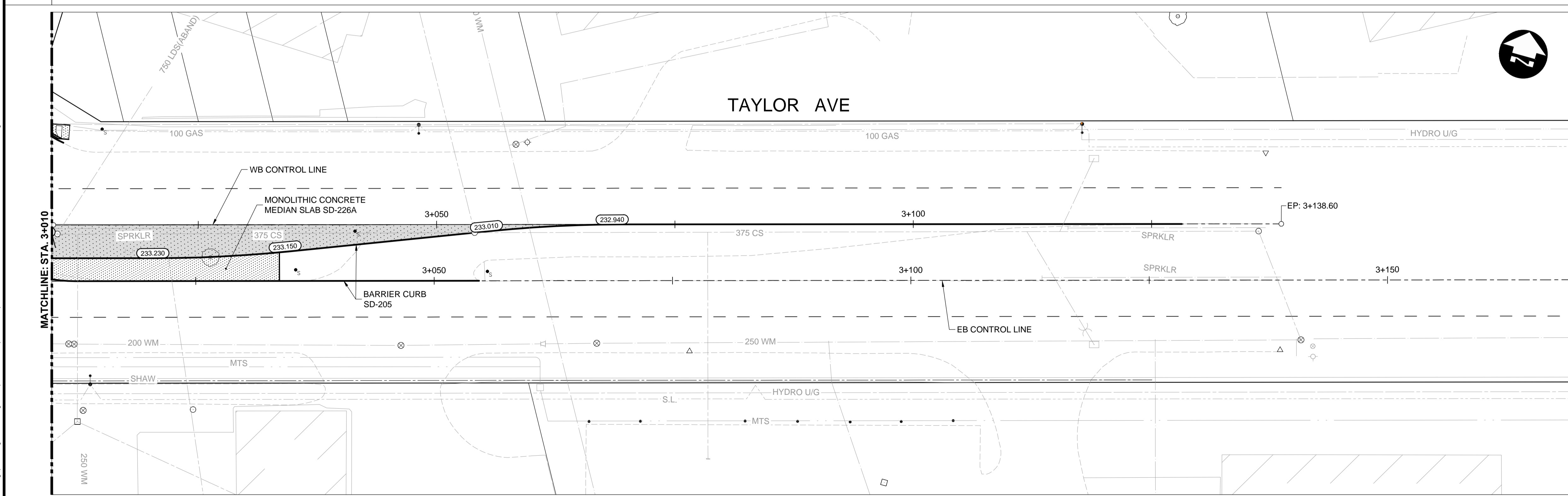

METRIC
 WHOLE NUMBERS INDICATE MILLIMETRES
 DECIMALIZED NUMBERS INDICATE METRES

- WARNING**
- IF POWER EQUIPMENT OR EXPLOSIVES ARE TO BE USED FOR EXCAVATION ON THIS PROJECT THE CONTRACTOR MUST:
- NOTIFY THE GAS COMPANY OF THE PROPOSED LOCATION OF EXCAVATION.
 - TAKE PRECAUTION TO AVOID DAMAGE TO GAS COMPANY INSTALLATIONS SEE PROVINCIAL REGULATION 210/72 FOR DETAILS.
 - OBTAIN EXCAVATION PERMITS PRIOR TO CONSTRUCTION.



150 WM	WATERMAIN	150 WM	CONCRETE	150 WM	WATERMAIN	150 WM	WATERMAIN
HYDRANT	HYDRANT	ASPHALT	150 WM	LAND DRAINAGE SEWER	150 WM	LAND DRAINAGE SEWER	150 WM
VALVE	VALVE	PLANING	300 LDS	WASTE WATER SEWER	300 LDS	WASTE WATER SEWER	300 LDS
MANHOLE	MANHOLE	SIDEWALK	250 WWS	HYDRANT	250 WWS	HYDRANT	250 WWS
CATCH BASIN	CATCH BASIN	PAVING STONES	+	VALVE	+	VALVE	+
CURB INLET	CURB INLET	PARTIAL DEPTH REPAIR	-	Q PROFILE	-	Q PROFILE	-
300 LDS	LAND DRAINAGE SEWER	PROPERTY LINE	---	NORTH/WEST GUTTER	---	NORTH/WEST GUTTER	---
250 WWS	WASTE WATER SEWER	DRAINAGE ARROW	→	SOUTH/EAST GUTTER	---	SOUTH/EAST GUTTER	---
HYDRO	HYDRO	CURB RAMP (SD-229C)	▬	NORTH/WEST DITCH	---	NORTH/WEST DITCH	---
M.T.S.	M.T.S.	DETECTABLE WARNING SURFACE TILE (SD-229AA)	▬	SOUTH/EAST DITCH	---	SOUTH/EAST DITCH	---
100 GAS	GAS						
EXISTING	LEGEND-PLAN	PROPOSED	EXISTING	LEGEND-PROFILE	PROPOSED	EXISTING	LEGEND-PROFILE

UNDERGROUND STRUCTURES

SUPPLY: U/G STRUCTURES DATE

LOCATION OF UNDERGROUND STRUCTURES AS SHOWN ARE BASED ON THE BEST INFORMATION AVAILABLE. BUT NO GUARANTEE IS GIVEN THAT ALL EXISTING UTILITIES ARE SHOWN OR THAT THE GIVEN LOCATIONS ARE EXACT. CONFIRMATION OF EXISTENCE AND EXACT LOCATION OF ALL SERVICES MUST BE OBTAINED FROM THE INDIVIDUAL UTILITIES BEFORE PROCEEDING WITH CONSTRUCTION.

B.M. ELEV. SEE SHEET C2-CT-007 FOR CONTROL POINT INFORMATION

DESIGNED BY	RTP	CHECKED BY	DBW
DRAWN BY	RD	APPROVED BY	DBW
HOR. SCALE	1:250	RELEASED FOR CONSTRUCTION	
VERTICAL	1:10	DATE	

ENGINEER'S SEAL

PROVINCE OF MANITOBA
D.B. WIEBE
 Member 22480
 REGISTERED PROFESSIONAL ENGINEER

CONSULTANT PROJECT NUMBER
16-3353

THE CITY OF WINNIPEG
 PUBLIC WORKS DEPARTMENT

Waverley Street Underpass at CN Mile 3.89 Rivers Sub
 Contract 2: Underpass Structures, Railworks, Roadworks, Land Drainage Sewer, Pumping Station and Landscaping Works

TAYLOR AVENUE - STA. 3+010 TO END (PLAN-PROFILE)

CITY DRAWING NUMBER
 U-239-2016-C2-CT-049

SHEET 049 OF 081

CONSULTANT DRAWING NUMBER
C2-CT-049

G:\CAD\163353\Technical\Workspace\Engineering\Drawings and Figures\Roadworks\Contract\163353-C2-CON-CT-PLAN-PROFILE-TAYLOR.dwg