

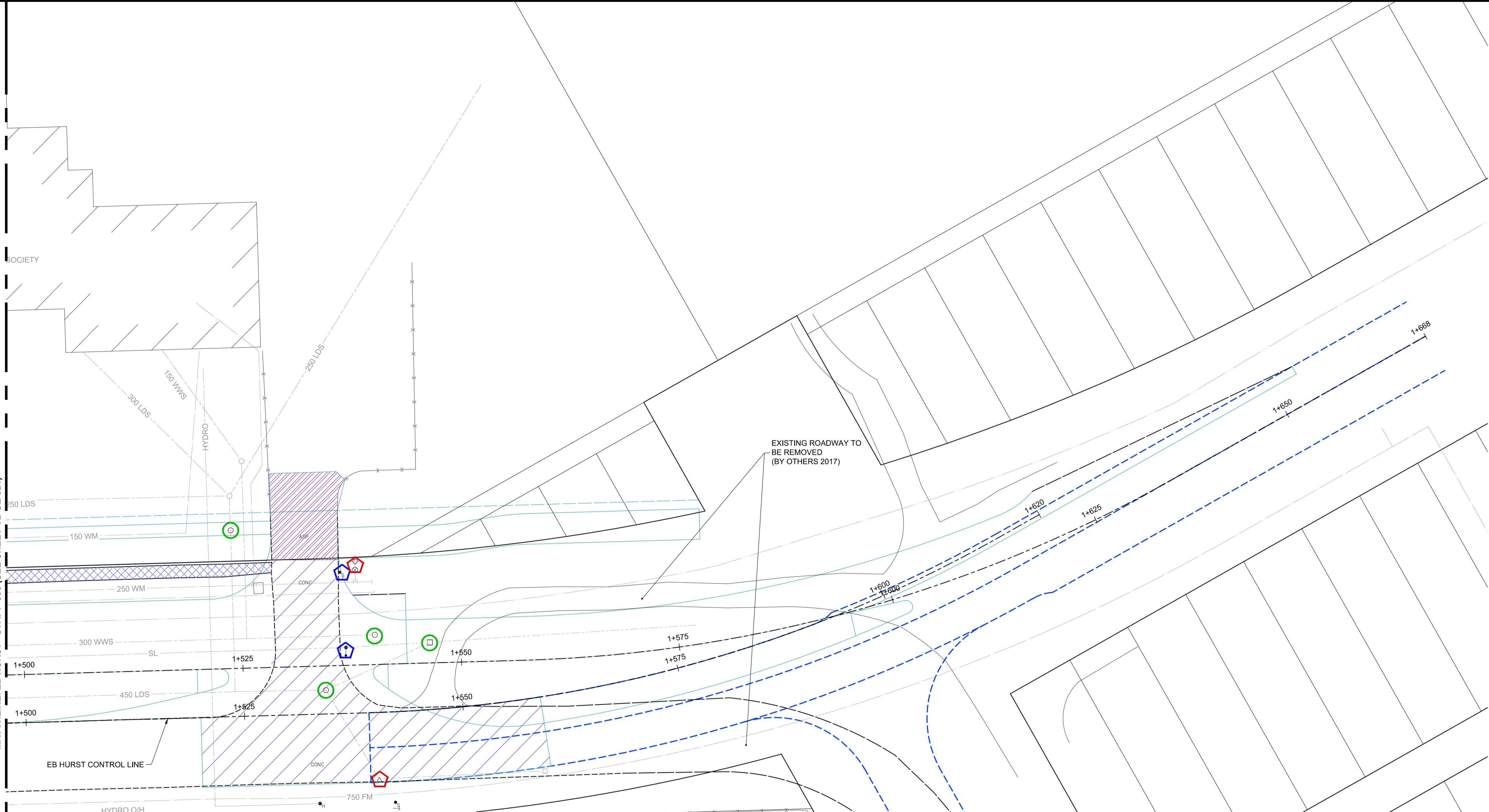

MATCHLINE: EB HURST - STA. 1+500 (SEE SHEET C2-GE-021)



LEGEND

REMOVALS / RELOCATES

REMOVALS / RELOCATES BY OTHERS

ADJUSTMENTS

CONCRETE SIDEWALK REMOVAL

ASPHALT SIDEWALK REMOVAL

CONCRETE REMOVAL

ASPHALT REMOVAL

ASPHALT PLANING

NOTE:

1) SEE LANDSCAPING DRAWINGS FOR TREE REMOVALS (TYP.)

2) SEE UNDERGROUND DRAWINGS FOR UNDERGROUND REMOVALS (TYP.)

APEGM

Certificate of Authorization

Dillon Consulting Limited (MB)

No. 1789 Date: 17/01/09

150 WM	WATERMAIN	150 WM	CONCRETE	150 WM	WATERMAIN	150 WM
HYDRANT	HYDRANT	ASPHALT	LAND DRAINAGE SEWER	300 LDS	LAND DRAINAGE SEWER	300 LDS
VALVE	VALVE	PLANING	WASTE WATER SEWER	250 WWS	WASTE WATER SEWER	250 WWS
MANHOLE	MANHOLE	SIDEWALK	HYDRANT		HYDRANT	
CATCH BASIN	CATCH BASIN	PAVING STONES	VALVE		VALVE	
CURB INLET	CURB INLET	PARTIAL DEPTH REPAIR	Q PROFILE		Q PROFILE	
300 LDS	LAND DRAINAGE SEWER	PROPERTY LINE	NORTH/WEST GUTTER		NORTH/WEST GUTTER	
250 WWS	WASTE WATER SEWER	DRAINAGE ARROW	SOUTH/EAST GUTTER		SOUTH/EAST GUTTER	
HYDRO	HYDRO	CURB RAMP (SD-229C)	NORTH/WEST DITCH		NORTH/WEST DITCH	
MTS	M.T.S.	DETECTABLE WARNING	SOUTH/EAST DITCH		SOUTH/EAST DITCH	
100 GAS	GAS	SURFACE TILE (SD-229AA)				
EXISTING	LEGEND-PLAN	PROPOSED	EXISTING	LEGEND-PROFILE	PROPOSED	EXISTING

UNDERGROUND STRUCTURES

SUPV. U/G STRUCTURES DATE

LOCATION OF UNDERGROUND STRUCTURES AS SHOWN ARE BASED ON THE BEST INFORMATION AVAILABLE, BUT NO GUARANTEE IS GIVEN THAT ALL EXISTING UTILITIES ARE SHOWN OR THAT THE GIVEN LOCATIONS ARE EXACT. CONFIRMATION OF EXISTENCE AND EXACT LOCATION OF ALL SERVICES MUST BE OBTAINED FROM THE INDIVIDUAL UTILITIES BEFORE PROCEEDING WITH CONSTRUCTION.

B.M. ELEV.			
NO.	REVISIONS	DATE	BY
0	ISSUED FOR TENDER	17/01/09	DBW

DILLON CONSULTING

DESIGNED BY	PMW	CHECKED BY	RTP
DRAWN BY	RD	APPROVED BY	DBW
HOR. SCALE	1:250	RELEASED FOR CONSTRUCTION	
VERTICAL		DATE	

ENGINEER'S SEAL

PROVINCE OF MANITOBA

D.B. WIEBE

Member 22480

REGISTERED PROFESSIONAL ENGINEER

CONSULTANT PROJECT NUMBER

16-3353

THE CITY OF WINNIPEG

PUBLIC WORKS DEPARTMENT

Waverley Street Underpass at CN Mile 3.89 Rivers Sub

CONTRACT 2: UNDERPASS STRUCTURE, RAILWORKS, ROADWORKS, LAND DRAINAGE SEWER, PUMPING STATION AND LANDSCAPING WORKS

CITY DRAWING NUMBER U-239-2016-C2-GE-022

SHEET 022 OF 052

CONSULTANT DRAWING NUMBER C2-GE-022

HURST REMOVALS (2 OF 2)

G:\CAD\163353\Technical\Workspace\Engineering\Drawings and Figures\Roadworks\Contract\163353-C2-CON-CI-REMOVALS.dwg