

REFER TO C2-LS-011 FOR  
TAYLOR AVE LANDSCAPE PLAN

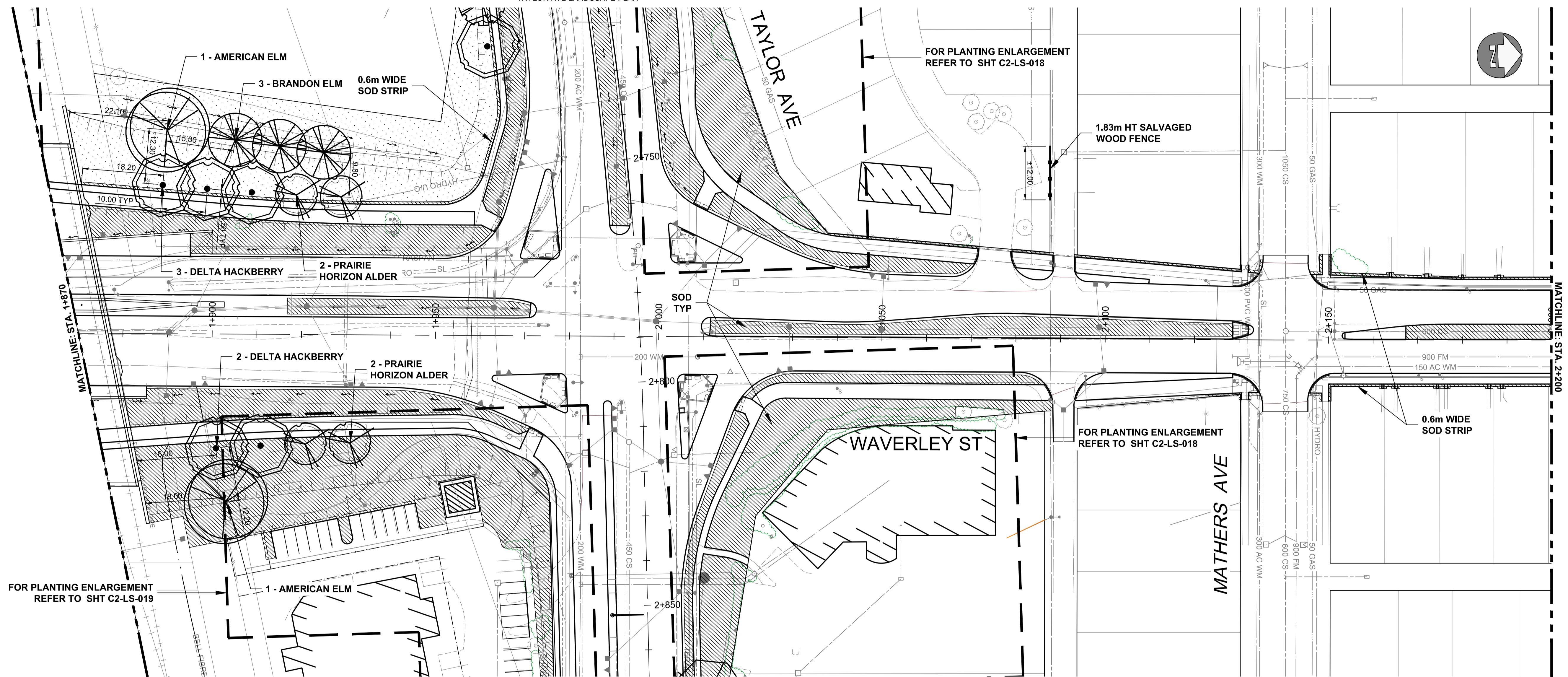

FOR PLANTING ENLARGEMENT  
REFER TO SHT C2-LS-019

FOR PLANTING ENLARGEMENT  
REFER TO SHT C2-LS-018

REFER TO C2-LS-012 FOR  
TAYLOR AVE LANDSCAPE PLAN

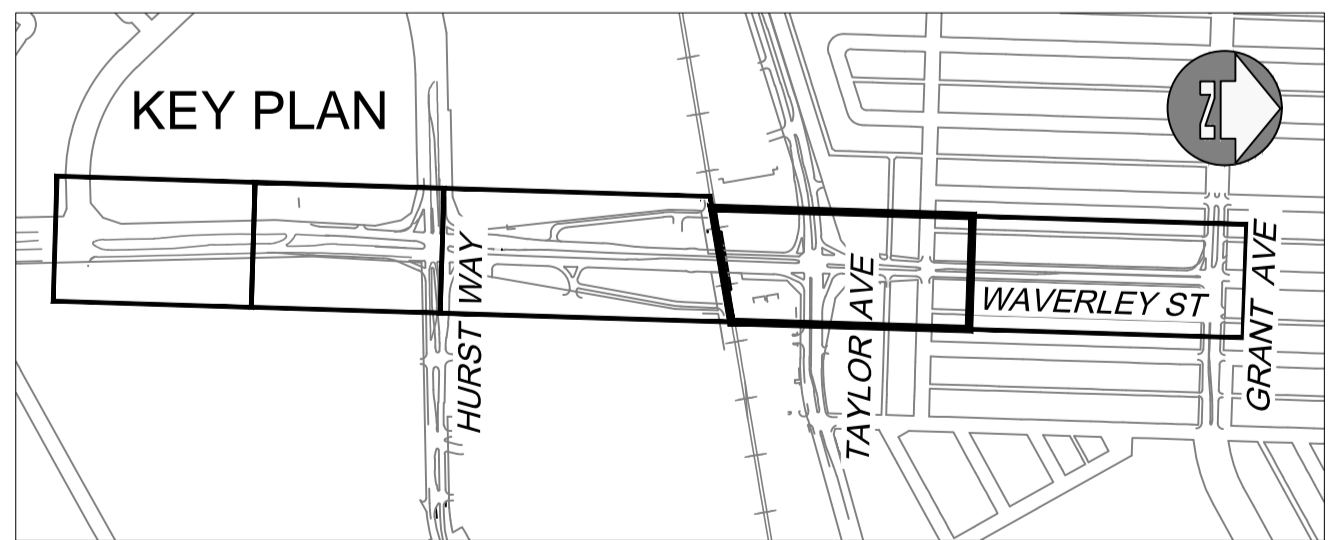

**PLANT LIST (FOR SHEETS C2-LS-005 TO 006 AND C2-LS-009 TO 012)**

No.	COMMON NAME	BOTANICAL NAME	CALIPER OR HT	NOTES	SPACING
<b>DECIDUOUS TREES - LARGE</b>					
11	Baron Manitoba Maple	<i>Acer negundo</i>	65mm cal.	B&B/Machine	AS NOTED
3	Silver Maple	<i>Acer saccharinum</i>	65mm cal.	B&B/Machine	AS NOTED
29	Ohio Buckeye	<i>Aesculus glabra</i>	50mm cal.	B&B/Machine	AS NOTED
18	Prairie Horizon Alder	<i>Alnus hisuta 'Harbin'</i>	50mm cal.	B&B/Machine	AS NOTED
30	Delta Hackberry	<i>Celtis occidentalis 'Delta'</i>	50mm cal.	B&B/Machine	AS NOTED
1	Patmore Green Ash	<i>Fraxinus pennsylvanica 'Patmore'</i>	65mm cal.	B&B/Machine	AS NOTED
6	Bur Oak	<i>Quercus macrocarpa</i>	45mm cal.	B&B/Machine	AS NOTED
6	Glenleven Linden	<i>Tilia x flavescens 'Glenleven'</i>	65mm cal.	B&B/Machine	NA
2	Harvest Gold Linden	<i>Tilia mongolica 'Harvest Gold'</i>	65mm cal.	B&B/Machine	AS NOTED
10	American Elm	<i>Ulmus americana</i>	65mm cal.	B&B/Machine	AS NOTED
16	Brandon Elm	<i>Ulmus americana 'Brandon'</i>	65mm cal.	B&B/Machine	AS NOTED
<b>DECIDUOUS TREES - SMALL</b>					
9	Amur Maple	<i>Acer ginnala</i>	50mm cal.	B&B/Machine	AS NOTED
7	Gladiator Crabapple	<i>Malus 'Gladiator'</i>	50mm cal.	B&B/Machine	AS NOTED
5	Pink Spires Crabapple	<i>Malus 'Pink Spires'</i>	50mm cal.	B&B/Machine	AS NOTED
13	Japanese Tree Lilac	<i>Syringa reticulata</i>	50mm cal.	B&B/Machine	AS NOTED
<b>CONIFEROUS TREES</b>					
8	Colorado Spruce	<i>Picea pungens 'var. glauca'</i>	2.4m ht.	B&B/Machine	NA

**(FOR SHEETS C2-LS-017 TO 019)**

No.	COMMON NAME	BOTANICAL NAME	CONTAINER CLASS / PLANT HT (WIDTH)	NOTES	SPACING
<b>CONIFEROUS SHRUBS</b>					
5	Big Tuna Mugo Pine	<i>Pinus mugo 'Big Tuna'</i>	#10 / 0.8m ht.	B&B/Container	NA
8	Gray Glean Juniper	<i>Juniperus scopulorum 'Gray Glean'</i>	#10 / 1.00m ht.	B&B/Container	AS NOTED
13	Calgary Carpet Juniper	<i>Juniperus horizontalis 'Calgary Carpet'</i>	#5 / 0.6m width	B&B/Container	AS NOTED
5	Hughes Juniper	<i>Juniperus horizontalis 'Hughes'</i>	#5 / 0.6m width	B&B/Container	AS NOTED
11	Blue Chip Juniper	<i>Juniperus horizontalis 'Blue Chip'</i>	#5 / 0.5m width	B&B/Container	AS NOTED
<b>DECIDUOUS SHRUBS</b>					
15	False Spirea	<i>Sorbaria sorbifolia</i>	#5 / 0.9m ht.	B&B/Container	2.1m o.c.
45	Meyer Lilac	<i>Syringa meyeri</i>	#5 / 0.9m ht.	B&B/Container	0.9m o.c.
45	Miss Kim Lilac	<i>Syringa patula 'Miss Kim'</i>	#5 / 0.9m ht.	B&B/Container	0.9m o.c.
12	Charles Joly Lilac	<i>Syringa vulgaris 'Charles Joly'</i>	#10 / 1.2m ht.	B&B/Container	2.1m o.c.
9	Nannyberry	<i>Viburnum lentago</i>	#5 / 0.9m ht.	B&B/Container	1.8m o.c.
45	Abotswood Potentilla	<i>Potentilla fruticosa 'Abbotswood'</i>	#5 / 0.4m ht.	B&B/Container	1.0m o.c.

SPECIFICATION: All plant material to be supplied and installed in accordance with the latest edition of Landscape Canada's Metric Guide Specifications for Nursery Stock  
NOTE: REFER TO PLANTING DETAILS, DRAWING C2-LS-020

**LEGEND**  

 BLUEGRASS/FESCUE SOD  
 HYDRO MULCH AND TURF SEED MIX

**METRIC**  
WHOLE NUMBERS INDICATE MILLIMETRES  
DECIMALIZED NUMBERS INDICATE METRES

**WARNING**  
IF POWER EQUIPMENT OR EXPLOSIVES ARE TO BE USED FOR EXCAVATION ON THIS PROJECT THE CONTRACTOR MUST:  
 1. NOTIFY THE GAS COMPANY OF THE PROPOSED LOCATION OF EXCAVATION.  
 2. TAKE PRECAUTION TO AVOID DAMAGE TO GAS COMPANY INSTALLATIONS SEE PROVINCIAL REGULATION 210/72 FOR DETAILS.  
 3. OBTAIN EXCAVATION PERMITS PRIOR TO CONSTRUCTION.

EXISTING	LEGEND-PLAN	PROPOSED	EXISTING	LEGEND-PLAN	PROPOSED	EXISTING	LEGEND-PROFILE	PROPOSED
	WATERMAIN			CONCRETE			ASPHALT	
	HYDRANT			SIDEWALK			PAVING STONES	
	VALVE			PROPERTY LINE			DRAINAGE ARROW	
	MANHOLE			CURB RAMP			CULVERT	
	CATCH BASIN			CURB INLET				
	300 LDS LAND DRAINAGE SEWER							
	250 WWS WASTE WATER SEWER							
	HYDRO							
	M.T.S.							
	100 GAS							

**UNDERGROUND STRUCTURES**  
SUPV. U/G STRUCTURES DATE

LOCATION OF UNDERGROUND STRUCTURES AS SHOWN ARE BASED ON THE BEST INFORMATION AVAILABLE BUT NO GUARANTEE IS GIVEN THAT ALL EXISTING UTILITIES ARE SHOWN OR THAT THE GIVEN LOCATIONS ARE EXACT. CONFIRMATION OF EXISTENCE AND EXACT LOCATION OF ALL SERVICES MUST BE OBTAINED FROM THE INDIVIDUAL UTILITIES BEFORE PROCEEDING WITH CONSTRUCTION.

B.M. ELEV.	NO.	REVISIONS	DATE	BY
	0	ISSUED FOR TENDER	17/01/09	LJV

**AECOM**

DESIGNED BY: LJV  
 DRAWN BY: LJV  
 HOR. SCALE: 1:500  
 VERTICAL: NA

CHECKED BY:  
 APPROVED BY:  
 RELEASED FOR CONSTRUCTION: DATE

ENGINEER'S SEAL  
 L. JOY VIBERG  
 member no. 125  
 CONSULTANT PROJECT NUMBER: 60321148

**THE CITY OF WINNIPEG PUBLIC WORKS DEPARTMENT**

WAVERLEY STREET UNDERPASS AT CN MILE 3.89 RIVERS SUB  
 CONTRACT 2: UNDERPASS STRUCTURE, RAILWORKS, ROADWORKS, LAND DRAINAGE SEWER, PUMPING STATION AND LANDSCAPING WORKS

CITY DRAWING NUMBER: U-239-2016-C2-LS-006  
 SHEET 006 OF 021  
 CONSULTANT DRAWING NUMBER: C2-LS-006

PA:60321148-900-Work\910-CAD\20-SHEETS\163353-C2-CON-LS-WAVERLEY.dwg