

ELEVATION VIEW OF TYPICAL TRAFFIC BARRIERS
1:10

BILL OF REINFORCING STEEL																
STRAIGHT BARS					BENT BARS											
MARK	QTY.	LENGTH (mm)	MASS (kg)		MARK	QTY.	TYPE	A	B	C	D	E	F	G	LENGTH (mm)	MASS (kg)
B1601X	364	5887	3334.3		B1614X	622	A	337	500	87	187	250	449	337	1878	1817.6
B1602X	15	5487	128.1		B1615X	8	A	200	500	84	156	250	415	337	1857	23.1
B1603X	30	5242	244.7		B1616X	6	A	200	500	87	124	250	386	337	1845	17.2
B1604X	15	4611	107.6		B1617X	8	A	200	500	89	93	250	357	337	1835	22.8
B1605X	15	4337	101.2		B1618X	6	A	200	500	90	59	250	324	337	1826	17.0
B1606X	15	4187	97.7		B1619X	8	A	200	500	91	28	250	294	337	1821	22.7
B1607X	30	3910	182.5		B1620X	6	A	200	500	90	0	250	265	337	1819	17.0
B1608X	15	3500	81.7													
B1609X	15	3462	80.8		B1621X	622	B	678	110	250	140				2003	1938.6
					B1622X	16	C	665	170						835	20.8
					B1623X	24	C	740	170						910	34.0
B1613X	664	1100	1136.5		B1624X	20	C	810	170						980	30.5
B1628X	632	750	737.5		B1625X	24	C	890	170						1060	39.6
TOTAL MASS OF MMFX STEEL REINFORCING																10233.5 kg
DOWEL & SLEEVE ASSEMBLY																
MARK	DESCRIPTION										MASS PER UNIT (kg)	QTY.	MASS (kg)			
PD1	25# x 550 LG. GALV. PLAIN DOWEL										2.12	64	135.7			
BV1	32 O.D. x 300 LG. GALV. EXPANSION SLEEVE										N/A	64	N/A			

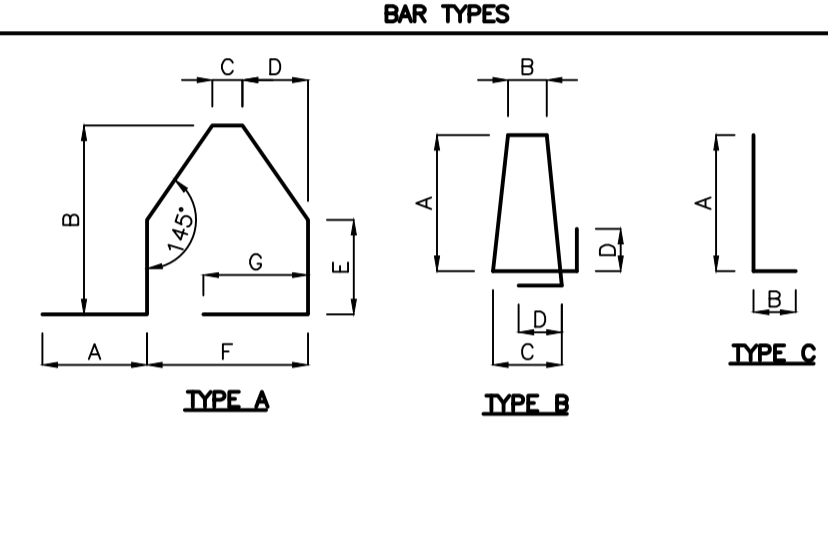

- NOTE:**
- All dimensions given in bending diagram are out to out, except radii. radii are inside dimensions. All reinforcing steel bends and hooks shall conform to clause 6.6.2 of C.S.A. A23.1-04, unless noted otherwise in the BILL OF REINFORCING STEEL.
 - All reinforcing steel shall be deformed steel, unless noted otherwise in the BILL OF REINFORCING STEEL.
 - Like bars shall be bundled, securely tied and identified as to mark and site no. by appropriate means. All other items to be identified in a similar fashion.
 - Unless otherwise noted, pin diameters shall be similar at all bends and hooks of a bar in accordance with the following detail:

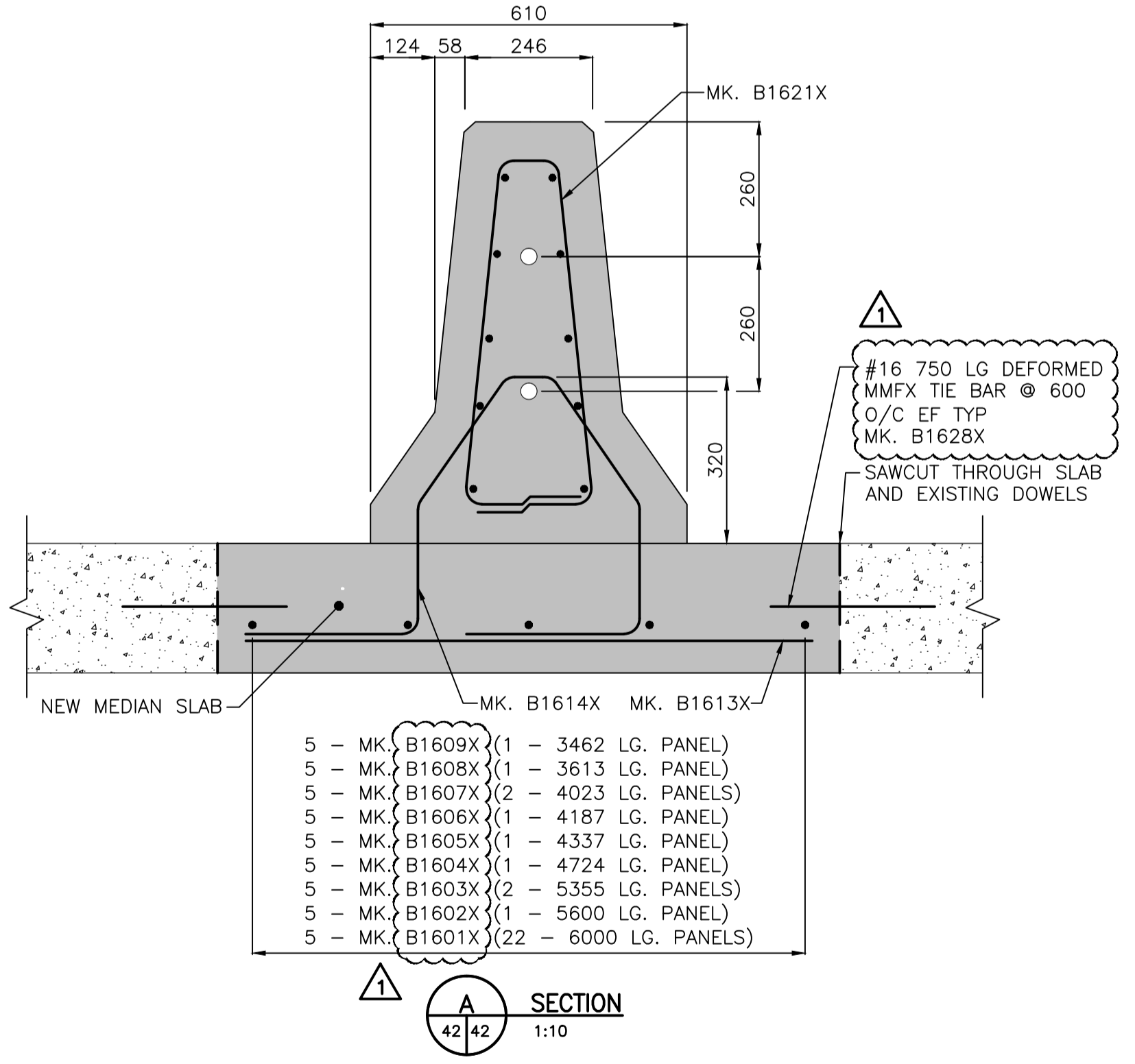

SECTION A
1:10

LOCATION APPROVED UNDERGROUND STRUCTURES

SUPV. U/G STRUCTURES COMMITTEE DATE

NOTE:
LOCATION OF UNDERGROUND STRUCTURES AS SHOWN ARE BASED ON THE BEST INFORMATION AVAILABLE BUT NO GUARANTEE IS GIVEN THAT ALL EXISTING UTILITIES ARE SHOWN OR THAT THE GIVEN LOCATIONS ARE EXACT. CONFIRMATION OF EXISTENCE AND EXACT LOCATION OF ALL SERVICES MUST BE OBTAINED FROM THE INDIVIDUAL UTILITIES BEFORE PROCEEDING WITH CONSTRUCTION.

NO.	REVISIONS	DATE	BY
1	ISSUED FOR ADDENDUM No.1	16.07.13	K.S.A.
0	ISSUED FOR TENDER	16.07.04	K.S.A.

Stantec
500 - 311 Portage Avenue, Winnipeg MB Canada
www.stantec.com

DESIGNED BY: S.Y. CHECKED BY: K.S.A.
 DRAWN BY: V.F. APPROVED BY: B.J.W.

HOR. SCALE: AS NOTED
 VERTICAL: RELEASED FOR CONSTRUCTION: DATE 2016.02.19

ENGINEER'S SEAL

CONSULTANT DRAWING NO. S-126

THE CITY OF WINNIPEG
PUBLIC WORKS DEPARTMENT
ENGINEERING DIVISION

2016 REGIONAL STREET PROGRAM
ARCHIBALD STREET
UNDERPASS REHABILITATION
TRAFFIC BARRIER REINFORCING SCHEDULE

SHEET 42 OF 62
 CAD FILE DRAWING NUMBER 06880s-119-884.dwg
 CITY DRAWING NUMBER U205-16-42