

STAGE 2 – CONSTRUCT NORTHBOUND LANES (2017)

SCALE 1:750

MAIN CONSTRUCTION:

- NORTHBOUND REHAB WORKS (ARCHIBALD)
- UNDERPASS STRUCTURAL WORKS – EAST SIDE

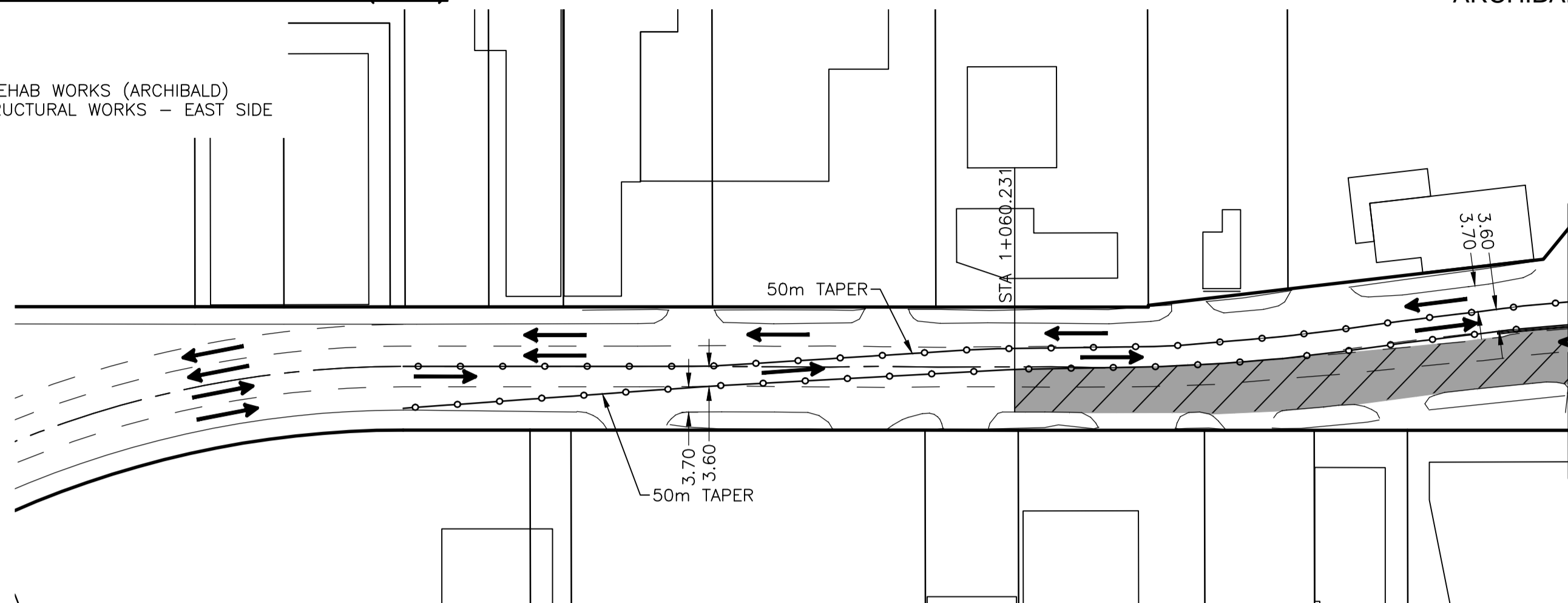

ARCHIBALD STREET

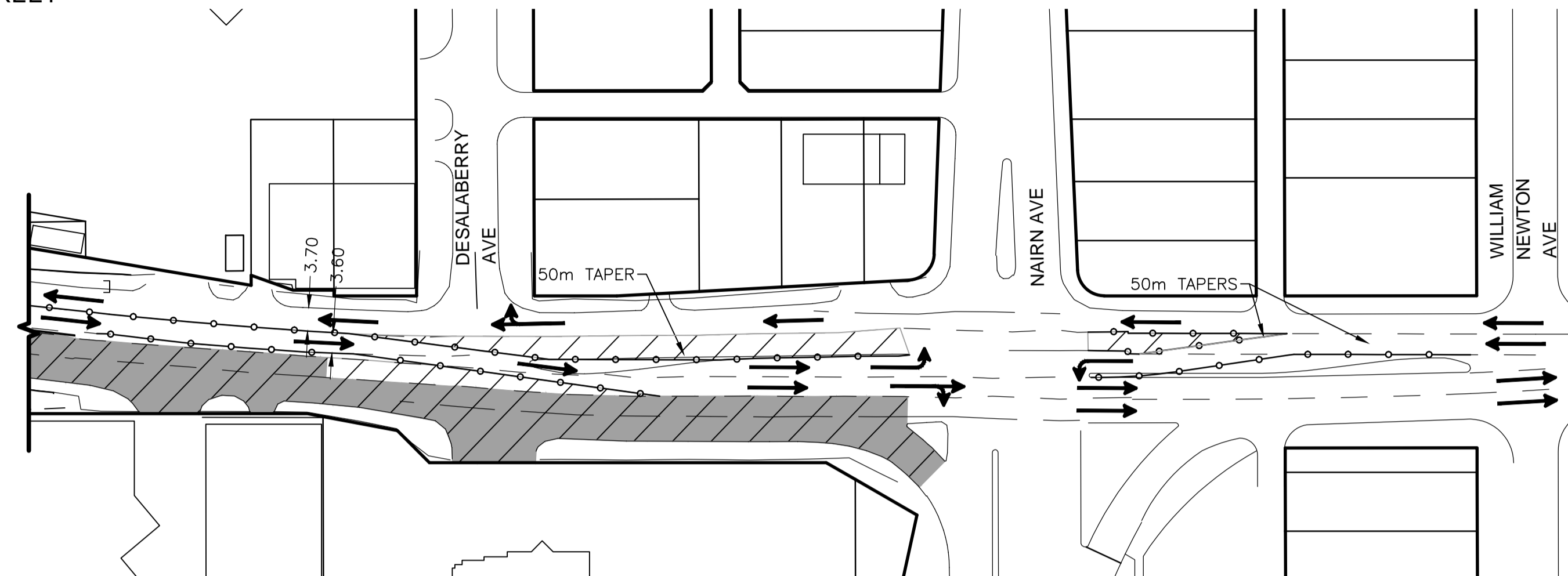

STAGE 3A – CONSTRUCT MEDIAN LANES (2017)

SCALE 1:750

MAIN CONSTRUCTION:

- CONSTRUCT MEDIAN WORKS – ARCHIBALD & WATT ST.

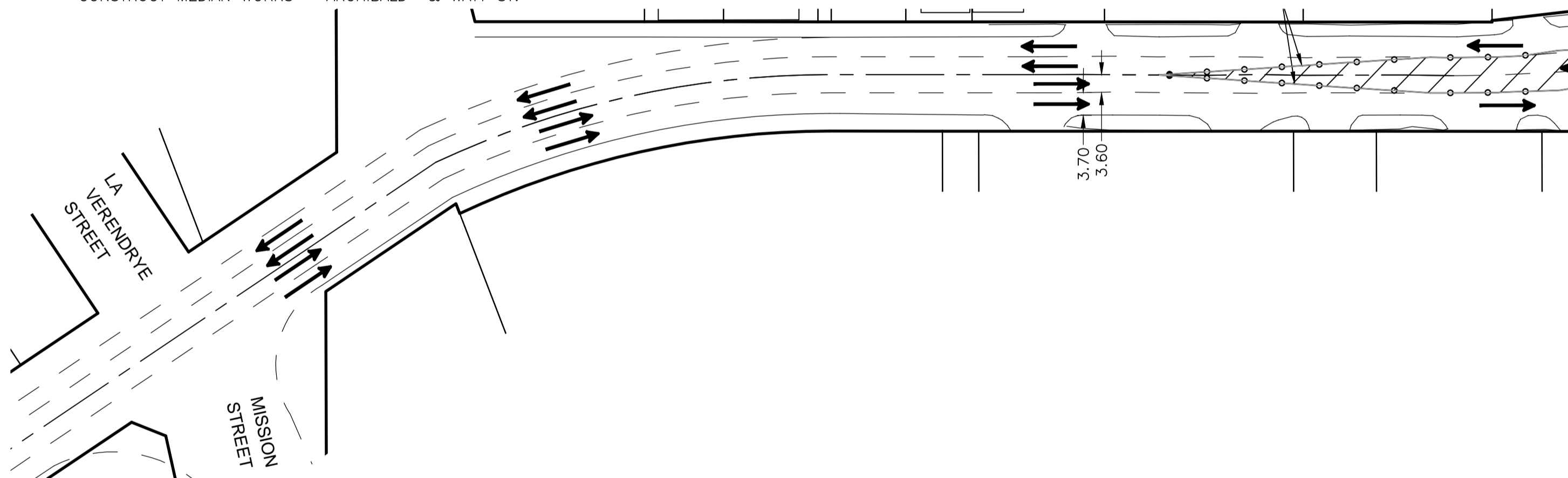

ARCHIBALD STREET

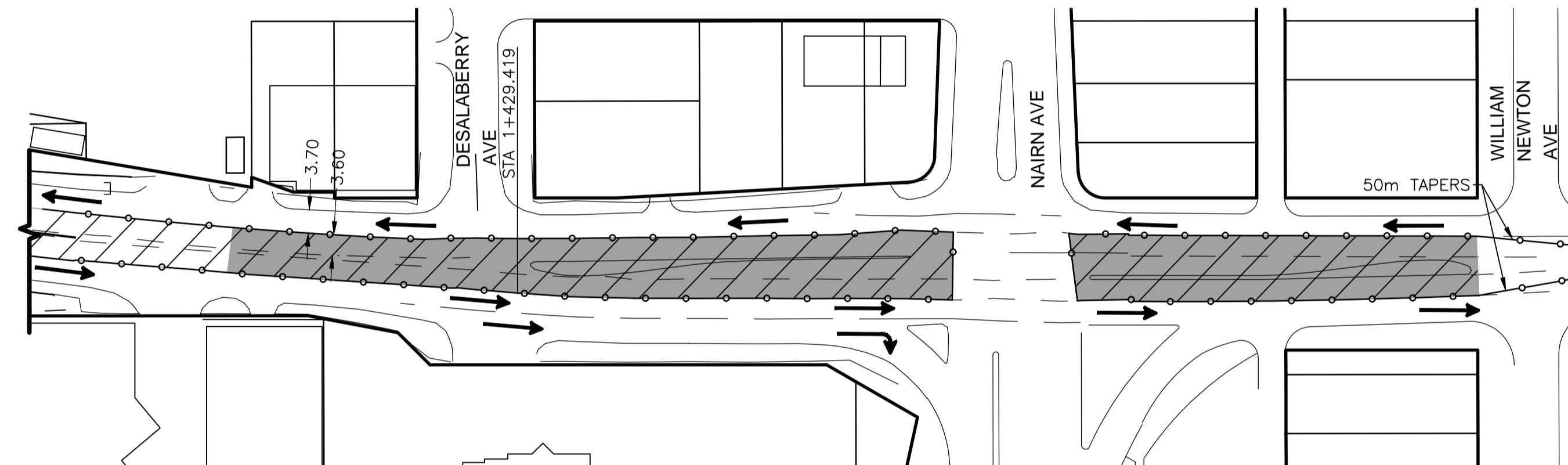

STAGE 3B – INTERMEDIATE INTERSECTION RESURFACING (2017)

SCALE 1:750

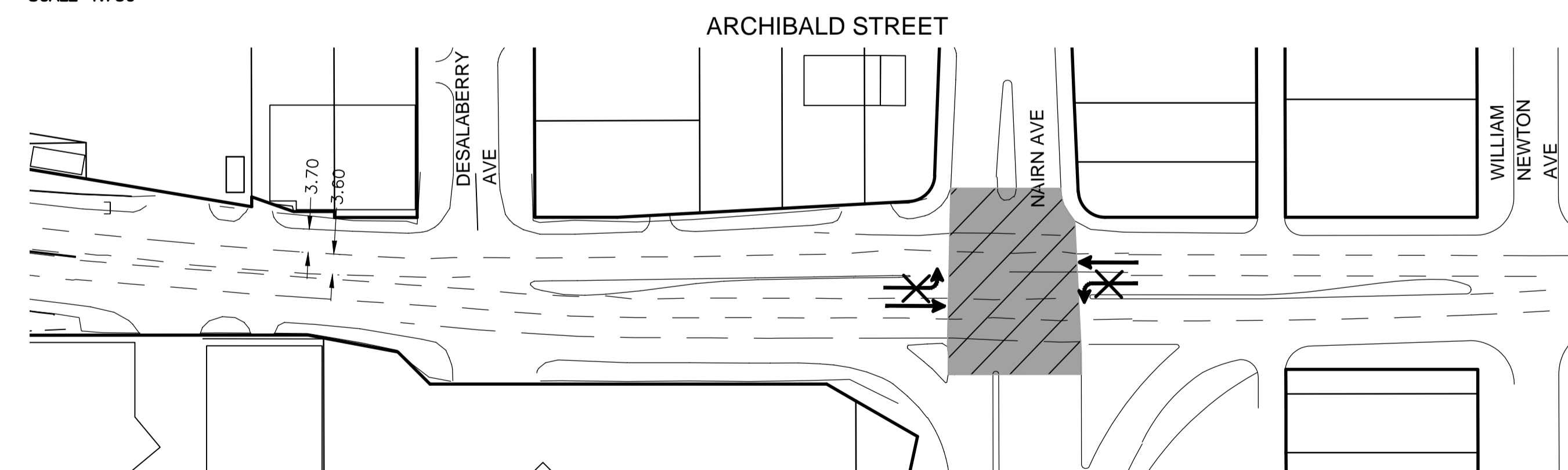

ARCHIBALD STREET

GENERAL NOTES:

1. TRAFFIC CONTROL PROVIDED AND MAINTAINED BY CITY OF WINNIPEG TRAFFIC SERVICES.
2. TEMPORARY TRAFFIC CONTROL PROVIDED AND MAINTAINED BY CONTRACTOR IN ACCORDANCE WITH CITY OF WINNIPEG MANUAL OF TEMPORARY TRAFFIC CONTROL ON CITY STREETS.
3. CONTRACTOR TO SCHEDULE TRAFFIC CONTROL MEETING WITH CONTRACT ADMINISTRATOR & CITY TRAFFIC SERVICES 72 HOURS IN ADVANCE OF COMMENCING SET UP.

TRAFFIC CONTROL NOTES:

1. LANE CLOSURES & RESTRICTIONS
 - STAGE 3, CLOSE MIDDLE LANES FOR CONSTRUCTION, MAINTAIN ONE LANE IN EACH DIRECTION IN THE INTERSECTION DURING PAVING OPERATIONS.
 - STAGE 4, MAINTAIN ONE LANE IN EACH DIRECTION IN THE INTERSECTION DURING PAVING OPERATIONS.
 - RESTRICT LEFT TURN MOVEMENTS:
 - ARCHIBALD FOR DURATION OF PROJECT
 - WATT ST. FOR STAGES 1A & 1B
 - TRAFFIC PLAN TO BE SUBMITTED FOR APPROVAL PRIOR TO SET UP OF TRAFFIC CONTROL.
2. PEDESTRIAN TRAFFIC
 - MAINTAIN SIDEWALKS DURING CONSTRUCTION.
 - MAINTAIN PEDESTRIAN CROSSINGS.
3. TRANSIT
 - MAINTAIN TRANSIT STOPS AS OUTLINED IN THE SPECIFICATIONS.
4. PARKING / LOADING
 - PARKING / LOADING RESTRICTIONS TO BE IN PLACE FOR DURATION OF CONSTRUCTION.
 - RESTRICTION SIGNAGE TO BE COMPLETED BY TRAFFIC SERVICES.
5. TRAFFIC SIGNALS
 - COORDINATE WITH TRAFFIC SIGNALS FOR BAGGING & DEACTIVATION OF PERMISSIVE LEFT TURN SIGNALS.

METRIC

WHOLE NUMBERS INDICATE MILLIMETRES
DECIMALIZED NUMBERS INDICATE METRES

WARNING

- IF POWER EQUIPMENT OR EXPLOSIVES ARE TO BE USED FOR EXCAVATION ON THIS PROJECT THE CONTRACTOR MUST:
1. NOTIFY THE GAS COMPANY OF THE PROPOSED LOCATION OF EXCAVATION.
 2. TAKE PRECAUTION TO AVOID DAMAGE TO GAS COMPANY INSTALLATIONS SEE PROVINCIAL REGULATION 210/72 FOR DETAILS.
 3. OBTAIN EXCAVATION PERMITS PRIOR TO CONSTRUCTION.

LEGEND

- POLYPOSTS
- LANE CLOSURE
- STAGE CONSTRUCTION
- PEDESTRIAN CORRIDOR
- OFF PEAK CLOSURE



LOCATION APPROVED UNDERGROUND STRUCTURES

SUPV. U/G STRUCTURES COMMITTEE DATE

NOTE:
LOCATION OF UNDERGROUND STRUCTURES AS SHOWN ARE BASED ON THE BEST INFORMATION AVAILABLE BUT NO GUARANTEE IS GIVEN THAT ALL EXISTING UTILITIES ARE SHOWN OR THAT THE GIVEN LOCATIONS ARE EXACT. CONFIRMATION OF EXISTENCE AND EXACT LOCATION OF ALL SERVICES MUST BE OBTAINED FROM THE INDIVIDUAL UTILITIES BEFORE PROCEEDING WITH CONSTRUCTION.

NO.	REVISIONS	DATE	BY	B.M. ELEV.
0	ISSUED FOR TENDER	16.07.04	S.B.C.	



DESIGNED BY	D.L.	CHECKED BY	D.J.M.
DRAWN BY	G.P.	APPROVED BY	S.B.C.
HOR. SCALE:	1:750	RELEASED FOR CONSTRUCTION:	
VERTICAL:		DATE	2016.07.04

ENGINEER'S SEAL
CONSULTANT DRAWING NO. C-106



2016 REGIONAL STREET PROGRAM
ARCHIBALD STREET
MISSION STREET TO NAIRN AVENUE
TRAFFIC CONTROL & STAGING

SHEET	6	OF	62
CAD FILE DRAWING NUMBER	06880c-105-884.dwg		
CITY DRAWING NUMBER	U205-16-06		
	P-3478-06		