

GENERAL NOTES:

- DESIGN GRADES ARE TO BE CONFIRMED ONCE PLANING HAS BEEN COMPLETED.
- ADJUST WATER VALVES TO MATCH FINAL GRADES.
- ADJUST PAVEMENT MANHOLE AND CATCHBASIN FRAMES 50mm BELOW FINAL GRADE TO ACCOMMODATE A RISER RING FOR FINAL ASPHALT PAVING OPERATIONS.
- MAINTAIN TRAFFIC AS OUTLINED IN THE TRAFFIC MANAGEMENT SPECIFICATION AND AS PER THE STAGING/TRAFFIC CONTROL DRAWINGS.
- RADI CURB RENEWAL ON INTERSECTING STREET & BACK LANES TO BE MODIFIED BARRIER CURB.
- CONSTRUCT PARTIAL DEPTH CONCRETE REPAIRS AS DIRECTED BY THE CONTRACT ADMINISTRATOR.

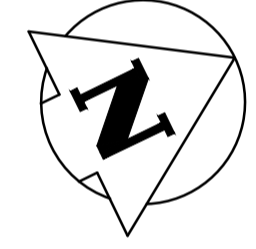

APEGM
Certificate of Authorization
Stantec Consulting Ltd.
No. 1301

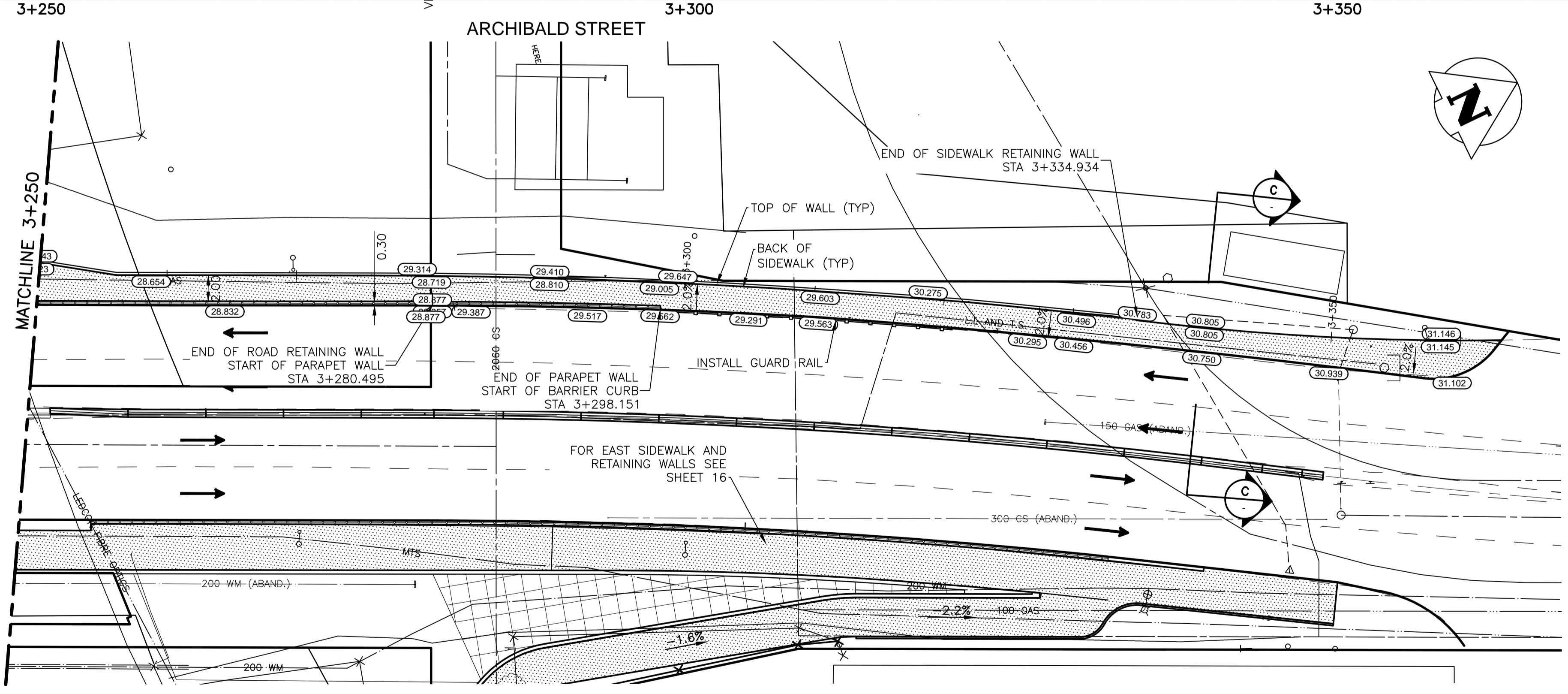
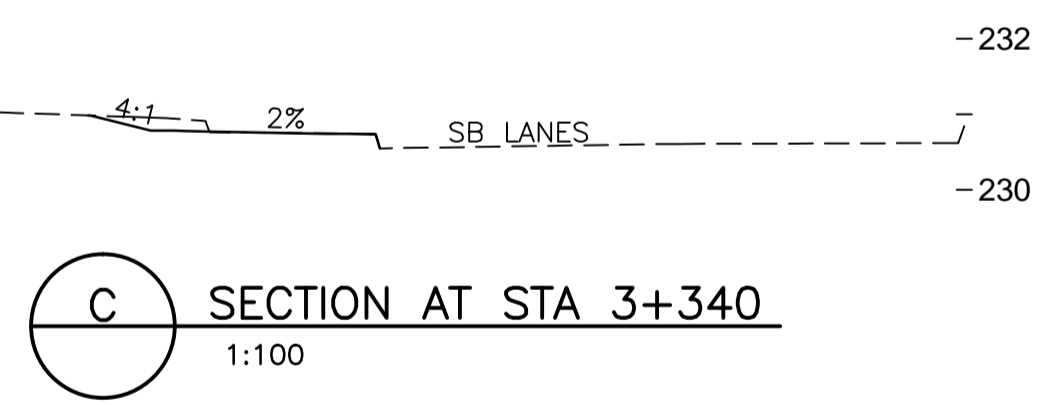

WARNING

IF POWER EQUIPMENT OR EXPLOSIVES ARE TO BE USED FOR EXCAVATION ON THIS PROJECT THE CONTRACTOR MUST:

- NOTIFY THE GAS COMPANY OF THE PROPOSED LOCATION OF EXCAVATION.
- TAKE PRECAUTION TO AVOID DAMAGE TO GAS COMPANY INSTALLATIONS SEE PROVINCIAL REGULATION 210/72 FOR DETAILS.
- OBTAIN EXCAVATION PERMITS PRIOR TO CONSTRUCTION.

METRIC
WHOLE NUMBERS INDICATE MILLIMETRES
DECIMALIZED NUMBERS INDICATE METRES

| EXISTING | LEGEND-PLAN | PROPOSED | EXISTING | LEGEND-PLAN | PROPOSED | EXISTING | LEGEND-PROFILE | PROPOSED |
|----------|-----------------------|----------|-----------------------|-------------|-----------------------|----------|---------------------|----------|
| 150 WM | WATERMAIN | 150 WM | HYDRO | 150 WM | WATERMAIN | 150 WM | HYDRANT, VALVE | 150 WM |
| 300 LDS | LAND DRAINAGE SEWER | 300 LDS | M.T.S. | 300 LDS | LAND DRAINAGE SEWER | 300 LDS | CONCRETE | 300 LDS |
| 250 WWS | WASTE WATER SEWER | 250 WWS | MILL AND FILL OVERLAY | 250 WWS | WASTE WATER SEWER | 250 WWS | SEEDING | 250 WWS |
| ○ | MANHOLE | ● | CONCRETE SIDEWALK | ○ | CONCRETE SIDEWALK | ○ | PROPERTY LINE | ○ |
| □ | CATCH BASIN/CATCH PIT | ■ | SEEDING | □ | CATCH BASIN/CATCH PIT | □ | SURVEY BAR | □ |
| ▽ | CURB RENEWAL | ▽ | PROPERTY LINE | ▽ | CURB RENEWAL | ▽ | ELEVATION | ▽ |
| --- | GRAVEL | --- | CONCRETE SIDEWALK | --- | GRAVEL | --- | SIDEWALK DETECTABLE | --- |
| --- | GAS | --- | SEEDING | --- | GAS | --- | --- | --- |

LOCATION APPROVED UNDERGROUND STRUCTURES
SUPV. U/G STRUCTURES COMMITTEE
DATE

NOTE:
LOCATION OF UNDERGROUND STRUCTURES AS SHOWN ARE BASED ON THE BEST INFORMATION AVAILABLE BUT NO GUARANTEE IS GIVEN THAT ALL EXISTING UTILITIES ARE SHOWN OR THAT THE GIVEN LOCATIONS ARE EXACT. CONFIRMATION OF EXISTENCE AND EXACT LOCATION OF ALL SERVICES MUST BE OBTAINED FROM THE INDIVIDUAL UTILITIES BEFORE PROCEEDING WITH CONSTRUCTION.

| | | |
|-------------------------------|-----------------------------|---------------------------------|
| B.M. BM52-16 ELEV. 232.706 | DESIGNED BY: D.L. | CHECKED BY: D.J.M. |
| | DRAWN BY: G.P. | APPROVED BY: S.B.C. |
| | HOR. SCALE: 1:250 | RELEASED FOR CONSTRUCTION: DATE |
| | VERTICAL: 1:10 | |
| 0 | ISSUED FOR TENDER: 16.07.04 | DATE: 2016.07.04 |
| | NO. REVISIONS | DATE |

Stantec
500-311 Portage Avenue, Winnipeg MB Canada
www.stantec.com

ENGINEER'S SEAL

THE CITY OF WINNIPEG
PUBLIC WORKS DEPARTMENT
ENGINEERING DIVISION

2016 REGIONAL STREET PROGRAM
ARCHIBALD STREET
STA 3+250 TO STA 3+361
WEST SIDEWALK RENEWAL

SHEET 14 OF 62
CAD FILE DRAWING NUMBER 06880c-204-884.dwg
CITY DRAWING NUMBER U205-16-14
P-3478-14

CONSULTANT DRAWING NO. C-205