

**A SECTION**  
1:10

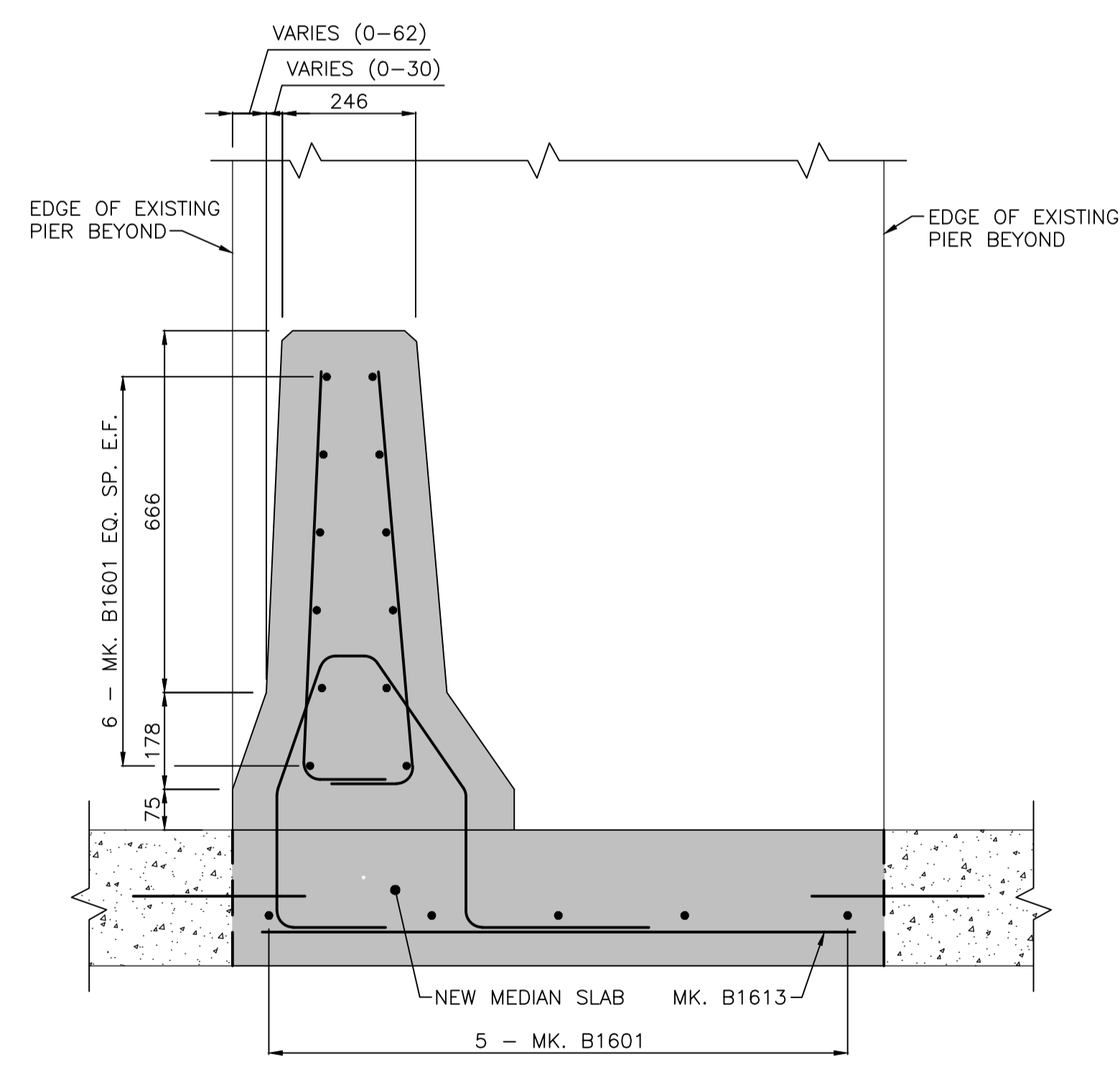

**B SECTION**  
1:10

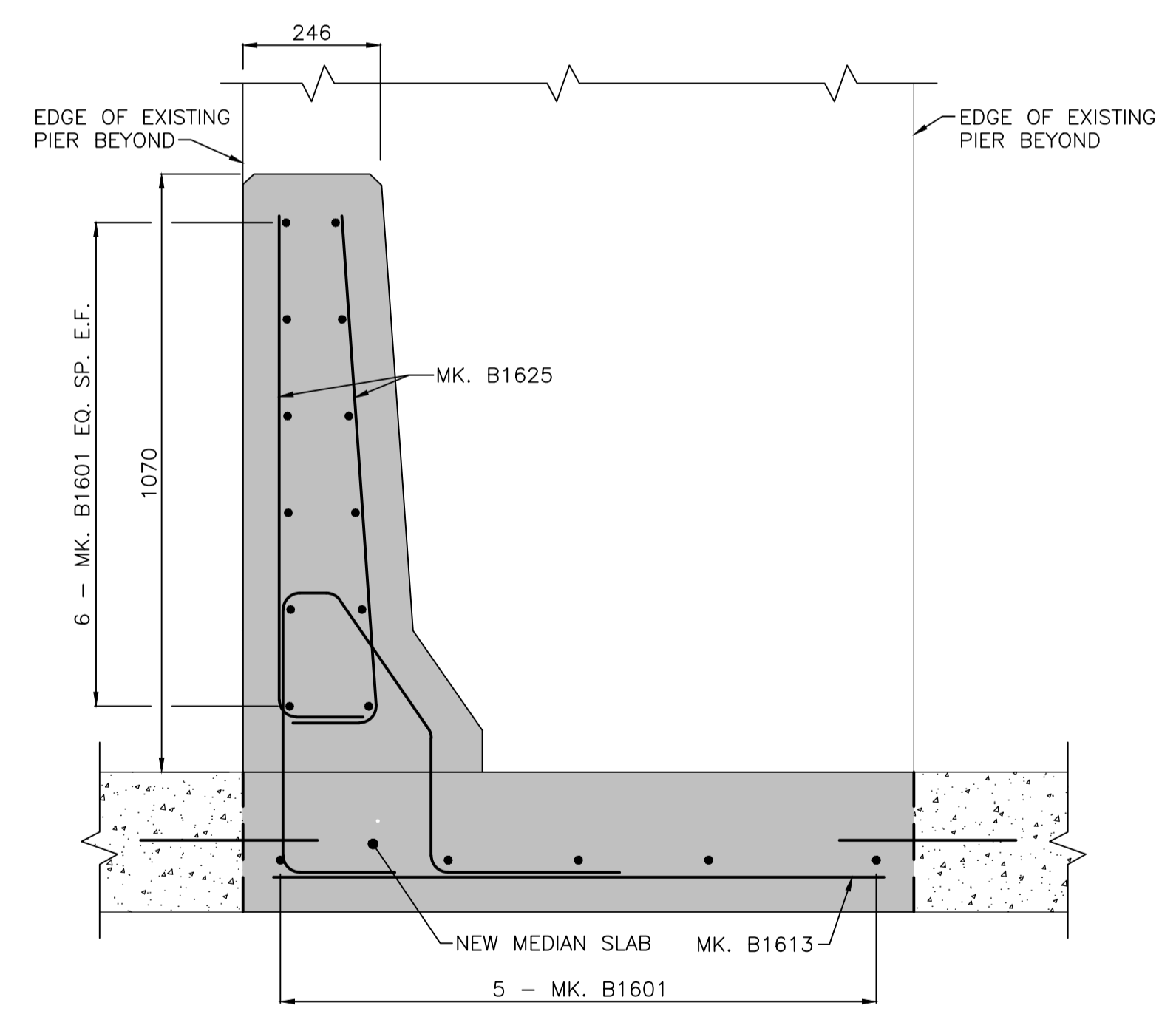

**C SECTION**  
1:10

LOCATION APPROVED UNDERGROUND STRUCTURES

SUPV. U/G STRUCTURES COMMITTEE DATE

NOTE:  
LOCATION OF UNDERGROUND STRUCTURES AS SHOWN ARE BASED ON THE BEST INFORMATION AVAILABLE BUT NO GUARANTEE IS GIVEN THAT ALL EXISTING UTILITIES ARE SHOWN OR THAT THE GIVEN LOCATIONS ARE EXACT. CONFIRMATION OF EXISTENCE AND EXACT LOCATION OF ALL SERVICES MUST BE OBTAINED FROM THE INDIVIDUAL UTILITIES BEFORE PROCEEDING WITH CONSTRUCTION.

NO.	REVISIONS	DATE	BY
0	ISSUED FOR TENDER	16.07.04	K.S.A.

<b>Stantec</b> 500 - 311 Portage Avenue, Winnipeg MB Canada www.stantec.com		ENGINEER'S SEAL	
DESIGNED BY: S.Y.	CHECKED BY: K.S.A.	CONSULTANT DRAWING NO. S-125	
DRAWN BY: V.F.	APPROVED BY: B.J.W.		
HOR. SCALE: AS NOTED	RELEASED FOR CONSTRUCTION: DATE	DATE: 2016.02.19	

**THE CITY OF WINNIPEG**  
PUBLIC WORKS DEPARTMENT  
ENGINEERING DIVISION

**2016 REGIONAL STREET PROGRAM**  
ARCHIBALD STREET  
ST+ 130 TO ST+ 370  
TRAFFIC BARRIER REINFORCING DETAILS

SHEET 41 OF 62  
CAD FILE DRAWING NUMBER 06880s-119-884.dwg  
CITY DRAWING NUMBER U205-16-41

I:\117\stn\11716880s\03100\_drawing\0302\_sheer\_files\03\_structural\06880s-119-884.dwg  
 Date: 2016 Jul 05 3:02 pm  
 User: B.J.W.