

EAST SIDEWALK LAYOUT - SOUTH
1:100

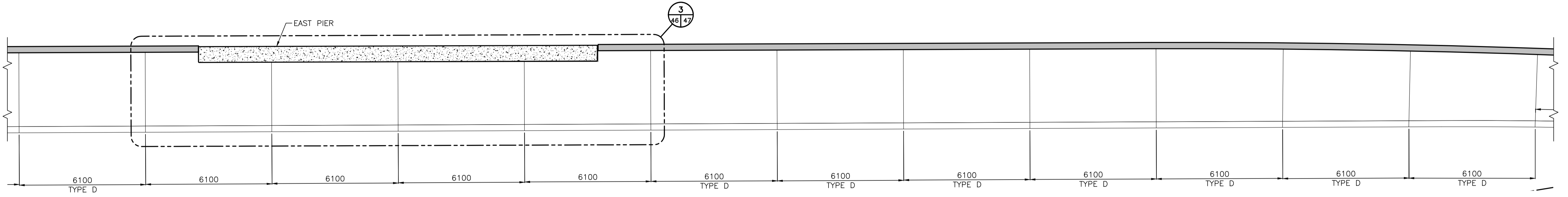

EAST SIDEWALK LAYOUT - CENTER
1:100

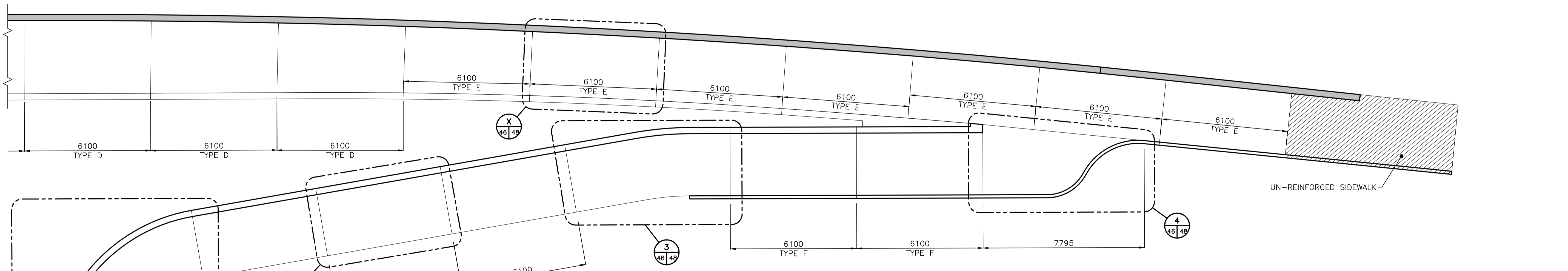

EAST SIDEWALK LAYOUT - NORTH
1:100

VA:13791246.dwg, 1:10716880, 0302, drawing, 0302, sheet, files\03_struct\0302\06880s-128-884.dwg
 2016.07.04 10:49 AM J.Y. BERNARDIS, J.S.M.



METRIC
WHOLE NUMBERS INDICATE MILLIMETRES
DECIMALIZED NUMBERS INDICATE METRES
UNLESS INDICATED OTHERWISE

LOCATION APPROVED UNDERGROUND STRUCTURES

SUPV. U/G STRUCTURES COMMITTEE DATE

NOTE:
LOCATION OF UNDERGROUND STRUCTURES AS SHOWN ARE BASED ON THE BEST INFORMATION AVAILABLE BUT NO GUARANTEE IS GIVEN THAT ALL EXISTING UTILITIES ARE SHOWN OR THAT THE GIVEN LOCATIONS ARE EXACT. CONFIRMATION OF EXISTENCE AND EXACT LOCATION OF ALL SERVICES MUST BE OBTAINED FROM THE INDIVIDUAL UTILITIES BEFORE PROCEEDING WITH CONSTRUCTION.

NO.	REVISIONS	DATE	BY
0	ISSUED FOR TENDER	16.07.04	K.A.

Stantec
500 - 311 Portage Avenue, Winnipeg MB Canada
www.stantec.com

DESIGNED BY: S.Y.	CHECKED BY: K.S.A.
DRAWN BY: J.M.B.	APPROVED BY: B.J.W.
HOR. SCALE: 1:750	RELEASED FOR CONSTRUCTION: DATE
VERTICAL:	DATE

ENGINEER'S SEAL

CONSULTANT DRAWING NO.
S-130

THE CITY OF WINNIPEG
PUBLIC WORKS DEPARTMENT
ENGINEERING DIVISION

2016 REGIONAL STREET PROGRAM

ARCHIBALD STREET
UNDERPASS REHABILITATION
EAST SIDEWALK REINFORCING LAYOUT

SHEET **46** OF **62**
CAD FILE DRAWING NUMBER
06880s-128-884.dwg
CITY DRAWING NUMBER
U205-16-46