

SOUTH EAST PARAPET WALL REINFORCING  
1:25

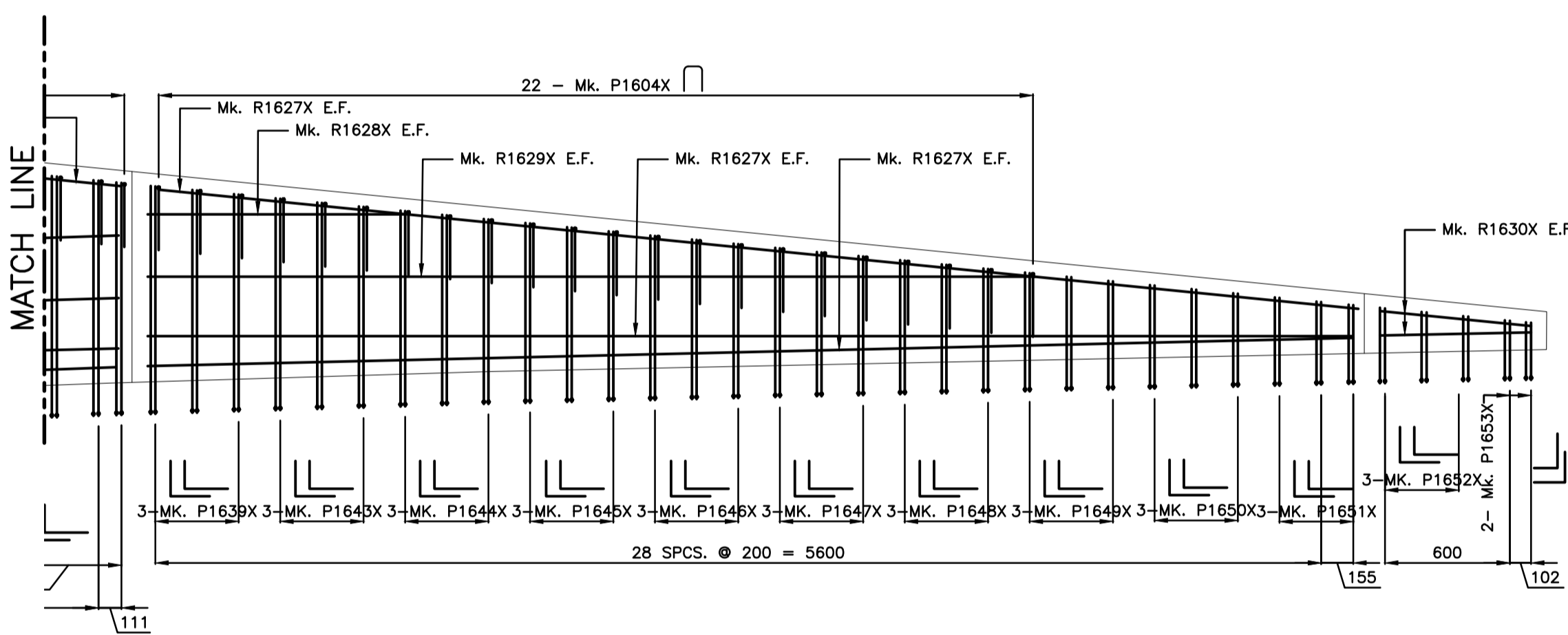

NORTH EAST PARAPET WALL REINFORCING  
1:25

**BILL OF REINFORCING STEEL**

SOUTH EAST PARAPET WALL													
STRAIGHT BARS				BENT BARS									
MARK	QTY.	LENGTH (mm)	MASS (kg)	MARK	QTY.	TYPE	A	B	C	D	E	LENGTH (mm)	MASS (kg)
P1601X	10	5775	88.0	P1604X	88	B	150	300	300			750	100.5
P1602X	12	5850	106.8	P1605X	10	A	400	1100				1500	22.8
P1603X	12	5225	95.4	P1606X	18	A	400	1150				1550	42.5
				P1607X	18	A	400	1200				1600	43.8
				P1608X	16	A	400	1250				1650	40.2
				P1609X	14	A	400	1300				1700	36.2
				P1610X	12	A	400	1350				1750	32.0
				P1611X	12	A	400	1400				1800	32.9
				P1612X	12	A	400	1450				1850	33.8
				P1613X	12	A	400	1500				1900	34.7
				P1614X	16	A	400	1550				1950	47.5
				P1615X	12	A	400	1600				2000	36.5
				P1616X	12	A	400	1650				2050	37.4
				P1617X	14	A	400	1715				2115	45.1
TOTAL MASS OF MMFX STEEL REINFORCING = 876.1 kg													

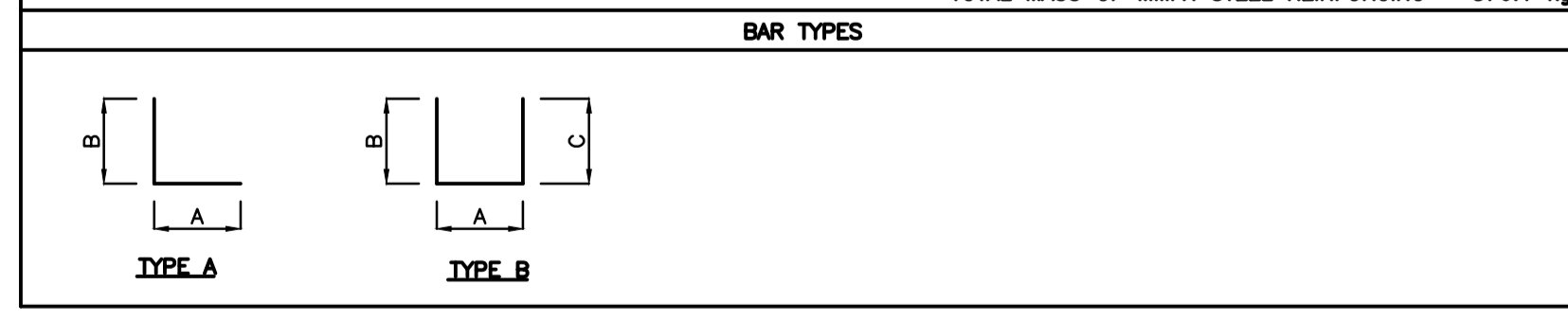

**BILL OF REINFORCING STEEL**

NORTH EAST PARAPET WALL													
STRAIGHT BARS				BENT BARS									
MARK	QTY.	LENGTH (mm)	MASS (kg)	MARK	QTY.	TYPE	A	B	C	D	E	LENGTH (mm)	MASS (kg)
P1618X	12	5225	95.4	P1604X	294	B	150	300	300			750	335.6
P1619X	10	5760	87.7	P1630X	46	A	400	1615				2015	141.1
P1620X	8	5890	71.7	P1631X	34	A	400	1425				1825	94.4
P1621X	8	5715	69.6	P1632X	30	A	400	1305				1705	77.9
P1622X	8	5640	68.7	P1633X	64	A	400	1205				1605	156.3
P1623X	26	5740	227.1	P1634X	22	A	400	1150				1550	51.9
P1624X	8	5775	70.3	P1635X	22	A	400	1090				1490	49.9
P1625X	2	570	1.7	P1636X	128	A	400	1050				1450	282.5
P1626X	2	5180	15.8	P1637X	20	A	400	1070				1470	44.7
P1627X	6	5790	52.9	P1638X	20	A	400	1080				1480	45.1
P1628X	2	1240	3.8	P1639X	16	A	400	1095				1495	36.4
P1629X	2	4260	13.0	P1640X	20	A	400	1125				1525	46.4
P1630X	4	725	4.4	P1641X	26	A	400	1185				1585	62.7
				P1642X	52	A	400	1225				1625	128.6
				P1643X	6	A	400	1020				1420	13.0
				P1644X	6	A	400	940				1175	10.7
				P1645X	6	A	400	865				1265	11.6
				P1646X	6	A	400	800				1200	11.0
				P1647X	6	A	400	720				1120	10.2
				P1648X	6	A	400	645				1045	9.6
				P1649X	6	A	400	570				970	8.9
				P1650X	6	A	400	500				900	8.2
				P1651X	6	A	400	425				825	7.5
				P1652X	6	A	400	365				765	7.0
				P1653X	4	A	400	290				690	4.2
TOTAL MASS OF MMFX STEEL REINFORCING = 2440.4 kg													

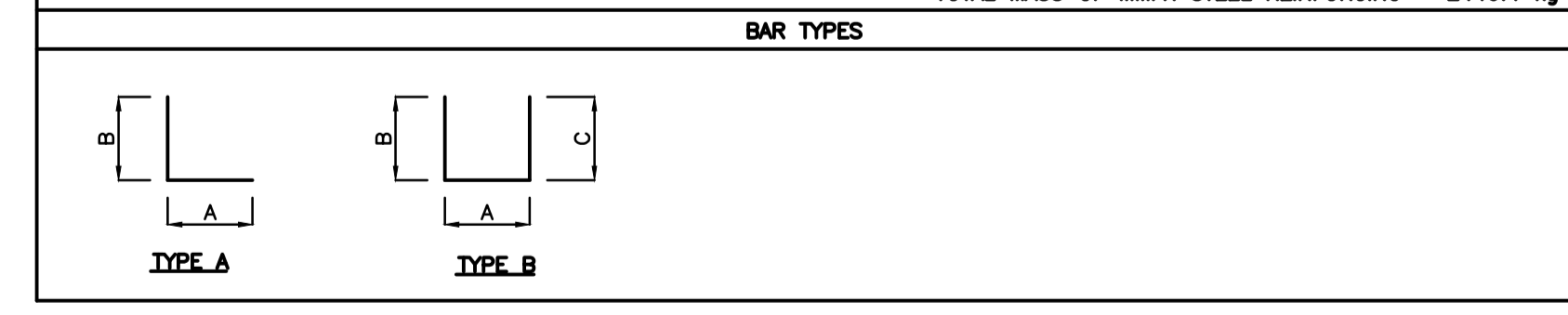

LOCATION APPROVED UNDERGROUND STRUCTURES

SUPV. U/G STRUCTURES COMMITTEE DATE

NOTE: LOCATION OF UNDERGROUND STRUCTURES AS SHOWN ARE BASED ON THE BEST INFORMATION AVAILABLE BUT NO GUARANTEE IS GIVEN THAT ALL EXISTING UTILITIES ARE SHOWN OR THAT THE GIVEN LOCATIONS ARE EXACT. CONFIRMATION OF EXISTENCE AND EXACT LOCATION OF ALL SERVICES MUST BE OBTAINED FROM THE INDIVIDUAL UTILITIES BEFORE PROCEEDING WITH CONSTRUCTION.

B.M. ELEV.	NO.	REVISIONS	DATE	BY
	0	ISSUED FOR 98% REVIEW	16.06.07	K.S.A.

**Stantec**  
500 - 311 Portage Avenue, Winnipeg MB Canada  
www.stantec.com

DESIGNED BY: S.Y. CHECKED BY: K.S.A.  
DRAWN BY: T.B.C. APPROVED BY: B.W.

HOR. SCALE: AS SHOWN VERTICAL: RELEASED FOR CONSTRUCTION: DATE: 2016.05.06

ENGINEER'S SEAL

CONSULTANT DRAWING NO. S-141

**THE CITY OF WINNIPEG**  
PUBLIC WORKS DEPARTMENT  
ENGINEERING DIVISION

2016 REGIONAL STREET PROGRAM  
ARCHIBALD UNDERPASS  
ST+ 130 TO ST+ 370  
EAST PARAPET REINFORCING DETAILS (2 OF 2)

SHEET 57 OF 62  
CAD FILE DRAWING NUMBER 06880s-140-884.dwg  
CITY DRAWING NUMBER U205-16-57