

REID, CROWTHER & PARTNERS LIMITED  
WINNIPEG  
**AS CONSTRUCTED**  
SIGNED: *W. McCallum* DATE: 85-12-10

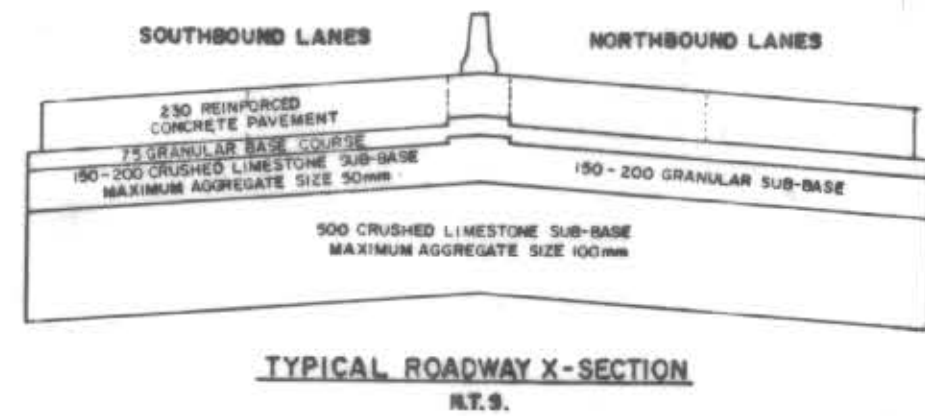

- REFERENCE NOTES**
- SEE DRAWING U205-85-02 FOR GEOMETRIC LAYOUT.
  - LEGAL PLAN SHEET NO. Y27.
  - GEM 27-013 ELEVATION 232.760.
  - ADD 200.000 TO OBTAIN GEODETIC DATUM.
  - PAVEMENT DIMENSIONS ARE TO BACK OF CURB.
  - R.C.L. FIELD BOOK NOS. 3093, 3159, 3193, 3194

**WARNING**

IF POWER EQUIPMENT OR EXPLOSIVES ARE TO BE USED FOR EXCAVATION ON THIS PROJECT THE CONTRACTOR MUST:

- NOTIFY THE GAS COMPANY OF THE PROPOSED LOCATION OF EXCAVATION.
- TAKE PRECAUTION TO AVOID DAMAGE TO GAS COMPANY INSTALLATIONS.

SEE PROVINCIAL REGULATION 210/72 FOR DETAILS

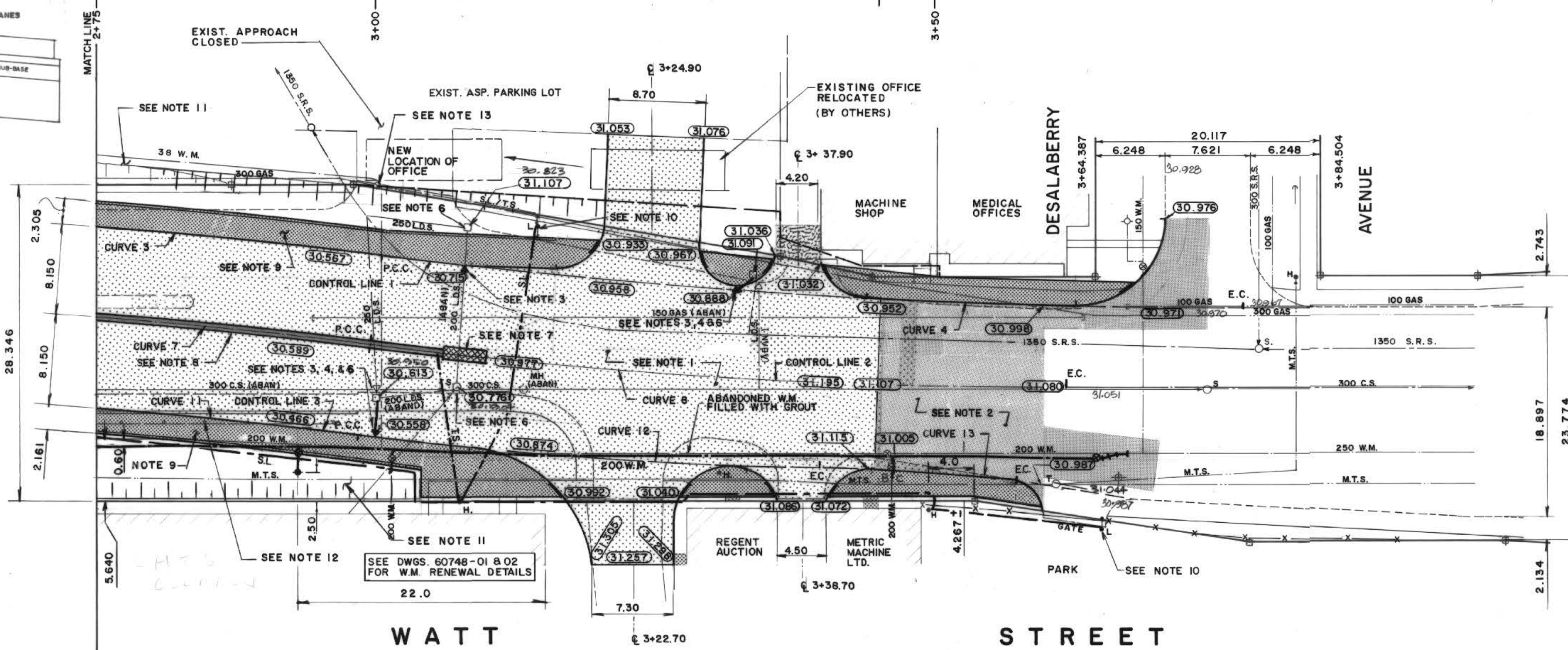

**CONSTRUCTION NOTES**

- REMOVED EXISTING 200 MM REINFORCED CONCRETE PAVEMENT C/W ASPHALT OVERLAY AND CONSTRUCTED NEW 230 MM (REINFORCED) CONCRETE PAVEMENT.
- REMOVED EXISTING ASPHALT PAVEMENT OVERLAY AND RESURFACED WITH NEW ASPHALT PAVEMENT OVERLAY.
- INSTALLED NEW CURB AND GUTTER INLET C/W NEW 250 MM LEAD.
- ABANDONED EXISTING DRAINAGE INLET.
- ABANDONED EXISTING CATCHBASIN.
- ADJUSTED MANHOLE TO GRADE.
- INSTALLED G.R.E.A.T. BARRIER UNIT. SEE DRAWINGS U205-85-14 AND U205-85-15 FOR DETAILS.
- CONSTRUCTED CONCRETE TRAFFIC BARRIERS. SEE DRAWING U205-85-09 FOR DETAILS.
- CONSTRUCTED NEW 150 MM UNDERPASS SIDEWALK SLAB C/W HANDRAIL. SEE DRAWINGS U205-85-07 AND U205-85-08 FOR DETAILS.
- INSTALLED NEW STREETLIGHT STANDARD (BY OTHERS).
- REGRADED EMBANKMENT TO SUIT.
- RELOCATED EXISTING FLEX-BEAM.
- ADJUSTED EXISTING WATER VALVE TO GRADE.
- REMOVED EXISTING RETAINING WALL. SEE DRAWING U206-85-16 FOR DETAILS.

B-5539-5 METRIC  
WHOLE NUMBERS INDICATE MILLIMETRES  
DECIMALIZED NUMBERS INDICATE METRES

EXISTING	LEGEND-PLAN	PROPOSED	EXISTING	LEGEND-PLAN	PROPOSED	EXISTING	LEGEND-PROFILE	PROPOSED
150 mm W.M.	WATERMAIN	150 mm W.M.	HYDRO	M.T.S.	CONCRETE PAVT.	150 mm W.M.	WATERMAIN	150 mm W.M.
300 mm L.D.S.	LAND DRAINAGE SEWER	300 mm L.D.S.	ASPHALT	PROPERTY LINE	GRAVEL SURFACING	300 mm L.D.S.	LAND DRAINAGE SEWER	300 mm L.D.S.
250 mm W.W.S.	WASTE WATER SEWER	250 mm W.W.S.	CONCRETE	SIDEWALK RAMP	ELEVATIONS	250 mm W.W.S.	WASTE WATER SEWER	250 mm W.W.S.
MANHOLE	CATCH BASIN	32.000	CONCRETE	SIDEWALK	TRAFFIC SIGNALS	MANHOLE	MANHOLE	MANHOLE
CURB INLET	JUNCTIONS	S.L.	CONCRETE	STREET LIGHTING	T.S.	CURB INLET	CURB INLET	CURB INLET
SURVEY BAR	GAS	T.S.	CONCRETE	STREET LIGHTING	T.S.	SURVEY BAR	SURVEY BAR	SURVEY BAR
EXISTING	LEGEND-PLAN	PROPOSED	EXISTING	LEGEND-PLAN	PROPOSED	EXISTING	LEGEND-PROFILE	PROPOSED

**LOCATION APPROVED**  
UNDERGROUND STRUCTURES  
DATE: APR 24 85  
NOTE:  
LOCATION OF UNDERGROUND STRUCTURES AS SHOWN ARE BASED ON THE BEST INFORMATION AVAILABLE BUT NO GUARANTEE IS GIVEN THAT ALL EXISTING UTILITIES ARE SHOWN OR THAT THE GIVEN LOCATIONS ARE EXACT. CONFIRMATION OF EXISTENCE AND EXACT LOCATION OF ALL SERVICES MUST BE OBTAINED FROM THE INDIVIDUAL UTILITIES BEFORE PROCEEDING WITH CONSTRUCTION

AS CONSTRUCTED  
NO. REVISIONS  
DATE APP. NOV 85  
ENGINEER'S SEAL

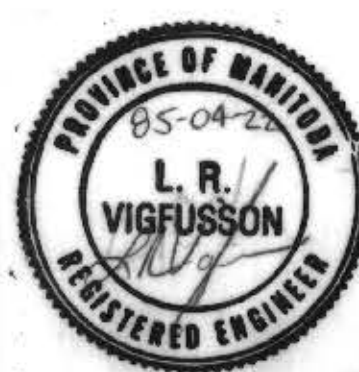

**Reid Crowther**  
DESIGNED BY: L.R.V.  
CHECKED BY: D.R.K.  
APPROVED BY: *W. McCallum*  
DATE: 85-02-11  
JOB NO: 60709-06

**THE CITY OF WINNIPEG**  
WORKS & OPERATIONS DIVISION  
STREETS & TRANSPORTATION DEPARTMENT

**RUE ARCHIBALD UNDERPASS**  
C.P.R. KEEWATIN SUBDIVISION  
PAVEMENT RECONSTRUCTION AND RELATED WORKS  
**WATT STREET**  
STA. 2+70 TO STA. 4+00  
AUTHORIZED BY: *W. McCallum* DATE: 1985-04-30  
ACCEPTED BY: *W. McCallum* DATE: 1985-04-30  
SCALE: HOR. 1:250 VER. 1:10  
DRAWING NO: U205-85-05