











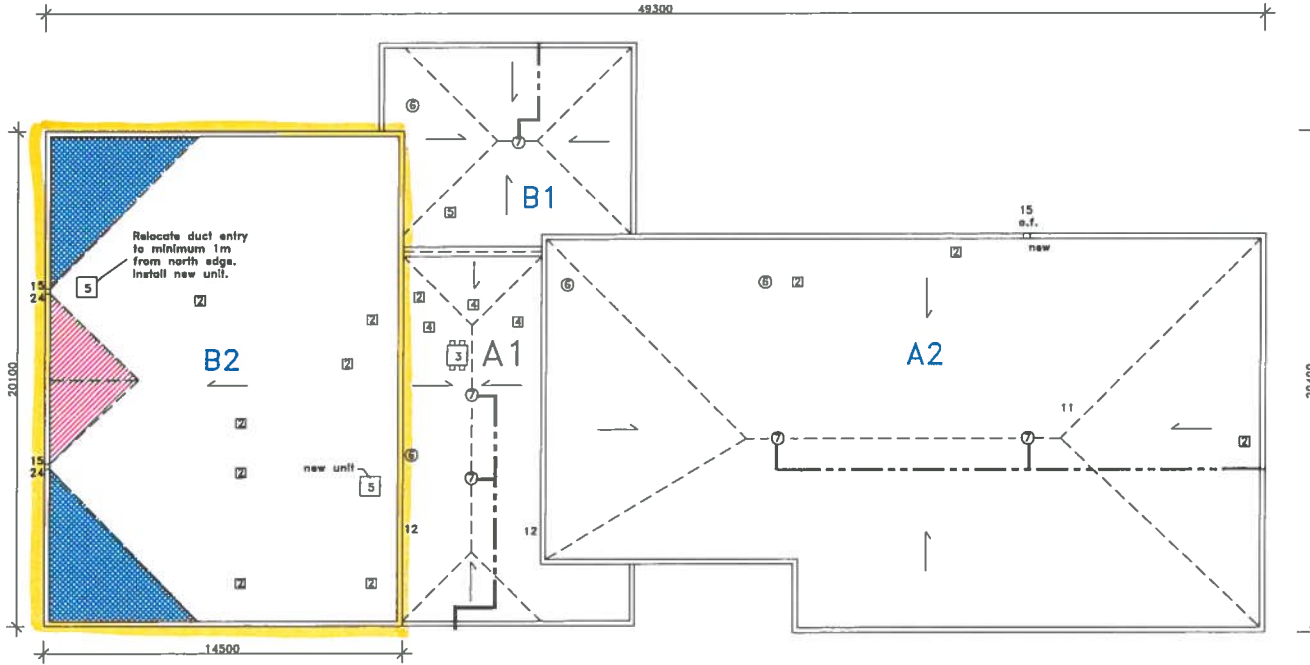

B2 Construction (2016)
 steel deck
 1/2" drywall
 torch grade base VB
 2% tapered type 2 EPS min 1"
 1" polyisocyanurate
 1" rock wool
 torch grade SBS base
 torch grade SBS cap
 system set in adhesive

A1, B1 & A2 Construction (2011)
 steel deck
 1/2" drywall
 2.2 mm torch grade base VB
 1.5% tapered type 2 EPS
 A2 - min 1.5"
 A1 & B1 - Min 3"
 1.5" polyisocyanurate
 1/4" recovery board
 180 gr torch grade base
 250 gr torch grade cap
 Mechanically fastened system

-  6"-0" x 12' back slope
-  10"-0" x 20' back slope
-  WORK AREA



GRAPHIC LEGEND

- Parapet 
- Gravel stop 
- Gas line 
- Control Joint 
- Expansion Joint 
- New Insulated drain pipe 
- Photo vantage point 
- Area Label 
- no. of stories 

☒ = attic vent X = leak

KEYNOTE LEGEND

- 1 core sample
- 2 chimney
- 3 AC unit
- 4 vent hood
- 5 ventilator
- 6 vent pipe
- 7 roof drain
- 8 skylight
- 9 eavestrough
- 10 firewall
- 11 antenna
- 12 ladder
- 13 stub column
- 14 roof hatch
- 15 scupper
- 16 pitch box
- 17 HVAC unit
- 18 capped curb
- 19 flag pole
- 20 electrical mast
- 21 cooling tower
- 22 splash pad
- 23 splash pan
- 24 downspout/rainwater leader
- 25 back slope
- 26 cant
- 27 increase slope to drain
- 28 cricket
- 29 parapet/wide flashing
- 30 life line anchor

ROOF PLAN

Parapet

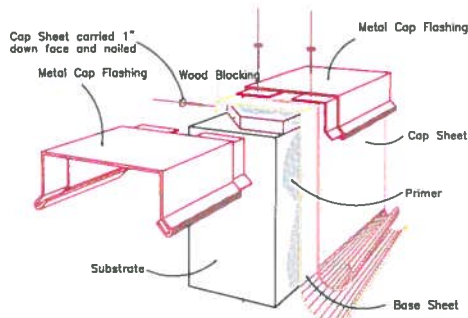

Typical Roof Edge Detail

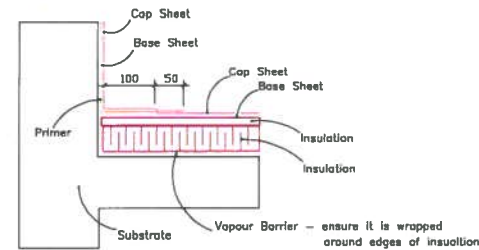

Approx. Area
 sq.m.
 A1 = 98
 A2 = 446
 B1 = 86
 B2 = 291
 Total = 921



Notes:
 .01 Contractor is responsible for site verifications of all dimensions
 .02 Drawings are not to be scaled for estimating purposes
 .03 All areas given are approximate
 .04 Contractor is responsible for site verification of existing roof constructions
 Stated scale is when in 11x17 format

ACG

Agassiz Consulting Group Ltd.
 Box 41, Warren, Manitoba R0C 3E0
 Office Phone (204) 383-553K

Project: **Springfield Shop**
 1229 Springfield
 Winnipeg, MB

Date: **September 25, 2016**

Drawing No. **R-1**

File no: **4352-16** Scale: **1:200**

BID OPP# 577-2016