

FLOOR PLAN

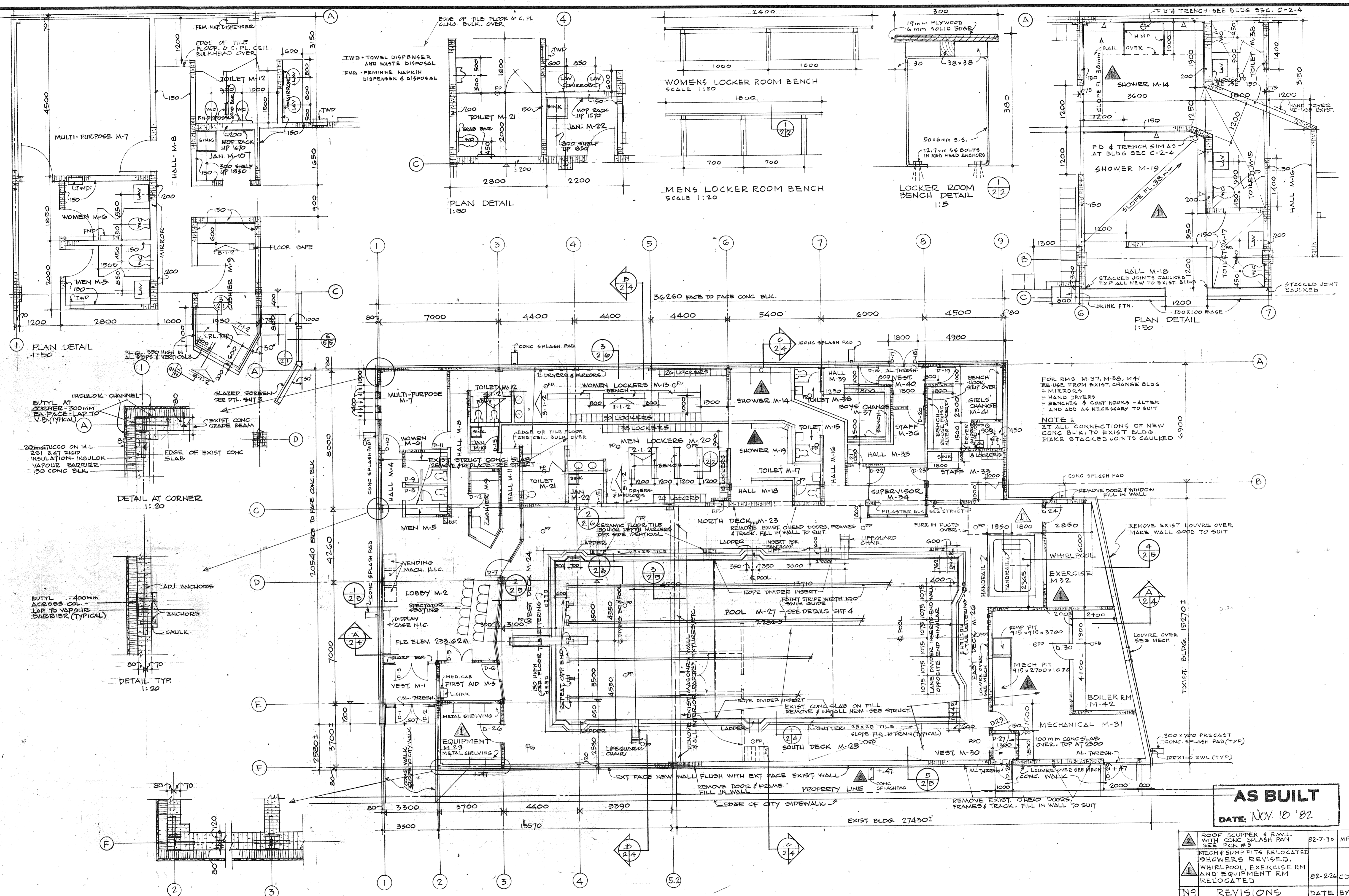

PLAN DETAIL 1:150

PLAN DETAIL 1:50

MENS LOCKER ROOM BENCH SCALE 1:20

LOCKER ROOM BENCH DETAIL 1:5

PLAN DETAIL 1:50

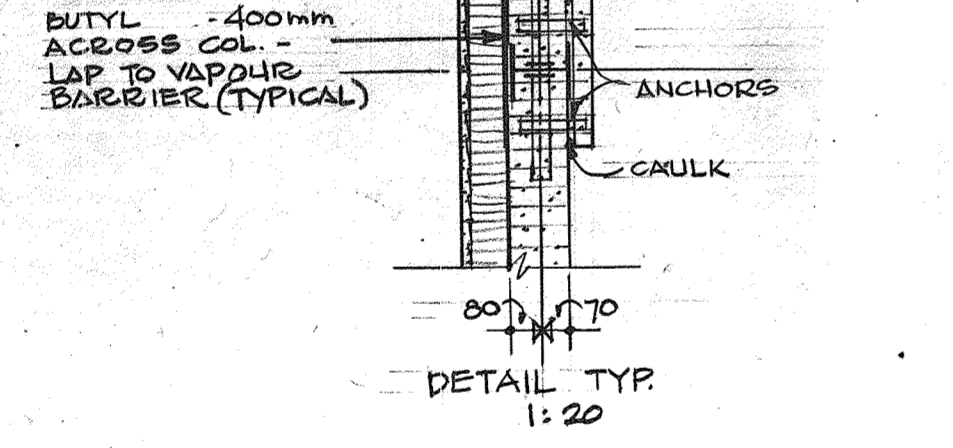
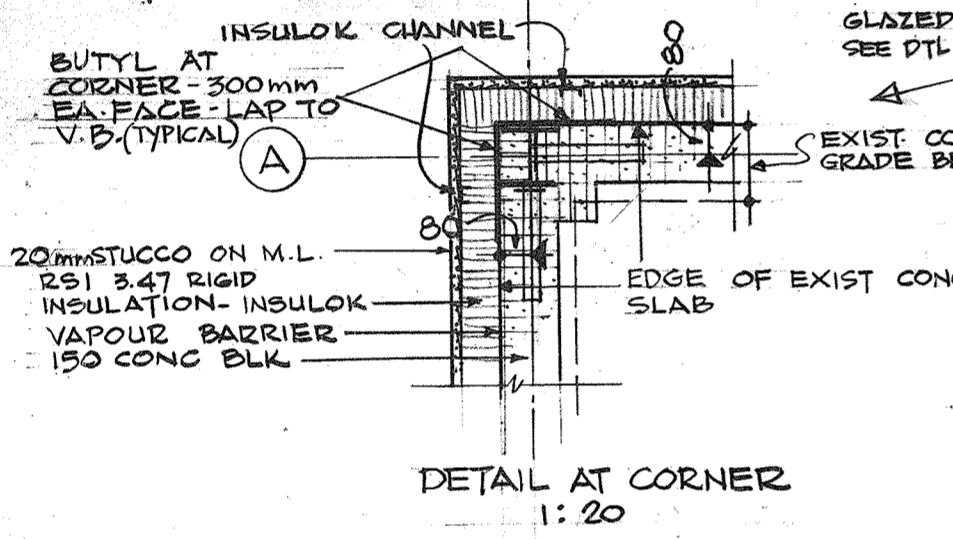

DETAIL AT CORNER 1:20

FOR RMS M-37, M-38, M-41 RE-USE FROM EXIST. CHANGE BLDG
 = MIRRORS
 = BENCHES & COAT HOOKS - ALTER AND ADD AS NECESSARY TO SUIT.
 NOTE:
 AT ALL CONNECTIONS OF NEW CONG. BLK. TO EXIST. BLDG. MAKE STACKED JOINTS CAULKED

AS BUILT
 DATE: NOV. 18 '82

ROOF SCUPPER & R.W.L. WITH CONG. SPLASH PAN SEE FCN # 3	82-7-30	MP
MECH & SUMP PITS RELOCATED SHOWERS REVISED. WHIRLPOOL, EXERCISE RM AND EQUIPMENT RM RELOCATED	82-276	CD
NO. REVISIONS		DATE BY



THE CITY OF WINNIPEG
 Works and Operations Div.
 Civic Properties Dept.
 6 - 510 Main St. R3B 1B9

APPROVED BY:
 DIRECTOR OF CIVIC PROPERTIES: *[Signature]*
 GEN. MGR. OF PARKS & RECREATION: *[Signature]*
 BROOKLANDS N.I.P.: *[Signature]*

BROOKLANDS N.I.P.
INDOOR SWIMMING POOL
 1887 PACIFIC WINNIPEG

FLOOR PLAN
 SCALE 1:100
 DATE 81.11.15
 DRAWN M.H.
 REV 8131
 SHEET NUMBER **2**

GBR ASSOCIATES
 ARCHITECTS
 ENGINEERS
 WINNIPEG, CANADA