

1+240 1+260 1+280 1+300 1+320 1+340

**WARNING**  
 IF POWER EQUIPMENT OR EXPLOSIVES ARE TO BE USED FOR EXCAVATION ON THIS PROJECT THE CONTRACTOR MUST:  
 1) NOTIFY THE GAS COMPANY OF THE PROPOSED LOCATION OF EXCAVATION.  
 2) TAKE PRECAUTION TO AVOID DAMAGE TO GAS COMPANY INSTALLATIONS.  
 SEE PROVINCIAL REGULATION 210/72 FOR DETAILS.

**PROPERTY LIMITS DELINEATION**  
 DELINEATION OF PROPERTY LIMITS AS SHOWN ON THIS DWG DOES NOT REPRESENT A LEGAL SURVEY. CH2M HILL MAKES NO REPRESENTATION OR WARRANTY AS TO THE ACCURACY OF PROPERTY LIMITS DELINEATED ON THIS DRAWING, NOR ON THE DIMENSIONAL ACCURACY OF DRAWING FEATURES RELATIVE TO THOSE PROPERTY LIMITS.

**CONSTRUCTION NOTES:**  
 1. SEWER AND WATER SERVICES SHOWN ON DRAWING ARE APPROXIMATE ONLY.  
 2. LOCATION OF ALL SEWER AND WATER LINES TO BE CONFIRMED IN FIELD.  
 3. INSTALL NEW SEWER BY TRENCHLESS METHODS, UNLESS OTHERWISE NOTED.

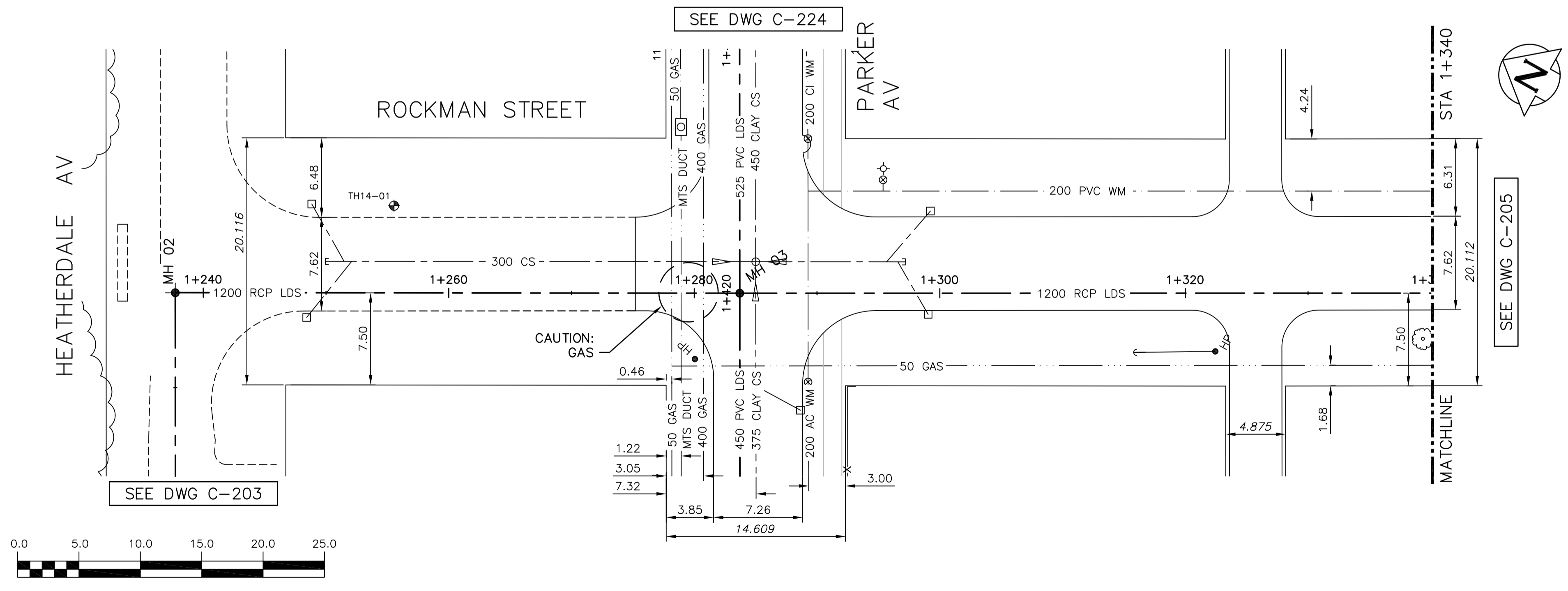

SEE DWG C-203

SEE DWG C-224

SEE DWG C-205

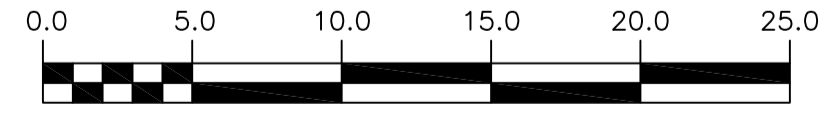

**APEGN**  
 Certificate of Authorization  
 CH2M HILL Canada Ltd.  
 No. 1441 Date: February 26, 2016

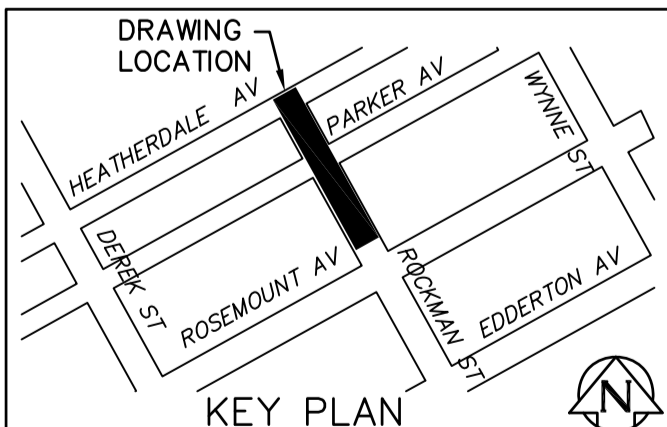

200 WM	WATERMAIN	200 WM	---	SL, HYDRO	---	150 WM	WATERMAIN	150 WM
+	HYDRANT	+	---	MTS	---	+	HYDRANT	+
⊗	VALVE	⊗	---	TRAFFIC SIGNALS	---	⊗	VALVE	⊗
525 LDS	LAND DRAINAGE SEWER	525 LDS	---	GAS	---	300 LDS	LAND DRAINAGE SEWER	300 LDS
375 WWS	WASTEWATER SEWER	375 WWS	---	SURVEY BAR	---	250 WWS	WASTEWATER SEWER	250 WWS
○	MANHOLE	●	---	FENCE	---	⊕	PROFILE	⊕
□	CATCH BASIN	■	---	POLE - HYDRO, MTS	---	⊕	GROUND ABOVE PIPE	⊕
▽	CURB INLET	♂	---	CURB STOP	---	⊕		⊕
+	JUNCTIONS	+	---	GUY ANCHOR	---			
⊕	CULVERT	⊕	---	LIGHT STANDARD	---			
⊕	ANODE	⊕	---	TREE	---			
---	EXISTING	---	---	LEGEND-PLAN	---	---	LEGEND-PROFILE	---

LOCATION APPROVED		B.M. ELEV.	
UNDERGROUND STRUCTURES		CONSTRUCTION COMPLETION DATE: YYYY MM DD	
SUPV. U/G STRUCTURES COMMITTEE	DATE		
NOTE: LOCATION OF UNDERGROUND STRUCTURES AS SHOWN ARE BASED ON THE BEST INFORMATION AVAILABLE BUT NO GUARANTEE IS GIVEN THAT ALL EXISTING UTILITIES ARE SHOWN OR THAT THE GIVEN LOCATIONS ARE EXACT. CONFIRMATION OF EXISTENCE AND EXACT LOCATION OF ALL SERVICES MUST BE OBTAINED FROM THE INDIVIDUAL UTILITIES BEFORE PROCEEDING WITH CONSTRUCTION.			
NO.	ISSUED FOR TENDER	02/2016	JBC
	REVISIONS	DATE	BY

<b>ch2m</b>	
DESIGNED BY: SDG	CHECKED BY: MAF
DRAWN BY: JBC	APPROVED BY: ES
SCALE: HORIZONTAL 1:250	RELEASED FOR CONSTRUCTION
VERTICAL 1:50	DATE



**THE CITY OF WINNIPEG**  
 WATER AND WASTE DEPARTMENT  
 ENGINEERING DIVISION

COCKBURN AND CALROSSIE COMBINED  
 SEWER RELIEF WORKS  
 ROCKMAN STREET  
 FROM HEATHERDALE AV TO  
 STA 1+340

SHEET 6 OF 25  
 CITY DRAWING NUMBER  
 LD-7804