

LDS CONNECTION TO MH 011

2+220 2+240

NOTE: REFER TO DRAWING LD-7231 FOR COMPLETE OUTFALL PLAN AND PROFILE

**WARNING**  
 IF POWER EQUIPMENT OR EXPLOSIVES ARE TO BE USED FOR EXCAVATION ON THIS PROJECT THE CONTRACTOR MUST:  
 1) NOTIFY THE GAS COMPANY OF THE PROPOSED LOCATION OF EXCAVATION.  
 2) TAKE PRECAUTION TO AVOID DAMAGE TO GAS COMPANY INSTALLATIONS. SEE PROVINCIAL REGULATION 210/72 FOR DETAILS.

**PROPERTY LIMITS DELINEATION**  
 DELINEATION OF PROPERTY LIMITS AS SHOWN ON THIS DWG DOES NOT REPRESENT A "LEGAL SURVEY". CH2M HILL MAKES NO REPRESENTATION OR WARRANTY AS TO THE ACCURACY OF PROPERTY LIMITS DELINEATED ON THIS DRAWING, NOR ON THE DIMENSIONAL ACCURACY OF DRAWING FEATURES RELATIVE TO THOSE PROPERTY LIMITS.

- CONSTRUCTION NOTES:**
- SEWER AND WATER SERVICES SHOWN ON DRAWING ARE APPROXIMATE ONLY.
  - LOCATION OF ALL SEWER AND WATER LINES TO BE CONFIRMED IN FIELD.
  - INSTALL NEW SEWER BY TRENCHLESS METHODS, UNLESS OTHERWISE NOTED.
  - NO STOCKPILING OF MATERIAL WITHIN 107m OF NORMAL SUMMER RIVER LEVEL (NSRL).
  - ALL EXCAVATED MATERIAL WITHIN 107m OF NSRL TO BE REMOVED FROM SITE.

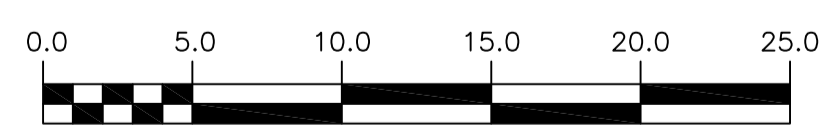
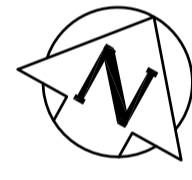
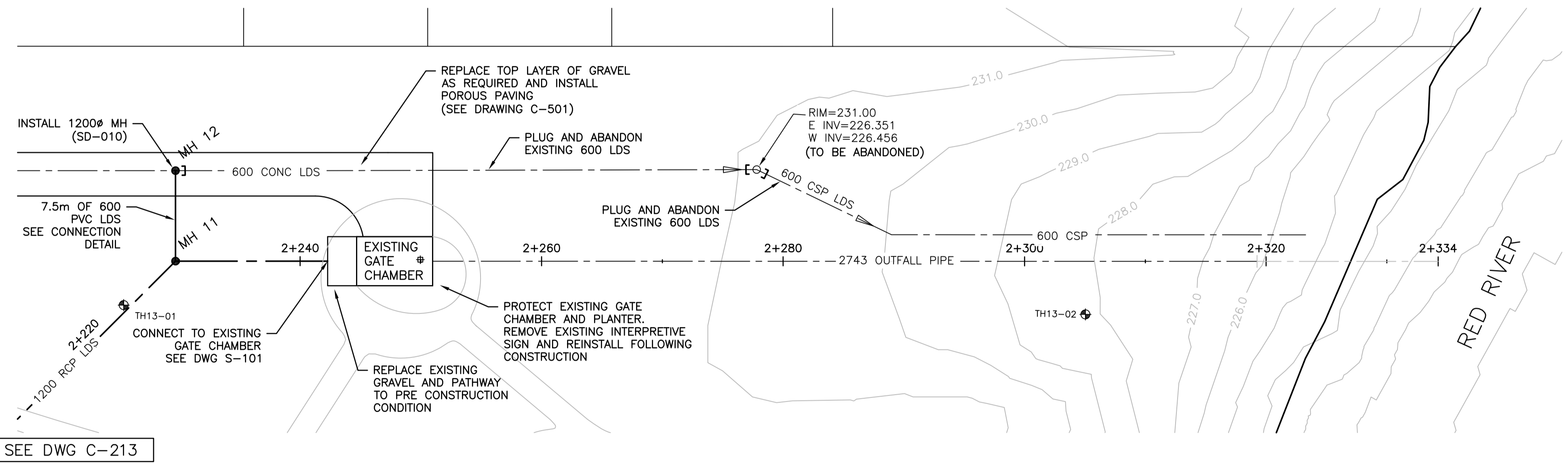

**APEGN**  
 Certificate of Authorization  
 CH2M HILL Canada Ltd.  
 No. 1441 Date: February 26, 2016

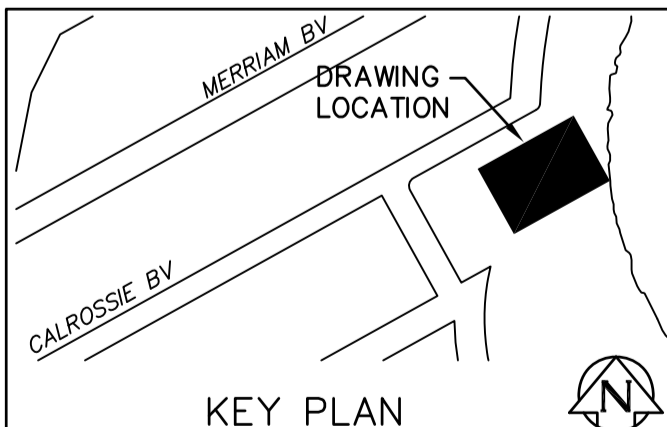

200 WM	WATERMAIN	200 WM	SL, HYDRO	150 WM	WATERMAIN	150 WM
⊕	HYDRANT	⊕	MTS	⊕	HYDRANT	⊕
⊙	VALVE	⊙	TRAFFIC SIGNALS	⊙	VALVE	⊙
525 LDS	LAND DRAINAGE SEWER	525 LDS	GAS	300 LDS	LAND DRAINAGE SEWER	300 LDS
375 WWS	WASTEWATER SEWER	375 WWS	SURVEY BAR	250 WWS	WASTEWATER SEWER	250 WWS
○	MANHOLE	○	FENCE	⊕	PROFILE	⊕
□	CATCH BASIN	□	POLE - HYDRO, MTS	⊕	GROUND ABOVE PIPE	⊕
▽	CURB INLET	▽	CURB STOP	⊕		⊕
⊕	JUNCTIONS	⊕	GUY ANCHOR	⊕		⊕
⊕	CULVERT	⊕	LIGHT STANDARD	⊕		⊕
⊕	ANODE	⊕	TREE	⊕		⊕
EXISTING	LEGEND-PLAN	PROPOSED	EXISTING	LEGEND-PLAN	PROPOSED	EXISTING

**LOCATION APPROVED UNDERGROUND STRUCTURES**

SUPV. U/G STRUCTURES COMMITTEE DATE

NOTE:  
 LOCATION OF UNDERGROUND STRUCTURES AS SHOWN ARE BASED ON THE BEST INFORMATION AVAILABLE BUT NO GUARANTEE IS GIVEN THAT ALL EXISTING UTILITIES ARE SHOWN OR THAT THE GIVEN LOCATIONS ARE EXACT. CONFIRMATION OF EXISTENCE AND EXACT LOCATION OF ALL SERVICES MUST BE OBTAINED FROM THE INDIVIDUAL UTILITIES BEFORE PROCEEDING WITH CONSTRUCTION.

NO.	ISSUED FOR TENDER	REVISIONS	DATE	BY
0	ISSUED FOR TENDER		02/2016	JBC

**ch2m**

DESIGNED BY: SDG  
 CHECKED BY: MAF  
 DRAWN BY: JBC  
 APPROVED BY: ES

SCALE:  
 HORIZONTAL 1:250  
 VERTICAL 1:50

DATE: 02/2016

ENGINEER'S SEAL  
**S.D. GODON**  
 MEMBER 25524  
 REGISTERED PROFESSIONAL ENGINEER

CONSULTANT DRAWING NUMBER: C-214

**THE CITY OF WINNIPEG**  
 WATER AND WASTE DEPARTMENT  
 ENGINEERING DIVISION

COCKBURN AND CALROSSIE COMBINED SEWER RELIEF WORKS

BYNG PLACE FROM MH 11 TO EXISTING GATE CHAMBER

SHEET 16 OF 25  
 CITY DRAWING NUMBER: LD-7814