

WWS CONNECTION TO MH 014

NOTE: CHAINAGES SHOWN ARE ALONG CL OF PROPOSED PIPE

WARNING
 IF POWER EQUIPMENT OR EXPLOSIVES ARE TO BE USED FOR EXCAVATION ON THIS PROJECT THE CONTRACTOR MUST:
 1) NOTIFY THE GAS COMPANY OF THE PROPOSED LOCATION OF EXCAVATION.
 2) TAKE PRECAUTION TO AVOID DAMAGE TO GAS COMPANY INSTALLATIONS.
 SEE PROVINCIAL REGULATION 210/72 FOR DETAILS

- CONSTRUCTION NOTES:**
- SEWER AND WATER SERVICES SHOWN ON DRAWING ARE APPROXIMATE ONLY.
 - LOCATION OF ALL SEWER AND WATER LINES TO BE CONFIRMED IN FIELD.
 - INSTALL NEW SEWER BY TRENCHLESS METHODS, UNLESS OTHERWISE NOTED.
 - EXISTING CROSS CONNECTION TO BE INVESTIGATED AND CONDITION OF EXISTING FLAP AND SLUICE GATES TO BE PROVIDED TO CONTRACT ADMINISTRATOR PRIOR TO REMOVAL FOR RE-USE CONFIRMATION.
 - REFER TO DRAWING C-505 FOR WEIR OVERFLOW STRUCTURE DETAILS.

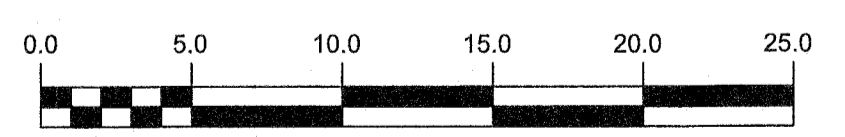
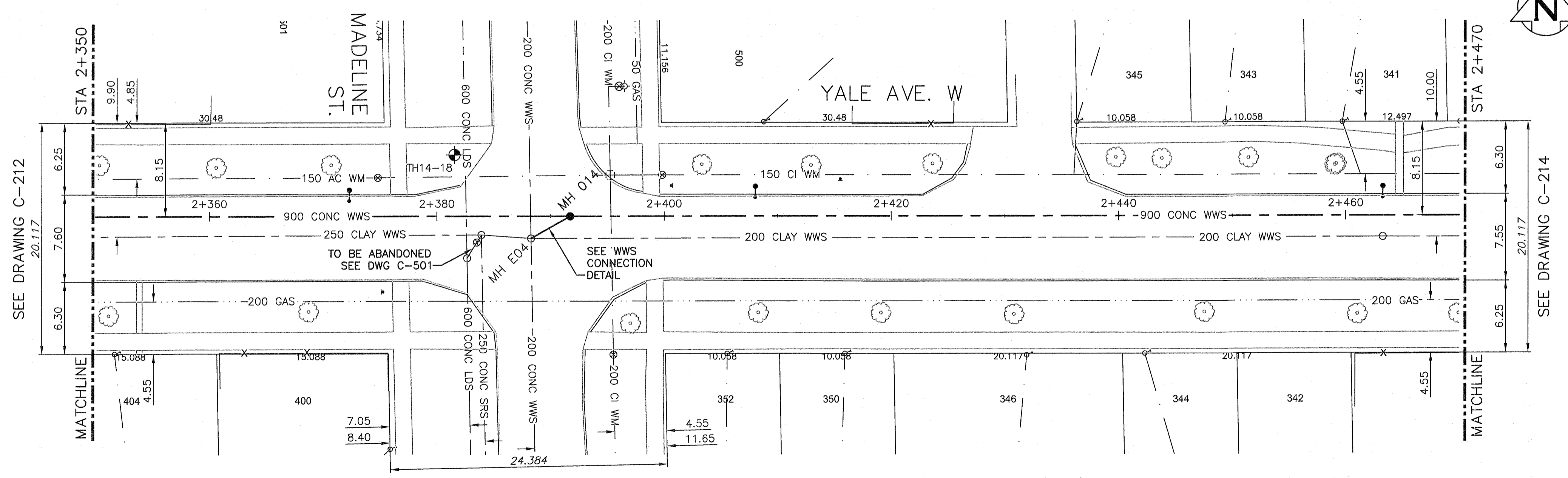

APEGM
 Certificate of Authorization
 CH2M HILL Canada Ltd.
 No. 1441 Date: 2016 02 11

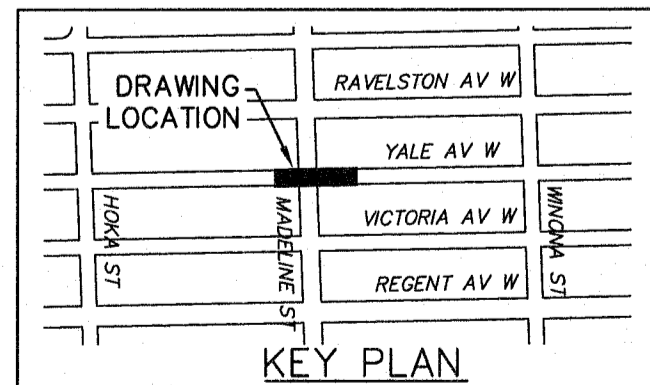

| | | | | | | |
|-------------|---------------------|-------------|-------------------|-------------------|---------------------|-------------------|
| 200 WM | WATERMAIN | 200 WM | SL, HYDRO | 150 WM | WATERMAIN | 150 WM |
| Hydrant | HYDRANT | Hydrant | MTS | Hydrant | HYDRANT | Hydrant |
| Valve | VALVE | Valve | TRAFFIC SIGNALS | Valve | VALVE | Valve |
| 525 LDS | LAND DRAINAGE SEWER | 525 LDS | GAS | 300 LDS | LAND DRAINAGE SEWER | 300 LDS |
| 375 WWS | WASTEWATER SEWER | 375 WWS | SURVEY BAR | 250 WWS | WASTEWATER SEWER | 250 WWS |
| Manhole | MANHOLE | Manhole | FENCE | Profile | Q PROFILE | Profile |
| Catch Basin | CATCH BASIN | Catch Basin | POLE - HYDRO, MTS | Ground Above Pipe | GROUND ABOVE PIPE | Ground Above Pipe |
| Curb Inlet | CURB INLET | Curb Inlet | CURB STOP | | | |
| Junctions | JUNCTIONS | Junctions | GUY ANCHOR | | | |
| Culvert | CULVERT | Culvert | LIGHT STANDARD | | | |
| Anode | ANODE | Anode | TREE | | | |
| EXISTING | LEGEND-PLAN | PROPOSED | EXISTING | LEGEND-PROFILE | PROPOSED | EXISTING |

| | | | |
|--|------------------|---------------------------|--------------------|
| LOCATION APPROVED UNDERGROUND STRUCTURES | | B.M. ELEV. | |
| CONSTRUCTION COMPLETION DATE: YYYY MM DD | | | |
| DESIGNED BY | MAF | CHECKED BY | MD |
| DRAWN BY | JBC | APPROVED BY | <i>[Signature]</i> |
| SCALE: | HORIZONTAL 1:250 | RELEASED FOR CONSTRUCTION | <i>[Signature]</i> |
| | VERTICAL 1:50 | DATE | Feb 12/16 |
| ISSUED FOR TENDER | 02/16 | JBC | |
| NO. | REVISIONS | DATE | BY |

ch2m

ENGINEER'S SEAL
 PROVINCE OF MANITOBA
[Signature]
 Member 25524
 REGISTERED PROFESSIONAL ENGINEER

CONSULTANT DRAWING NUMBER
 C-213

THE CITY OF WINNIPEG
 WATER AND WASTE DEPARTMENT
 ENGINEERING DIVISION

TRANSCONA SEWER RELIEF WORKS
 CONTRACT NO. 1
 YALE AVE W
 FROM STA 2+350 TO 2+470

SHEET 16 OF 24
 CITY DRAWING NUMBER
 LD-7757