

2:\Projects\0015 City of Winnipeg\0015 014 00 Lyndale Monck to Gauvin\3 Survey and Dwg\3.4 CAD\3.4.3 Working Folder\0015 014 00 SHT10-13.dwg
 Last Saved: 9/28/2016 2:29 PM by drevies
 Printed: 9/28/2016 2:29 PM by Daniel Neves
 ISO A1 - 594mm x 841mm

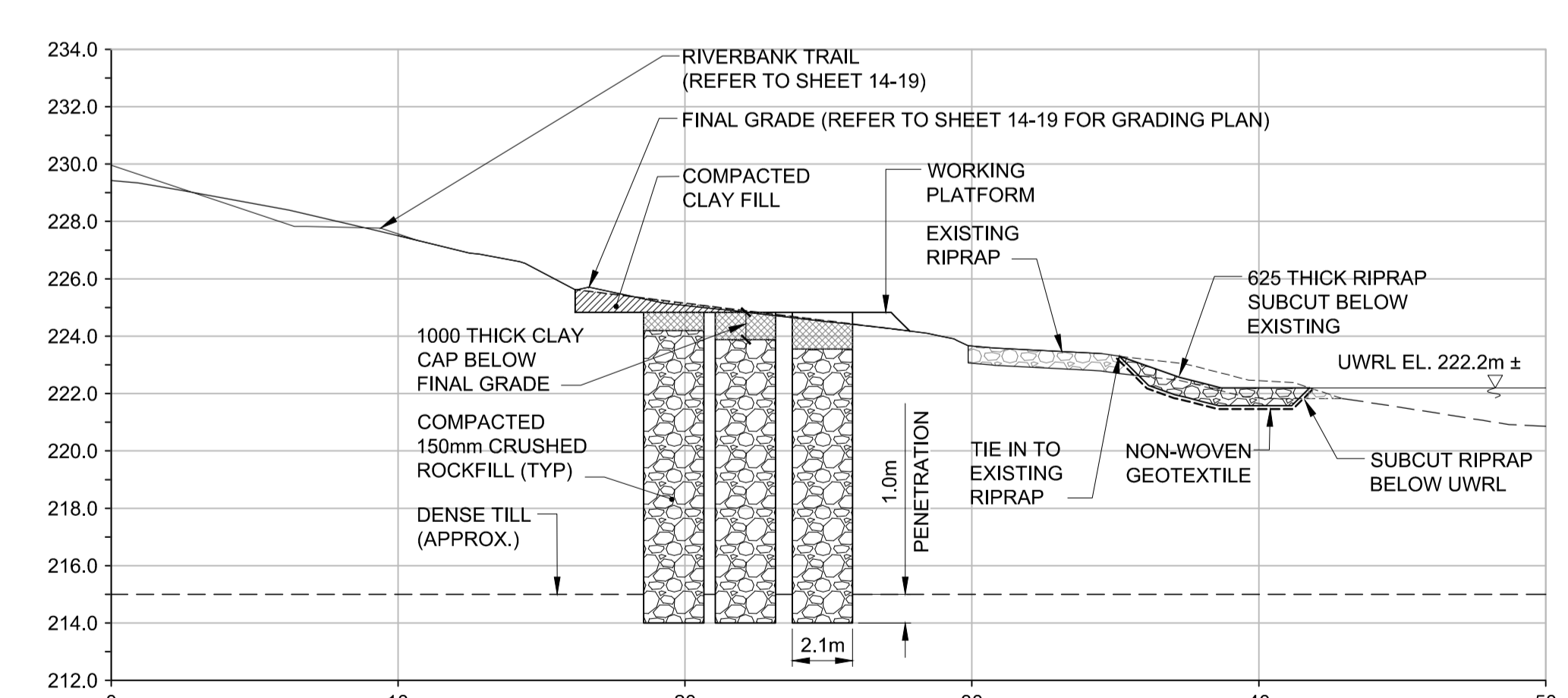
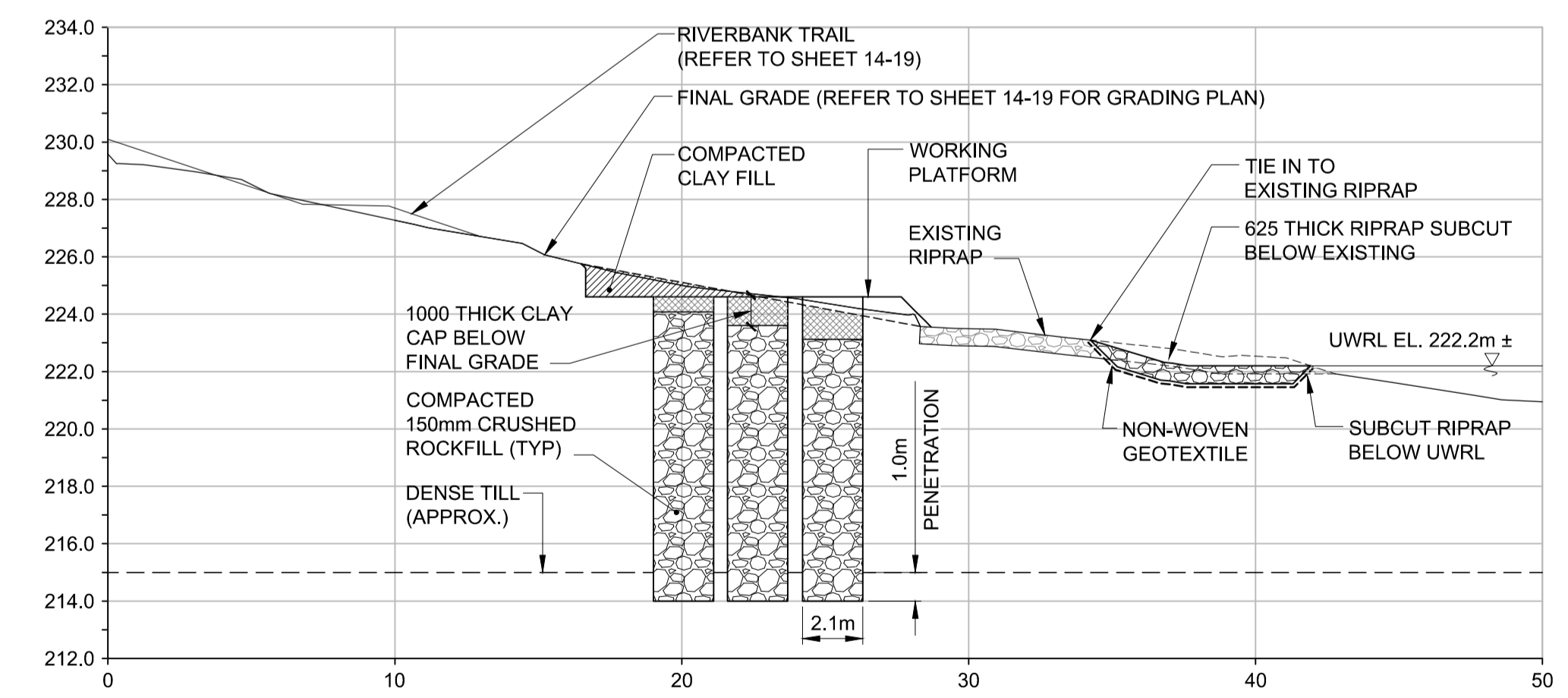
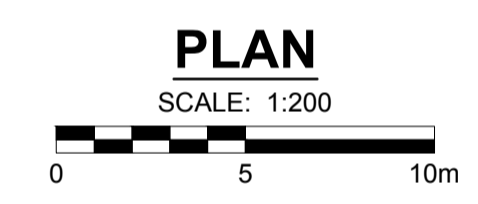
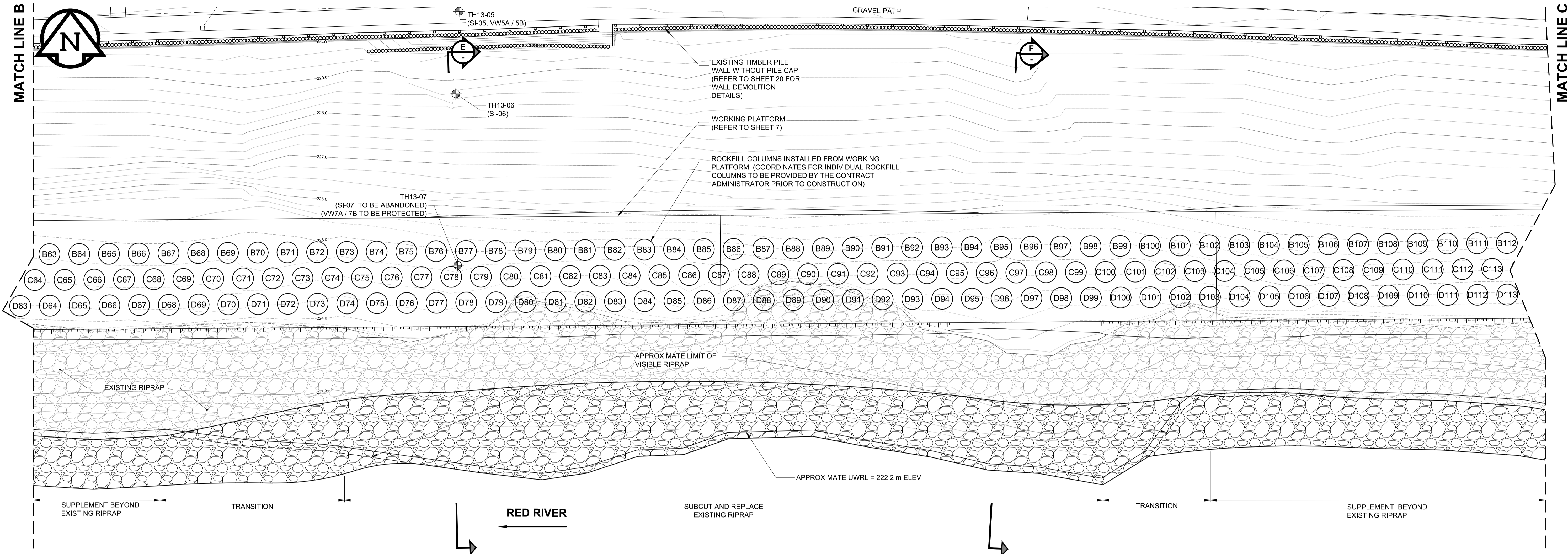

- NOTE:**
- UWRL (UNREGULATED WINTER RIVER LEVEL) = APPROXIMATELY 222.2 m ELEV.
 - EXISTING GEOTECHNICAL INSTRUMENTATION CONSISTING OF SLOPE INCLINOMETER (SI) AND VIBRATING-WIRE PIEZOMETERS (VW) TO BE PROTECTED UNLESS OTHERWISE NOTED.

METRIC
 WHOLE NUMBERS INDICATE MILLIMETRES
 DECIMALIZED NUMBERS INDICATE METRES

GAS MTS HANDWELL/PEDESTAL HYDRO HANDWELL/CABINET CATV/FIBRE OPTIC TRAFFIC SIGNALS/PIT LAND DRAINAGE SEWER SANITARY/COMBINED SEWER CB LEAD/SSP/DCP WATERMAIN SUBDRAIN DITCH	MANHOLE CATCH BASIN/CATCH PIT CURB INLET WITH BOX TREE TEST HOLE PROPERTY LINE SURVEY BAR FENCE BOC/EDGE OF PAVEMENT ELEVATION (33.333) TRAFFIC SIGN	CONCRETE PAVEMENT CONC SIDEWALK/MEDIAN ASPHALT PAVEMENT PAVING STONE GRAVEL RAMP CURB PLANING/REMOVAL
--	--	---

LOCATION APPROVED
 UNDERGROUND STRUCTURES
 SUPR. U/G STRUCTURES COMMITTEE DATE
NOTE:
 LOCATION OF UNDERGROUND STRUCTURES AS SHOWN ARE BASED ON THE BEST INFORMATION AVAILABLE BUT NO GUARANTEE IS GIVEN THAT ALL EXISTING UTILITIES ARE SHOWN OR THAT THE GIVEN LOCATIONS ARE EXACT. CONFIRMATION OF EXISTENCE AND EXACT LOCATION OF ALL SERVICES MUST BE OBTAINED FROM THE INDIVIDUAL UTILITIES BEFORE PROCEEDING WITH CONSTRUCTION.

BM 34-007 ELEV 231.455 m S.W. Cor. Tache Ave. and Lyndale Dr. Toll. In E. Cor. Plat. 11.9 W. n.E.L. of Tache Ave. & 2.7 S. of S. curb of Pav'l on Lyndale Dr.	<table border="1"> <tr> <th>No.</th> <th>REVISIONS</th> <th>DATE</th> <th>BY</th> </tr> <tr> <td> </td> <td> </td> <td> </td> <td> </td> </tr> </table>	No.	REVISIONS	DATE	BY				
No.	REVISIONS	DATE	BY						

	DESIGNED BY: MVH CHECKED BY: KMS DRAWN BY: BIT APPROVED BY: RELEASED FOR CONSTRUCTION: DATE: 16/09/29
--	--

PROFESSIONAL'S SEAL

 CONSULTANT FILE NAME: 0015 014 00 SHT10-13.dwg

THE CITY OF WINNIPEG
 PUBLIC WORKS DEPARTMENT
 ENGINEERING DIVISION
LYNDALE DRIVE RIVERBANK STABILIZATION AND ASSOCIATED WORKS
 MONCK AVENUE TO GAUVIN STREET
 RIVERBANK STABILIZATION PLAN AND SECTIONS

CITY DRAWING NUMBER: RW751-2016-012
 SHEET 12 OF 32
 DRAWING No. REV 12 C

Certificate of Authorization
 Trek Geotechnical Inc.
 No. 4877 Date:

BID OPPORTUNITY No. 721-2016