

RIVERBANK TRAIL PROFILE

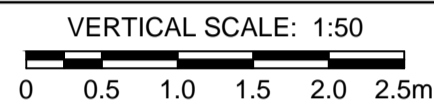

CHAINAGE
ALONG L
PROPOSED PAVEMENT

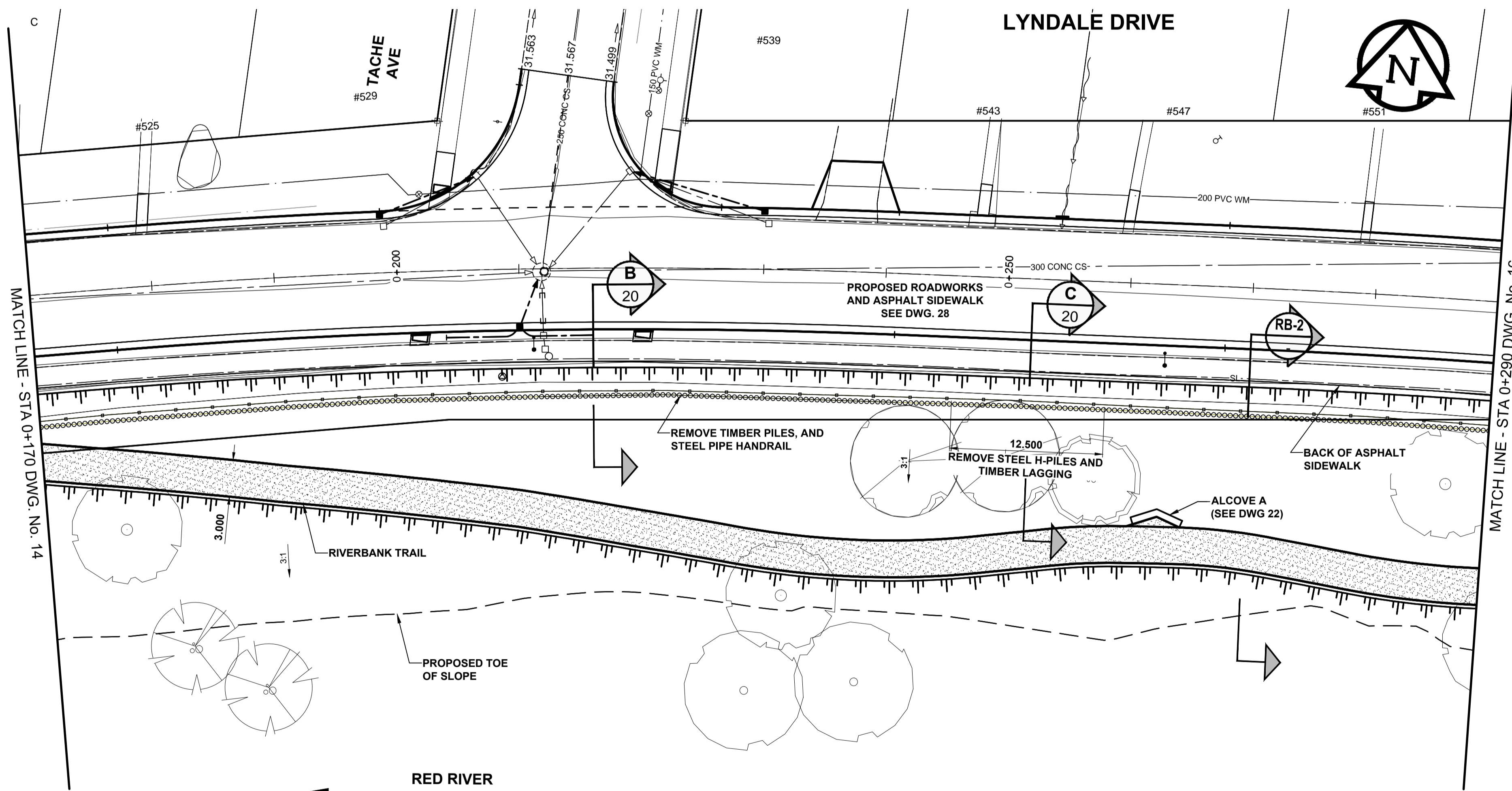

PLAN

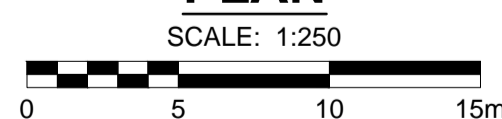

PLANT SPECIFICATION LIST

Symbol	Quantity	Botanical / Common Name	Size / Remarks
Deciduous Trees			
	11	<i>Acer negundo</i> / Manitoba Maple	60mm cal., 3.7 to 4.0m ht., 11 major branches in well formed head 2.0m above grade, B&B or tree mover, wire basket. Double stake.
	9	<i>Ulmus Americana</i> / American Elm	60mm cal., 3.7 to 4.0m ht., 11 major branches in well formed head 2.0m above grade, B&B or tree mover, wire basket. Double stake.
	8	<i>Tilia americana</i> / Basswood	Multi-stem, 3.7 to 4.0m ht., 11 major branches in well formed head 2.0m above grade, B&B or tree mover, wire basket. Double stake.
	11	<i>Populus deltoides</i> / Cottonwood (male - seedless)	60mm cal., 3.7 to 4.0m ht., 11 major branches in well formed head 2.0m above grade, B&B or tree mover, wire basket. Double stake.
	8	<i>Salix amygdaloides</i> 'Andersson' / Peachleaf Willow	Multi-stem, 3.7 to 4.0m ht., 11 major branches in well formed head 2.0m above grade, B&B or tree mover, wire basket. Double stake.

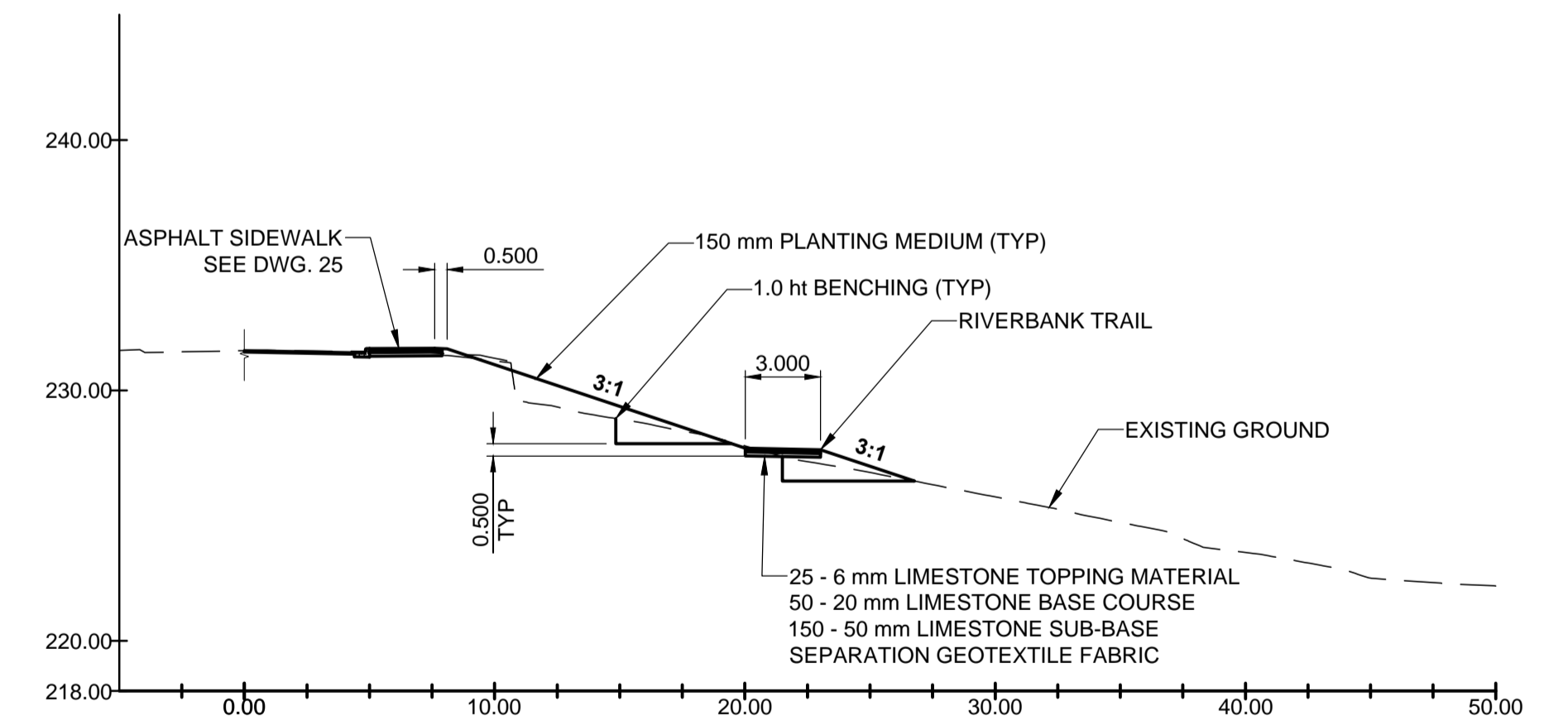

RB-2 RIVERBANK TRAIL SECTION

GRAVEL STRUCTURE
STATION 0+270.000
SCALE: HOR 1:250 VER 1:250

METRIC

WHOLE NUMBERS INDICATE MILLIMETRES
DECIMALIZED NUMBERS INDICATE METRES

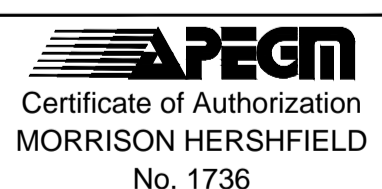

BID OPPORTUNITY No. 721-2016

M:\Proj\61600474 Design\Drawings\Sheets\Detailed Design\51600474_Lyndale-PP-15.dwg Last Saved: 9/26/2016 5:18 PM by diane Ploined: 9/26/2016 1:18 PM by Dave Lane

EXISTING	LEGEND - PLAN	NEW	EXISTING	LEGEND - PLAN	NEW	EXISTING	LEGEND - PLAN	NEW
	GAS			MANHOLE			CONCRETE PAVEMENT	
	MTS HANDWELL/PEDESTAL			CATCH BASIN/CATCH PIT			CONC SIDEWALK/MEDIAN	
	HYDRO HANDWELL/CABINET			CURB INLET WITH BOX			ASPHALT PAVEMENT	
	CATV/FIBRE OPTIC			TREE			PAVING STONE	
	TRAFFIC SIGNALS/PIT			TEST HOLE			GRAVEL	
	LAND DRAINAGE SEWER			PROPERTY LINE			RAMP CURB	
	SANITARY/COMBINED SEWER			SURVEY BAR			PLANING/REMOVAL	
	CB LEAD/SSP/DCP			FENCE				
	WATERMAIN			BOC/EDGE OF PAVEMENT				
	SUBDRAIN			ELEVATION				
	DITCH			TRAFFIC SIGN				

LOCATION APPROVED
UNDERGROUND STRUCTURES

DATE: _____

NOTE:
LOCATION OF UNDERGROUND STRUCTURES AS SHOWN ARE BASED ON THE BEST INFORMATION AVAILABLE BUT NO GUARANTEE IS GIVEN THAT ALL EXISTING UTILITIES ARE SHOWN OR THAT THE GIVEN LOCATIONS ARE EXACT. CONFIRMATION OF EXISTENCE AND EXACT LOCATION OF ALL SERVICES MUST BE OBTAINED FROM THE INDIVIDUAL UTILITIES BEFORE PROCEEDING WITH CONSTRUCTION.

BM 34-004	ELEV 229.873m
C	ISSUED FOR TENDER 16/09/29 JGK
B	ISSUED FOR FINAL REVIEW 16/09/13 JGK
A	ISSUED FOR 75% REVIEW 16/08/17 JGK
No. REVISIONS	YYMMDD BY DATE

MORRISON HERSHFIELD	
DESIGNED BY: JGK	CHECKED BY: MVH
DRAWN BY: DID	APPROVED BY: BWB
DATE: 16/09/06	RELEASED FOR CONSTRUCTION

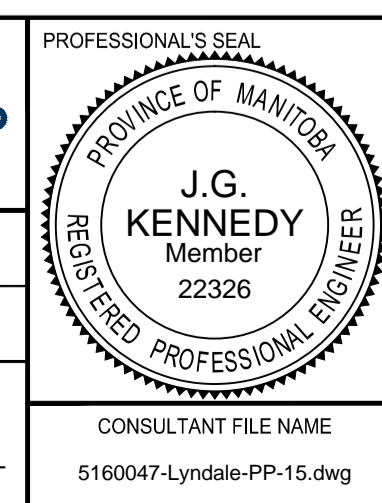

THE CITY OF WINNIPEG
PUBLIC WORKS DEPARTMENT
ENGINEERING DIVISION

LYNDALE DRIVE RIVERBANK STABILIZATION AND ASSOCIATED WORKS
MONCK AVENUE TO GAUVIN STREET
RIVERBANK GRADING AND TRAIL
STA 0+170 TO STA 0+290

CITY DRAWING NUMBER: RW751-2016-15
SHEET 15 OF 32
DRAWING No. 15 REV C