

NOTE: CHAINAGES SHOWN ARE ALONG CL OF PROPOSED PIPE

WARNING
 IF POWER EQUIPMENT OR EXPLOSIVES ARE TO BE USED FOR EXCAVATION ON THIS PROJECT THE CONTRACTOR MUST:
 1) NOTIFY THE GAS COMPANY OF THE PROPOSED LOCATION OF EXCAVATION.
 2) TAKE PRECAUTION TO AVOID DAMAGE TO GAS COMPANY INSTALLATIONS.
 SEE PROVINCIAL REGULATION 210/72 FOR DETAILS

- CONSTRUCTION NOTES:**
- SEWER AND WATER SERVICES SHOWN ON DRAWING ARE APPROXIMATE ONLY.
 - LOCATION OF ALL SEWER AND WATER LINES TO BE CONFIRMED IN FIELD.
 - INSTALL NEW SEWER BY TRENCHLESS METHODS, UNLESS OTHERWISE NOTED.
 - FRONT ACCESS TO ALL YALE AVENUE PROPERTIES TO BE MAINTAINED AT ALL TIMES DURING CONSTRUCTION PERIOD.
 - EXISTING 750 WWS INSTALLED AS PART OF TRANSCONA CONTRACT NO. 1 (BID OPPORTUNITY 70-2016). INVERT AND EXACT LOCATION TO BE FIELD VERIFIED.
 - ABANDONED AS PART OF TRANSCONA CONTRACT NO. 1 (BID OPPORTUNITY 70-2016)

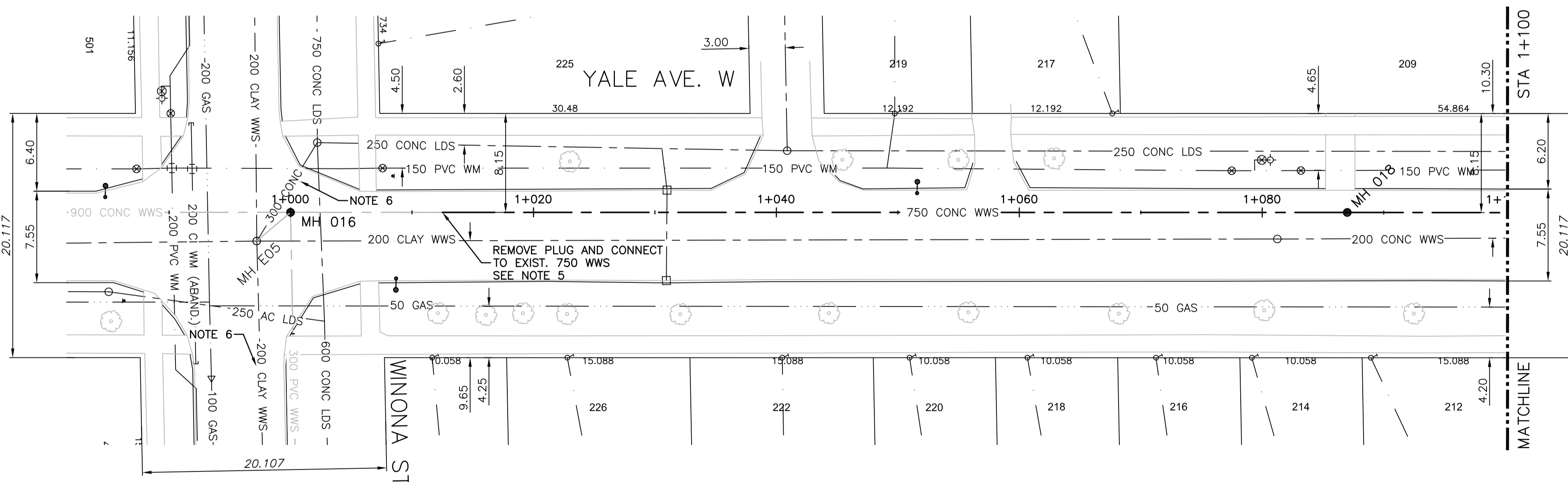

SEE DRAWING C-222

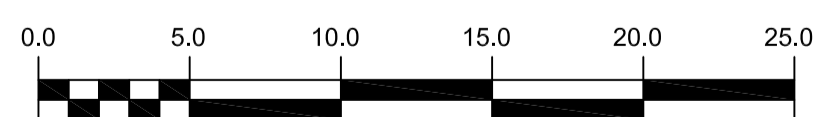

200 WM	WATERMAIN	200 WM	SL - HYDRO	150 WM	WATERMAIN	150 WM
⊕	HYDRANT	⊕	MTS	⊕	HYDRANT	⊕
⊙	VALVE	⊙	TRAFFIC SIGNALS	⊙	VALVE	⊙
525 LDS	LAND DRAINAGE SEWER	525 LDS	50 GAS	300 LDS	LAND DRAINAGE SEWER	300 LDS
375 WWS	WASTEWATER SEWER	375 WWS	50 GAS	250 WWS	WASTEWATER SEWER	250 WWS
○	MANHOLE	●	⊗	⊗	PROFILE	⊗
□	CATCH BASIN	■	• H • T	⊗	GROUND ABOVE PIPE	⊗
▽	CURB INLET	▴	POLE - HYDRO, MTS	⊗		
⊕	JUNCTIONS	⊕	CURB STOP	⊗		
⊕	CULVERT	⊕	GUY ANCHOR	⊗		
⊕	ANODE	⊕	LIGHT STANDARD	⊗		
⊕		⊕	TREE	⊗		
EXISTING	LEGEND-PLAN	PROPOSED	EXISTING	LEGEND-PLAN	PROPOSED	EXISTING
				LEGEND-PROFILE	PROPOSED	

LOCATION APPROVED
UNDERGROUND STRUCTURES

NOTE:
 LOCATION OF UNDERGROUND STRUCTURES AS SHOWN ARE BASED ON THE BEST INFORMATION AVAILABLE BUT NO GUARANTEE IS GIVEN THAT ALL EXISTING UTILITIES ARE SHOWN OR THAT THE GIVEN LOCATIONS ARE EXACT. CONFIRMATION OF EXISTENCE AND EXACT LOCATION OF ALL SERVICES MUST BE OBTAINED FROM THE INDIVIDUAL UTILITIES BEFORE PROCEEDING WITH CONSTRUCTION.

B.M. ELEV.	
CONSTRUCTION COMPLETION DATE: YYYY MM DD	
DESIGNED BY	MAF
CHECKED BY	MD
DRAWN BY	JBC
APPROVED BY	ES
SCALE:	
HORIZONTAL	1:250
VERTICAL	1:50
ISSUED FOR TENDER	09/16 JBC
NO.	REVISIONS
	DATE
	BY
	DATE



ENGINEER'S SEAL
 PROVINCE OF MANITOBA
 S.D. GODON
 Member
 25524
 REGISTERED PROFESSIONAL ENGINEER
 CONSULTANT DRAWING NUMBER
 C-221

APEGM
 Certificate of Authorization
 CH2M HILL Canada Ltd.
 No. 1441

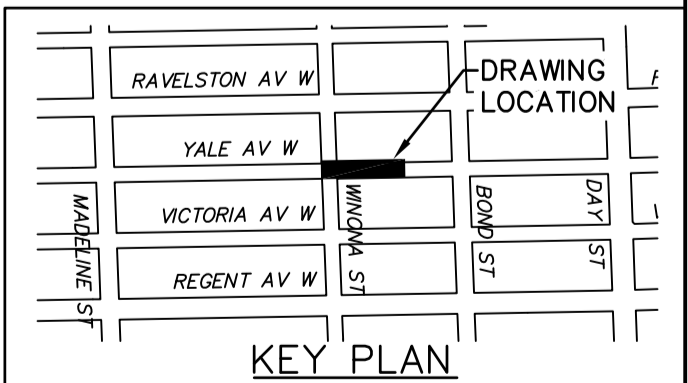

THE CITY OF WINNIPEG
 WATER AND WASTE DEPARTMENT
 ENGINEERING DIVISION
 TRANSCONA SEWER RELIEF WORKS
 CONTRACT NO. 2
 YALE AVE W
 FROM STA 1+000 TO 1+100
 SHEET 4 OF 22
 CITY DRAWING NUMBER
 LD-7902