

SPARLING AVENUE CONNECTION  
SEE DWG C-503 FOR DETAILS

**WARNING**  
IF POWER EQUIPMENT OR EXPLOSIVES ARE TO BE USED FOR EXCAVATION ON THIS PROJECT THE CONTRACTOR MUST:  
1) NOTIFY THE GAS COMPANY OF THE PROPOSED LOCATION OF EXCAVATION.  
2) TAKE PRECAUTION TO AVOID DAMAGE TO GAS COMPANY INSTALLATIONS.  
SEE PROVINCIAL REGULATION 210/72 FOR DETAILS

**PROPERTY LIMITS DELINEATION**  
DELINEATION OF PROPERTY LIMITS AS SHOWN ON THIS DWG DOES NOT REPRESENT A "LEGAL SURVEY". CH2M HILL MAKES NO REPRESENTATION OR WARRANTY AS TO THE ACCURACY OF PROPERTY LIMITS DELINEATED ON THIS DRAWING, NOR ON THE DIMENSIONAL ACCURACY OF DRAWING FEATURES RELATIVE TO THOSE PROPERTY LIMITS.

- CONSTRUCTION NOTES:**
- SEWER AND WATER SERVICES SHOWN ON DRAWING ARE APPROXIMATE ONLY.
  - LOCATION OF ALL SEWER AND WATER LINES TO BE CONFIRMED IN FIELD.
  - INSTALL NEW SEWER BY TRENCHLESS METHODS, UNLESS OTHERWISE NOTED.
  - MAINTAIN TRUCK ACCESS TO REAR OF WAL-MART FROM SPARLING AVENUE AT ALL TIMES.
  - INSTALL AND MAINTAIN TEMPORARY CONSTRUCTION FENCING ALONG ALL LDS CONSTRUCTION EASEMENT LINES. TEMPORARY ACCESS GATES TO BE INSTALLED AS SHOWN.
  - IRRIGATION LINE TO BE CONFIRMED PRIOR TO CONSTRUCTION AND RELOCATED IF NECESSARY.
  - TIE-IN LOCATION TO 2700 LDS TO BE LOCATED EITHER NORTH OR SOUTH OF PROPOSED LOCATION TO ALLOW CONNECTION POINT TO BE ALIGNED TO AVOID PIPE JOINTS BY MINIMUM OF 450mm.
  - PROPOSED STANDPIPE LOCATION TO BE DETERMINED ON SITE BY THE CONTRACTOR PRIOR TO CONSTRUCTION COMMENCEMENT. REFER TO SPECIFICATION FOR DETAILS.
  - IF REQUIRED THE EXISTING 1200 LDS PIPE TO BE TEMPORARY RELOCATED TO ALLOW INSTALLATION OF NEW MH 32. ALL SITE INVESTIGATIONS NECESSARY TO CONFIRM UTILITY LOCATIONS TO BE PROVIDED TO CONTRACT ADMINISTRATOR PRIOR TO MANHOLE INSTALLATION. LDS PIPE TO BE RETURNED TO EXISTING AFTER INSTALLATION.

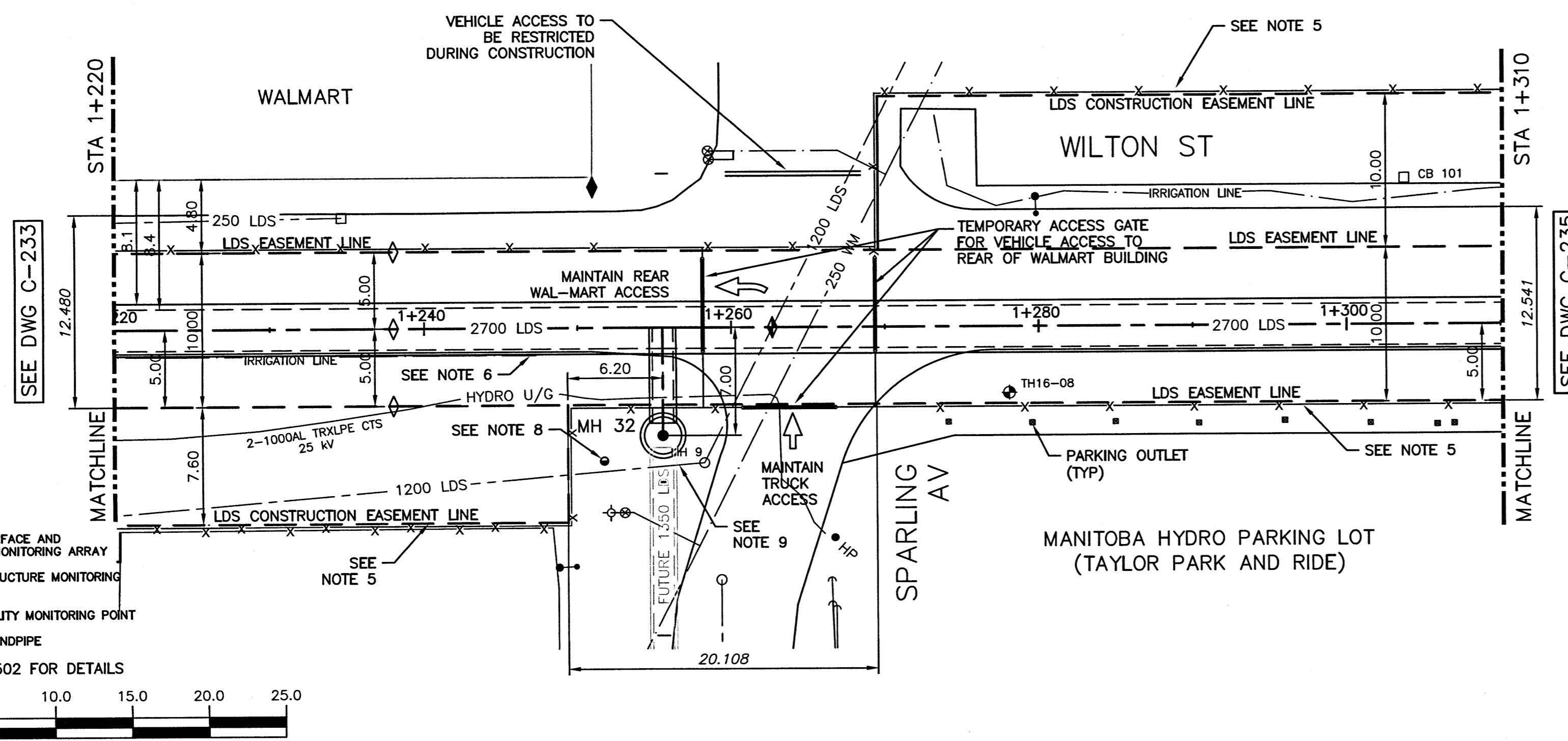

**LEGEND**  
 ◊ PROPOSED SURFACE AND SUBSURFACE MONITORING ARRAY  
 ◆ PROPOSED STRUCTURE MONITORING POINT  
 ◆ PROPOSED UTILITY MONITORING POINT  
 ● PROPOSED STANDPIPE  
 SEE DWG C-502 FOR DETAILS

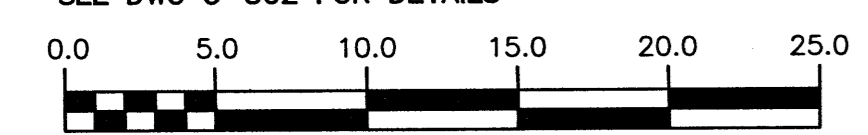

File Name C:\pwworkdir\ch2mhill\wg\portez\40204776

EXISTING	LEGEND-PLAN	PROPOSED	EXISTING	LEGEND-PLAN	PROPOSED	EXISTING	LEGEND-PROFILE	PROPOSED
150 WM	WATER MAIN	150 WM	HYDRO	M.T.S.	150 WM	WATER MAIN	150 WM	HYDRANT, VALVE
300 LDS	LAND DRAINAGE SEWER	300 LDS	CONCRETE	ASPHALT	300 LDS	LAND DRAINAGE SEWER	300 LDS	LAND DRAINAGE SEWER
250 WWS	WASTE WATER SEWER	250 WWS	SIDEWALK	PLANNING	250 WWS	WASTE WATER SEWER	250 WWS	CENTRELINE
○	MANHOLE	●	PROPERTY LINE	SURVEY BAR	□	NORTH/WEST GUTTER	○	SOUTH/EAST GUTTER
□	CATCH BASIN	■	GAS	CURB STOP	◇, ○	N/W, S/E P'S		
▽	CURB INLET	+	TEE					
∩	BEND	∩						
∩	REDUCER	∩						

**LOCATION APPROVED UNDERGROUND STRUCTURES**  
 SUPV. U/G STRUCTURES COMMITTEE DATE  
 NOTE: LOCATION OF UNDERGROUND STRUCTURES AS SHOWN ARE BASED ON THE BEST INFORMATION AVAILABLE BUT NO GUARANTEE IS GIVEN THAT ALL EXISTING UTILITIES ARE SHOWN OR THAT THE GIVEN LOCATIONS ARE EXACT. CONFIRMATION OF EXISTENCE AND EXACT LOCATION OF ALL SERVICES MUST BE OBTAINED FROM THE INDIVIDUAL UTILITIES BEFORE PROCEEDING WITH CONSTRUCTION.

NO.	REVISIONS	DATE	BY
0	ISSUED FOR TENDER	01/2017	JBC

**KGS GROUP**  
CONSULTING ENGINEERS

**ch2m**  
 DESIGNED BY: SDG  
 CHECKED BY: MD  
 DRAWN BY: JBC  
 APPROVED BY: RBO  
 HOR. SCALE: 1:250  
 VERTICAL: 1:50  
 RELEASED FOR CONSTRUCTION: 10 JAN 5/17

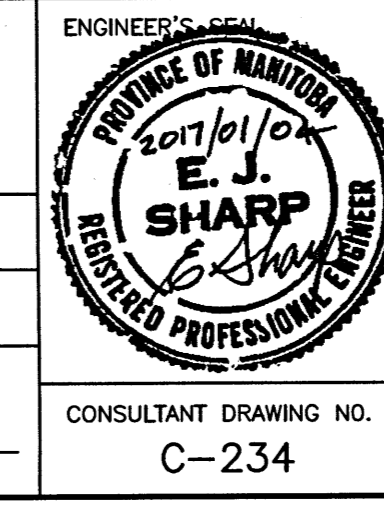

**THE CITY OF WINNIPEG**  
WATER AND WASTE DEPARTMENT

PROJECT TITLE: COCKBURN AND CALROSSIE COMBINED SEWER RELIEF WORKS - CONTRACT 4  
 FROM STA 1+220 TO STA 1+310

SHEET OF 8 OF 12  
 COMPUTER FILE NAME: C-234.dwg  
 CITY DRAWING NUMBER: LD-7894

