

KEYNOTE LEGEND	
1	NEW CORNER GUARDS TO BE INSTALLED, TYP.
2	ALL PENETRATIONS THROUGH EXISTING FIRE-RATING TO BE FIRE-STOPPED
3	EXISTING DOOR TO REMAIN.
4	ALL EXISTING WALLS WITHIN EXPANDED JANITOR'S CLOSET TO BE PATCHED, REPAIRED AND PREPARED TO RECEIVE NEW PAINT FINISH.
5	EXISTING DOOR TO BE SCRAPPED TO REVEAL EXISTING FIRE-RATING LABEL
6	NEW MOP SINK C/W MOP RAIL. REFER TO MECHANICAL.
7	EXPOSED CONCRETE FLOOR TO BE SEALED. REFER TO ROOM SCHEDULE.
8	BARRIER FREE ENTRANCE SIGNAGE, BARRIER FREE WASHROOM SIGNAGE, & ROOM IDENTIFICATION SIGNAGE REFER TO SPEC
9	NEW SURFACE-MOUNTED FIRE EXTINGUISHER CABINET C/W FIRE EXTINGUISHER. T.O. CABINET TO BE AT 4'-0" A.F.F. CONTRACTOR TO COORDINATE FINAL LOCATION WITH CONTRACT ADMINISTRATOR.
10	EXISTING FIRE SEPARATION TO BE MAINTAINED. ALL NEW & EXISTING PENETRATIONS TO BE FIRE-STOPPED TO SUIT. EXTENT OF SEPARATION SHOWN THUS: _____
11	ROTATED FLOOR ACCESS HATCH.

**GENERAL NOTES:**

1. ALL EXISTING LIGHT SWITCHES MOUNTED IN GYPSUM BOARD TO BE LOWERED TO 1000MM O.C. AS PER CITY OF WINNIPEG ACCESSIBILITY DESIGN STANDARDS. CONTRACTOR TO MAKE GOOD ALL GYPSUM BOARD AND FINISHES WHERE LIGHT SWITCHES HAVE BEEN RELOCATED.

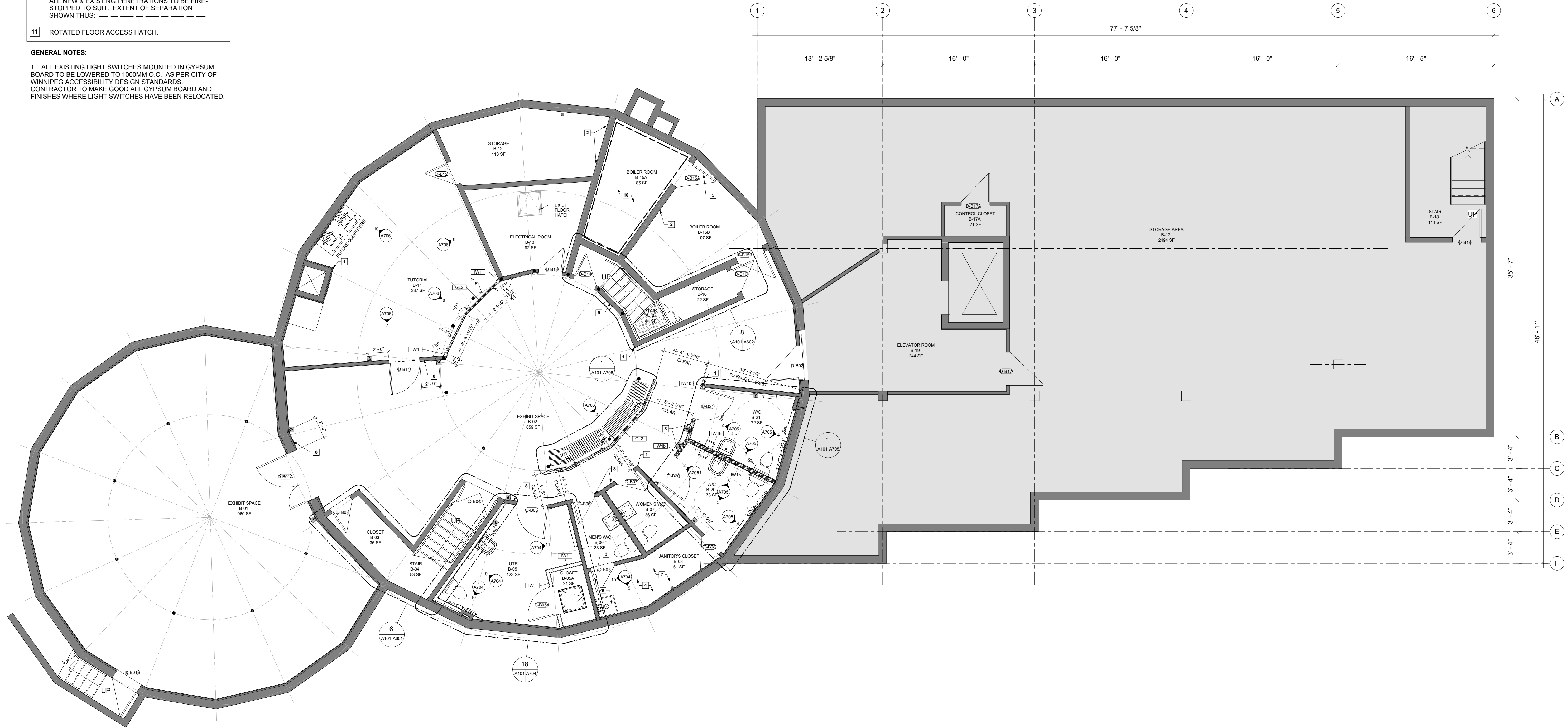

**1 BASEMENT FLOOR PLAN**  
3/16" = 1'-0"

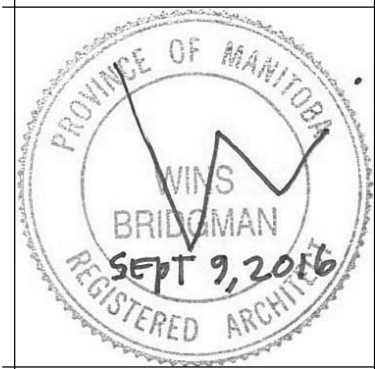

Project:  
St. Vital Library

6 Fermor Ave. Winnipeg, MB  
Project Number: 1605  
Bid Opportunity Number: 788-2016

Drawing Title:  
BASEMENT FLOOR PLAN

#	Issue/Revision	Date
1	ISSUED FOR CONSTRUCTION	SEPT 9, 2016

Sheet No: A101

This drawing is property of the Architect and cannot be reproduced or used without the consent of the Architect. The contractor is responsible for checking and verifying all levels and dimensions and shall report all discrepancies to the Architect and obtain clarification prior to commencing work.