

1 SECTION DETAIL - ROOF EDGE ON FLAT ROOF (HIGH SIDE)
3" = 1'-0"

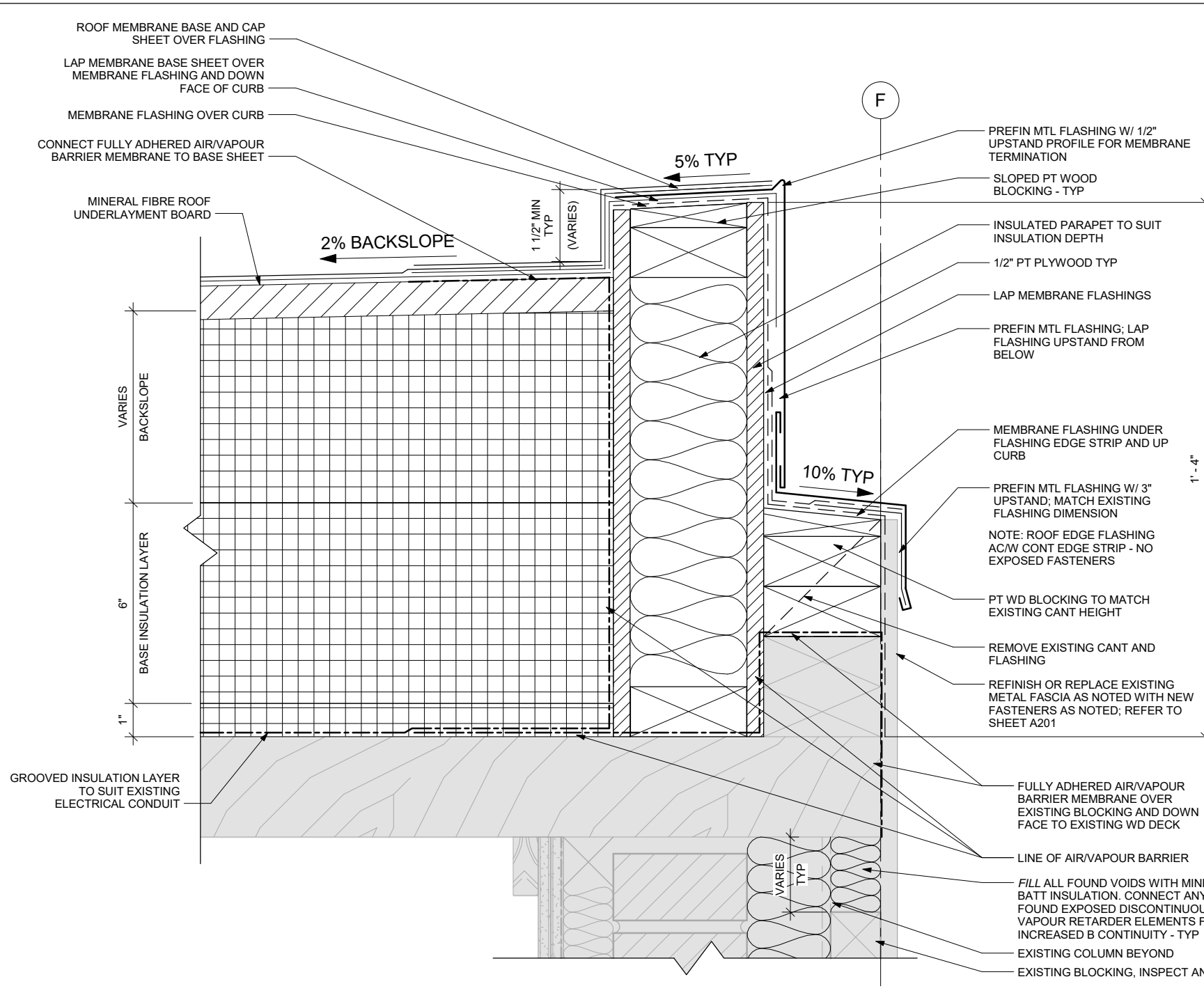

2 SECTION DETAIL - ROOF EDGE ON FLAT ROOF (LOW SIDE)
3" = 1'-0"

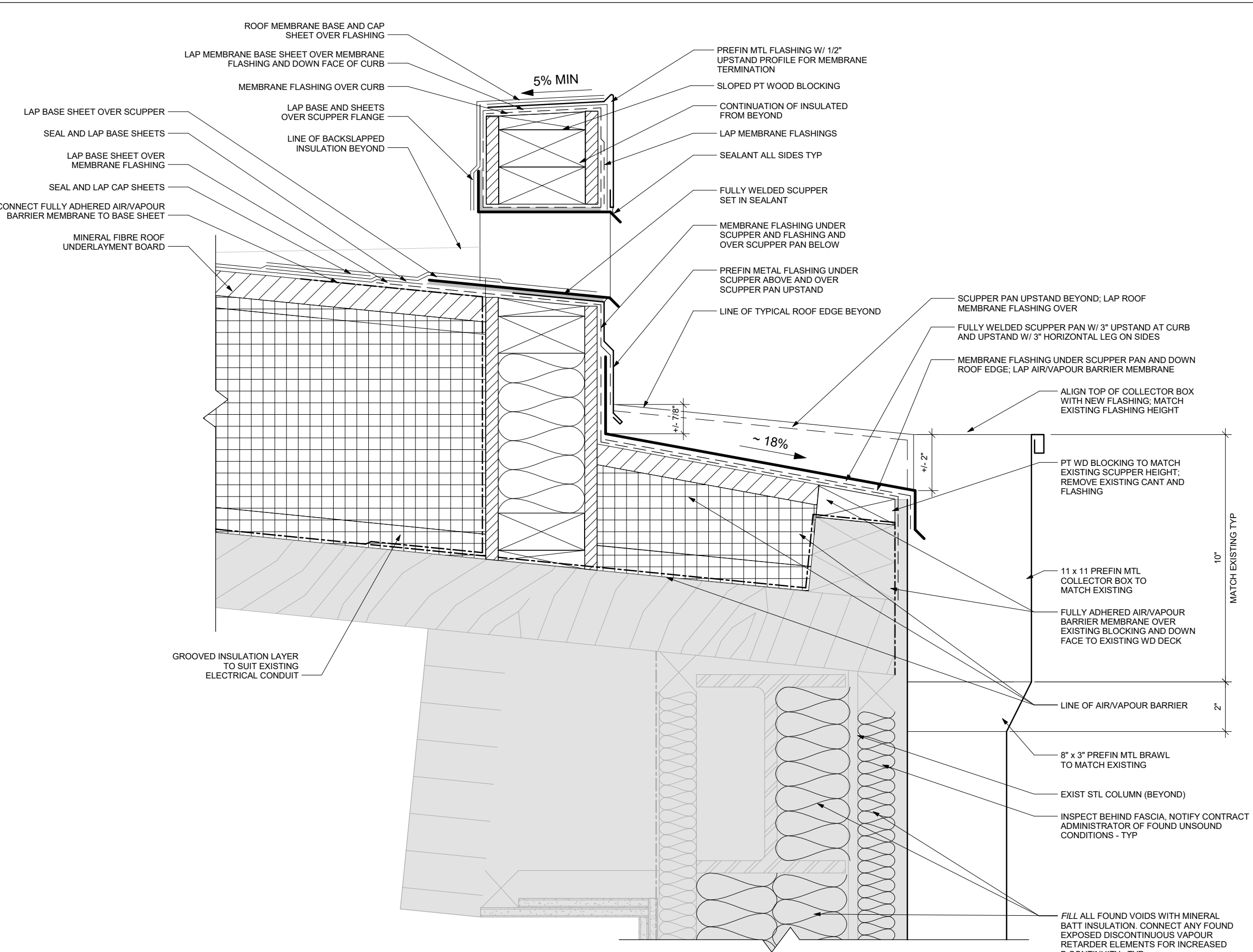

3 SECTION DETAIL - SCUPPER SLOPED ROUND ROOF
3" = 1'-0"

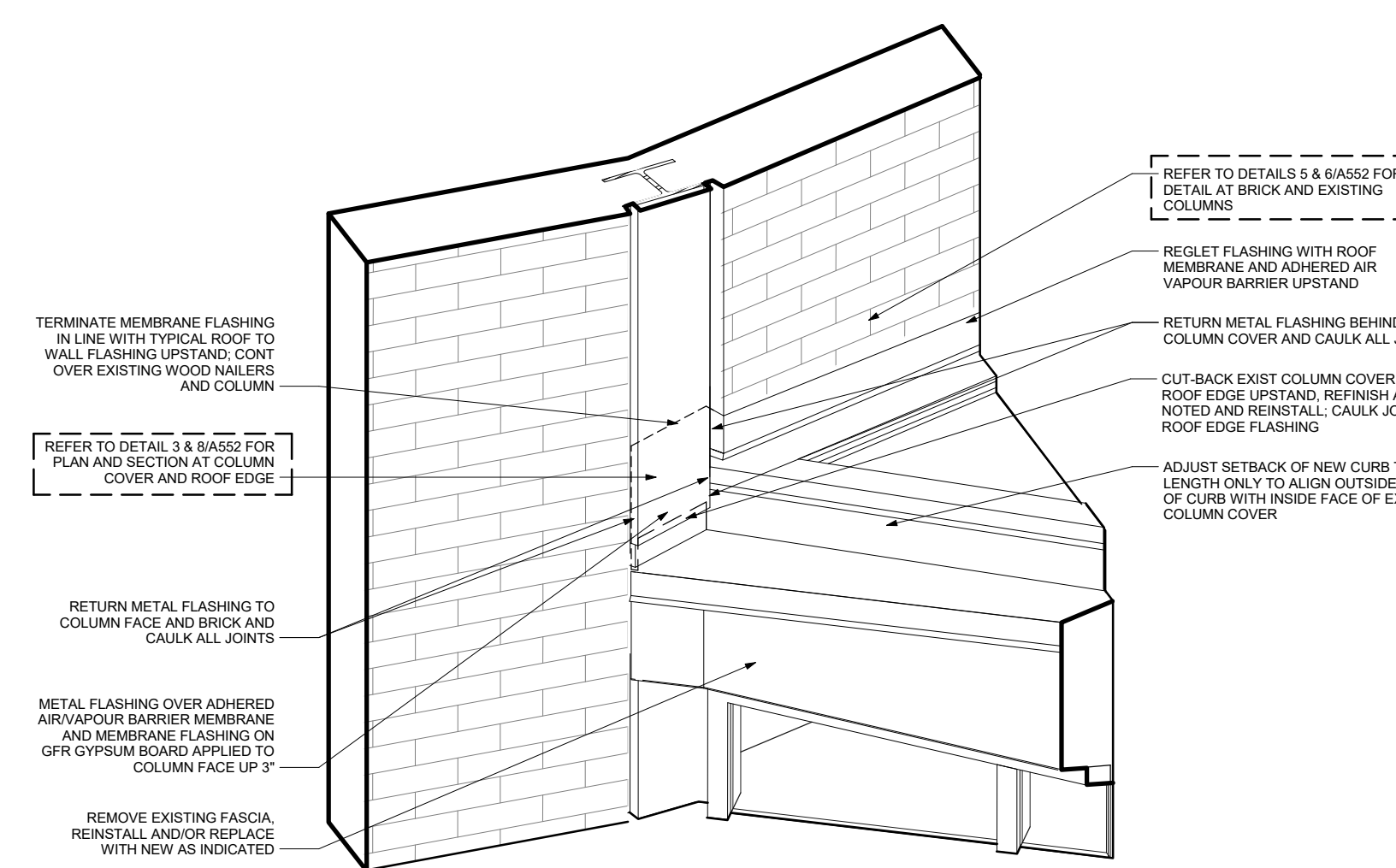

7 AXO CUT DETAIL - LOW ROOF PARAPET
3" = 1'-0"

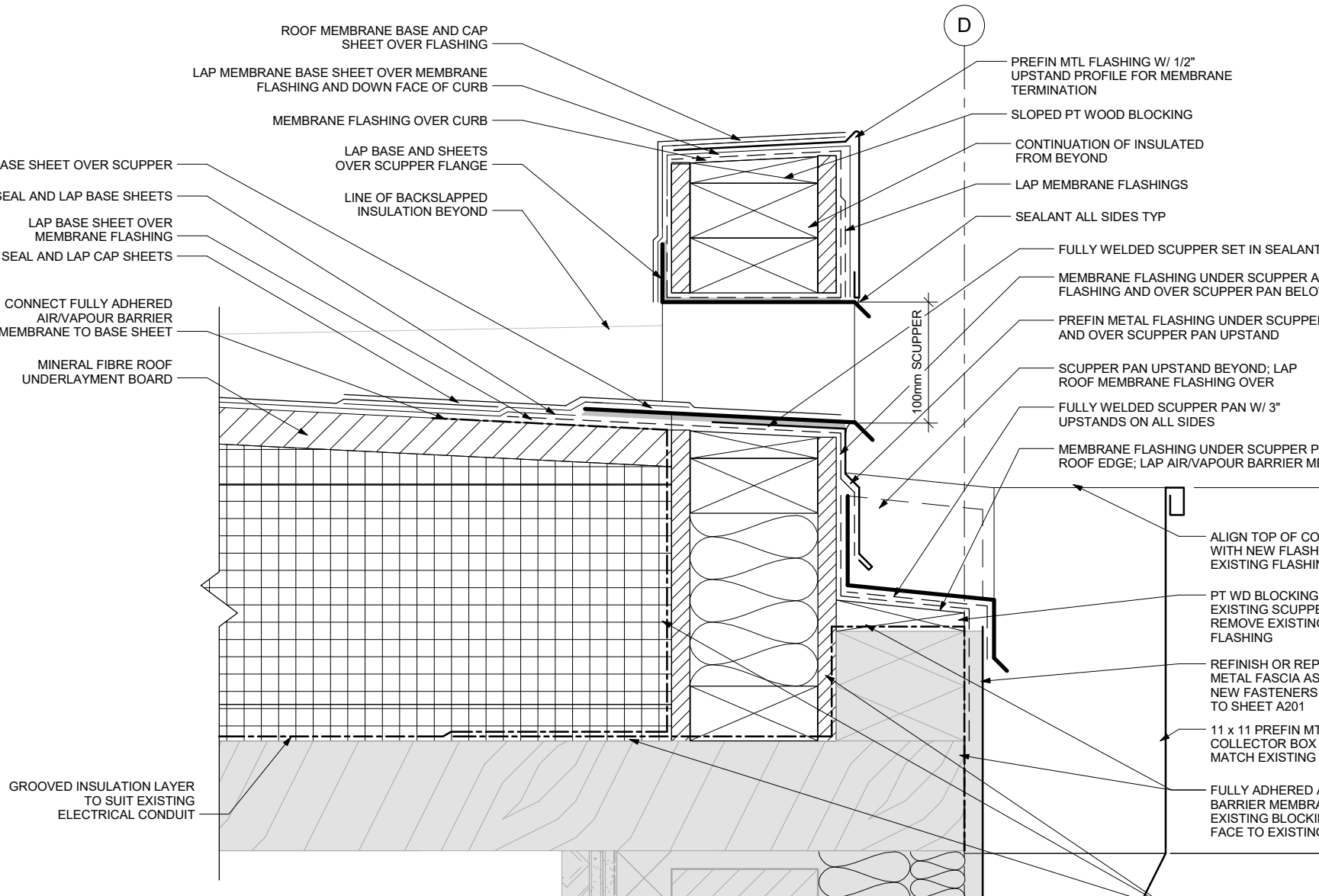

6 SECTION DETAIL - SCUPPER FLAT ROOF
3" = 1'-0"

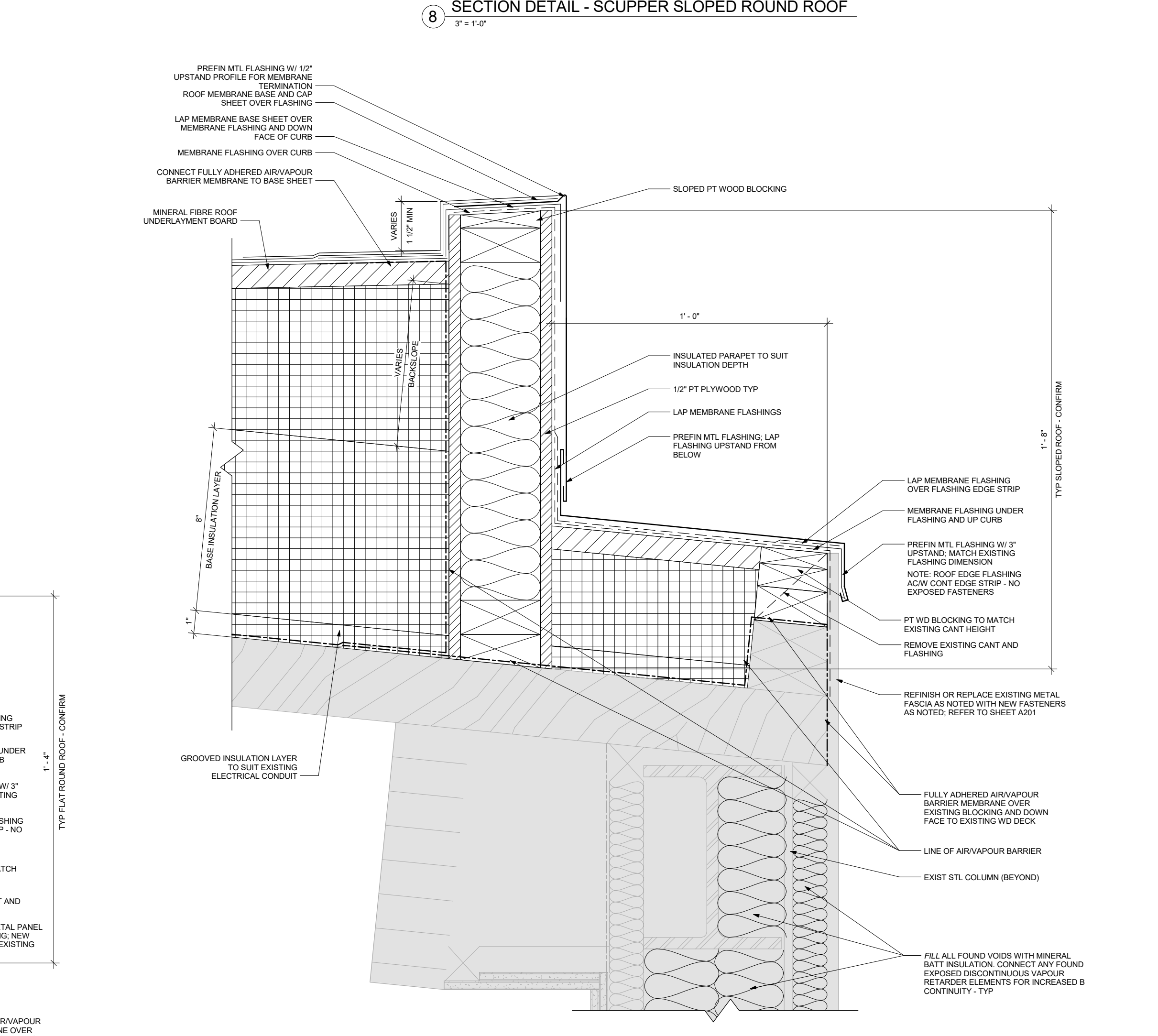

3 SECTION DETAIL - ROOF EDGE ON SLOPED ROUND ROOF
3" = 1'-0"

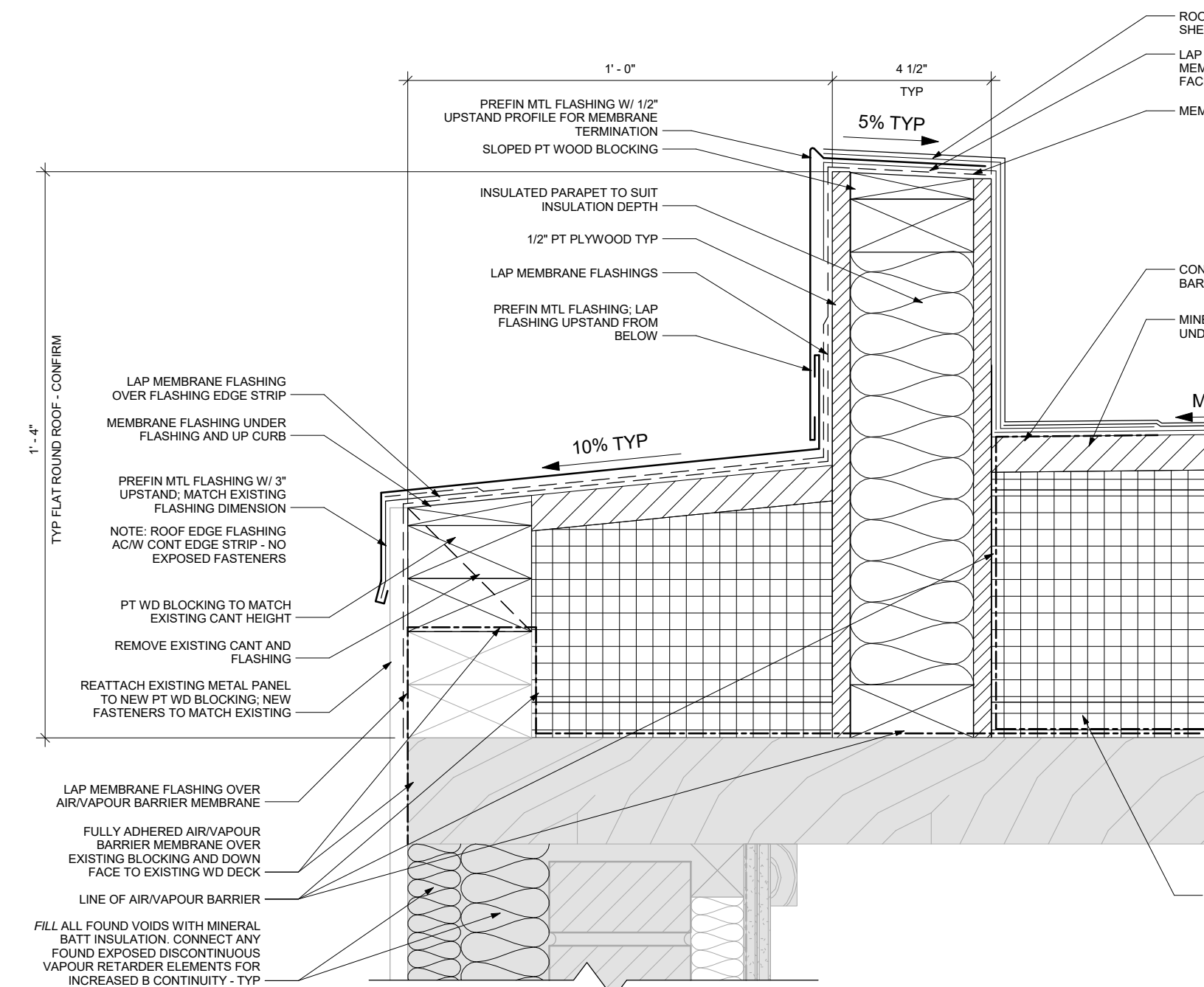

5 SECTION DETAIL - ROOF EDGE ON FLAT ROUND ROOF (LOW SIDE)
3" = 1'-0"

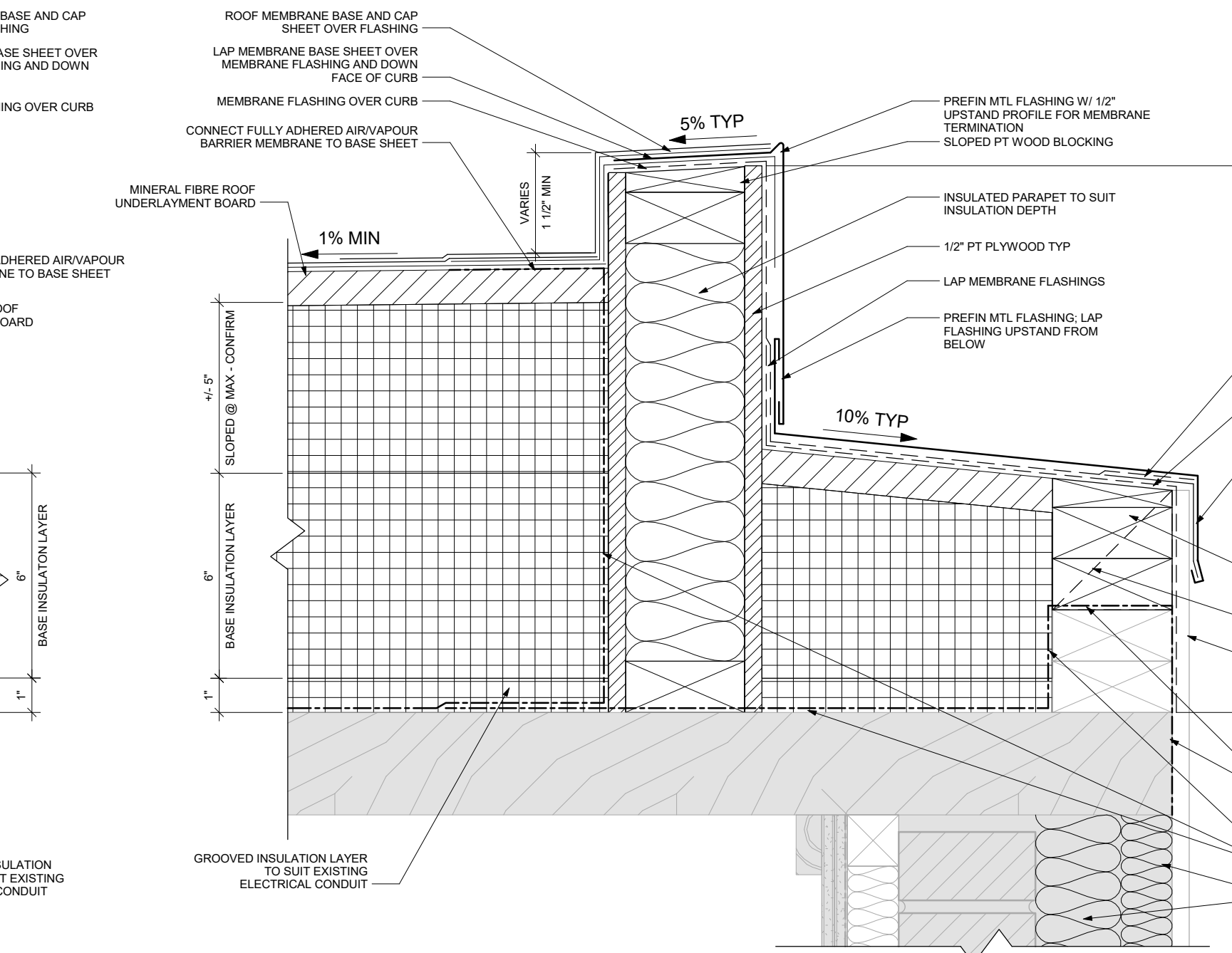

4 SECTION DETAIL - ROOF EDGE ON FLAT ROUND ROOF (HIGH SIDE)
3" = 1'-0"

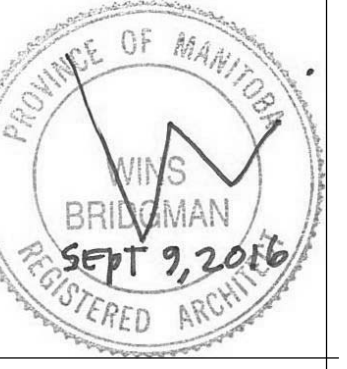

Winnipeg
THE CITY OF WINNIPEG PLANNING,
PROPERTY AND DEVELOPMENT
DEPARTMENT
MUNICIPAL ACCOMMODATIONS DIVISION
4TH FLOOR - 185 KING STREET
R3B 1J1

Project:
St. Vital Library

6 Fermor Ave. Winnipeg, MB
Project Number: 1855
Bid Opportunity Number: 788-2016

Drawing Title:
ROOF DETAILS

Issue/Revision Date
1 ISSUED FOR CONSTRUCTION SEPT 9, 2016

Sheet No: A551

This drawing is property of the Architect and cannot be reproduced or used without the consent of the Architect. The Architect is not responsible for the accuracy of the information provided and warrants that the information is true and correct. The Architect shall not be held liable for any errors or omissions in this drawing and shall not be held liable for any damages or losses resulting from the use of this drawing.