

- GENERAL NOTES:**
- LIGHT LINES INDICATE EXISTING TO REMAIN
 - DARK LINES INDICATE NEW
 - REFER TO A603 FOR ALL STAIR FINISHES
 - REFER TO A602 FOR ALL STAIR TREAD DETAILS
 - ALL NEW WOOD HANDRAILS, GUARDS AND NEWEL POSTS TO BE SOLID BIRCH. REFER TO SPEC
 - PROVIDE CONCEALED STEEL REINFORCEMENT IN WOOD ELEMENTS AS INDICATED
 - ALL NEW WOOD HANDRAILS, GUARDS AND NEWEL POSTS TO BE CLEAR SEALED. REFER TO SPEC

RECOMMENDED DETAILED SCOPE DESCRIPTION FOR THE STAIR RENOVATIONS:

THE INTENT OF THE WORK IS TO MEET THE REQUIREMENTS OF WADS AND BUILDING CODE. NEW RAILINGS ARE TO BE ATTACHED THROUGH THE EXISTING METAL SCREENS TO THE EXISTING PICKETS AND SECURED MECHANICALLY.

1. DISASSEMBLE RAILINGS WHERE INDICATED
2. INSTALL BLOCKING IN EXISTING WALLS FOR NEW RAIL AND MAKE GOOD WALLS
3. REMOVE EXISTING GUARD RAIL METAL SCREENS, FIT-UP AS INDICATED, PAINT, AND REINSTALL
4. SECURE NEW BRACKETS FOR NEW RAIL ONTO PICKETS WHERE INDICATED USING MECHANICAL FASTENERS THROUGH THE REFRESHED SCREENS.
5. INSTALL NEW NEWEL POSTS
6. INSTALL STEEL SUPPORT AND BIRCH RAILING AND MAKE CONTINUOUS

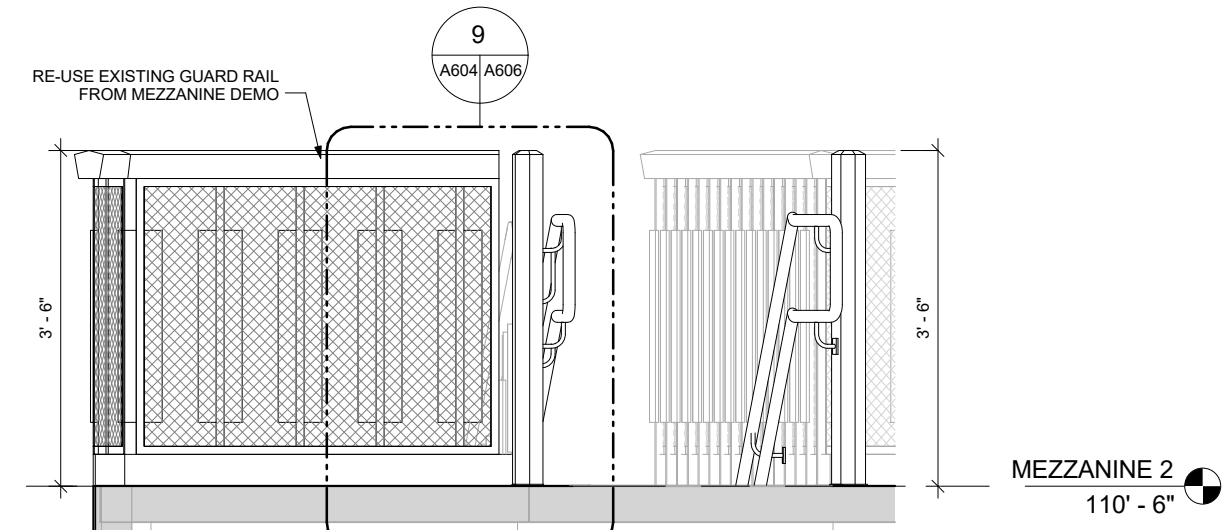

5 STAIR SECTION - STAIR 2 - i
1/2" = 1'-0"

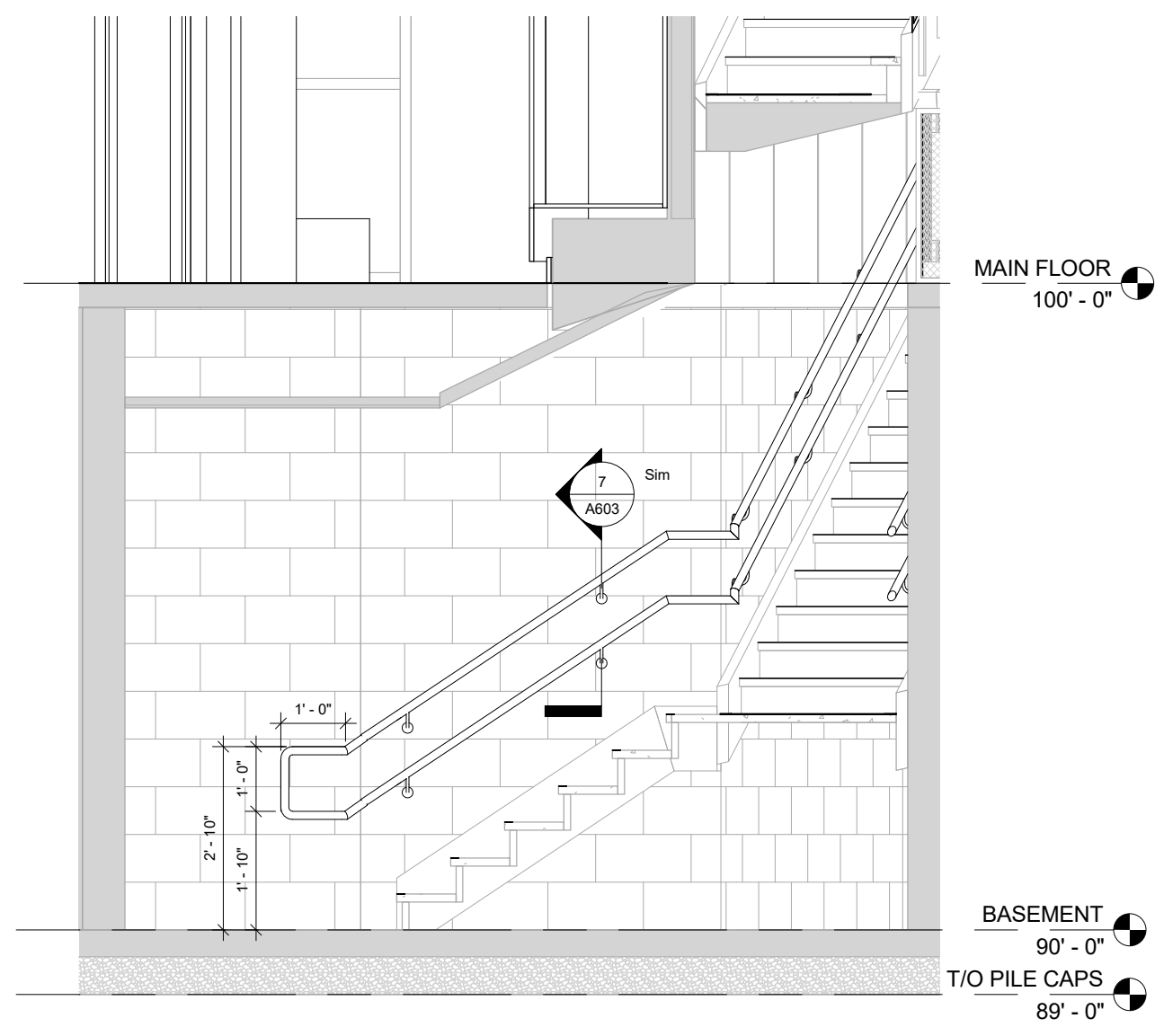

8 STAIR SECTION - STAIR 2 - e
3/8" = 1'-0"

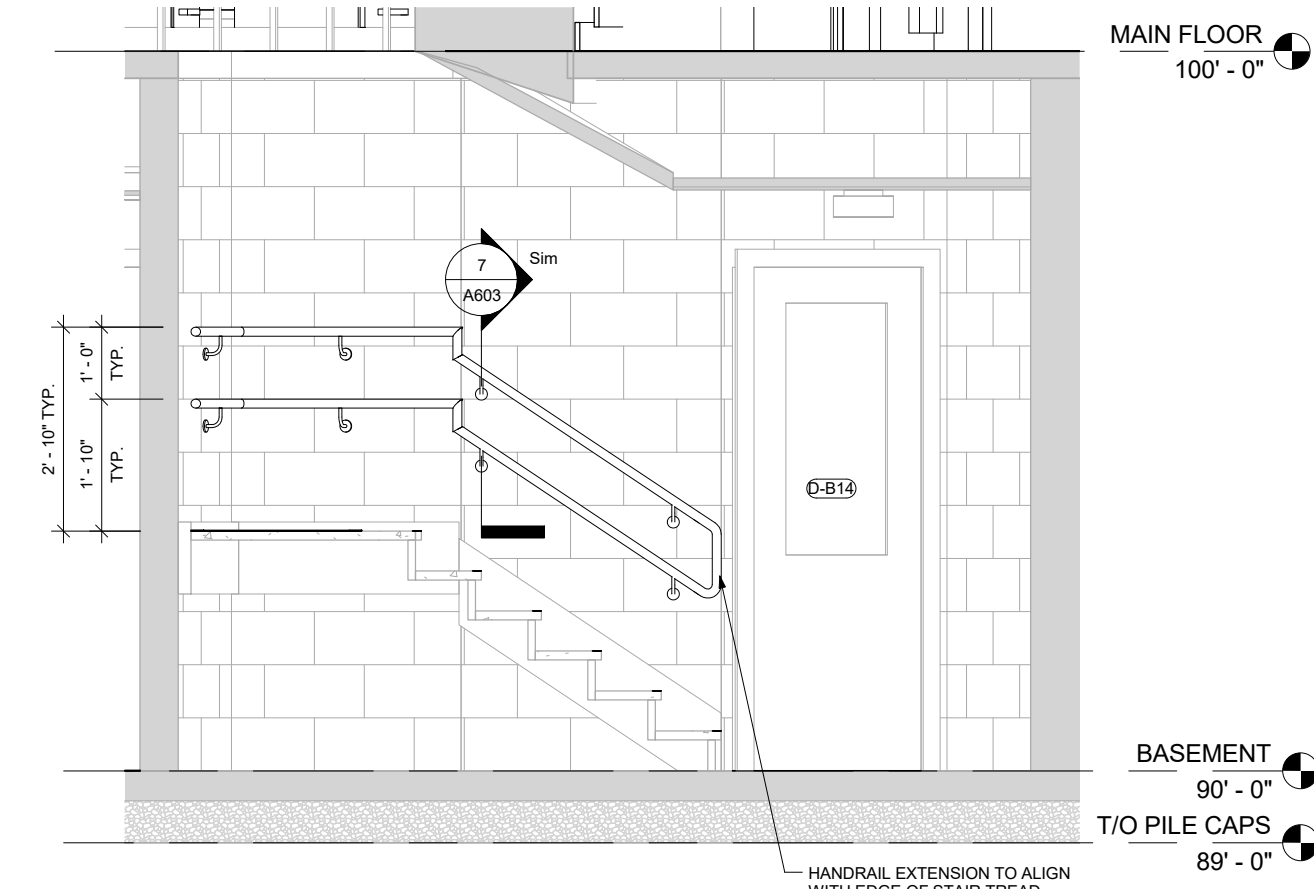

9 STAIR SECTION - STAIR 2 - f
3/8" = 1'-0"

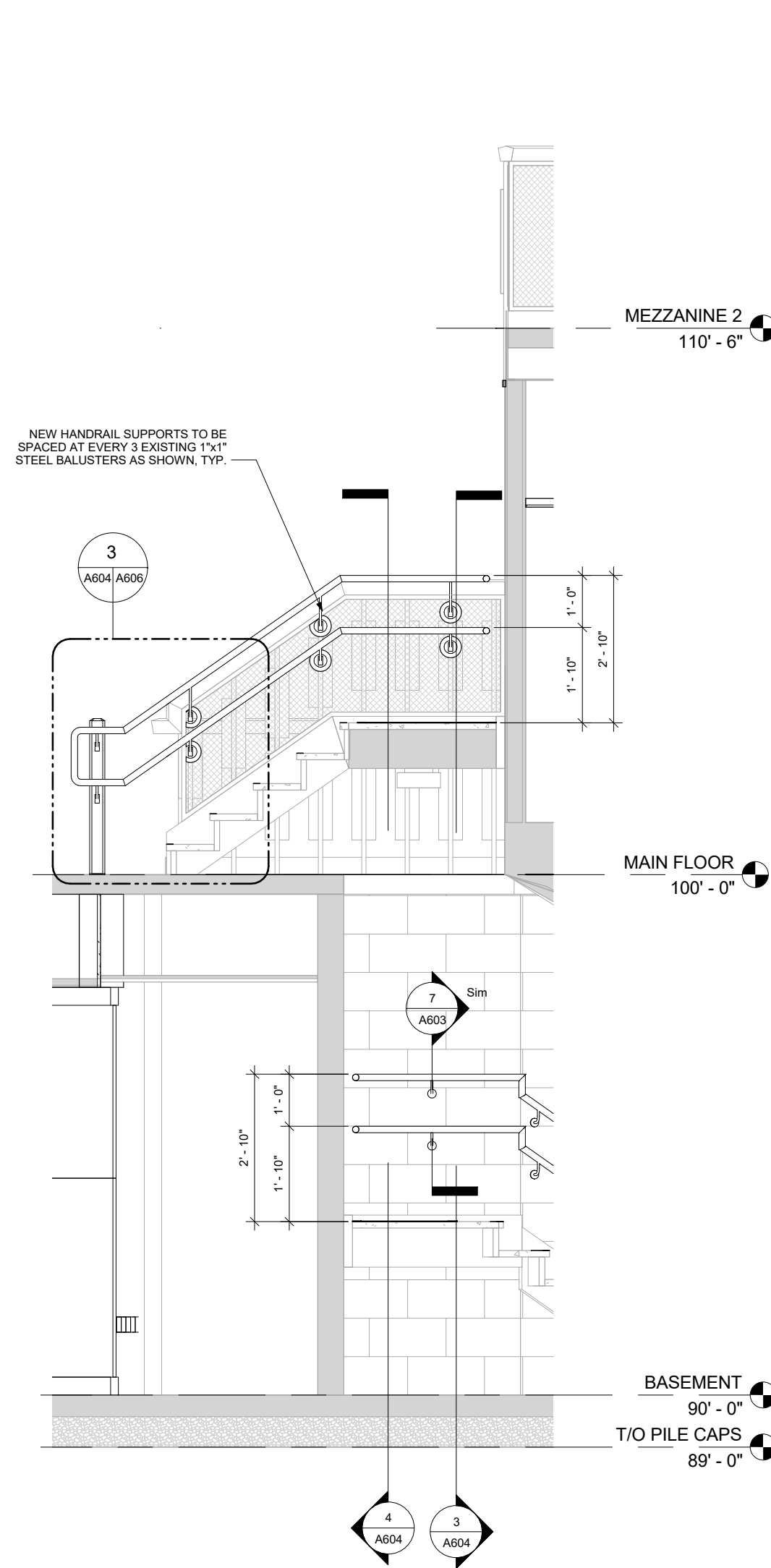

1 STAIR SECTION - STAIR 2 - a
3/8" = 1'-0"

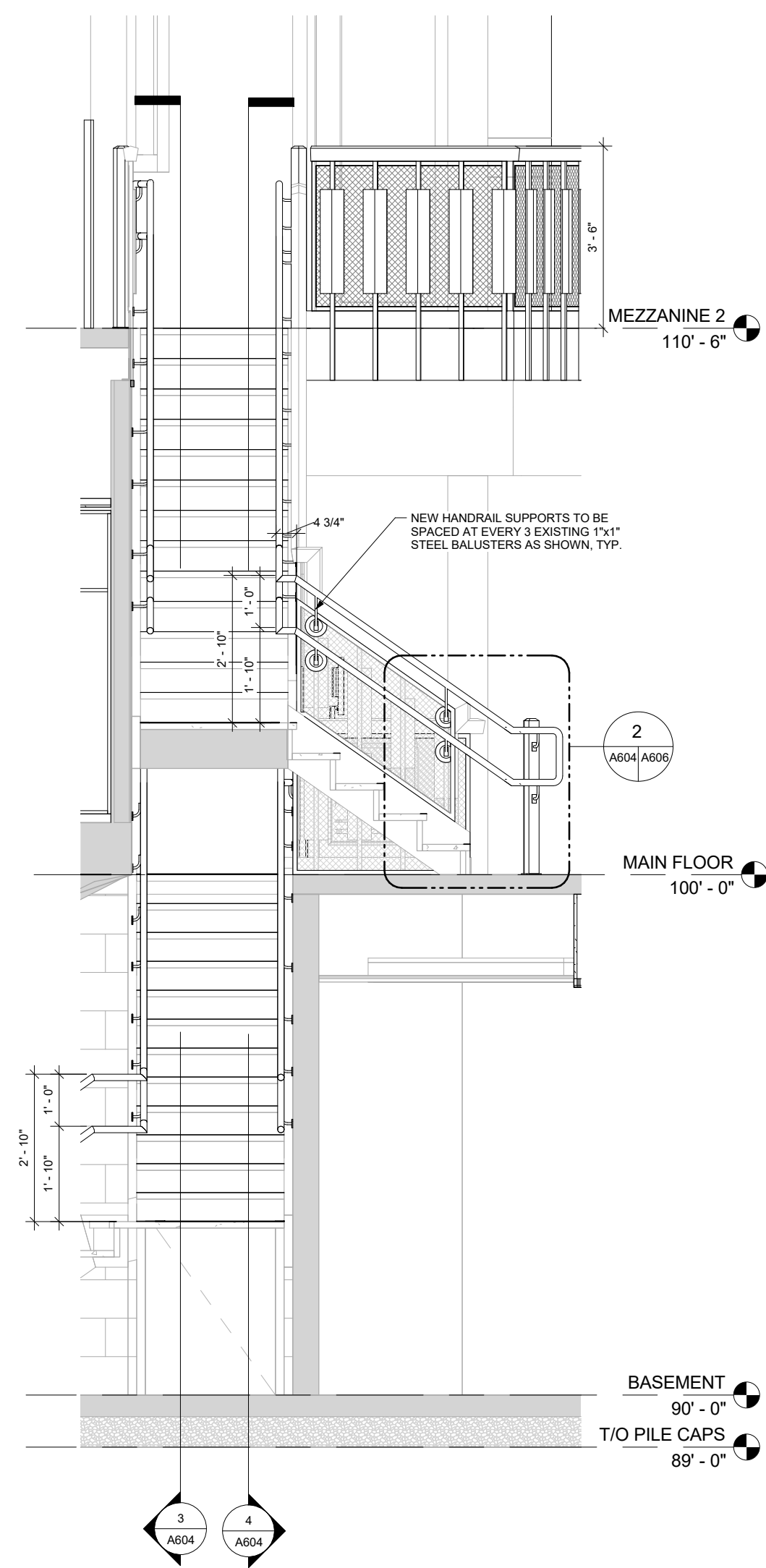

2 STAIR SECTION - STAIR 2 - b
3/8" = 1'-0"

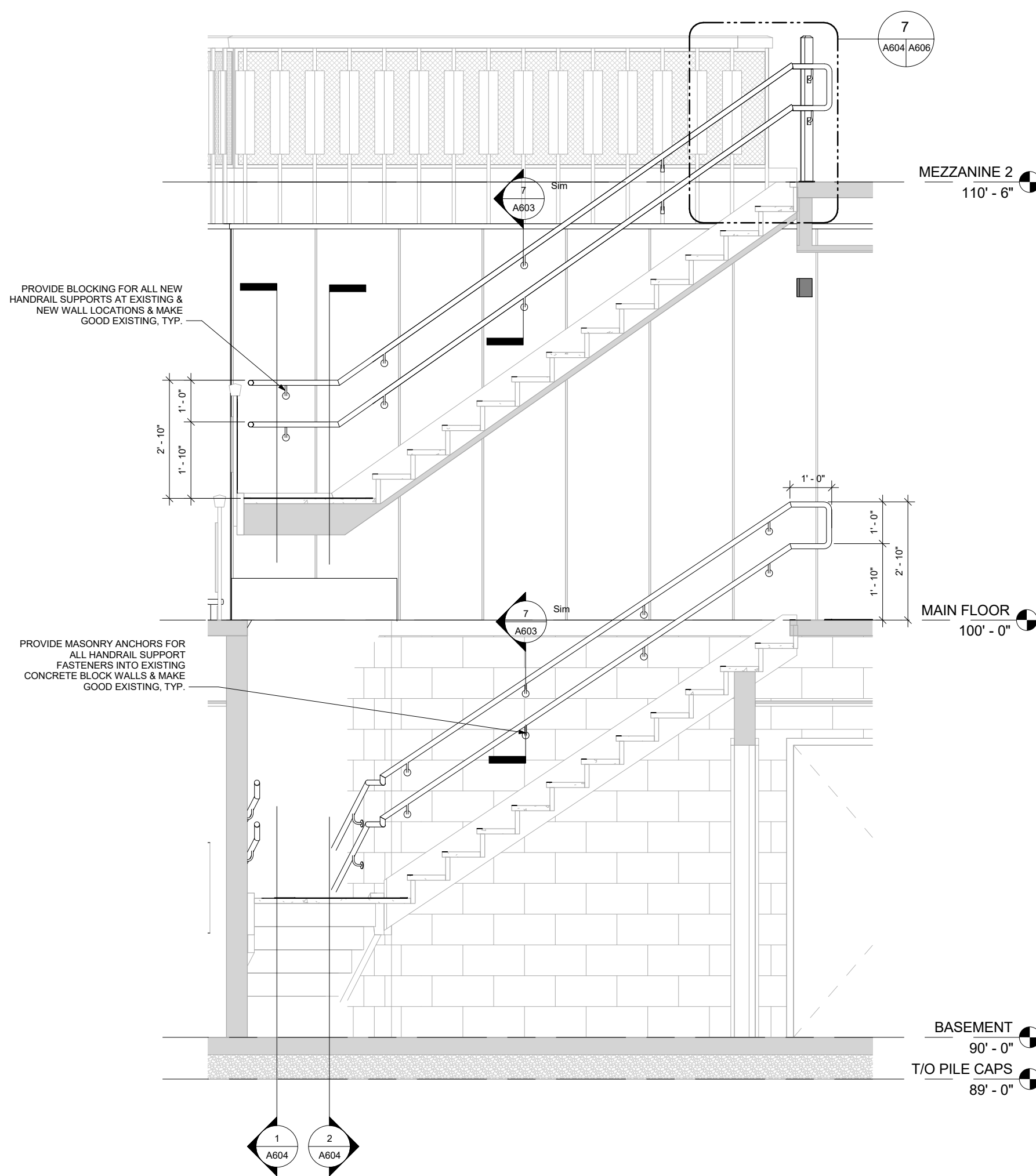

3 STAIR SECTION - STAIR 2 - c
3/8" = 1'-0"

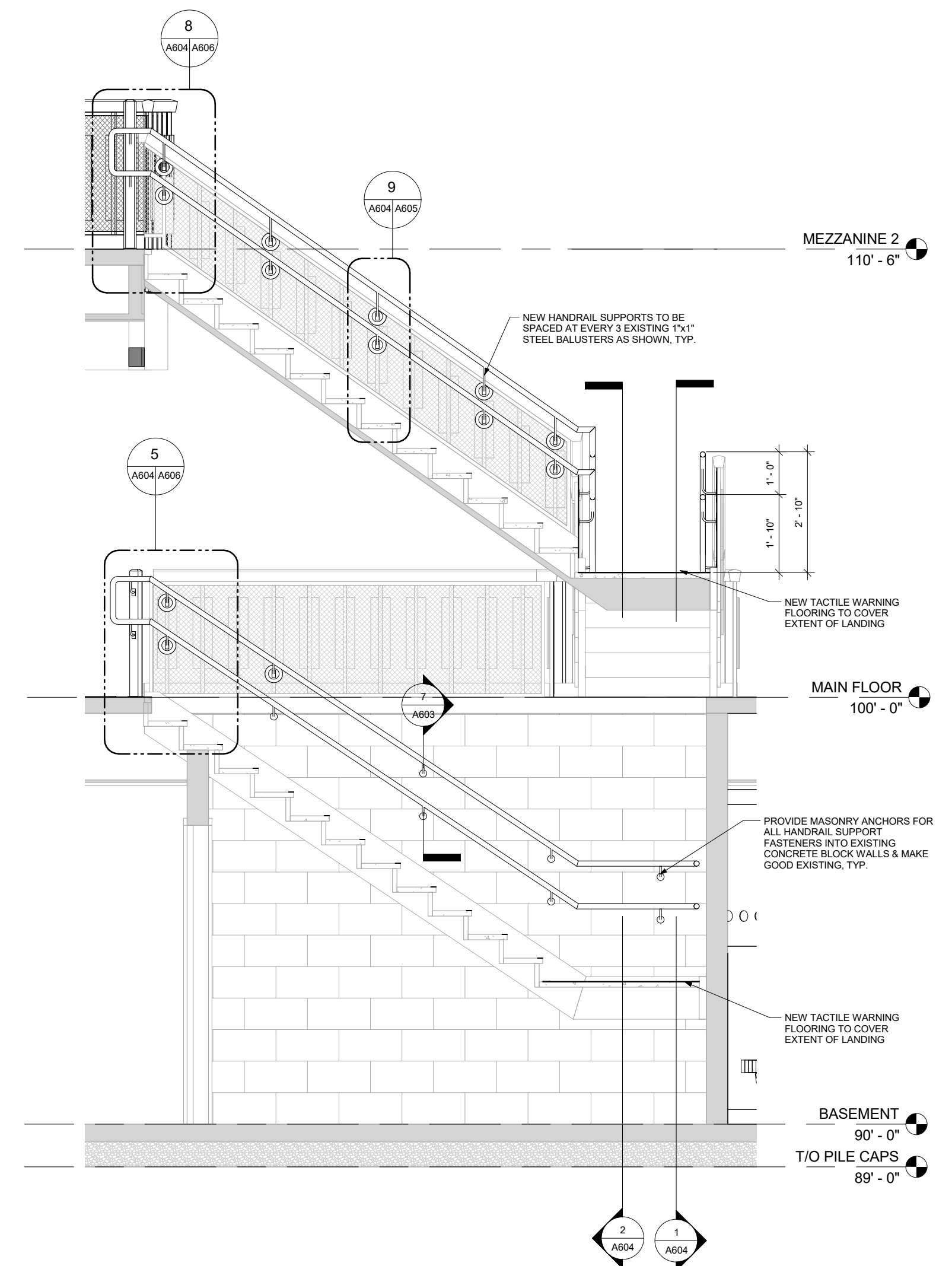

4 STAIR SECTION - STAIR 2 - d
3/8" = 1'-0"



Project:
St. Vital Library

6 Fermor Ave. Winnipeg, MB
Project Number: 1605
Bid Opportunity Number: 788-2016

Drawing Title:
STAIR SECTIONS

#	Issue/Revision	Date
1	ISSUED FOR CONSTRUCTION	SEPT 9, 2016

Sheet No: A604

This drawing is property of the Architect and cannot be reproduced or used without the consent of the Architect. The Architect is not responsible for construction and verifying all levels and dimensions and shall accept all responsibility for the Architect and obtain clarification prior to commencing work.