

PARTIAL THIRD FLOOR PLAN - MECHANICAL DEMOLITION
SCALE: 1/8"=1'-0"

THIRD FLOOR PLAN MECHANICAL DEMOLITION NOTES:

- 1 EXISTING SUPPLY AIR DIFFUSER TO BE REMOVED, CLEANED AND REINSTALLED AS PER NEW MECHANICAL RENOVATION PLAN
- 2 EXISTING SUPPLY AIR DIFFUSER TO REMAIN
- 3 EXISTING SUPPLY DUCT TO REMAIN
- 4 EXISTING EXHAUST DUCT TO REMAIN
- 5 EXISTING EXHAUST FAN TO REMAIN
- 6 EXISTING UPRIGHT SPRINKLER HEAD TO BE RELOCATED TO SUIT NEW CEILING PLAN AS PER MECHANICAL RENOVATION PLAN
- 7 EXISTING SPRINKLER LINE/MAIN TO REMAIN
- 8 EXISTING UPRIGHT SPRINKLER HEAD TO REMAIN

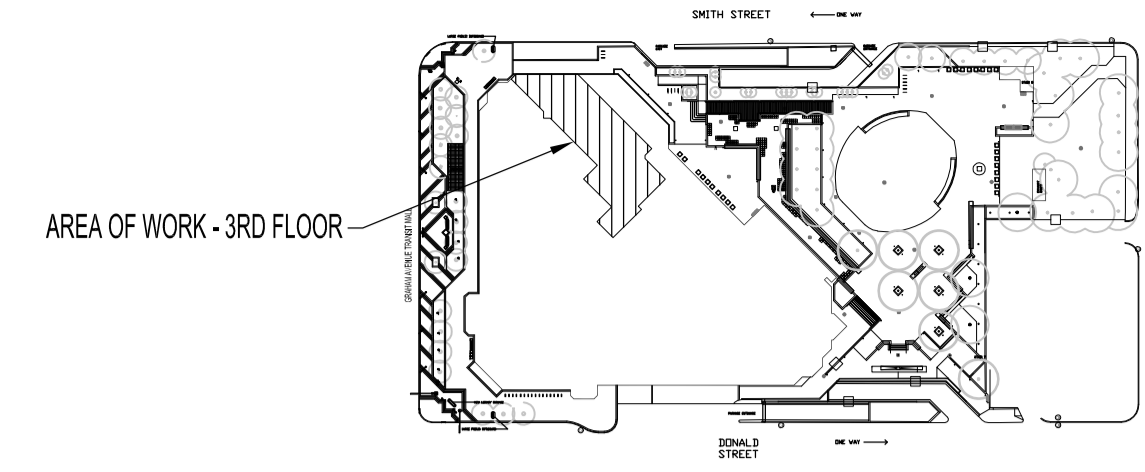

KEY PLAN
SCALE: N.T.S.

MECHANICAL SYMBOLS	
	EXISTING CONSTRUCTION TO REMAIN
	TO BE DEMOLISHED
	NEW CONSTRUCTION
	NEW BALANCE DAMPER
	EXISTING SUPPLY AIR GRILLE TO BE REMOVED
	EXISTING RETURN AIR GRILLE TO BE REMOVED
	NEW SUPPLY AIR GRILLE
	NEW RETURN AIR GRILLE
	NEW FLEX DUCT THERMOFLEX, MODEL M-KE
	GRILLE TYPE (SEE GRILLE SCHEDULE) SIZE CFM / R/A
	EQUIPMENT DESIGNATION
	NEW WET SPRINKLER PIPING
	EXISTING UPRIGHT SPRINKLER HEAD
	NEW UPRIGHT SPRINKLER HEAD
	NEW PENDENT SPRINKLER HEAD
	RELOCATED UPRIGHT SPRINKLER HEAD
	EXISTING THERMOSTAT TO REMAIN
	EXISTING SPEAKER TO REMAIN
	EXISTING FIRE HORN/STROBE TO REMAIN
	EXISTING FIRE PULL STATION TO REMAIN
	EXISTING FIRE EXTINGUISHER TO REMAIN
	EXISTING EXIT SIGN TO REMAIN

NOTES:

THESE DRAWINGS SHALL NOT BE SCALED.

THE CONTRACTOR SHALL VISIT THE SITE AND SATISFY ONESELF ALL DIMENSIONS, DATUM, AND DETAILED INFORMATION SHOWN ARE CORRECT.

THE CONTRACTOR IS TO REVIEW AND COORDINATE ALL ARCHITECTURAL, MECHANICAL, ELECTRICAL AND STRUCTURAL DRAWINGS FOR ADDITIONAL OPENINGS THROUGH FLOORS, WALLS, AND CEILINGS FOR DUCT, PIPE & ELECTRICAL RISERS AND ALL OPENINGS NOT SHOWN ON DRAWINGS.

ALL OPENINGS THROUGH FIRE ASSEMBLIES ARE TO BE FIRE STOPPED AND SEALED WITH ULC APPROVED FIRE STOPPING TO MAINTAIN THE INTEGRITY OF THE FIRE SEPARATION, AND PROVIDE A SMOKE-TIGHT BARRIER.

ALL PRODUCTS AND MATERIALS TO BE USED AND INSTALLED SHALL CONFORM WITH MANUFACTURER'S SPECIFICATIONS & APPLICABLE CODES.

THE CONTRACTOR SHALL BE RESPONSIBLE TO PATCH AND MAKE GOOD ALL EXISTING CONSTRUCTION AFFECTED BY THE REMOVAL OF ALL ITEMS FORMING THE PART OF THE RENOVATION WORK.

THE CONTRACTOR IS RESPONSIBLE FOR INSTALLING RISERS, SWING JOINTS AND DEEP CUP ESCUTCHEONS AS REQUIRED.

COMPLETE ALL WORK IN CONFORMANCE WITH THE REQUIREMENTS OF NFPA 13-2013 "STANDARD FOR THE INSTALLATION OF SPRINKLER SYSTEMS".

ELECTRICAL WIRING SHALL BE PERFORMED BY A QUALIFIED ELECTRICAL SUBCONTRACTOR.

NEW DUCT SHALL BE CONSTRUCTED AS RECOMMENDED BY SMACNA.

AIR SYSTEM SHALL BE BALANCED AND TESTED BY AN INDEPENDENT AIR BALANCE AGENCY TO PROVIDE AIR QUANTITY AS SHOWN. PROVIDE AIR BALANCE REPORT FOR REVIEW BY CONTRACT ADMINISTRATOR.

No.	REVISION/DESCRIPTION	BY	DATE
1	ISSUED FOR CONSTRUCTION	MMK	AUG 1 2016
0	PRELIMINARY DRAWING ISSUED	JAW	MAY 31 2016

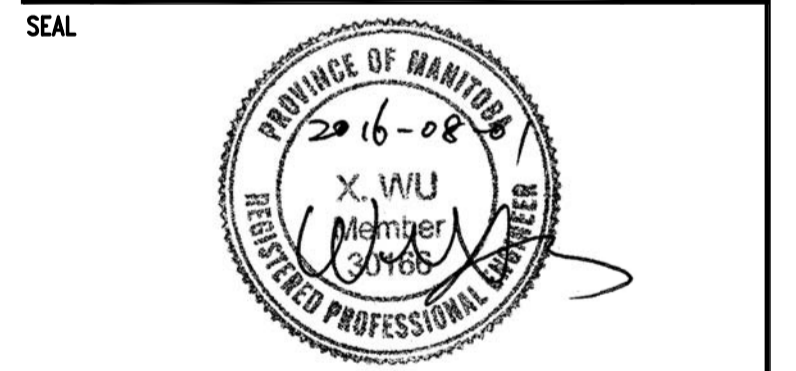

DRAWN	CHECKED	DESIGNED	APPROVED
JAW	XYW	XYW	XYW
DATE: 2016.05.31	USER APPROVAL		

THE CITY OF WINNIPEG
PLANNING, PROPERTY AND
DEVELOPMENT DEPARTMENT
MUNICIPAL ACCOMMODATIONS DIVISION
3-65 GARRY STREET, R3C 4K4

PROJECT
MILLENNIUM LIBRARY
DEVELOPMENT OF THIRD FLOOR
IDEA MILL
251 DONALD STREET

SHEET TITLE
PARTIAL THIRD FLOOR PLAN
MECHANICAL DEMOLITION