

**LAB ROOF FRAMING PLAN  
FOR AHU M639**  
1:100  
SEE S-03

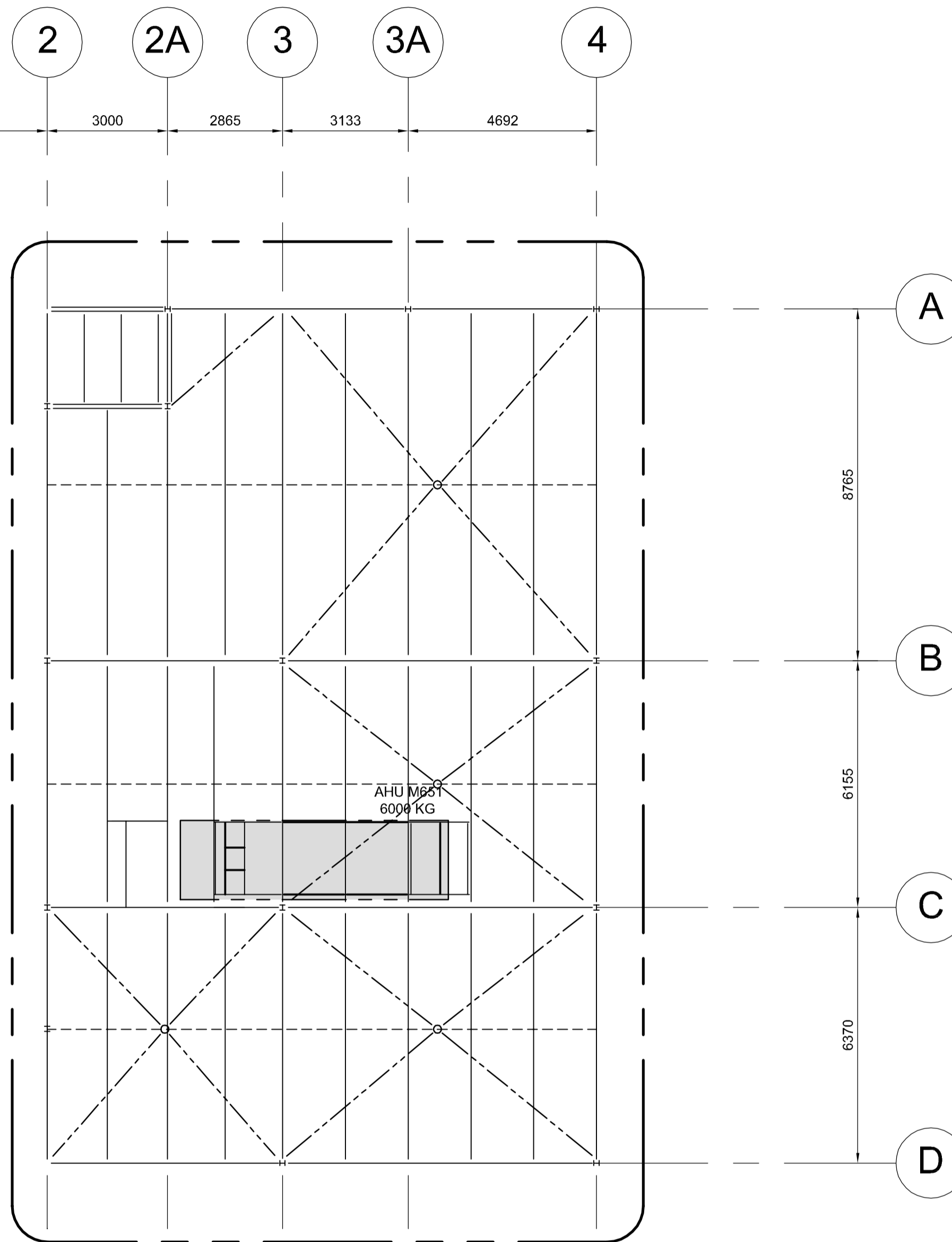

**HIGH ROOF FRAMING PLAN  
FOR AHU M651**  
1:100  
SEE S-02

**GENERAL**

1. THE CONTRACTOR SHALL CHECK AND VERIFY ALL EXISTING INFORMATION AND DIMENSIONS PRIOR TO COMMENCING WORK.
2. TEMPORARY SUPPORT AND BRACING FOR CONSTRUCTION IS THE RESPONSIBILITY OF THE CONTRACTOR.
3. THE CONTRACTOR SHALL VERIFY EXISTING UTILITIES & FRAMINGS AND REASSURE THAT THE WORK DOES NOT INTERFERE WITH THE EXISTING UTILITIES & FRAMINGS.
4. THE CONTRACTOR SHALL BE RESPONSIBLE FOR SAFEGUARDING AND PROTECTION OF THE EXISTING FACILITIES AND UTILITIES WHICH MAY BE AFFECTED BY THE WORK OF THIS CONTRACT.
5. ALL WORK SHALL CONFORM TO THE NATIONAL BUILDING CODE OF CANADA (2015) AND TO THE RELATED RECENT PROVINCIAL BUILDING CODE.
6. ALL WORK SHALL CONFORM TO THE RELATED CSA REQUIREMENTS.
7. DO NOT CONSTRUCT FROM THESE DRAWINGS UNLESS MARKED "ISSUED FOR CONSTRUCTION".
8. DO NOT SCALE FROM THE DRAWINGS.

**DESIGN SNOW LOADS**

Ss 1.9 kPa  
Sr 0.2 kPa

IMPORTANT FACTORS = 1

**STRUCTURAL STEEL**

1. STRUCTURAL STEEL WORK SHALL CONFORM TO CSA A16-14.
2. ALL FABRICATION, ERECTION, AND WELDING SHALL BE IN ACCORDANCE WITH THE LATEST CODES AND STANDARDS.
3. ALL STRUCTURAL STEEL SHAPES SHALL CONFORM TO CSA G40.21-13 GRADE 350W.
4. ALL STRUCTURAL STEEL PLATES SHALL CONFORM TO CSA G40.21-13 GRADE 300W.
5. CONNECTION DETAILS NOT SHOWN ON DRAWINGS SHALL BE DESIGNED UNDER THE SUPERVISION OF AND STAMPED BY A PROFESSIONAL ENGINEER LICENSED IN THE PROVINCE OF MANITOBA.
6. UNLESS NOTED OTHERWISE, DESIGN ALL CONNECTIONS FOR NON-COMPOSITE BEAMS FOR 50% OF THE SHEAR RESISTANCE OF THE BEAM AND USE A MINIMUM OF 3-19 MM DIA BOLTS IN EACH BOLTED CONNECTION.
7. ALL STRUCTURAL STEEL AND CONNECTIONS, INCLUDING ANCHOR BOLTS EXPOSED TO ENVIRONMENT TO BE GALVANIZED.
8. THE CONTRACTOR SHALL PREPARE AND SUBMIT ALL SHOP DRAWINGS FOR ENGINEER OF RECORD TO REVIEW PRIOR TO FABRICATION.
9. WELDING TO CONFORM TO THE REQUIREMENTS OF CSA W59.
10. SEAL ALL HSS WITH SUITABLE CAP PLATES.
11. DO NOT PLACE HOLES OR OPENINGS IN STRUCTURAL STEEL MEMBERS WITHOUT THE APPROVAL OF THE ENGINEER OF RECORD.
12. REMOVE ALL EXISTING COATING PRIOR TO WELDING.
13. GRIND ALL WELDS SMOOTH.
14. APPLY PRIME PAINTING TO ALL FIELD REPAIRS.
15. APPLY TWO COATS OF CAN/CGSB-1.132-M90 TO ALL STEEL EXPOSED TO THE EXTERIOR UNLESS OTHERWISE SPECIFIED.
16. THE CONTRACTOR SHALL ARRANGE FOR MATERIALS AND WORKMANSHIP TESTING BY AN INDEPENDENT INSPECTION FIRM.

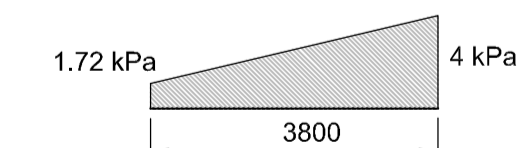

TYPICAL SNOW PILE UP AROUND AHU



B.M. ELEV.	DESIGNED BY	NR
	DRAWN BY	DJB
	CHECKED BY	-
	APPROVED BY	-
	HOR. SCALE	VERTICAL
0	Issued for Tender	16/10/27 NR
NO.	REVISIONS	DATE BY DATE

**DILLON CONSULTING**

RELEASED FOR CONSTRUCTION

ENGINEER'S SEAL

PROVINCE OF MANITOBA

PATTANWANGCHAREN

Member 23609

REGISTERED PROFESSIONAL ENGINEER

CONSULTANT PROJECT NO. 163526

**THE CITY OF WINNIPEG**  
WATER AND WASTE DEPARTMENT

NORTH END SEWAGE TREATMENT PLANT  
NEWPCC MAIN BUILDING - HVAC REPLACEMENT

ROOF FRAMING PLANS  
AND TYPICAL NOTES

CITY DRAWING NUMBER 1-0101M-S0019-001  
SHEET 2 OF 21

S-01