

WARNING
 IF POWER EQUIPMENT OR EXPLOSIVES ARE TO BE USED FOR EXCAVATION ON THIS PROJECT THE CONTRACTOR MUST:
 1) NOTIFY THE GAS COMPANY OF THE PROPOSED LOCATION OF EXCAVATION.
 2) TAKE PRECAUTION TO AVOID DAMAGE TO GAS COMPANY INSTALLATIONS.
 SEE PROVINCIAL REGULATION 210/72 FOR DETAILS

PROPERTY LIMITS DELINEATION
 DELINEATION OF PROPERTY LIMITS AS SHOWN ON THIS DWG DOES NOT REPRESENT A "LEGAL SURVEY". CH2M HILL MAKES NO REPRESENTATION OR WARRANTY AS TO THE ACCURACY OF PROPERTY LIMITS DELINEATED ON THIS DRAWING, NOR ON THE DIMENSIONAL ACCURACY OF DRAWING FEATURES RELATIVE TO THOSE PROPERTY LIMITS.

- CONSTRUCTION NOTES:**
- SEWER AND WATER SERVICES SHOWN ON DRAWING ARE APPROXIMATE ONLY.
 - LOCATION OF ALL SEWER AND WATER LINES TO BE CONFIRMED IN FIELD.
 - INSTALL NEW SEWER BY TRENCHLESS METHODS, UNLESS OTHERWISE NOTED.
 - MAINTAIN TRUCK ACCESS TO REAR OF WAL-MART FROM SPARLING AVENUE AT ALL TIMES.
 - INSTALL AND MAINTAIN TEMPORARY CONSTRUCTION FENCING AROUND SITE IN ALL PUBLIC LOCATIONS.

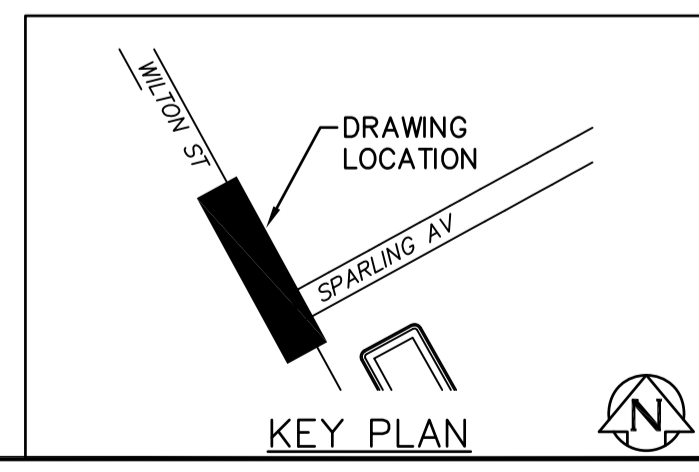
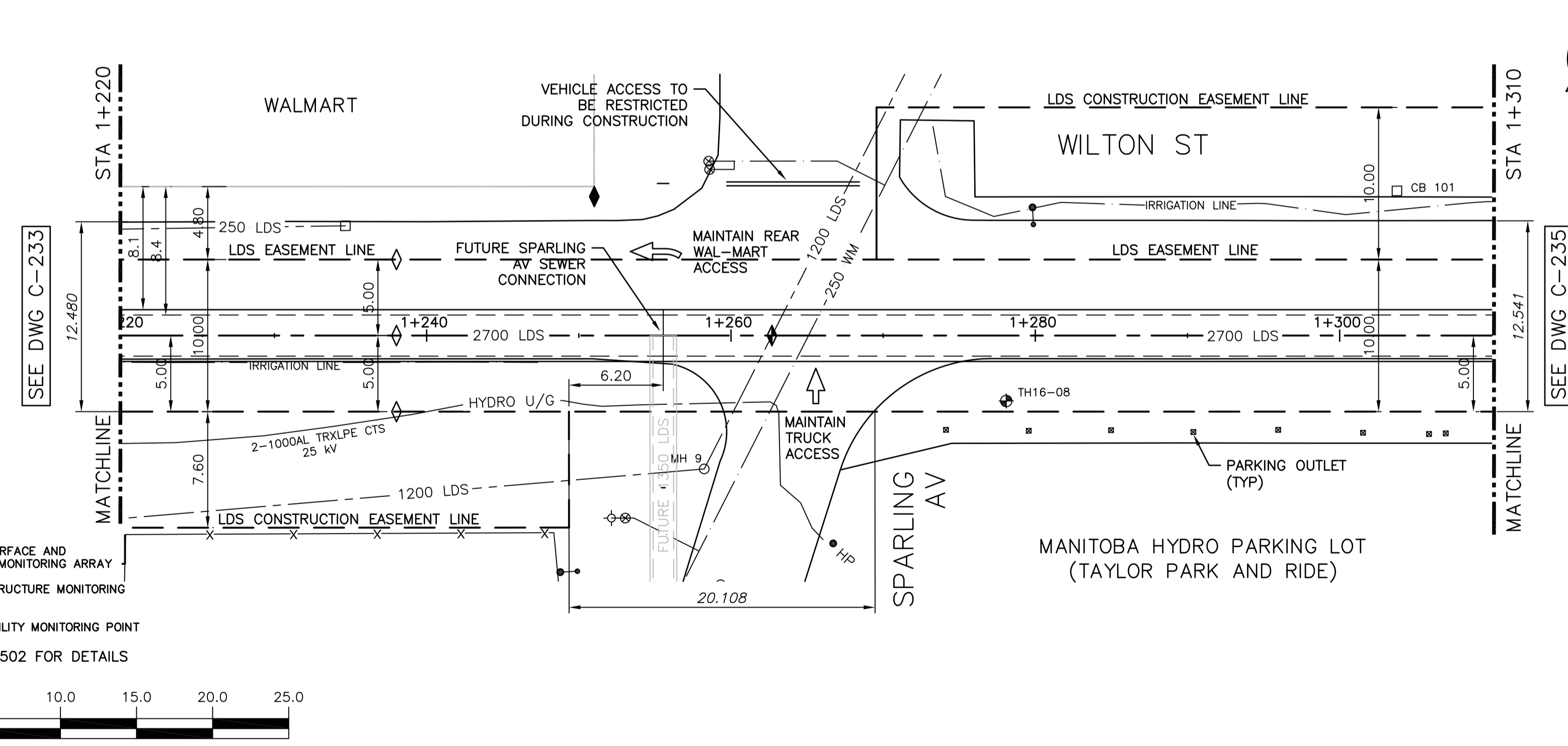

File name C:\pwworkdir\ch2mhill_wbg\cortez\0204776\

EXISTING	LEGEND-PLAN	PROPOSED	EXISTING	LEGEND-PLAN	PROPOSED	EXISTING	LEGEND-PROFILE	PROPOSED
150 WM	WATER MAIN	150 WM	HYDRO	M.T.S.	150 WM	WATER MAIN	150 WM	HYDRANT, VALVE
300 LDS	LAND DRAINAGE SEWER	300 LDS	CONCRETE	ASPHALT	300 LDS	LAND DRAINAGE SEWER	300 LDS	LAND DRAINAGE SEWER
250 WWS	WASTE WATER SEWER	250 WWS	SIDEWALK	PLANNING	250 WWS	WASTE WATER SEWER	250 WWS	WASTE WATER SEWER
MANHOLE	MANHOLE	MANHOLE	PROPERTY LINE	SURVEY BAR	MANHOLE	NORTH/WEST GUTTER	MANHOLE	NORTH/WEST GUTTER
CATCH BASIN	CATCH BASIN	CATCH BASIN	GAS	CURB STOP	CATCH BASIN	SOUTH/EAST GUTTER	CATCH BASIN	SOUTH/EAST GUTTER
CURB INLET	CURB INLET	CURB INLET	TEE	TEE	CURB INLET		CURB INLET	
BEND	BEND	BEND			BEND		BEND	
REDUCER	REDUCER	REDUCER			REDUCER		REDUCER	

LOCATION APPROVED UNDERGROUND STRUCTURES

SUPV. U/G STRUCTURES COMMITTEE DATE

NOTE:
 LOCATION OF UNDERGROUND STRUCTURES AS SHOWN ARE BASED ON THE BEST INFORMATION AVAILABLE BUT NO GUARANTEE IS GIVEN THAT ALL EXISTING UTILITIES ARE SHOWN OR THAT THE GIVEN LOCATIONS ARE EXACT. CONFIRMATION OF EXISTENCE AND EXACT LOCATION OF ALL SERVICES MUST BE OBTAINED FROM THE INDIVIDUAL UTILITIES BEFORE PROCEEDING WITH CONSTRUCTION.

NO.	REVISIONS	DATE	BY
D	ISSUED FOR RFQ 908-2016	11/2016	JBC
C	ISSUED FOR 95% REVIEW	09/2016	JBC
B	ISSUED FOR REVIEW	05/2016	JBC
A	ISSUED FOR REVIEW	05/2016	JBC

KGS GROUP CONSULTING ENGINEERS

ch2m

DESIGNED BY: SDG
 CHECKED BY: MD
 DRAWN BY: JBC
 APPROVED BY:
 HOR. SCALE: 1:250
 VERTICAL: 1:50
 RELEASED FOR CONSTRUCTION: DATE

ENGINEER'S SEAL

PRELIMINARY NOT FOR CONSTRUCTION

CONSULTANT DRAWING NO. C-234

THE CITY OF WINNIPEG WATER AND WASTE DEPARTMENT

PROJECT TITLE: COCKBURN AND CALROSSIE COMBINED SEWER RELIEF WORKS - CONTRACT 4

FROM STA 1+220 TO STA 1+310

SHEET OF 8 OF 12
 COMPUTER FILE NAME: C-234.dwg
 CITY DRAWING NUMBER: LD-7894