

ADDRESS: 25 POSEIDON BAY  
 PROJECT No: 2016.11.28  
 SHEET TITLE: AQUATIC HALL OF FAME MUSEUM  
 FILE NAME: 0025P502.dwg/A3  
 DATE: 2016.11.28

**MILLWORK HARDWARE SCHEDULE**

MOBILE DISPLAY CABINET DRAWER SLIDES:  
 ACCURIDE SIDE MOUNTED #9301 HEAVY DUTY STEEL  
 FULL EXTENSION SLIDES WITH GANG LOCK  
 MECHANISM AND ANTI TIP MECHANISM REQUIRED.  
 30" LONG TO SUIT DRAWERS.

DISPLAY CASE DOOR FRAMES:  
 CR LAURENCE/BLUMCRAFT SERIES 1301-SM DISPLAY  
 CASE DRAWERS WITH SURFACE MOUNTED TOP AND  
 BOTTOM PIVOTS AND 7150 LEVER TYPE CAM LOCK  
 REQ'D. FOR 1/2" THICK TEMPERED GLASS. SATIN  
 ANODIZED FINISH.

DISPLAY CABINET SHELVING SYSTEM HARDWARE:  
 CR LAURENCE FLOOR TO CEILING VERTICAL CABLE  
 SYSTEM KIT CONSISTING OF #Y003 CR FOR 3/8" TO 1/2"  
 THICK GLASS KIT - 4 REQUIRED  
 KIT INCLUDES 15 FT STAINLESS STEEL CABLE, TOP  
 SWIVEL FITTING, AND BOTTOM ANCHOR  
 #Y031CR CRL HORIZONTAL SHELF CONNECTORS  
 #Y033CR CRL DRILL THRU SHELF SUPPORTS  
 #Y033TR CRL TRIM RING  
 #Y0310 CRL DUAL THREADED SCREW

DRAWER HANDLES:  
 RICHELIEU #2102128174- MATTE CHROME FINISH

CABINET DOOR HINGES:  
 BLUM CLIP 170 DEGREES SELF CLOSING NICKEL FINISH

CASTORS:  
 CASTORLAND # BLLKPA-TPA-80-FI-FK  
 3 1/8" RUBBER LOCKING CASTOR. CONFIRM CASTOR  
 TYPE IS SUITABLE FOR MOBILE CABINET DESIGN AND  
 FLOORING.

STANDOFFS:  
 RICHELIEU 3/4" Ø STANDOFF BASE # GMSOB341SC  
 RICHELIEU 3/4" Ø STANDOFF CAP # GMSOCAP34SC  
 RICHELIEU HANGER BOLT TO SUIT VARIOUS PANEL  
 THICKNESSES  
 FINISH- SATIN CHROME.

GROMMETS FOR INFORMATION DESK:  
 3"Ø SATIN CHROME FINISH INTO  
 SOLID SURFACE TOP.

DRAWER AND DOOR LOCKS:  
 CAM LOCKS- SATIN CHROME FINISH

INFORMATION DESK GATE HINGE:  
 HEAVY DUTY PIANO HINGE- SATIN CHROME FINISH

**GLAZING SCHEDULE**

TYPE G1- DISPLAY CABINET DOORS  
 10mm THICK LAMINATED SAFETY GLASS COMPLETE WITH  
 PVB INTERLAYER WITH POLISHED EDGES

TYPE G2- DISPLAY CABINET GLASS SHELVES  
 6mm THICK TEMPERED GLASS COMPLETE WITH  
 WITH POLISHED EDGES.

TYPE G3- MOBILE DISPLAY CABINET GLASS "CUBE"  
 3 SIDED "CUBE".  
 3/8" THICK UV PLEXIGLASS; # GUF-4 ON SIDES WITH 1/4"  
 THICK UV PLEXIGLASS # GUF-3 ON TOP.

**ROOM FINISH SCHEDULE**

ROOM NO.	ROOM NAME	FLOOR	BASEBOARD	NORTH WALL	SOUTH WALL	EAST WALL	WEST WALL	CEILING	CEILING HEIGHT	NOTES
<b>MAIN FLOOR</b>										
100	VESTIBULE		EXIST.					EXIST.	8'-0"	
101	LOBBY	SVF-1,	RB-2	EXIST.	EXIST.	EXIST.	EXIST.	EXIST.	31'-0"	
<b>SECOND FLOOR</b>										
200	MUSEUM ENTRY/GALLERY SPACE	SVF.	RB-1	PT-3	PT-3	PT-1	NA	EXIST./ACP-1/PT-2	21'-4"	EXISTING BULKHEAD PAINTED PT-7
201	GALLERY DISPLAY	CPT-1	RB-1	PT-1	PT-3	PT-1	PT-1	EXIST./PT-2	21'-4"	EXISTING METAL CEILING DECK
202	PROCESSING ROOM	VCT-1	RB-1	PT-5	PT-5	PT-5	PT-5	GYP. BD./PT-7	± 17'-0"	CEILING INSTALLED AT UIS OF JOISTS
203	GALLERY DISPLAY	CPT-1	RB-1	PT-3	PT-1	PT-1	PT-1	EXIST./PT-2	21'-4"	EXISTING METAL CEILING DECK
204	CORRIDOR	CPT-1	RB-1	PT-1	PT-1	PT-1	PT-1	ACT-1	9'-0"	
205	UNIVERSAL TOILET ROOM	QT-1	CT-1	CT-1/CT-2/PT-4	CT-1/CT-2/PT-4	CT-1/CT-2/PT-4	CT-1/CT-2/PT-4	ACT-1	8'-6"	
206	UNIVERSAL TOILET ROOM	QT-1	CT-1	CT-1/CT-2/PT-4	CT-1/CT-2/PT-4	CT-1/CT-2/PT-4	CT-1/CT-2/PT-4	ACT-1	8'-6"	
207	MEETING ROOM OFFICE	CPT-1	RB-1	PT-5	PT-5	PT-4	PT-5	ACT-1	11'-6"	
208	ARTIFACT HOLDING	EXIST.	RB-1	EXIST.	EXIST.	EXIST.	PT-5	EXIST./PT-2	21'-4"	EXISTING METAL CEILING DECK
<b>ABBREVIATIONS</b> ACT.-ACOUSTIC TILE CPT.-2 x 2 CARPET TILE CT.-CERAMIC WALL TILE GYP. BD.-GYPSUM BOARD PT.-PAINT QT.-QUARRY FLOOR TILE SVF.-SHEET VINYL FLOOR RB.-RUBBER COVERED BASE R.F.-RUBBER FLOORING VCT.-VINYL COMPOSITE TILE										

**DOOR SCHEDULE**

DOOR NO.	DOOR				FRAME				RATING	HARDWARE GROUP	NOTES
	TYPE	WIDTH	HEIGHT	THICK	MATL.	FINISH	TYPE	MATL.			
D-100A	EXISTING		EXISTING		AL	---	AL	---	---	---	
D-100B					AL	---	AL	---	---	---	
D-100C					AL	---	AL	---	---	---	
D-100D					AL	---	AL	---	---	---	
D-100E					AL	---	AL	---	---	---	
D-100F					AL	---	AL	---	---	---	
D-200A					HCM	PT	PS	PT	---	---	
D-200B					HCM	PT	PS	PT	---	---	
D-201	EXISTING		EXISTING		AL	---	AL	---	---	---	
D-202	EXISTING		EXISTING		HCM	PT-8	---	PT-8	---	---	
D-203	EXISTING		EXISTING		AL	---	AL	---	---	---	
D-205	B	3'-4"	7'-0"	1 1/2"	SCW	ST	1	PS	PT-6	---	TYPE 3
D-206	B	3'-4"	7'-0"	1 1/2"	SCW	ST	1	PS	PT-6	---	TYPE 3
D-207	B	3'-4"	7'-0"	1 1/2"	SCW	ST	1	PS	PT-6	---	TYPE 1
D-208	A	3'-6"	7'-0"	1 1/2"	HCM	PT-9	1	PS	PT-6	---	TYPE 2
<b>ABBREVIATIONS</b> AL-ALUMINUM HCM-HOLLOW CORE METAL SCW-SOLID CORE WOOD PS-PRESSED STEEL PT-PAINT PT-9 -PAINT #9 ST-STAIN											

**DOOR AND HARDWARE NOTES**

- CAULK ALL DOOR FRAMES PRIOR TO PAINTING.
- PROVIDE LEVER SETS SCHLAGE "SATURN" OR APPROVED EQUAL IN ACCORDANCE WITH B7.
- FOR DOOR HARDWARE FINISH TO BE BRUSHED ALUMINUM OR SIMILAR.
- DOOR HARDWARE TO BE MEDIUM DUTY GRADE, EQUAL TO SCHLAGE COMMERCIAL MEDIUM DUTY GRADE.
- ALL CYLINDER KEYWAYS TO BE SUPPLIED, INSTALLED & KEYPED BY THE CONTRACTOR.
- PROVIDE (3) THREE KEYS FOR EVERY LOCK.
- STAMP KEYING CODE NUMBERS ON KEYS & CYLINDERS.
- NEW DOOR OPERATORS TO BE:
- EXISTING DOUBLE DOORS & ALL HARDWARE D202 TO BE SALVAGED & RELOCATED. CONFIRM WITH CONTRACT ADMINISTRATOR.
- SOLID CORE WOOD DOORS TO BE MAPLE VENEER STAINED CLEAR. PROVIDE STAIN SAMPLE TO CONTRACT ADMINISTRATOR FOR APPROVAL.

**HARDWARE SCHEDULE**

**TYPE 1 - OFFICE**  
 3 EACH HINGES 3CB1 4.5 x 4.652 IVE BRUSHED CHROME.  
 1 EACH LOCKING LEVER HANDLE  
 1 EACH ENTRANCE LOCK AL53PDSAT 626 SCH  
 1 EACH DOME STOP FS438 626 IVE

**TYPE 2 - STORAGE**  
 3 EACH HINGES 3CB1 4.5 x 4.652 IVE BRUSHED CHROME.  
 1 EACH LOCKING LEVER HANDLE  
 1 EACH ENTRANCE LOCK AL53PDSAT 626 SCH  
 1 EACH DOME STOP FS438 626 IVE  
 305mm STAINLESS STEEL KICKPLATES -BOTH SIDES

**TYPE 3 - WASHROOMS**  
 4 HINGES CB179 4 1/2 x 4 26D CST  
 1 LOCKSET ND80PD RHO 50-210-MK 626 CSC  
 1 ELECTRIC STRIKE 5100-3FP SP28 CVO  
 1 AUTO OPERATOR 7100LE 628 HOAS  
 1 KICKPLATE GSH 80A 305 x 990 C32D CGA  
 1 WALL STOP GSH 240 C26D CGA  
 1 RESTROOM CONTROL CX-WC11 CAMS  
 2 FULL HEIGHT ACTUATOR 1-36-5 INGRESS'R 628 VA01  
 NOTE: USE MODEL 1-36-3 x CLEAR ANODIZED FINISH  
 PUSH BUTTON & ANNUNCIATOR SYSTEM:  
 CX-33 ADVANCED LOGIC CONTROL  
 CM-400/8 MUSHROOM (PUSH TO LOCK) BUTTON  
 CM-AF500 SINGLE GANG LED ANNUNCIATOR  
 CX-MDC MAGNETIC DOOR CONTACT

**DOOR LEGEND**

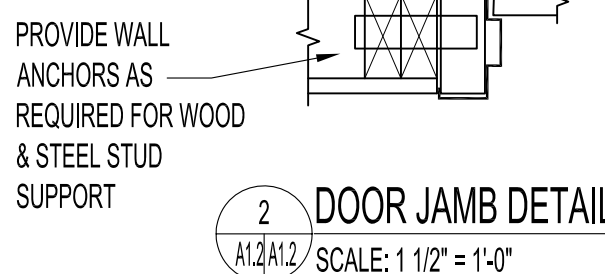
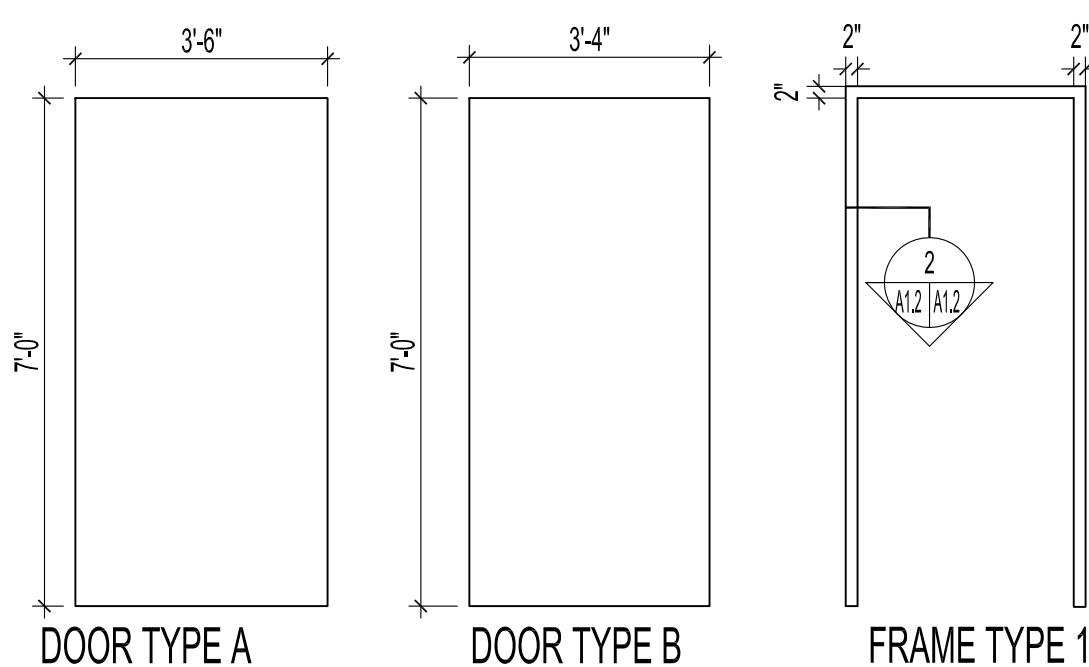

**FINISH LEGEND**

ACT-1: ACOUSTIC CEILING TILE  
 CGC CEILINGS: MARS CP 3/4" SLT #86684  
 COLOR: WHITE  
 SIZE: 24"x24"  
 GRID: CGC DOWN DX 15/16" CONCEALED SUSPENSION SYSTEM

ACP-1: ACRYLIC CEILING PANELS  
 CGC TRANSLUCENT CANOPIES  
 WAVE PROFILE; 2X6' 2 PANELS KIT  
 PANEL COLOR: SANTORINI  
 TO BE MOUNTED FROM STRUCTURE. PROVIDE ALL NECESSARY PANEL CLIPS AND ACCESSORIES REQUIRED.

CPT-1: CARPET TILE  
 SHAW CONTRACT- SHAPE TILE # 5T070; 24"x24" TILE  
 COLOR: SPACE 69500  
 INSTALLATION: ASHLAR METHOD. REFER TO DRAWING A1.4 FOR DIRECTION  
 100% SOLUTION DYED; LIFETIME COMMERCIAL LIMITED WARRANTY  
 CONTRACTOR TO PROVIDE 3% EXTRA MATERIAL  
 TO BE INSTALLED OVER UNDERCUSHION UC-1.

CT-1: CERAMIC WALL TILE-ACCENT  
 JULIAN TILE LUMINA SERIES- CURVED GLASS- # LWHCU1030G  
 SIZE: 10"x 30"  
 GROUT: COLOR TBD  
 INSTALLATION: HORIZONTAL- REFER TO ELEVATIONS.  
 CONTRACTOR TO PROVIDE 3% EXTRA MATERIAL

CT-2: CERAMIC WALL TILE- FIELD  
 JULIAN TILE LUMINA SERIES- WHITE GLOSS- # LWH1030G  
 SIZE: 10"x 30"  
 GROUT: COLOR TBD  
 INSTALLATION: HORIZONTAL- REFER TO ELEVATIONS.  
 CONTRACTOR TO PROVIDE 3% EXTRA MATERIAL

CG-1: CORNER GUARDS  
 JOHNSONITE # VBG-40-48 1 1/2" WIDE BLACK; 4 FT HIGH

MEL-1: MELAMINE  
 MELAMINE PANEL TO MATCH WILSONART MANITOBA MAPLE  
 #7911-60 LAMINATE

PL-1: PLASTIC LAMINATE  
 WILSONART MANITOBA MAPLE #7911-60

PL-2: PLASTIC LAMINATE  
 WILSONART 6257-(419) SATIN BRUSHED ALUMINUM

PT-1: PAINT  
 PRODUCT: DULUX PAINTS LIFEMASTER 100% ACRYLIC LATEX  
 COLOR: 00NN 07/000 DEEP ONYX  
 FINISH: EGGSHELL- 2 FINISH COATS REQ'D. TINTED PRIMER MAY BE REQUIRED ON NEW DRYWALL WALLS.  
 LOCATION: WALLS AS INDICATED

PT-2: PAINT  
 PRODUCT: GLIDDEN PAINTS SPRAYMASTER 10105 LATEX PREMIXED PAINT  
 COLOR: BLACK  
 LOCATION: METAL CEILING DECK AND TRUSSES, METAL HVAC DUCTS, PIPES  
 APPLY AS PER MANUFACTURERS SPECIFICATIONS.

PT-3: PAINT  
 PRODUCT: DULUX PAINTS LIFEMASTER 100% ACRYLIC LATEX  
 COLOR: TO MATCH BENJAMIN MOORE COLOR # 2055-20 PACIFIC OCEAN BLUE  
 FINISH: EGGSHELL- 2 FINISH COATS REQ'D. TINTED PRIMER MAY BE REQUIRED ON NEW DRYWALL WALLS. FLAT FINISH REQUIRED ON DUNE WALL PANELS.  
 LOCATION: WALLS AS INDICATED

PT-4: PAINT  
 PRODUCT: DULUX PAINTS LIFEMASTER 100% ACRYLIC LATEX  
 COLOR: COSMIC BLUE 30BG 21/301  
 FINISH: PEARL IN UNIVERSAL TOILET ROOMS; EGGSHELL IN OFFICE  
 1 PRIMER COAT, 2 FINISH COATS REQ'D.  
 LOCATION UNIVERSAL TOILET ROOMS AND OFFICE

PT-5: PAINT  
 PRODUCT: DULUX PAINTS LIFEMASTER 100% ACRYLIC LATEX  
 COLOR: TOASTY GREY 30YY 51/098  
 FINISH: EGGSHELL 1 PRIMER COAT, 2 FINISH COATS REQ'D.  
 LOCATION: OFFICE/ MEETING ROOM

PT-6: PAINT  
 PRODUCT: DULUX PAINTS LIFEMASTER 100% ACRYLIC LATEX  
 COLOR: OBSIDIAN GLASS 00NN 13/000  
 FINISH: SEMI-GLOSS-1 PRIMER COAT, 2 FINISH COATS REQ'D.  
 LOCATION: METAL DOOR FRAMES  
 REFER TO DOOR FINISH SCHEDULE

PT-7: PAINT  
 PRODUCT: DULUX PAINTS LIFEMASTER 100% ACRYLIC LATEX  
 COLOR: TREASURED MOMENT 40YY 83/043  
 FINISH: FLAT 1 PRIMER COAT ON NEW DRYWALL, 2 FINISH COATS REQ'D.  
 LOCATION: EXISTING BULKHEAD IN GALLERY SPACE;  
 PROCESSING ROOM CEILING

PT-8: PAINT  
 PRODUCT: DULUX PAINTS LIFEMASTER 100% ACRYLIC LATEX  
 COLOR: 00NN 07/000 DEEP ONYX  
 FINISH: SEMI-GLOSS - 1 COAT PRIMER; 2 FINISH COATS REQ'D.  
 LOCATION: HOLLOW METAL DOOR FRAMES  
 REFER TO DOOR FINISH SCHEDULE

QT-1: QUARRY FLOOR TILE  
 JULIAN TILE SERIES ALPS #ALGR160 GRIGIO  
 SIZE: 12" x 24"  
 GROUT: COLOR TBD  
 LOCATION: UNIVERSAL TOILET ROOMS

RB-1: RUBBER BASE  
 JOHNSONITE MILLWORK SERIES REVEAL PROFILE  
 # MW-40-F BLACK  
 HEIGHT: 6"

RB-2: RUBBER BASE  
 JOHNSONITE MILLWORK SERIES REVEAL PROFILE  
 # MW-70-F BLUEST  
 HEIGHT: 6"  
 LOCATION: LOBBY AREA ONLY WITH SVF.

RB-3: RUBBER BASE  
 JOHNSONITE RUBBER COVERED BASE  
 # 69 STERLING SILVER CG  
 HEIGHT: 4" AND 6" ON INFORMATION DESK

RF-1: RUBBER FLOOR TILE  
 ROPPE #996 RAISED CIRCULAR VANTAGE DESIGN  
 COLOR: TBD  
 SIZE 19" x 19"; PROFILE HEIGHT 1/32"  
 LOCATION: TOP OF STAIR 1 AND 2

RP-1: RESIN PANEL  
 3 FORM VARIA ECORESIN  
 STYLE: HINT FLOW + ATLANTIC  
 FINISH: FRONT- HINT FLOW EMBOSS; BACK PATINA  
 GAUGE: 1/2"

SN-1: STAIR NOSING  
 WOOSTER FLEX TRED ANTISLIP ROLL TAPE  
 2" WIDE; COLOR: BLACK

SN-2: STAIR NOSING  
 WOOSTER FLEX TRED ANTISLIP ROLL TAPE  
 2" WIDE; COLOR: SAFETY YELLOW

SS-1: SOLID SURFACE COUNTERTOP  
 AVONITE COZUMEL #K3-8575  
 SATIN FINISH # 05/16  
 THICKNESS: 1/2"

SVF-1: SHEET VINYL FLOOR  
 FORBO MARMOLEUM  
 SERIES: REAL  
 COLOR: 3205 LAPIS LAZULI

SVF-2: SHEET VINYL FLOOR  
 FORBO MARMOLEUM  
 SERIES: REAL  
 COLOR: 3238 LAGUNA

SVF-3: SHEET VINYL FLOOR  
 FORBO MARMOLEUM  
 SERIES: REAL  
 COLOR: 3242 ADRIATICA

**FINISH LEGEND**

TR-1: ADAPTOR TRANSITION STRIP - CARPET TO SHEET VINYL  
 JOHNSONITE CTA-40-A; COLOR: BLACK

TR-2: PVC COVE BASE TRANSITION  
 PROFILE: SCHLUTER SYSTEMS DILEX-HK  
 LOCATION: BETWEEN WALL AND FLOOR TILE

TR-3: SCHLUTER SYSTEMS; SCHEINE PROFILE TO SUIT  
 FINISH: ALUMINUM  
 LOCATION: FLOOR TILE TO CARPET; TOP OF CT-2 WALL TILE

TR-4: WHEELED TRAFFIC TRANSITION STRIP- CARPET TO CONCRETE  
 JOHNSONITE CTA-40-J; COLOR: BLACK # 40

TR-5: REDUCER EDGE TRIM  
 JOHNSONITE SSR-70-B; COLOR: 70 BLUEST

UC-1: UNDERCUSHION  
 SHAW CONTRACT; CUSHIONWORX PRODUCT  
 3 mm THICK UNDERLAY  
 TO BE INSTALLED UNDER CARPET TILE AS PER MANUFACTURER'S  
 INSTRUCTIONS

VCT-1: VINYL COMPOSITE TILE  
 ARMSTRONG STANDARD EXCELOX; SIZE: 12"x12"  
 COLOR: TBD

WB-1: WINDOW BLINDS  
 ALTEX SUN PROJECT TEXSCREEN 9109; 126" WIDE  
 COLOR: 9101-10 BLACK WITH 1% OPENESS FACTOR  
 COMPLETE WITH ALUMINUM TOP COVER RAIL.

WB-2: WINDOW BLINDS (BLACKOUT)  
 ALTEX SUN PROJECT TEXOPAQUE 6300 WITH  
 TEXSCREEN 9109 SHEERWEAVE; 126" WIDE PRODUCT  
 COLOR: BLACK  
 COMPLETE WITH ALUMINUM TOP COVER RAIL.

WF-1: TRANSLUCENT INTERIOR WINDOW FILM  
 MACTAC DUSTED GLASS FILM  
 LOCATION: EAST WALLS AND DOOR AS SHOWN ON ELEVATION 2/A2.0  
 PROVIDE SAMPLE TO CONTRACT ADMINISTRATOR.

WF-2: UV WINDOW FILM  
 VISTA WINDOW FILM WITH 99% UV REJECTION WITH  
 VISIBLE LIGHT TRANSMISSION AND HEAT REDUCTION PROPERTIES.  
 LOCATION: LOBBY WINDOWS-NORTH AND SOUTH SIDE  
 PROVIDE SAMPLE TO CONTRACT ADMINISTRATOR.  
 WP-1: WALL PANEL  
 MODULAR ARTS INC. INTERLOCKING ROCK PANEL  
 PRODUCT: DUNE PANEL  
 SIZE: 32"x32"; HORIZONTAL PATTERN INSTALL

0	ISSUED FOR CONSTRUCTION	NOV 28/16
No.	REVISION/DESCRIPTION	BY DATE
SEAL		

DRAWN	K/JN	CHECKED	DESIGNED	K/JN	APPROVED
DATE	2016.08.24	USER	APPROVAL		

THE CITY OF WINNIPEG  
 PLANNING, PROPERTY AND  
 DEVELOPMENT DEPARTMENT  
 MUNICIPAL ACCOMMODATIONS DIVISION  
 3-65 GARRY STREET, R3C 4K4

PROJECT  
 AQUATIC HALL OF FAME MUSEUM  
 ROYAL GALLERY SPACE RESTORATION

25 POSEIDON BAY

SHEET TITLE

SPECIFICATIONS

SCALE	PROJECT No:	SHEET No:
AS SHOWN	2014-148	A5.0