

**LEGEND**

- TIED CONCRETE BLOCKS
- GABIONS/ GABION MATTRESS
- WILLOW SPILING
- 25% EXISTING SLOPE AND DIRECTION
- 227.87 + EXISTING GRADE
- EXISTING MATURE TREES (AS PER AMEC FOSTER WHEELER SURVEY)
- EXISTING MATURE TREES (AS PER CITY SURVEY)

**GENERAL NOTES**

1. EXISTING PATHWAY PROVIDED FOR GENERAL LOCATION OF ELEMENTS ONLY. CONTRACTOR TO CONFIRM ALL SITE LAYOUT PRIOR TO CONSTRUCTION.
2. ALL DIMENSIONS SHOWN IN METRIC UNITS. NUMBERS WITH DECIMALS INDICATE METERS. WHOLE NUMBERS INDICATE MILLIMETERS.
3. ALL UTILITIES ARE SHOWN AS INFORMATION ONLY. CONTRACTOR TO CONFIRM LOCATION OF ALL UTILITIES ON SITE PRIOR TO CONSTRUCTION.
4. CONTRACTOR TO STAKE OUT LOCATION OF ALL WORKS FOR APPROVAL BY CONTRACT ADMINISTRATOR PRIOR TO ANY CONSTRUCTION OR REMOVALS.
5. CONTRACTOR TO CONFIRM ALL DIMENSIONS ON SITE AND REPORT ANY DISCREPANCIES TO THE CONTRACT ADMINISTRATOR PRIOR TO CONSTRUCTION.
6. DURING CONSTRUCTION, CONTRACTOR TO PROTECT TO CITY OF WINNIPEG STANDARDS ALL EXISTING TREES, SIDEWALKS, CURBS, SOD, UTILITIES, AND PAVING TO REMAIN. AREAS DAMAGED DURING CONSTRUCTION TO BE REPAIRED TO CITY OF WINNIPEG STANDARDS AT CONTRACTOR'S COST.
7. CONTRACTOR IS RESPONSIBLE FOR ALL REMOVALS AS REQUIRED TO CONSTRUCT ALL WORKS AS SHOWN ON PLANS AND DETAILS. ALL ITEMS TO BE REMOVED MUST BE DISPOSED OF LEGALLY OFF SITE.
8. CONTRACTOR TO REPAIR ALL ON AND OFF SITE NATURAL GRASS AREAS, SODDED AREAS, SHRUB BEDS, TREES, CONCRETE, ROAD PAVING AND CURBS ETC. DAMAGED DURING CONSTRUCTION TO CONTRACT ADMINISTRATOR'S SATISFACTION AND TO THE CITY OF WINNIPEG STANDARDS AT HISHER OWN COST.
9. ALL WORK TO BE DONE IN ACCORDANCE WITH CITY OF WINNIPEG STANDARD CONSTRUCTION SPECIFICATIONS UNLESS OTHERWISE NOTED.
10. REFER ALSO TO WRITTEN SPECIFICATIONS.
11. MAINTAIN EXISTING GRADE AND DRAINAGE PATTERNS WHERE POSSIBLE.
12. CONSTRUCTION ACCESS TO BE LIMITED TO THE ROUTES SPECIFIED ON SITE BY CONTRACT ADMINISTRATOR.
13. CONTRACTOR TO ADJUST GRADES OF ALL SERVICES WITHIN LIMIT OF WORK AS REQUIRED INCLUDING ALL MANHOLES, CATCH BASINS, FIRE HYDRANT, CURB STOPS, ETC. CONFIRM WITH CONTRACT ADMINISTRATOR.

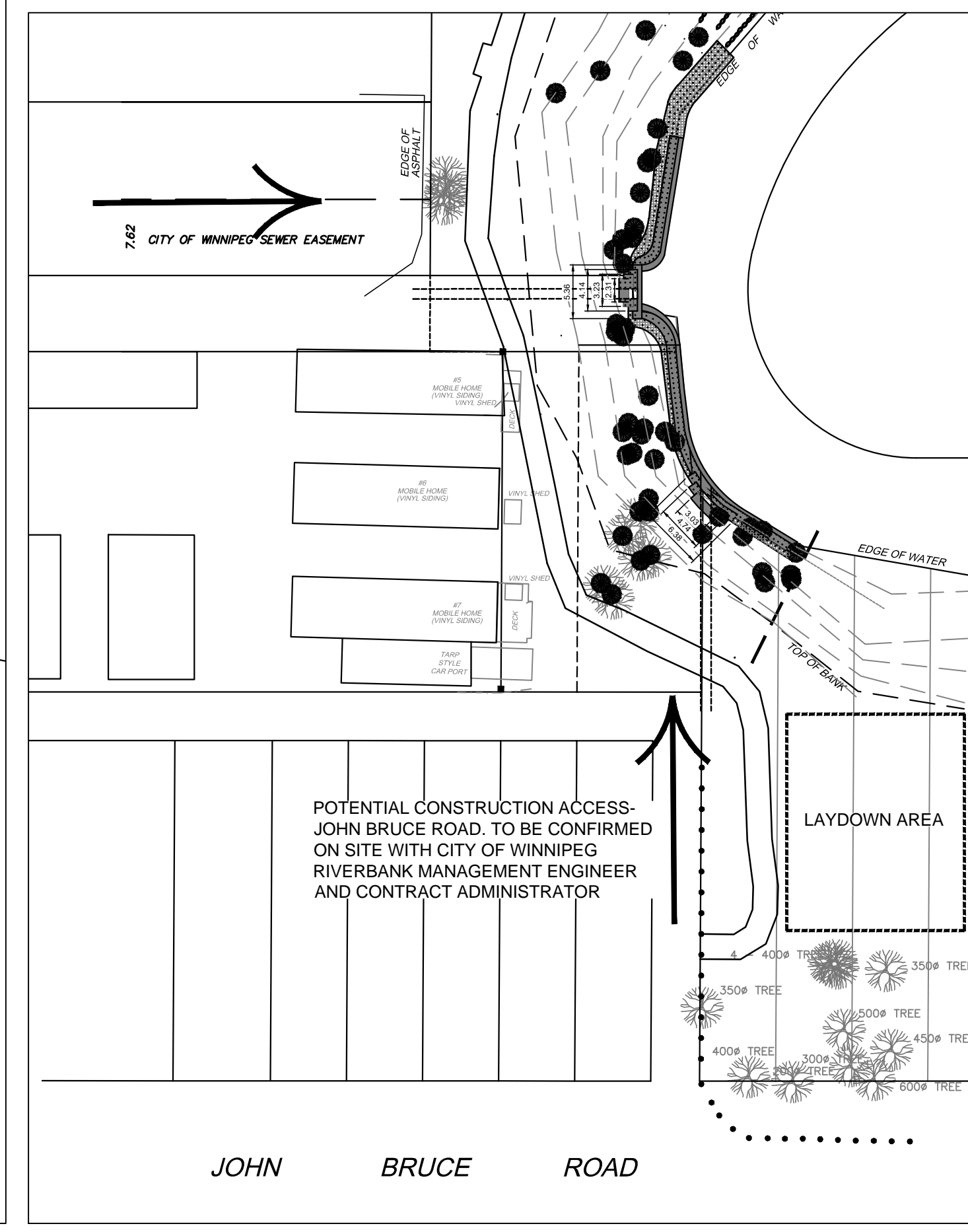

PROPOSED CONSTRUCTION ACCESS

1	ISSUED FOR TENDER	16/10/19MN
No.	Revisions	Date By
Date	Scale	
23-09-2016		1:250
Designed By	Drawn By	Checked By
MN	MN	SR



**JOHN BRUCE PARK SEINE RIVERBANK STABILIZATION**

**LAYOUT PLAN**