

APPENDIX "A"

SITES

Site 1 SRB 4-5 *
(Lakeside Meadows)



Site 2 SRB 4-6 *
(Kildonan Meadows)



Site 3 SRB 4-7 *
(Transcona Deep Pond)

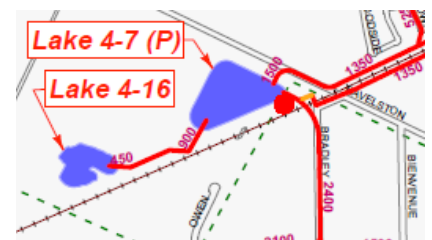

Site 4 SRB 5-1 *
(St. Boniface Industrial park)

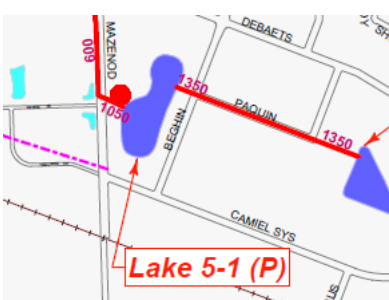

Site 5 SRB 5-21 *
(East Mint Place)

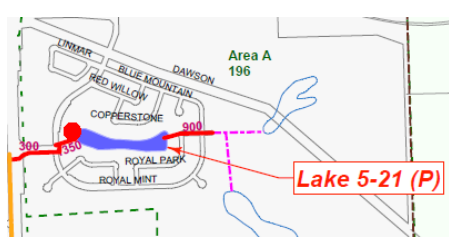

Site 6 Lot 16 Drain @ Brady Rd *
(Brady Road Bridge)

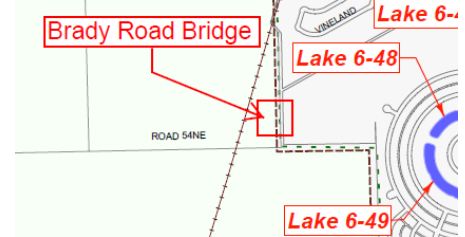

Site 7 Lot 16 Drain @ SRB 6-14**
(Up and Downstream of SRB 6-14)

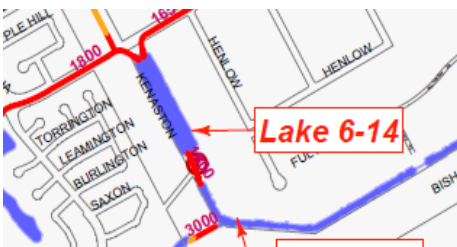

Site 8 Lot 16 Drain @ Plaza inlet*
(Inlet Structure to 96" pipe)

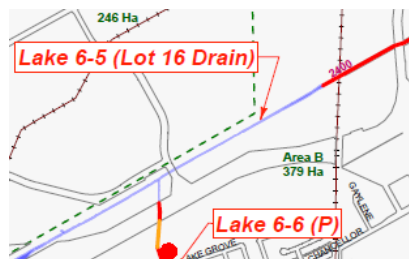

Site 9 SRB 6-6 *
(Waverly Heights)

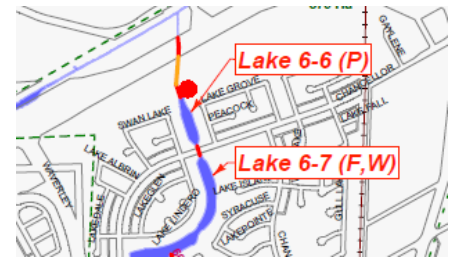

EQUIPMENT AT EACH SITE

* Adcon Telemetry A753 addWAVE GSM/GRPS datalogger, 460mA 9V solar set, and LEV-1 10m Level Sensor (15m cable). 4m mast anchored in ground.

**Adcon Telemetry A753 addWAVE GSM/GRPS datalogger, 460mA 9V solar set, and 2 LEV-1 10m Level Sensor (15m cable). 4m mast anchored in ground.

APPENDIX "A" CON'T

SITES

Site 10 Dugald Drain @ Mezenod Rd *
(Dugald Drain)

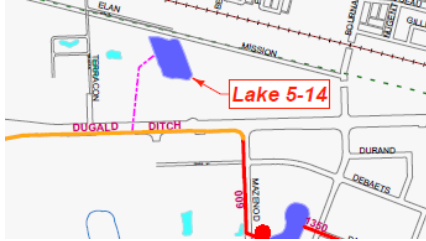

Site 11 SRB 6-23 *
(Inland Cement)

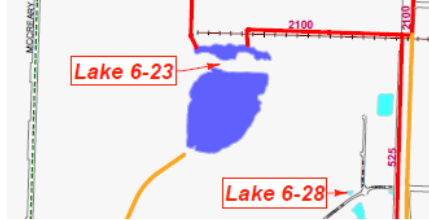

Site 12 SRB 6-36 *
(Waverly West)



Site 13 North Perimeter Bridge ***



Site 14 South Perimeter Bridge ***



EQUIPMENT AT EACH SITE

* Adcon Telemetry A753 addWAVE GSM/GRPS datalogger, 460mA 9V solar set, and LEV-1 10m Level Sensor (15m cable). 4m mast anchored in ground.

**Adcon Telemetry A753 addWAVE GSM/GRPS datalogger, 460mA 9V solar set, and 2 LEV-1 10m Level Sensor (15m cable). 4m mast anchored in ground.

*** Adcon A752 addSDI GPRS RTU datalogger, 460mA 9VDC, 5W solar set, and SR50-Sonic Ranging Sensor (15m cable). 4m mast anchored in ground.