

ST. VITAL ROAD

TOD DR

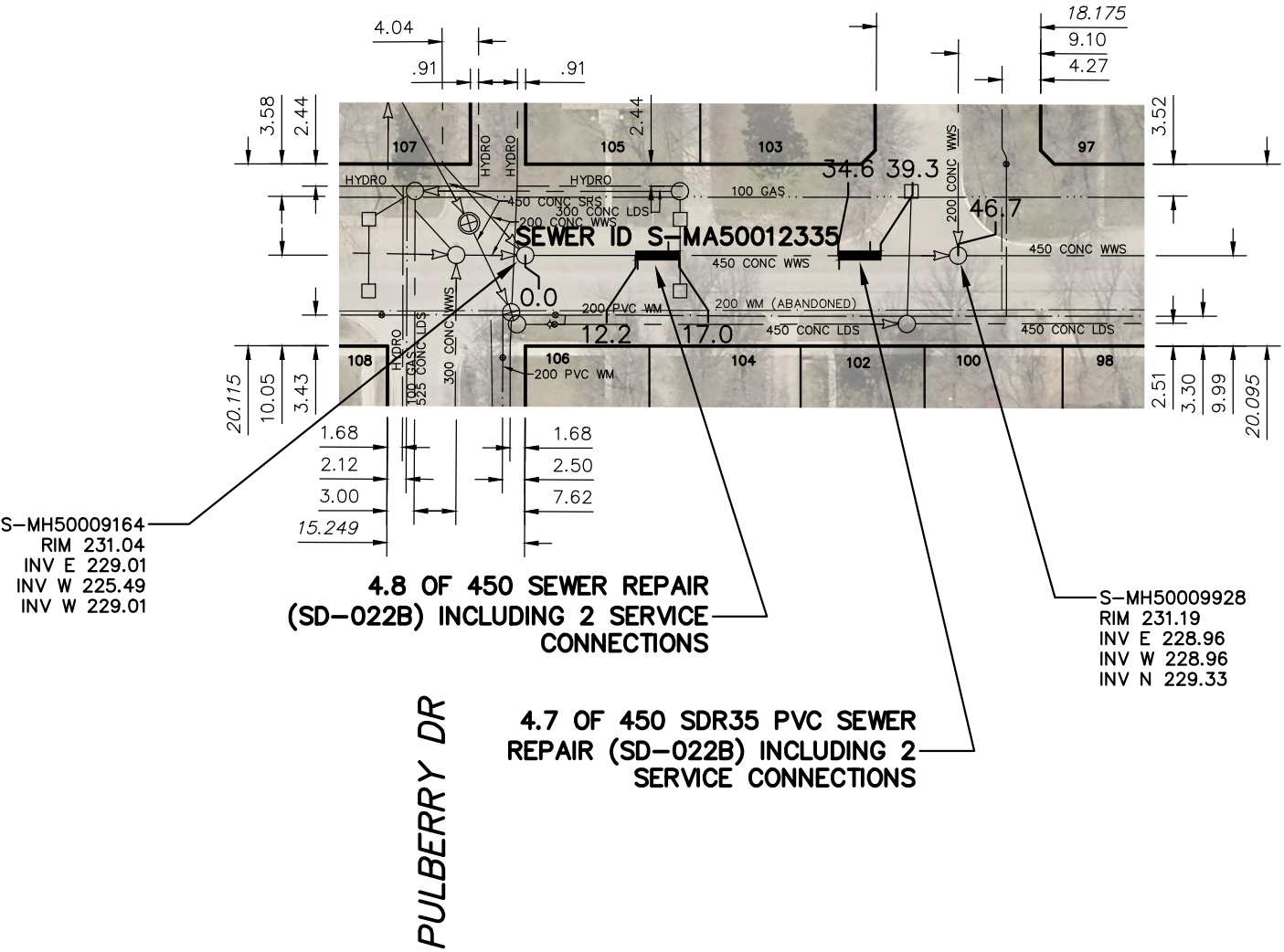
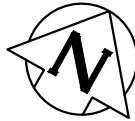

FOR INDEX SEE 11339

WARNING

IF POWER EQUIPMENT OR EXPLOSIVES ARE TO BE USED FOR EXCAVATION ON THIS PROJECT THE CONTRACTOR MUST:

- 1) NOTIFY THE GAS COMPANY OF THE PROPOSED LOCATION OF EXCAVATION.
- 2) TAKE PRECAUTION TO AVOID DAMAGE TO GAS COMPANY INSTALLATIONS.

SEE PROVINCIAL REGULATION 210/72 FOR DETAILS

METRIC
WHOLE NUMBERS INDICATE MILLIMETRES
DECIMALIZED NUMBERS INDICATE METRES

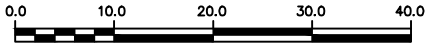

<p>LOCATION APPROVED UNDERGROUND STRUCTURES</p> <p>SUPV. U/G STRUCTURES COMMITTEE _____ DATE _____</p> <p>NOTE: LOCATION OF UNDERGROUND STRUCTURES AS SHOWN ARE BASED ON THE BEST INFORMATION AVAILABLE BUT NO GUARANTEE IS GIVEN THAT ALL EXISTING UTILITIES ARE SHOWN OR THAT THE GIVEN LOCATIONS ARE EXACT. CONFIRMATION OF EXISTENCE AND EXACT LOCATION OF ALL SERVICES MUST BE OBTAINED FROM THE INDIVIDUAL UTILITIES BEFORE PROCEEDING WITH CONSTRUCTION.</p>	<p>B.M. ELEV.</p> <table border="1" style="width:100%; height: 100px;"> <tr><td> </td><td> </td><td> </td><td> </td></tr> <tr><td> </td><td> </td><td> </td><td> </td></tr> <tr><td> </td><td> </td><td> </td><td> </td></tr> <tr><td> </td><td> </td><td> </td><td> </td></tr> <tr><td> </td><td> </td><td> </td><td> </td></tr> <tr><td> </td><td> </td><td> </td><td> </td></tr> <tr><td> </td><td> </td><td> </td><td> </td></tr> <tr><td> </td><td> </td><td> </td><td> </td></tr> <tr><td> </td><td> </td><td> </td><td> </td></tr> <tr><td> </td><td> </td><td> </td><td> </td></tr> <tr><td> </td><td> </td><td> </td><td> </td></tr> </table>																																													<table border="1" style="width:100%;"> <tr> <td>DESIGNED BY</td> <td>TS</td> <td>CHECKED BY</td> <td>SC</td> </tr> <tr> <td>DRAWN BY</td> <td>AD</td> <td>APPROVED BY</td> <td>KZ</td> </tr> <tr> <td>SCALE:</td> <td>1:750</td> <td>RELEASED FOR CONSTRUCTION</td> <td>K. ZUREK</td> </tr> <tr> <td>HORIZONTAL</td> <td> </td> <td>DATE</td> <td>2016 12 21</td> </tr> <tr> <td>VERTICAL</td> <td> </td> <td>DATE</td> <td>2016 12 21</td> </tr> </table>	DESIGNED BY	TS	CHECKED BY	SC	DRAWN BY	AD	APPROVED BY	KZ	SCALE:	1:750	RELEASED FOR CONSTRUCTION	K. ZUREK	HORIZONTAL		DATE	2016 12 21	VERTICAL		DATE	2016 12 21	<p>ENGINEER'S SEAL</p> <p>ORIGINAL SIGNED BY S.R.J. COURNOYER 16/12/15</p> <p>CONSULTANT DRAWING NUMBER -</p>	<p style="text-align: center;">THE CITY OF WINNIPEG WATER AND WASTE DEPARTMENT ENGINEERING DIVISION</p> <p style="text-align: center;">2016 SEWER MAIN RENEWALS BY EXTERNAL POINT REPAIR ST. VITAL ROAD MH AT PULBERRY DRIVE (E R) TO MH AT TOD DRIVE (W LEG)</p>	<p>SHEET 14 OF 17</p> <p>CITY DRAWING NUMBER</p> <p style="font-size: 24pt; text-align: center;">11350</p>
DESIGNED BY	TS	CHECKED BY	SC																																																																		
DRAWN BY	AD	APPROVED BY	KZ																																																																		
SCALE:	1:750	RELEASED FOR CONSTRUCTION	K. ZUREK																																																																		
HORIZONTAL		DATE	2016 12 21																																																																		
VERTICAL		DATE	2016 12 21																																																																		