

# BEDSON STREET

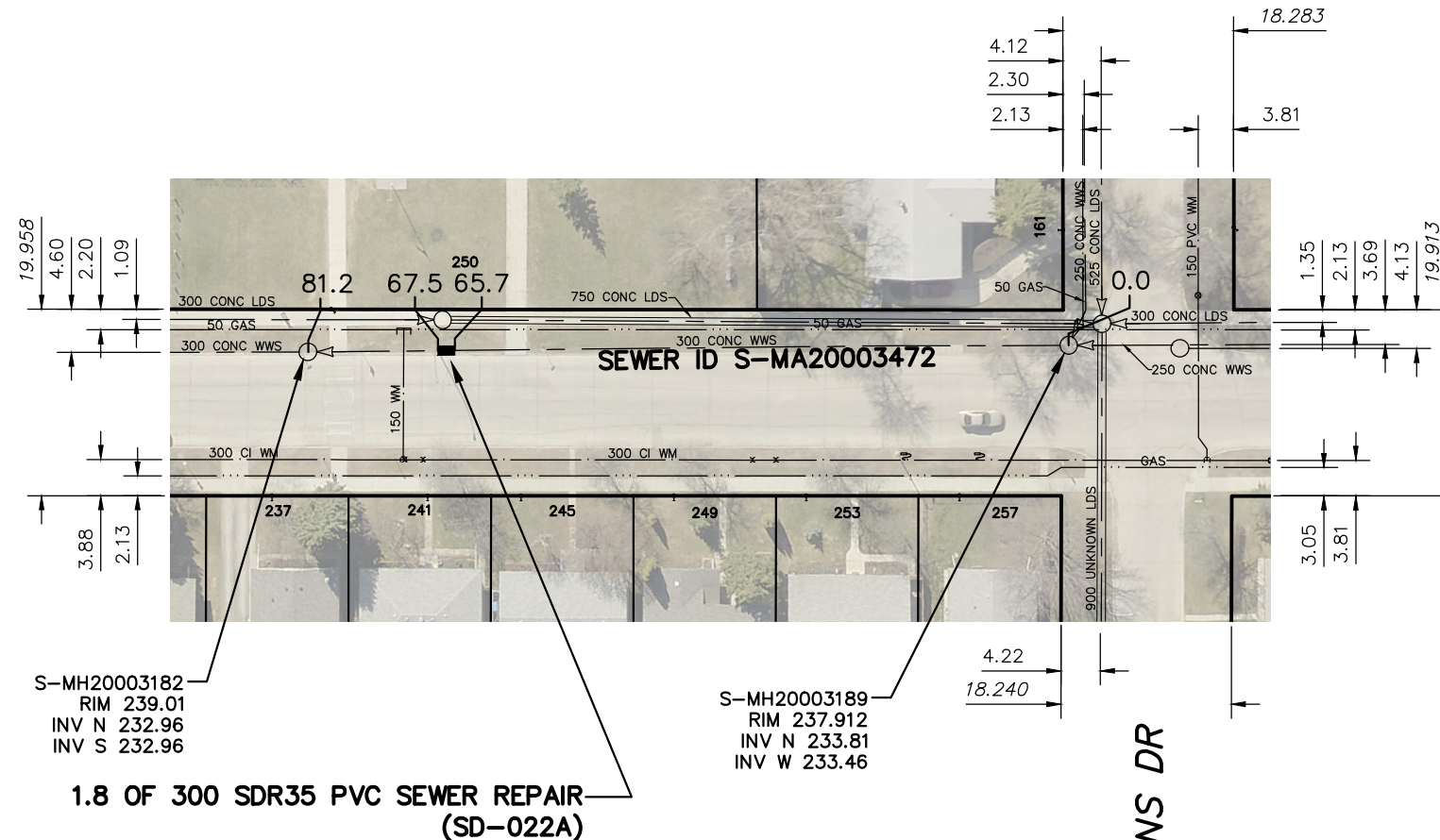

SEWER JUNCTION INFORMATION FROM SEWER VIDEO INSPECTION		
SEWER ID S-MA20003472		
DISTANCE FROM MH ID S-MH20003189		
DISTANCE	DIAMETER	CLOCK
12.8	150	12
28.1	150	12
43.4	150	12
58.5	150	12
63.3	150	12
73.8	150	12

FOR INDEX SEE 11308

### WARNING

IF POWER EQUIPMENT OR EXPLOSIVES ARE TO BE USED FOR EXCAVATION ON THIS PROJECT THE CONTRACTOR MUST:

- 1) NOTIFY THE GAS COMPANY OF THE PROPOSED LOCATION OF EXCAVATION.
- 2) TAKE PRECAUTION TO AVOID DAMAGE TO GAS COMPANY INSTALLATIONS.

SEE PROVINCIAL REGULATION 210/72 FOR DETAILS

### METRIC

WHOLE NUMBERS INDICATE MILLIMETRES  
DECIMALIZED NUMBERS INDICATE METRES

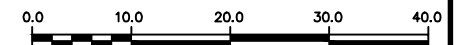

### LOCATION APPROVED UNDERGROUND STRUCTURES

SUPV. U/G STRUCTURES COMMITTEE DATE

#### NOTE:

LOCATION OF UNDERGROUND STRUCTURES AS SHOWN ARE BASED ON THE BEST INFORMATION AVAILABLE BUT NO GUARANTEE IS GIVEN THAT ALL EXISTING UTILITIES ARE SHOWN OR THAT THE GIVEN LOCATIONS ARE EXACT. CONFIRMATION OF EXISTENCE AND EXACT LOCATION OF ALL SERVICES MUST BE OBTAINED FROM THE INDIVIDUAL UTILITIES BEFORE PROCEEDING WITH CONSTRUCTION.

B.M. ELEV.

NO.	REVISIONS	DATE	BY

DESIGNED BY	TS	CHECKED BY	SC
DRAWN BY	RJ	APPROVED BY	KZ
SCALE:	1:750	RELEASED FOR CONSTRUCTION	K. ZUREK
HORIZONTAL		DATE	2016 11 14
VERTICAL		DATE	2016 11 14

ENGINEER'S SEAL

ORIGINAL SIGNED BY  
S.R.J. COURNOYER  
16/11/14

CONSULTANT DRAWING NUMBER



**THE CITY OF WINNIPEG**  
WATER AND WASTE DEPARTMENT  
ENGINEERING DIVISION

2016 SEWER MAIN RENEWALS  
BY EXTERNAL POINT REPAIR  
**BEDSON STREET (W & P)**  
MH AT DICKENS DRIVE TO  
1ST MH S OF DICKENS DRIVE

SHEET 5 OF 29

CITY DRAWING NUMBER

11312

PLOT DATE: 2016 11 18

BID OPPORTUNITY: 967-2016  
CONTRACT NUMBER: 6A

FILE PATH: R:\DRAWINGS\SEWER\2016 RENEWALS\Contract 6A\CONSTRUCTION\  
FILE NAME: BEDSON\_S-MA20003472.dwg