

BUFFIE BAY (S LEG)

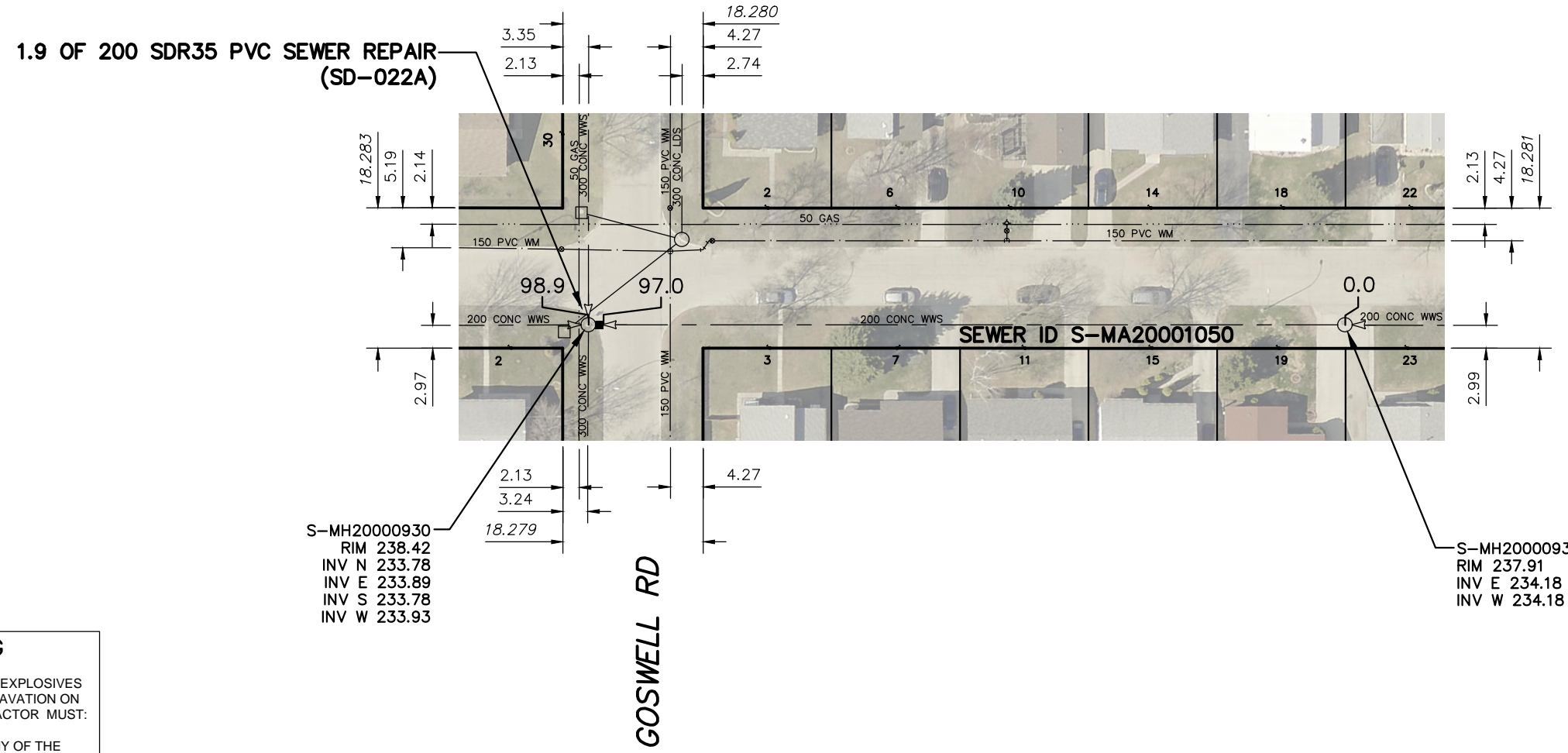

SEWER JUNCTION INFORMATION FROM SEWER VIDEO INSPECTION		
SEWER ID S-MA20001050		
DISTANCE FROM MH ID S-MH20000936		
DISTANCE	DIAMETER	CLOCK
7.6	150	11
8.8	150	2
23.6	150	1
24.8	150	1
40.8	150	11
42.0	150	1
57.9	150	10
59.2	150	1
73.9	150	11
75.2	150	1

S-MH20000930
RIM 238.42
INV N 233.78
INV E 233.89
INV S 233.78
INV W 233.93

S-MH20000936
RIM 237.91
INV E 234.18
INV W 234.18

FOR INDEX SEE 11308

WARNING

IF POWER EQUIPMENT OR EXPLOSIVES ARE TO BE USED FOR EXCAVATION ON THIS PROJECT THE CONTRACTOR MUST:

- 1) NOTIFY THE GAS COMPANY OF THE PROPOSED LOCATION OF EXCAVATION.
- 2) TAKE PRECAUTION TO AVOID DAMAGE TO GAS COMPANY INSTALLATIONS.

SEE PROVINCIAL REGULATION 210/72 FOR DETAILS

METRIC

WHOLE NUMBERS INDICATE MILLIMETRES
DECIMALIZED NUMBERS INDICATE METRES

<p>LOCATION APPROVED UNDERGROUND STRUCTURES</p> <p>SUPV. U/G STRUCTURES COMMITTEE _____ DATE _____</p> <p>NOTE: LOCATION OF UNDERGROUND STRUCTURES AS SHOWN ARE BASED ON THE BEST INFORMATION AVAILABLE BUT NO GUARANTEE IS GIVEN THAT ALL EXISTING UTILITIES ARE SHOWN OR THAT THE GIVEN LOCATIONS ARE EXACT. CONFIRMATION OF EXISTENCE AND EXACT LOCATION OF ALL SERVICES MUST BE OBTAINED FROM THE INDIVIDUAL UTILITIES BEFORE PROCEEDING WITH CONSTRUCTION.</p>	<p>B.M. ELEV.</p> <table border="1" style="width:100%; height: 100px;"> <tr><td> </td><td> </td><td> </td><td> </td></tr> <tr><td> </td><td> </td><td> </td><td> </td></tr> <tr><td> </td><td> </td><td> </td><td> </td></tr> <tr><td> </td><td> </td><td> </td><td> </td></tr> <tr><td> </td><td> </td><td> </td><td> </td></tr> <tr><td> </td><td> </td><td> </td><td> </td></tr> <tr><td> </td><td> </td><td> </td><td> </td></tr> <tr><td> </td><td> </td><td> </td><td> </td></tr> <tr><td> </td><td> </td><td> </td><td> </td></tr> <tr><td> </td><td> </td><td> </td><td> </td></tr> <tr><td> </td><td> </td><td> </td><td> </td></tr> </table>																																													<table border="1" style="width:100%;"> <tr> <td>DESIGNED BY</td> <td>TS</td> <td>CHECKED BY</td> <td>SC</td> </tr> <tr> <td>DRAWN BY</td> <td>RJ</td> <td>APPROVED BY</td> <td>KZ</td> </tr> <tr> <td>SCALE:</td> <td rowspan="2">1:750</td> <td>RELEASED FOR CONSTRUCTION</td> <td rowspan="2">K. ZUREK</td> </tr> <tr> <td>HORIZONTAL</td> <td> </td> </tr> <tr> <td>VERTICAL</td> <td> </td> <td> </td> <td> </td> </tr> <tr> <td>DATE</td> <td>2016 11 18</td> <td>DATE</td> <td>2016 11 14</td> </tr> </table> <p>PLOT DATE: 2016 11 18</p>	DESIGNED BY	TS	CHECKED BY	SC	DRAWN BY	RJ	APPROVED BY	KZ	SCALE:	1:750	RELEASED FOR CONSTRUCTION	K. ZUREK	HORIZONTAL		VERTICAL				DATE	2016 11 18	DATE	2016 11 14	<p>ENGINEER'S SEAL</p> <p>ORIGINAL SIGNED BY S.R.J. COURNOYER 16/11/14</p> <p>CONSULTANT DRAWING NUMBER -</p>	<p style="text-align: center;"> THE CITY OF WINNIPEG WATER AND WASTE DEPARTMENT ENGINEERING DIVISION</p> <p style="text-align: center;">2016 SEWER MAIN RENEWALS BY EXTERNAL POINT REPAIR BUFFIE BAY (S LEG) MH AT GOSWELL ROAD TO 1ST MH E OF GOSWELL ROAD</p>	<p>SHEET 8 OF 29</p> <p>CITY DRAWING NUMBER</p> <p style="font-size: 24pt; text-align: center;">11315</p>
DESIGNED BY	TS	CHECKED BY	SC																																																																				
DRAWN BY	RJ	APPROVED BY	KZ																																																																				
SCALE:	1:750	RELEASED FOR CONSTRUCTION	K. ZUREK																																																																				
HORIZONTAL																																																																							
VERTICAL																																																																							
DATE	2016 11 18	DATE	2016 11 14																																																																				